

LATITUDE 39°17'30"

8,887'

1,892' TO BOTTOM HOLE
LATITUDE 39°17'30"

LONGITUDE 80°50'00"

13,400'

LONGITUDE 80°47'30"

RECEIVED
Office of Oil and Gas
MAY 18 2015
Environmental Protection

Antero Resources Corporation
Well No. Livingston Unit 1H
47-017-06223 (AS-DRILLED)

WELL 1H BOTTOM HOLE
47-017-06223

WELL NO. 1H
47-017-06223

1H BOTTOM HOLE

NOTE:
2 WATER WELLS WERE
LOCATED WITHIN 2000'
OF PROPOSED WELL

AS DRILLED DATA
WELL 1H TOP HOLE INFORMATION:
N: 277,700ft E: 1,625,351ft
LAT: 39°15'17.56" LON: 80°49'22.98"
BOTTOM HOLE INFORMATION:
N: 286,806ft E: 1,620,682ft
LAT: 39°16'46.87" LON: 80°50'24.06"
WEST VIRGINIA COORDINATE
SYSTEM OF 1927 NORTH ZONE.
ZONE WAS DERIVED FROM
MEASUREMENTS TAKEN WITH
TRIMBLE GEOXT SUBMETER
MAPPING GRADE GPS UNIT.
PLAT ORIENTATION, CORNER,
AND WELL REFERENCE TIE LINES
ARE BASED ON GRID NORTH.

(NAD) 83 (UTM) ZONE 17 COORDS:
WELL 1H TOP HOLE INFORMATION:
N: 4,345,085m E: 515,282m
BOTTOM HOLE INFORMATION:
N: 4,347,836m E: 513,813m

- NOTES**
1. NO OCCUPIED DWELLINGS OR BUILDINGS TWO THOUSAND FIVE HUNDRED (2,500) SQUARE FEET OR LARGER USED TO HOUSE OR SHELTER DAIRY CATTLE OR POULTRY HUSBANDRY ARE LOCATED WITHIN SIX HUNDRED TWENTY-FIVE (625) FEET OF THE CENTER OF THE WELL PAD.
 2. TOP HOLE DATA SHOWN HEREON WAS PROVIDED BY ALLEGHENY SURVEYS, INC.
 3. AS DRILLED DATA WAS PROVIDED BY ANTERO RESOURCES CORPORATION.
 4. WLS IS NOT CERTIFYING THE DATA AND INFORMATION PROVIDED LISTED IN NOTES 2 AND 3, ONLY THE RELATIONSHIP TO THE DATA AND INFORMATION PROVIDED TO THE LEASE BOUNDARIES.
 5. WLS IS BY NO MEANS RESPONSIBLE FOR ANY ERRORS OR INACCURACIES WITH THE DATA AND INFORMATION THAT HAS BEEN PROVIDED.

JOB # 12-155WA
DRAWING # LIVINGSTON1HAD
SCALE 1" = 1000'
MINIMUM DEGREE OF ACCURACY SUBMETER
PROVEN SOURCE OF ELEV. SUBMETER MAPPING GRADE GPS

LEGEND

- - - - - Surface Owner Boundary Lines +/-
- - - - - Interior Surface Tracts +/-
- x - x - x Existing Fence
- ⊕ Found monument, as noted
- ⊙ Proposed Well Path
- ⊙ As Drilled Well Path

DATE 03/30/15
OPERATOR'S WELL # LIVINGSTON UNIT #1H
API WELL # 47 - 017 - 06223
STATE COUNTY PERMIT

PAD LAYOUT



STATE OF WEST VIRGINIA, DIVISION OF ENVIRONMENTAL PROTECTION, OFFICE OF OIL AND GAS

WILLOW LAND SURVEYING PLLC
P.O. BOX 17
PENNSBORO, WV 26415

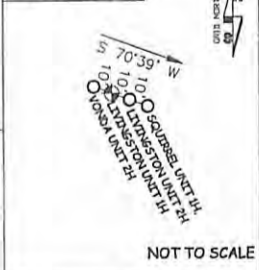

STATE OF WEST VIRGINIA DEPT. OF ENERGY DIVISION OF OIL AND GAS
WELL TYPE: OIL GAS X LIQUID INJECTION WASTE DISPOSAL
(IF "GAS") PRODUCTION X STORAGE DEEP SHALLOW X
LOCATION: ELEVATION 1,011' ORIGINAL - 1,003' AS DRILLED WATERSHED MIDDLE ISLAND CREEK
QUADRANGLE WEST UNION 7.5' DISTRICT WEST UNION COUNTY DODD

SURFACE OWNER LEWIS P. BEE ACREAGE 70.8 ACRES +/-
OIL & GAS ROYALTY OWNER GEORGE BEE ET AL; INA BEE ET AL; LIVINGSTON S. BEE; CRAIG ALLEN WRIGHT, II; PERRY CHIPPS ET AL; DENZIL L. LEGGETT ET AL; HUGH HAMMOND ET AL LEASE ACREAGE 356.5 AC±; 30 AC±; 9.159 AC±; 30.09±; 54.82 AC±; 140 AC±; 146 AC±
PROPOSED WORK: DRILL CONVERT DRILL DEEPER REDRILL FRACTURE OR STIMULATE
PLUG OFF OLD FORMATION PERFORATE NEW FORMATION OTHER PHYSICAL CHANGE IN WELL (SPECIFY) (X) AS DRILLED PLUG & ABANDON CLEAN OUT & REPLUG
TARGET FORMATION MARCELLUS ESTIMATED DEPTH 6,592' TVD 16,681' MD
WELL OPERATOR ANTERO RESOURCES CORP. DESIGNATED AGENT DIANNA STAMPER
ADDRESS 1615 WYNKOOP STREET ADDRESS CT CORPORATION SYSTEM
DENVER, CO 80202 ADDRESS 5400 D BIG TYLER ROAD
CHARLESTON, WV 25313