

(+) Denotes Location of Well on United States Topographical Maps

Bearing	Distance
L1 S 74°48' E	816.8'
L2 S 78°15' W	1,650.0'
L3 N 21°07' E	1,428.8'
L4 N 37°17' E	423.7'
L5 S 84°22' W	710.6'



I, the undersigned, hereby certify that this plat is correct to the best of my knowledge and belief and shows all the information required by law and the regulations issued and prescribed by the Department of Environmental Protection.

*Bradley D. Miller*  
Bradley D. Miller, P.S. 2167

**Legend**

- ⊙ Proposed gas well
- ⊙ Found Monument (as noted)
- Creek or Drain
- Existing Road
- Surface boundary (approx.)
- Interior surface tracts (approx.)
- ⊙ County Routes

**Detail Not to Scale**

S 90°00' E 10.0'

**Notes:**  
West Virginia Coordinate System of 1987, North Zone based upon Differential GPS Measurements.  
Well No. Tripel Unit 1H Top Hole coordinates are  
N: 252,912.78' Longitude: 80°39'42.13"  
E: 1,870,725.02' Longitude: 80°39'42.13"  
Bottom Hole coordinates are  
N: 247,018.65' Longitude: 39°10'20.52"  
E: 1,870,868.87' Longitude: 80°39'42.03"  
UTM Zone 17, MAD 1983  
Top Hole Coordinates Bottom Hole Coordinates  
N: 4,337,784.728 m N: 4,335,988.757 m  
E: 529,231.232 m E: 529,240.415 m  
Plat orientation and corner and well references are based upon the grid north meridian.  
Well location references are based upon the magnetic meridian.

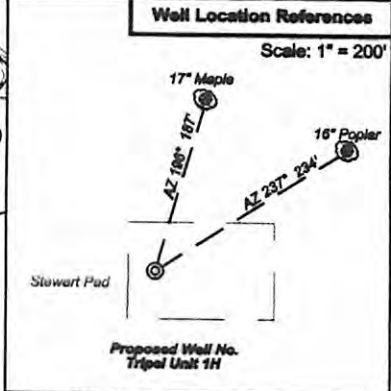

FILE NO: 89-30-NM-13  
DRAWING NO: 89-13 Tripel 1H Well  
SCALE: 1" = 1500'  
MINIMUM DEGREE OF ACCURACY: Submeter  
PROVEN SOURCE OF ELEVATION: WVDOT, Bridgeport, WV

**STATE OF WEST VIRGINIA**  
DEPARTMENT OF ENVIRONMENTAL PROTECTION  
**OIL AND GAS DIVISION**

DATE: April 26 2013  
OPERATOR'S WELL NO. Tripel Unit 1H  
API WELL NO  
47 - 017 - 6284 16A  
STATE COUNTY PERMIT

WELL TYPE:  OIL  GAS  LIQUID INJECTION  WASTE DISPOSAL  
(IF GAS) PRODUCTION:  STORAGE  DEEP  SHALLOW  
LOCATION: ELEVATION: 1332' WATERSHED: Indian Fork QUADRANGLE: New Milton  
DISTRICT: New Milton COUNTY: Doddridge  
SURFACE OWNER: Randall & Carolyn S. Stewart Ruby Farr Maxwell, et al; ARAC-Stewart 6-16-11,12,13; ACREAGE: 105.1 102.19;  
ROYALTY OWNER: Randall P. Stewart, et al; Joyce A. Shaw Nazlerod, et al; Susan B. Gum; ARAC 6-16-18; ARAC-Gum ACREAGE: 121;  
PROPOSED WORK:  DRILL  CONVERT  DRILL DEEPER  FRACTURE OR STIMULATE  PLUG OFF OLD FORMATION  
 PERFORATE NEW FORMATION  OTHER PHYSICAL CHANGE IN WELL (SPECIFY)  
 PLUG AND ABANDON  CLEAN OUT AND REPLUG TARGET FORMATION: Marcellus Shale ESTIMATED DEPTH: 7,400' TVD 13,800' MD

WELL OPERATOR: Antero Resources Appalachian Corporation DESIGNATED AGENT: Dianna Stamper - CT Corporation System  
ADDRESS: 1625 17th Street ADDRESS: 5400 D Big Tyler Road  
Denver, CO 80202 Charleston, WV 25313

10/17/2014

CANCELLED