

Tag	Y/M/PAR	OWNER	BK/PG	AC.
1	16/1	Shirley L. Devericks & William R. Cox	AB 24 / 28	73.387
2	16/2	Michael B. Duffelmeyer	WB 42 / 318	120.400
3	16/3	Virginia L. Nicholson	WB 26 / 273	43.600
4	16/17.1	Edward L. & Connie Lee Cumpston	281 / 355	29.410
5	16/17.3	John D. & Deborah Cumpston	232 / 127	32.000
6	16/17.4	Ronald E. & Trannis A. Smith	232 / 129	8.190
7	16/21	Brooks Jay Gum	131 / 218	72.000
8	20/8	James Devericks, et al	131 / 11	31.100
9	20/7	Mary Berlie Merand & Paul Uster (Mountain Link Associates)	288 / 131	13.000
10	20/12	Barry Properties, LLC	266 / 55	39.500
11	20/24.1	Darrell E. Reed, Jr.	261 / 662	2.000
12	20/25	James F. Furby & Hannah A. Hutson	306 / 667	46.500

Bearing	Distance
L1 S 74°58' E	826.5'
L2 S 78°11' W	1,640.2'
L3 N 21°30' E	1,432.4'
L4 N 38°20' E	429.9'
L5 S 79°11' W	1,048.9'



I, the undersigned, hereby certify that this plat is correct to the best of my knowledge and belief and shows all the information required by law and the regulations issued and prescribed by the Department of Environmental Protection.

*Bradley D. Miller*  
Bradley D. Miller, P.S. 2167

**Legend**

- ⊙ Proposed gas well
- ⊙ Found Monument (as noted)
- Creek or Drain
- Existing Road
- Surface boundary (approx.)
- Interior surface tracts (approx.)
- ⊙ County Routes

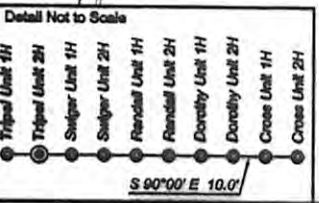

**Notes:**  
West Virginia Coordinate System of 1987, North Zone based upon Differential GPS Measurements.  
Well No. Tripel Unit 2H Top Hole coordinates are N: 252,912.78' Latitude: 39°11'18.78" E: 1,670,735.02' Longitude: 80°39'42.00"  
Bottom Hole coordinates are N: 246,338.03' Latitude: 30°10'13.90" E: 1,671,539.42' Longitude: 80°39'30.71"  
UTM Zone 17, NAD 1983  
Top Hole Coordinates Bottom Hole Coordinates  
N: 4,337,764.779 m N: 4,335,785.894 m  
E: 529,234.279 m E: 529,512.743 m  
Pit orientation and corner and well references are based upon the grid north meridian.  
Well location references are based upon the magnetic meridian.

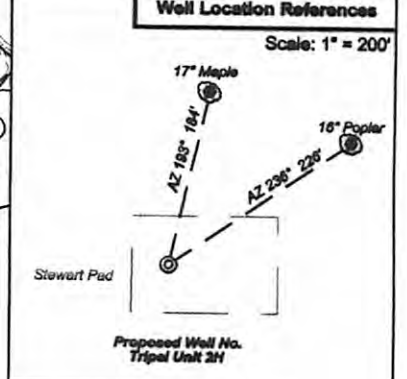

FILE NO: 89-30-NM-13  
DRAWING NO: 89-13 Tripel 2H Well  
SCALE: 1" = 1500'  
MINIMUM DEGREE OF ACCURACY: Submeter  
PROVEN SOURCE OF ELEVATION: WVDOT, Bridgeport, WV

**STATE OF WEST VIRGINIA**  
DEPARTMENT OF ENVIRONMENTAL PROTECTION  
**OIL AND GAS DIVISION**

DATE: April 25 2013  
OPERATOR'S WELL NO. Tripel Unit 2H  
API WELL NO  
47 - 017 - 0628516A  
STATE COUNTY PERMIT

WELL TYPE:  OIL  GAS  LIQUID INJECTION  WASTE DISPOSAL  
(IF GAS) PRODUCTION:  STORAGE  DEEP  SHALLOW  
LOCATION: ELEVATION: 1332' WATERSHED: Indian Fork QUADRANGLE: New Milton  
DISTRICT: New Milton  
SURFACE OWNER: Randall & Carolyn S. Stewart  
ROYALTY OWNER: Randall P. Stewart, et al; Joyce A. Shaw Nazelrod, et al; Susan B. Gum; LEASE NO: ARAC-21994-Swiger; ARAC-Stewart 6-16-11,12,13; ARAC-6-16-18; ARAC-Gum; ARAC-21121; ACREAGE: 105.1 102.19; 121; 52.5; 195; 384; 102  
PROPOSED WORK:  DRILL  CONVERT  DRILL DEEPER  FRACTURE OR STIMULATE  PLUG OFF OLD FORMATION  
 PERFORATE NEW FORMATION  OTHER PHYSICAL CHANGE IN WELL (SPECIFY)  
 PLUG AND ABANDON  CLEAN OUT AND REPLUG TARGET FORMATION: Marcellus Shale ESTIMATED DEPTH: 7,400' TVD 14,900' MD  
WELL OPERATOR: Antero Resources Appalachian Corporation DESIGNATED AGENT: Dianna Stamper - CT Corporation System  
ADDRESS: 1625 17th Street ADDRESS: 5400 D Big Tyler Road  
Denver, CO 80202 Charleston, WV 25313

**10/17/2014**

**CANCELLED**