

LEWIS MAXWELL LEASE OXF149 WELLS

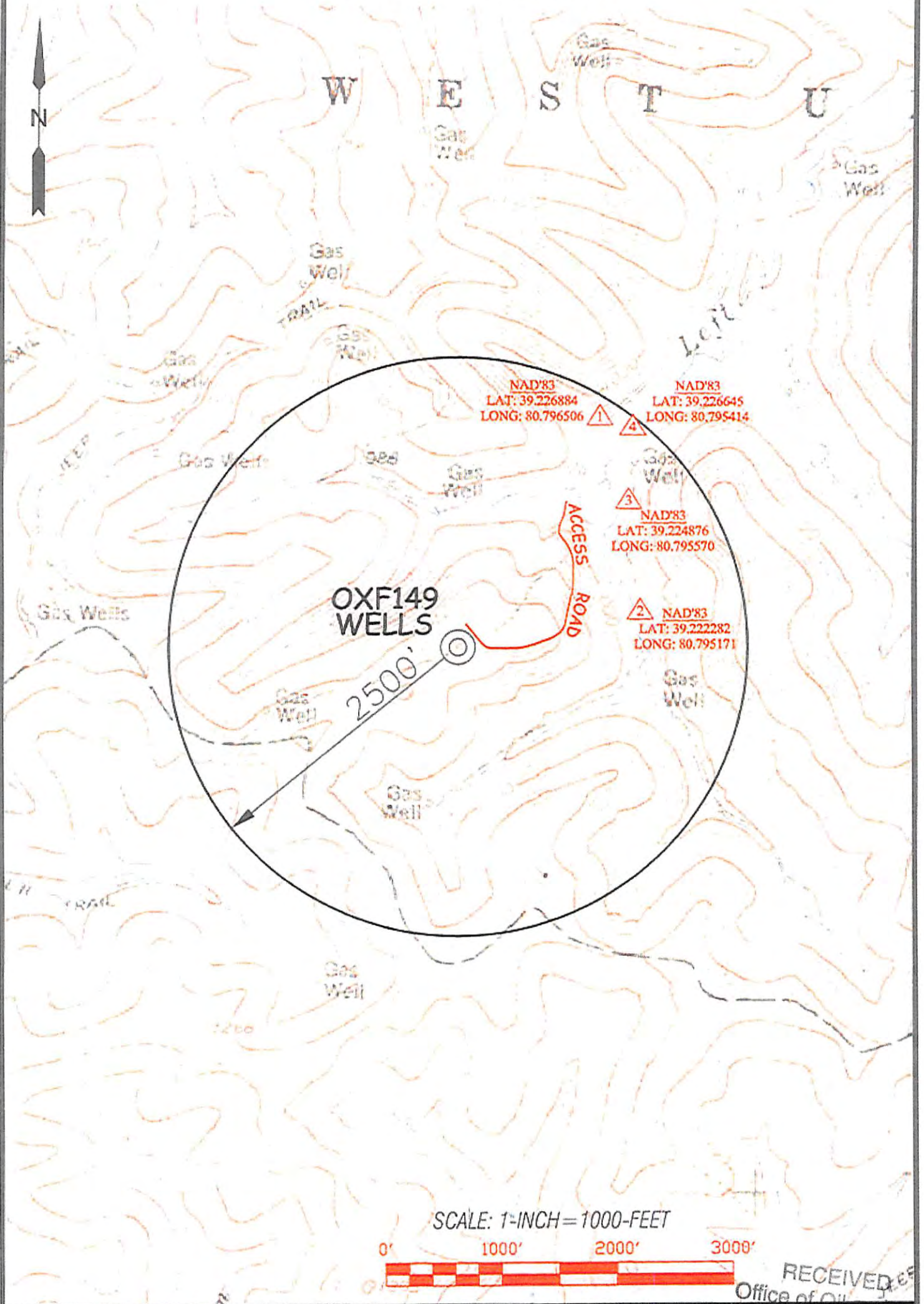

SCALE: 1-INCH = 1000-FEET



RECEIVED
Office of Oil and Gas

		TOPO SECTION OF: OXFORD, WV 7.5' QUAD.		OPERATOR: EQT PRODUCTIONS COMPANY 115 PROFESSIONAL PLACE P.O. BOX 280 BRIDGEPORT, WV 26330	
DISTRICT	COUNTY	TAX MAP-PARCEL NO.			
WEST UNION	DODDRIDGE	23-3.1			
DRAWN BY K.D.W.	FILE NO. 6980	DATE 09/12/13	CADD FILE: 6980W551247BR2		

01/24/2014