

Antero Resources
Well No. Arters Unit 1H
As-Drilled Plat
Antero Resources Corporation

Tax Map 5 Parcels				
Par	Owner	DB/Pg	Acres	
1	12	Ricky & Carla Jan Watson	186/339	31.5
2	16	Phillip & Sue Ellen Rager	195/779	1.06
3	12.4	Mt. Olive Baptist Trustees	252/98	0.44
4	12.3	Mt. Olive Baptist Trustees	214/734	0.07
5	13	Mt. Olive Baptist Trustees	-	2.65
6	17.1	William & Leanna J. Davis	229/116	0.55
7	17	James Jr. & Jo Anne Davis	168/338	1.45
8	20	Tillman Lee Williams	246/344	13.5

Tax Map 321 Parcels				
Par	Owner	DB/Pg	Acres	
9	34	Tillman Lee Williams	1322/1056	5.40
10	22.1	Earl Dixon	1062/878	3.17
11	21	Dave & Jennifer Lohman	1369/196	44.0
12	14	Arthur & Linda Lunsford	1004/1150	1.20
13	24	Gary & Janette Alderman	1421/1212	0.78
14	12.2	Layman Foundation	1300/641	4.81
15	3	Francis & Edith Marinaro	1348/836	19.28
16	3.1	Francis & Edith Marinaro	1461/310	3.75
17	13	Linda S. Lunsford	1219/947	33.0
18	4.4	Gordon & Kerry Edgell	1466/590	0.78
19	4.2	Gordon & Kerry Edgell	1466/588	0.16
20	22	James & Anna Taylor	1188/435	61.53
21	12	Miracle Meadows School	1210/9	51.02
22	12.1	Layman Foundation	1307/743	4.80
23	33	James L. Jenkins	1345/1059	28.14

Notes:
 West Virginia Coordinate System of 1927, North Zone based upon Differential GPS Measurements.
 Well No. Arters Unit 1H Top Hole coordinates are
 N: 273,017.02 Latitude: 39°14'40.75"
 E: 1,697,438.79 Longitude: 80°34'05.91"
 Bottom Hole coordinates are
 N: 283,958.93 Latitude: 39°16'28.55"
 E: 1,694,503.08 Longitude: 80°34'44.89"
UTM Zone 17, NAD 1983
 Top Hole Coordinates: Bottom Hole Coordinates:
 N: 4,344,025.287m N: 4,347,343.855m
 E: 537,267.559m E: 536,317.643m
 Plat orientation and corner and well references are based upon the grid north meridian.
 Well location references are based upon the magnetic meridian.

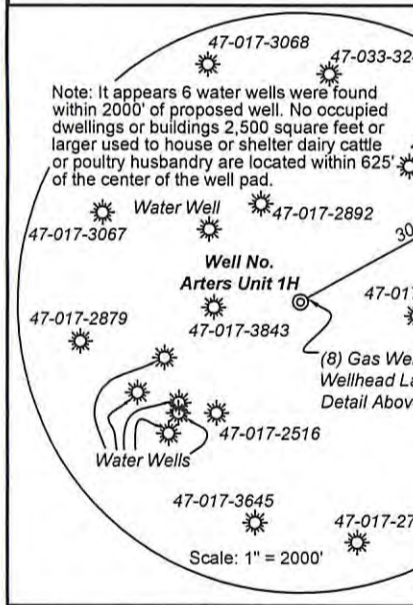

FILE NO: 355-30-G-12
 DRAWING NO: Arters 1H As-Drilled Plat
 SCALE: 1" = 1500'
 MINIMUM DEGREE OF ACCURACY: Submeter
 PROVEN SOURCE OF ELEVATION: WVDOT, Bridgeport, WV

STATE OF WEST VIRGINIA
 DEPARTMENT OF ENVIRONMENTAL PROTECTION
OIL AND GAS DIVISION

DATE: March 27 2015
 OPERATOR'S WELL NO. Arters Unit 1H
 API WELL NO: 47 - 017 - 06450
 STATE COUNTY PERMIT

WELL TYPE: OIL GAS LIQUID INJECTION WASTE DISPOSAL
 (IF GAS) PRODUCTION: STORAGE DEEP SHALLOW
 LOCATION: ELEVATION: Existing Grade - 1045' Proposed Grade - 1050' WATERSHED: Headwaters Middle Island Creek QUADRANGLE: Big Isaac
 DISTRICT: Greenbrier COUNTY: Doddridge
 SURFACE OWNER: Clarence & Mary Mutschelknaus ACREAGE: 99.03 39.339; 130
 ROYALTY OWNER: D. L. Louchery; Valma L. Arters, et vir; Victor G. Taylor; Pearl R. Bailey, et ux; Ruth Rogers, et al LEASE NO: DV019191; DAD36169/001; DV019285; 21620 ACREAGE: 283; 234.342
 PROPOSED WORK: DRILL CONVERT DRILL DEEPER FRACTURE OR STIMULATE PLUG OFF OLD FORMATION
 PERFORATE NEW FORMATION OTHER PHYSICAL CHANGE IN WELL (SPECIFY) As-Drilled
 PLUG AND ABANDON CLEAN OUT AND REPLUG TARGET FORMATION: Marcellus Shale DEPTH: MD 18, 198'
 WELL OPERATOR: Antero Resources Corporation DESIGNATED AGENT: Dianna Stamper - CT Corporation System
 ADDRESS: 1615 Wynkoop Street ADDRESS: 5400 D Big Tyler Road
 Denver, CO 80202 Charleston, WV 25313

