

AS DRILLED BHL is located on topo map 9,306 feet south of Latitude: 39° 12' 30"
 AS DRILLED SHL is located on topo map 14,395 feet south of Latitude: 39° 12' 30"

AS DRILLED BHL is located on topo map 2,598 feet west of Longitude: 80° 45' 00"
 AS DRILLED SHL is located on topo map 11,186 feet west of Longitude: 80° 42' 30"

NOTES:

1. There are no water wells or developed springs within 250' of proposed well.
2. Proposed well is greater than 100' from perennial stream, wetland, pond, reservoir or lake.
3. There are no native trout streams within 300' of proposed well.
4. Proposed well is greater than 1000' from surface/groundwater intake or public water supply.
5. It is not the purpose or intention of this plat to represent surveyed locations of the surface or mineral parcels depicted hereon. The location of the boundary lines, as shown, are based on record deed descriptions, field evidence found and/or tax map position, unless otherwise noted.
6. The center of pad is less than 625' from a dwelling.
7. Coordinates of As-Drilled locations are based on survey by Kelly Surveying, and drill logs provided by Antero Resources. BML takes no responsibility for accuracy.

LINE	BEARING	DISTANCE
R1	S 51°24'26" W	88.55'
R2	N 23°17'54" W	67.82'
R3	N 52°47'46" E	137.49'
R4	S 56°21'57" E	1633.64'
R5	N 73°39'35" W	1324.93'
R6	N 48°06'19" W	996.72'

AS DRILLED
 BOTTOM HOLE LOCATION (BHL)
 UTM 17-NAD83
 N:4337088.42
 E:520800.56
 NAD27, WV NORTH
 N:251155.220
 E:1643022.450
 LAT/LON DATUM-NAD27
 LAT:39.182700
 LON:-80.759339

PERMITTED
 APPROX. POINT OF ENTRY (POE)
 UTM 17-NAD83
 N:4335609.19
 E:521366.31
 NAD27, WV NORTH
 N:246270.000
 E:1644798.000
 LAT/LON DATUM-NAD27
 LAT:39.169356
 LON:-80.752836

AS DRILLED
 APPROX. POINT OF ENTRY (POE)
 UTM 17-NAD83
 N:4335619.32
 E:521359.25
 NAD27, WV NORTH
 N:246303.620
 E:1644775.390
 LAT/LON DATUM-NAD27
 LAT:39.169447
 LON:-80.752917

PERMITTED
 SURFACE HOLE LOCATION (SHL)
 UTM 17-NAD83
 N:4335535.00
 E:521787.00
 NAD27, WV NORTH
 N:246003.479
 E:1646174.472
 LAT/LON DATUM-NAD27
 LAT:39.168677
 LON:-80.747969

AS DRILLED
 SURFACE HOLE LOCATION (SHL)
 UTM 17-NAD83
 N:4335535.22
 E:521787.07
 NAD27, WV NORTH
 N:246004.191
 E:1646174.695
 LAT/LON DATUM-NAD27
 LAT:39.168679
 LON:-80.747968

LEGEND

- TOPO MAP POINT
- WELL
- ALL ARE POINTS UNLESS OTHERWISE NOTED.
- LESSORS
- SURFACE OWNERS
- WATER SOURCE
- MINERAL TRACT BOUNDARY
- LEASE BOUNDARY
- PARCEL LINES
- WELL REFERENCE
- PROPOSED HORIZONTAL WELL
- AS DRILLED
- ROAD
- STREAM CENTER LINE
- GAS WELLS
 - EXISTING WELLS
 - PLUGGED WELLS

PERMITTED
 BOTTOM HOLE LOCATION (BHL)
 UTM 17-NAD83
 N:4338659.23
 E:520197.96
 NAD27, WV NORTH
 N:256343.000
 E:1641131.000
 LAT/LON DATUM-NAD27
 LAT:39.196869
 LON:-80.766269

SURFACE OWNER		DIST-TM/PAR
A	I. L. (IKE) MORRIS	7-10/2
B	JERRY L. & SHARON LEGGETT (SURV)	7-15/3.1

PARCEL	LESSOR
1,3,4, 7&8	S.W. STOUT ET AL
9	SUSAN V. DRENNAN, ET AL

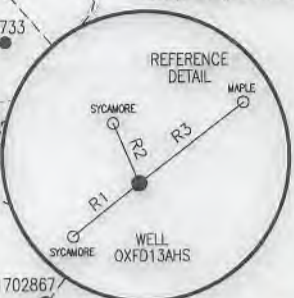

Blue Mountain Inc.
 10125 MASON DIXON HIGHWAY
 BURTON, WV 26562
 PHONE: (304) 662-6486

FILE #: OXFD13AHS
 DRAWING #: OXFD13AHS
 SCALE: 1" = 2000'
 MINIMUM DEGREE OF ACCURACY: 1/2500
 PROVEN SOURCE OF ELEVATION: U.S.G.S. MONUMENT THOMAS 1498.81'

I, THE UNDERSIGNED, HEREBY CERTIFY THAT THIS PLAT IS CORRECT TO THE BEST OF MY KNOWLEDGE AND BELIEF AND SHOWS ALL THE INFORMATION REQUIRED BY LAW AND THE REGULATIONS ISSUED AND PRESCRIBED BY THE DEPARTMENT OF ENVIRONMENTAL PROTECTION.

Signed: George D. Six
 R.P.E.: _____ L.L.S.: P.S. No. 2000

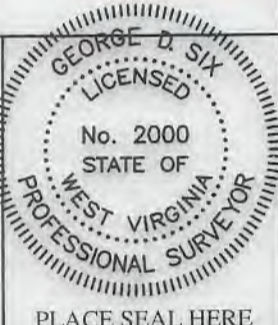

(+) DENOTES LOCATION OF WELL ON UNITED STATES TOPOGRAPHIC MAPS WVDEP
 OFFICE OF OIL & GAS
 601 57TH STREET
 CHARLESTON, WV 25304

Well Type: Oil Waste Disposal Production Deep
 Gas Liquid Injection Storage Shallow

WATERSHED: SOUTH FORK HUGHES RIVER ELEVATION: 1,152.4'
 COUNTY/DISTRICT: DODDRIDGE / SOUTHWEST QUADRANGLE: NEW MILTON, WV 7.5' (SHL) & OXFORD, WV 7.5' (BHL)
 SURFACE OWNER: I. L. (IKE) MORRIS ACREAGE: 6603.75±
 OIL & GAS ROYALTY OWNER: S. W. STOUT ET AL & SUSAN V. DRENNAN, ET VIR, ET AL ACREAGE: 1427±, 236±, 417±

DRILL CONVERT DRILL DEEPER REDRILL FRACTURE OR STIMULATE
 PLUG OFF OLD FORMATION PERFORATE NEW FORMATION PLUG & ABANDON
 CLEAN OUT & REPLUG OTHER CHANGE (SPECIFY): _____

TARGET FORMATION: MARCELLUS ESTIMATED DEPTH: TVD: 6,764'± TMD: 12,613'±
 WELL OPERATOR ANTERO RESOURCES CORPORATION DESIGNATED AGENT DIANNA STAMPER-CT CORPORATION SYSTEM
 Address 1615 WYNKOOP STREET Address 5400 D BIG TYLER ROAD
 City DENVER State CO Zip Code 80202 City CHARLESTON State WV Zip Code 25313

DATE: FEBRUARY 05, 2018
 OPERATOR'S WELL #: OXFD13AHS
 API WELL #: 47 17 06456 F
 STATE COUNTY PERMIT

10/12/2018

4701706456F

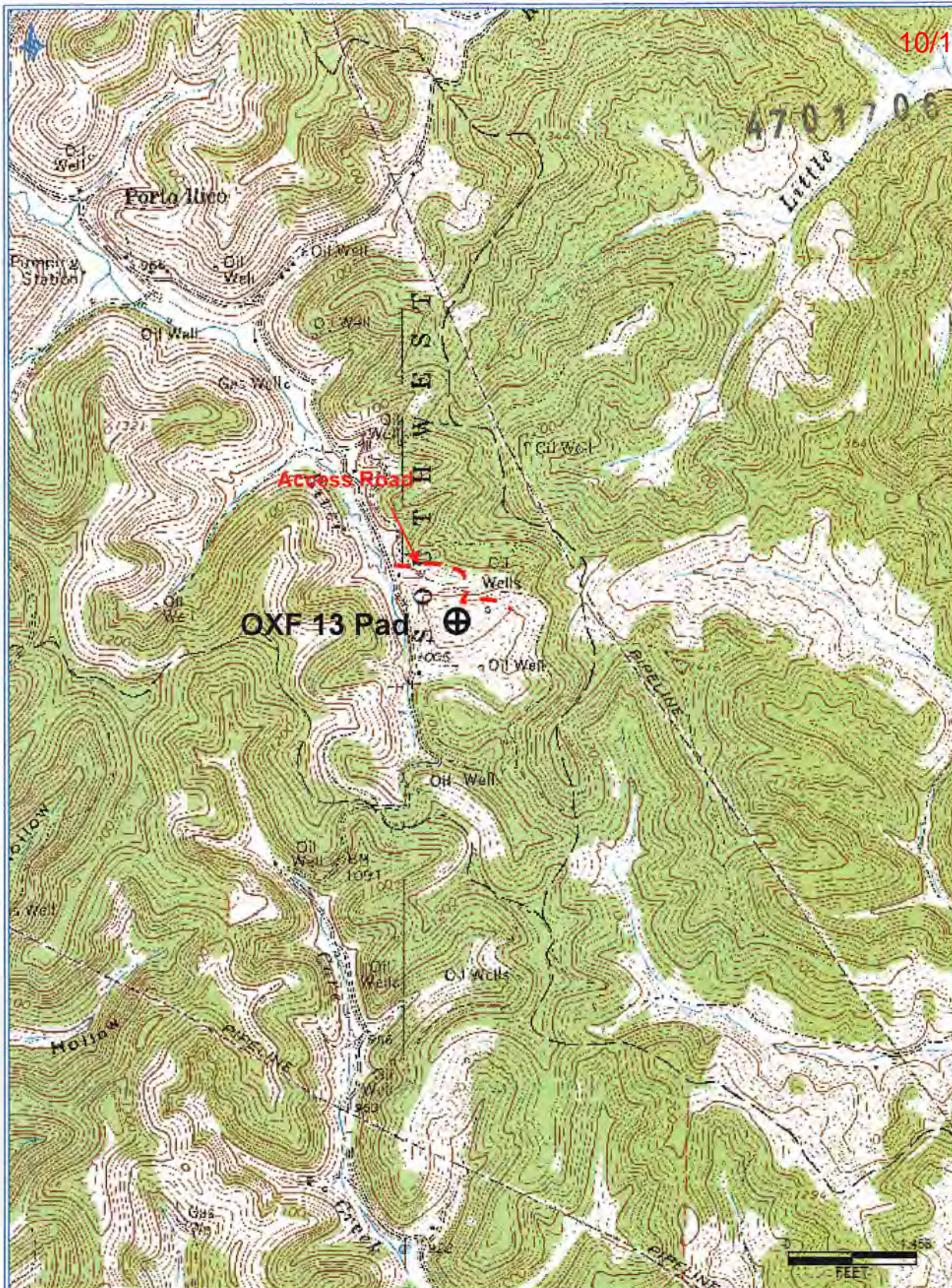

Antero Resources Corporation
 Appalachian Basin
 OXF 13 Pad
 Ritchie County

Quadrangle: New Milton
 Watershed: South Fork Hughes River
 District: Doddridge
 Date: 6-11-2018

RECEIVED
 Office of Oil and Gas
 JUN 14 2018
 WV Department of
 Environmental Protection