

Antero Resources
Well No. McDonnell Unit 2H
Antero Resources Corporation



Notes:
West Virginia Coordinate System of 1927, North Zone based upon Differential GPS Measurements.
Well No. McDonnell Unit 2H Top Hole coordinates are
N: 305,691.38' Latitude: 39°19'55.85"
E: 1,636,869.98' Longitude: 80°47'01.65"
Bottom Hole coordinates are
N: 297,854.89' Latitude: 39°18'38.96"
E: 1,640,887.49' Longitude: 80°46'09.11"
UTM Zone 17, NAD 1983
Top Hole Coordinates Bottom Hole Coordinates
N: 4,353,671.503m N: 4,351,304.551m
E: 518,649.029m E: 519,912.789m
Plat orientation and corner and well references are based upon the grid north meridian.
Well location references are based upon the magnetic meridian.

Legend

- Proposed gas well
- Found corner, as noted
- Creek or Drain
- Existing Road
- Surface boundary (approx.)
- Interior surface tracts (approx.)
- Existing well, as noted

Tag	Par	Tax Map 4 Owner	Bk / Pg	Ac.
1	35	Matthew Alexander	276 / 12	5.89
2	29	Phillip S. Underwood Patricia Cooper Katherine S. Sisler	WB 51/709	0.46
3	24	Karen Ann Smith	248 / 254	35.34
4	23	Christian Church	49/71 & 72	0.85
5	30	Kathryn J. Sisler, et al	211/302	30.50
6	14.1	John M. & Andrea Fitzgerald	282/418	27.21

(*) Denotes Location of Well on United States Topographical Maps

	Bearing	Dist.
L1	N 80°35' E	953.3'
L2	N 88°37' E	766.7'
L3	N 51°32' E	1006.1'
L4	S 65°43' E	1987.1'
L5	N 69°25' W	1195.0'

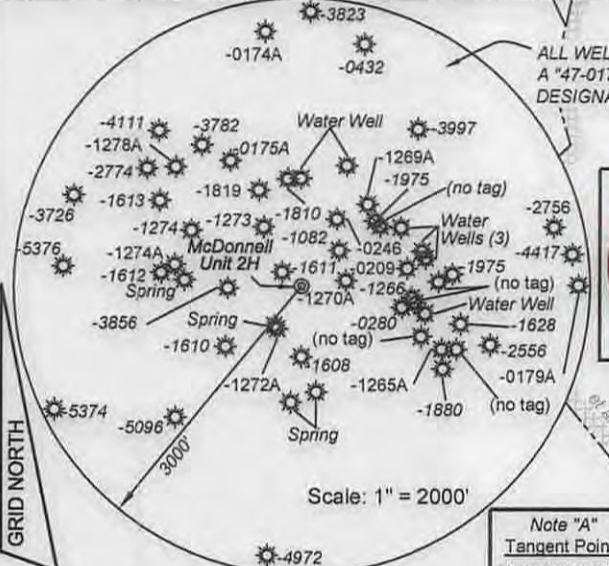

Note "A"
Tangent Point
N: 305,847.39'
E: 1,637,810.38'

I, the undersigned, hereby certify that this plat is correct to the best of my knowledge and belief and shows all the information required by law and the rules issued and prescribed by the Department of Environmental Protection.

Kenneth J. Plum
Kenneth J. Plum, P.S. 2216

FILE NO: 49-30-WU-14
DRAWING NO: 49-14 McDonnell 2H Plat
SCALE: 1" = 1200'
MINIMUM DEGREE OF ACCURACY: Submeter
PROVEN SOURCE OF ELEVATION: WVDOT, Harrisville, WV

STATE OF WEST VIRGINIA
DEPARTMENT OF ENVIRONMENTAL PROTECTION
OIL AND GAS DIVISION

DATE: September 9 20 14
OPERATOR'S WELL NO. McDonnell 2H
API WELL NO. **H6A**
47 - 017 - 06663
STATE COUNTY PERMIT

WELL TYPE: OIL GAS LIQUID INJECTION WASTE DISPOSAL
(IF GAS) PRODUCTION: STORAGE DEEP SHALLOW
LOCATION: ELEVATION: 1065' WATERSHED: Nutter Fork of Middle Island Creek QUADRANGLE: West Union
DISTRICT: West Union COUNTY: Doddridge
SURFACE OWNER: John Paul Strickling, et al B.J. (Sally) Underwood Joseph Freeman, et ux Freeman P. Smith, et ux ACREAGE: 357.75 31; 450; 600
ROYALTY OWNER: Charles C. Smith, et al; William Ashburn Heirs; William A. Farr LEASE NO: ACREAGE: 120; 45.88; 36
PROPOSED WORK: DRILL CONVERT DRILL DEEPER FRACTURE OR STIMULATE PLUG OFF OLD FORMATION
 PERFORATE NEW FORMATION OTHER PHYSICAL CHANGE IN WELL (SPECIFY)
 PLUG AND ABANDON CLEAN OUT AND REPLUG TARGET FORMATION: Marcellus Shale ESTIMATED DEPTH: 7,100' TVD 17,100 MD

WELL OPERATOR: Antero Resources Corporation DESIGNATED AGENT: Dianna Stamper - CT Corporation System
ADDRESS: 1615 Wynkoop Street ADDRESS: 5400 D Big Tyler Road
Denver, CO 80202 Charleston, WV 25313

01/23/2015

4701706663

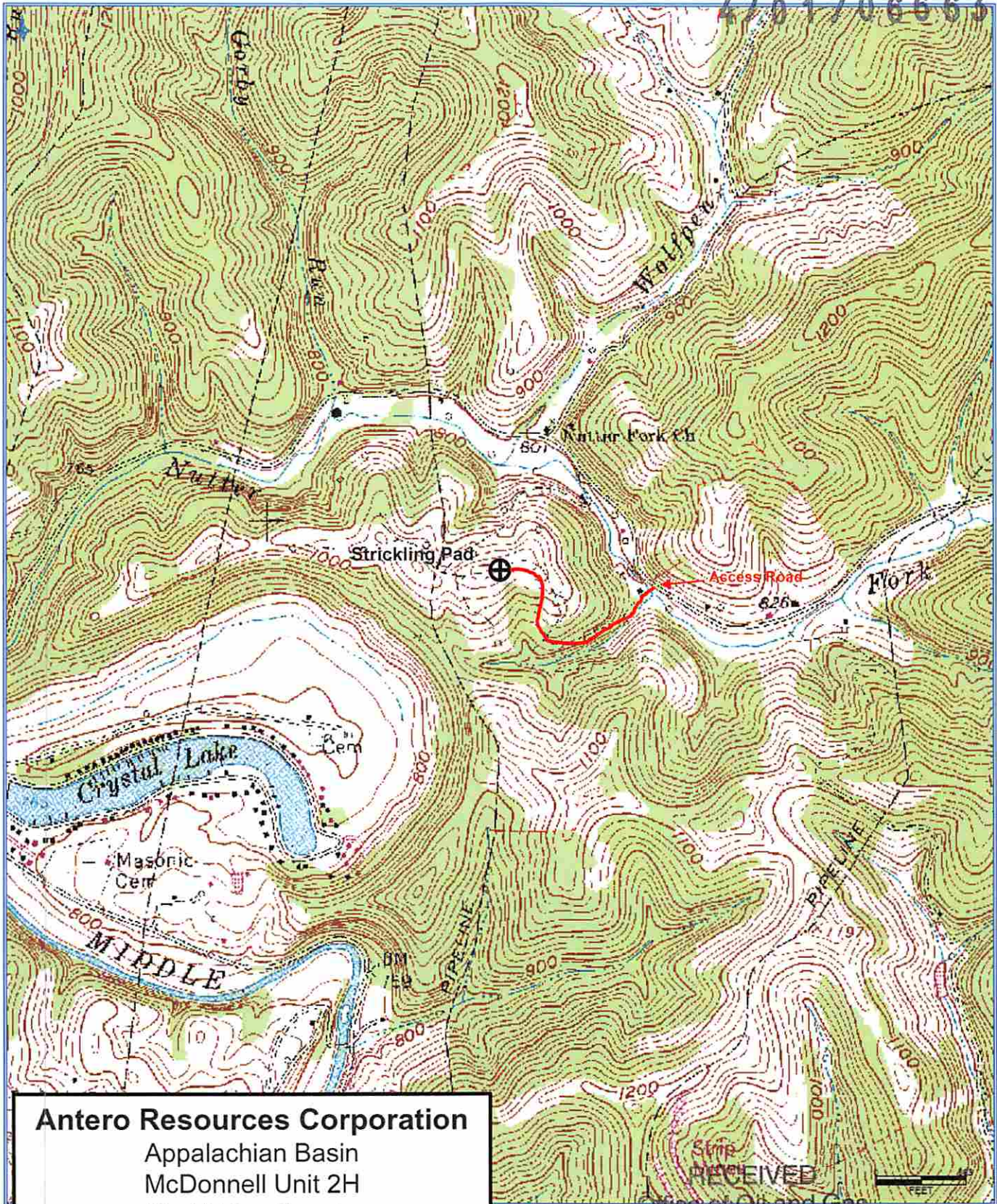

Antero Resources Corporation

Appalachian Basin
McDonnell Unit 2H
Doddridge County

Quadrangle: West Union
Watershed: Middle Creek
District: West Union
Date: 9-09-2014

Stamp RECEIVED
Office of Oil and Gas

OCT 31 2014

WV Department of
Environmental Protection