

2,866' to Bottom Hole

5,677' to Top Hole  
TOP HOLE LATITUDE 39 - 22 - 30  
BOTTOM HOLE LATITUDE 39 - 20 - 00 - 00

LONGITUDE 80 - 45 - 00

9,526' to Top Hole  
3,682' to Bottom Hole

**Antero Resources**  
**Well No. Walker Unit 2H As-Drilled Plat**  
**Antero Resources Corporation**

**Legend**

- Proposed gas well
- Found corner, as noted
- Existing Well, as noted
- Creek or Drain
- Existing Road
- Surface boundary (approx.)
- Interior surface tracts (approx.)

**Notes:**  
**West Virginia Coordinate System of 1927, North Zone based upon Differential GPS Measurements.**  
 Well No. Walker Unit 2H Top Hole coordinates are  
 N: 311,624.82' Latitude: 39°20'55.06"  
 E: 1,640,967.55' Longitude: 80°46'10.57"  
 Bottom Hole coordinates are  
 N: 302,294.65' Latitude: 39°19'23.21"  
 E: 1,643,567.23' Longitude: 80°45'35.81"  
**UTM Zone 17, NAD 1983**  
 Top Hole Coordinates Bottom Hole Coordinates  
 N: 4,355,500.00m N: 4,352,670.773m  
 E: 519,867.200m E: 520,706.611m  
 Plat orientation and corner and well references are based upon the grid north meridian.  
 Well location references are based upon the magnetic meridian.

ID	TM/Par	Owner	Bk / Pg	Acres
1	2/16	David & Lucy Mae Sparling	219/213	20.95
2	4/4.2	David & Lucy Mae Sparling	219/213	10.69
3	4/4	David & Lucy Mae Sparling	219/213	20.75
4	4/4.1	David & Lucy Mae Sparling	219/213	31.50
5	4/2	Scott Adams, Gregory Adams, David Adams, & Jennifer Adams McFall	282/181	0.90
6	4/11	Gary Lynn McMillan	195/237	7.19
7	4/19	Naomi Beagle, et al	AP19/594	33.25
8	4/20	Stella E. Spencer, et al	103/53	31.50
9	4/34.1	Larry Williams	260/226	0.53
10	8/1.1	Benjamin & Myrna Adams	169/160	5.08
11	8/15.1	Scott B. & Melissa L. Chumley	261/359	0.72
12	8/15	Robert Glenn & Shelly A. Fraley	239/262	26.53
13	8/7	Steven & Lu Ann McCloy	303/629	12.50
14	8/1.2	Richard Gregory Knight, et ux	179/275	1.331

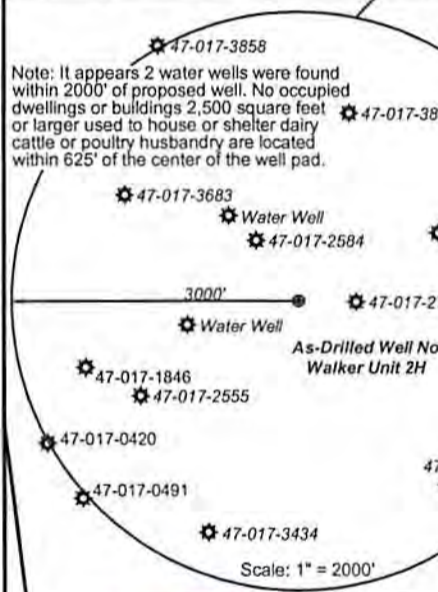

Top Hole Coordinates and As-drilled data and information was provided by Antero Resources Corporation, Allegheny Surveys Inc. (ASI) is not certifying the data and information provided. ASI is not responsible for any errors or inaccuracies with the data and information that has been provided.

I, the undersigned, hereby certify that this plat is correct to the best of my knowledge and belief and shows all the information required by law and the rules issued and prescribed by the Department of Environmental Protection.

*Bradley D. Miller*  
 Bradley D. Miller, P.S. 2167



FILE NO: 39-30-WU-14  
 DRAWING NO: 39-14 Walker 2H Well Plat  
 SCALE: 1" = 1500'  
 MINIMUM DEGREE OF ACCURACY: Submeter  
 PROVEN SOURCE OF ELEVATION: WVDOT, Harrisville, WV

**STATE OF WEST VIRGINIA**  
 DEPARTMENT OF ENVIRONMENTAL PROTECTION  
**OIL AND GAS DIVISION**

DATE: May 10 20 18  
 OPERATOR'S WELL NO. Walker Unit 2H  
 API WELL NO  
 47 - 017 - 06697  
 STATE COUNTY PERMIT

WELL TYPE:  OIL  GAS  LIQUID INJECTION  WASTE DISPOSAL  
 (IF GAS) PRODUCTION:  STORAGE  DEEP  SHALLOW  
 LOCATION: ELEVATION: 1229' As Drilled WATERSHED: Headwaters Middle Island Creek QUADRANGLE: West Union  
 DISTRICT: West Union COUNTY: Doddridge  
 SURFACE OWNER: Yvonne Foster Acreage: 125.48  
 ROYALTY OWNER: Ed Broome Inc, Memorandum of Oil & Gas Lease; Theda Dolores Price Davis, Heir of Esta Faye Price, OGL; Joseph Freeman, et ux; Paul Spencer; Elma Lipscomb, et vic; Larry Williams Lease No: 20234 Acreage: 72; 60; 33.25; 96  
 PROPOSED WORK:  DRILL  CONVERT  DRILL DEEPER  FRACTURE OR STIMULATE  PLUG OFF OLD FORMATION  
 PERFORATE NEW FORMATION  OTHER PHYSICAL CHANGE IN WELL (SPECIFY) As-Drilled  
 PLUG AND ABANDON  CLEAN OUT AND REPLUG TARGET FORMATION: Marcellus Shale ESTIMATED DEPTH: 7,022' TVD 16,564' MD

WELL OPERATOR: Antero Resources Corporation DESIGNATED AGENT: Dianna Stamper - CT Corporation System  
 ADDRESS: 1615 Wynkoop ADDRESS: 5400 D Big Tyler Road  
 Denver, CO 80202 Charleston, WV 25313