

LATITUDE 39°20'00" 2,995'  
 8,383' TO BOTTOM HOLE  
 LATITUDE 39°22'30"

Antero Resources Corporation  
 Well No. California Unit 1H  
 47-017-06796

AS DRILLED DATA:  
 WELL 1H TOP HOLE INFORMATION:  
 N: 295,052ft E: 1,619,701ft  
 LAT: 39°18'08.21" LON: 80°50'38.10"  
 BOTTOM HOLE INFORMATION:  
 N: 308,772ft E: 1,614,516ft  
 LAT: 39°20'23.04" LON: 80°50'38.10"  
 WEST VIRGINIA COORDINATE SYSTEM OF 1927 NORTH ZONE. ZONE WAS DERIVED FROM MEASUREMENTS TAKEN WITH TRIMBLE GEOXT SUBMETER MAPPING GRADE GPS UNIT. PLAT ORIENTATION, CORNER, AND WELL REFERENCE TIE LINES ARE BASED ON GRID NORTH.

(NAD) 83 (UTM) ZONE 17 COORDS:  
 WELL 1H TOP HOLE INFORMATION:  
 N: 4,350,343m E: 513,473m  
 BOTTOM HOLE INFORMATION:  
 N: 4,354,496m E: 511,823m

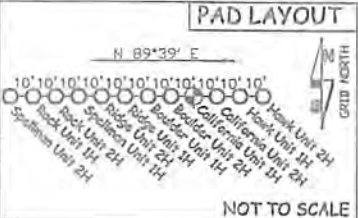

WV NORTH ZONE GRID NORTH

LONGITUDE 80°50'00"

LONGITUDE 80°50'00"

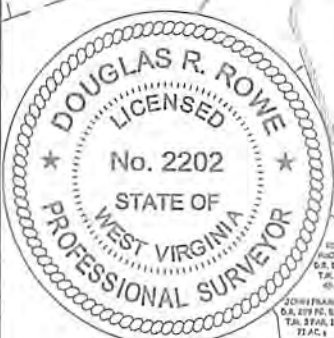

- NOTE
1. NO OCCUPIED DWELLINGS OR BUILDINGS TWO THOUSAND FIVE HUNDRED (2,500) SQUARE FEET OR LARGER USED TO HOUSE OR SHELTER DAIRY CATTLE OR POULTRY HUSBANDRY ARE LOCATED WITHIN SIX HUNDRED TWENTY-FIVE (625) FEET OF THE CENTER OF THE WELL PAD.
  2. TOP HOLE DATA SHOWN HEREON WAS PROVIDED BY ALLEGHENY SURVEYS, INC.
  3. AS DRILLED DATA WAS PROVIDED BY ANTERO RESOURCES CORPORATION.
  4. WLS IS NOT CERTIFYING THE DATA AND INFORMATION PROVIDED LISTED IN NOTES 2 AND 3, ONLY THE RELATIONSHIP TO THE DATA AND INFORMATION PROVIDED TO THE LEASE BOUNDARIES.
  5. WLS IS BY NO MEANS RESPONSIBLE FOR ANY ERRORS OR INACCURACIES WITH THE DATA AND INFORMATION THAT HAS BEEN PROVIDED.



JOB # 16-059WA  
 DRAWING # CALIFORNIA1HAD  
 SCALE 1" = 2000'  
 MINIMUM DEGREE OF ACCURACY SUBMETER  
 PROVEN SOURCE OF ELEV. SUBMETER MAPPING GRADE GPS

I, THE UNDERSIGNED, HEREBY CERTIFY THAT THIS PLAT IS CORRECT TO THE BEST OF MY KNOWLEDGE AND BELIEF AND SHOWS ALL THE INFORMATION REQUIRED BY LAW AND THE RULES ISSUED AND PERSCRIBED BY THE DEPARTMENT OF ENVIRONMENTAL PROTECTION.



STATE OF WEST VIRGINIA, DIVISION OF ENVIRONMENTAL PROTECTION, OFFICE OF OIL AND GAS  
 WILLOW LAND SURVEYING PLLC  
 220 MASONIC AVE. PENNSBORO WEST VIRGINIA 26415

LEGEND  
 - - - - - Surface Owner Boundary Lines +/-  
 - - - - - Interior Surface Tracts +/-  
 - - - - - Existing Fence  
 - - - - - As Drilled Well Path  
 DOUGLAS R. ROWE P.S. 2202

DATE 07/17/18  
 OPERATOR'S WELL# CALIFORNIA UNIT #1H

STATE OF WEST VIRGINIA DEPARTMENT OF ENERGY DIVISION OF OIL AND GAS  
 WELL TYPE: OIL GAS X LIQUID INJECTION WASTE DISPOSAL  
 (IF "GAS") PRODUCTION X STORAGE DEEP SHALLOW X  
 LOCATION: ELEVATION 1,135.5' AS BUILT WATERSHED HEADWATERS MIDDLE ISLAND CREEK  
 QUADRANGLE WEST UNION 7.5' DISTRICT CENTRAL COUNTY DODDRIDGE  
 SURFACE OWNER JEFFREY K. JONES SR. ET AL ACREAGE 77.32 ACRES +/-  
 OIL & GAS ROYALTY OWNER DONALD L. PIGGOTT; NELL ALLEN; RICHARD F. MCCULLOUGH ET UX; LEASE ACREAGE 81 AC±; 176 AC±; 63.5 AC±;  
 JOHN STAMPER ET UX; CARROLL SHEPHERD; CARROLL E. SHEPHERD ET UX; RICHARD MCCULLOUGH; MICHAEL KEE SHEPHERD; RICHARD MCCULLOUGH; RICHARD MCCULLOUGH ET UX; 58 AC±; 17.18 AC±; 26 AC±; 15 AC±; 12.025 AC±; 29 AC±;  
 EUGENE R. WALTON; KATHERINE MONTGOMERY; J.A. EXLINE ET UX; NATHAN GAIN ET AL; N.M. WELCH HEIRS 137 AC±; 26.13 AC±; 60 AC±; 278 AC±; 95 AC±  
 PROPOSED WORK: DRILL CONVERT DRILL DEEPER REDRILL FRACTURE OR STIMULATE  
 PLUG OFF OLD FORMATION PERFORATE NEW FORMATION OTHER PHYSICAL CHANGE IN WELL  
 (SPECIFY) AS DRILLED PLUG & ABANDON CLEAN OUT & REPLUG  
 TARGET FORMATION MARCELLUS ESTIMATED DEPTH 6,589' TVD 21,348' MD  
 WELL OPERATOR ANTERO RESOURCES CORP. DESIGNATED AGENT DIANNA STAMPER - CT CORPORATION SYSTEM  
 ADDRESS 1615 WYNKOOP STREET ADDRESS 5400 D BIG TYLER ROAD  
 DENVER, CO 80202 CHARLESTON, WV 25313

API WELL # 47-017-06796  
 STATE COUNTY PERMIT  
 COUNTY NAME PERMIT