

LATITUDE 39°20'00" ————— 3,005'

7,284' TO BOTTOM HOLE —————
 LATITUDE 39°20'00"

LONGITUDE 80°50'00" ————— 3,154' TO BOTTOM HOLE
 1,310'

LONGITUDE 80°50'00"

Antero Resources Corporation
Well No. Boulder Unit 2H
47-017-06799

AS DRILLED DATA:
WELL 2H TOP HOLE INFORMATION:
 N: 295,052ft E: 1,619,691ft
 LAT: 39°18'08.21" LON: 80°50'38.23"
BOTTOM HOLE INFORMATION:
 N: 303,271ft E: 1,615,533ft
 LAT: 39°19'28.83" LON: 80°48'27.89"
WEST VIRGINIA COORDINATE SYSTEM OF 1927 NORTH ZONE, ZONE WAS DERIVED FROM MEASUREMENTS TAKEN WITH TRIMBLE GEOXT SUBMETER MAPPING GRADE GPS UNIT. PLAT ORIENTATION, CORNER, AND WELL REFERENCE TIE LINES ARE BASED ON GRID NORTH.

(NAD) 83 (UTM) ZONE 17 COORDS:
WELL 2H TOP HOLE INFORMATION:
 N: 4,350,343m E: 513,469m
BOTTOM HOLE INFORMATION:
 N: 4,352,826m E: 512,161m

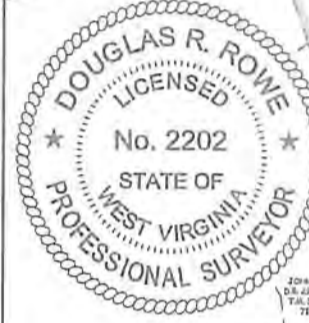
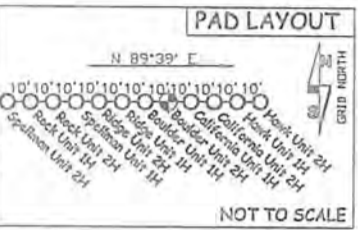

- NOTE**
1. NO OCCUPIED DWELLINGS OR BUILDINGS TWO THOUSAND FIVE HUNDRED (2,500) SQUARE FEET OR LARGER USED TO HOUSE OR SHELTER DAIRY CATTLE OR POULTRY HUSBANDRY ARE LOCATED WITHIN SIX HUNDRED TWENTY-FIVE (625) FEET OF THE CENTER OF THE WELL PAD.
 2. TOP HOLE DATA SHOWN HEREON WAS PROVIDED BY ALLEGHENY SURVEYS, INC.
 3. AS DRILLED DATA WAS PROVIDED BY ANTERO RESOURCES CORPORATION.
 4. WLS IS NOT CERTIFYING THE DATA AND INFORMATION PROVIDED LISTED IN NOTES 2 AND 3, ONLY THE RELATIONSHIP TO THE DATA AND INFORMATION PROVIDED TO THE LEASE BOUNDARIES.
 5. WLS IS BY NO MEANS RESPONSIBLE FOR ANY ERRORS OR INACCURACIES WITH THE DATA AND INFORMATION THAT HAS BEEN PROVIDED.



JOB # 16-059WA
DRAWING # BOULDER2HAD
SCALE 1" = 2000'
MINIMUM DEGREE OF ACCURACY SUBMETER
PROVEN SOURCE OF ELEV. SUBMETER MAPPING GRADE GPS
STATE OF WEST VIRGINIA DEPARTMENT OF ENERGY DIVISION OF OIL AND GAS
WELL TYPE: OIL ___ GAS X LIQUID INJECTION ___ WASTE DISPOSAL ___
(IF "GAS") PRODUCTION ___ STORAGE ___ DEEP ___ SHALLOW X
LOCATION: ELEVATION 1,135.5 AS BUILT WATERSHED HEADWATERS MIDDLE ISLAND CREEK
QUADRANGLE WEST UNION 7.5 **DISTRICT** CENTRAL **COUNTY** DODDRIDGE
SURFACE OWNER JEFFREY K. JONES SR. ET AL **ACREAGE** 77.32 ACRES +/-
OIL & GAS ROYALTY OWNER DONALD L. PIGGOTT; C. BURKE MORRIS ET AL; NELL ALLEN; RICHARD F. MCCULLOUGH ET UX; JOHN STATLER ET UX; RICHARD MCCULLOUGH; STEVEN SAUNDERS ET UX; RICHARD MCCULLOUGH F UX; EUGENE R. WALTON **LEASE ACREAGE** 81 AC±; 94 AC±; 176 AC±; 63.5 AC±; 56 AC±; 26 AC±; 10 AC±; 29 AC±; 137 AC±
PROPOSED WORK: DRILL ___ CONVERT ___ DRILL DEEPER ___ REDRILL ___ FRACTURE OR STIMULATE ___
PLUG OFF OLD FORMATION ___ PERFORATE NEW FORMATION ___ OTHER PHYSICAL CHANGE IN WELL (SPECIFY) AS DRILLED **PLUG & ABANDON** ___ **CLEAN OUT & REPLUG** ___
TARGET FORMATION MARCELLUS **ESTIMATED DEPTH** 6,613' TVD 15,805' MD
WELL OPERATOR ANTERO RESOURCES CORP. **DESIGNATED AGENT** DIANNA STAMPER - CT CORPORATION SYSTEM
ADDRESS 1615 WYNKOOP STREET **ADDRESS** 5400 D BIG TYLER ROAD
FORM WW-6 **DENVER, CO 80202** **CHARLESTON, WV 25313**

I, THE UNDERSIGNED, HEREBY CERTIFY THAT THIS PLAT IS CORRECT TO THE BEST OF MY KNOWLEDGE AND BELIEF AND SHOWS ALL THE INFORMATION REQUIRED BY LAW AND THE RULES ISSUED AND PERSCRIBED BY THE DEPARTMENT OF ENVIRONMENTAL PROTECTION.

STATE OF WEST VIRGINIA, DIVISION OF ENVIRONMENTAL PROTECTION, OFFICE OF OIL AND GAS

WILLOW LAND SURVEYING PLLC
 220 MASONIC AVE. PENNSBORO
 WEST VIRGINIA 26415

LEGEND

- Surface Owner Boundary Lines +/-
- Interior Surface Tracts +/-
- Proposed Well Path
- As Drilled Well Path

D. Rowe
DOUGLAS R. ROWE P.S. 2202

DATE 07/17/18
OPERATOR'S WELL # BOULDER UNIT #2H
API WELL # 47 - 017 - 06799
STATE COUNTY PERMIT

COUNTY NAME PERMIT