

**Antero Resources
Well No. Addie Unit 2H
As-Drilled Plat
Antero Resources
Corporation**

Leases
A J.C. Smith, Agent for Jacob Smith Estate
B R.E. McCabe, Jr. Trustee & Brooke F. McCabe Jr., Agent

Bearing	Dist.
L1 S 65°58' W	488.6'
L2 S 47°39' W	661.3'
L3 S 76°07' E	1099.9'
L4 N 65°40' W	981.5'

Note: It appears 13 water wells, 7 springs and a pond were found within 2000' of proposed well. No occupied dwellings or buildings 2,500 square feet or larger used to house or shelter dairy cattle or poultry husbandry are located within 625' of the center of the well pad.

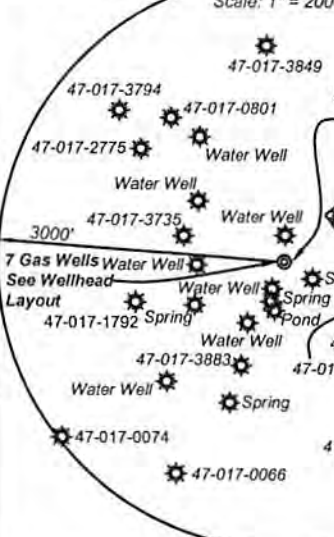

ID	TM/Par	Owner	Bk / Pg	Acres
1	3/17.1	Antero Resources Corp.	358/562	9.90
2	3/21.1	Charles & Carol Cottrill	256/479	3.00
3	3/17	Antero Resources Corp.	349/553	25.90
4	3/6	Thomas R. Prock	252/308	25.00
5	3/24	Charles L. & Carol Cottrill	256/474	2.45
6	1/7	Perry Gains & Aaron Gain	329/229	20.0
7	23/5	Richard/Lisa Hendrickson	334/209	0.25
8	3/21	Addie Marie Leadmon	250/84	19.84
9	1/10	Judith Ann Bagley	WB 32/342	10.09
10	23/3.1	Kathryn McNulty	323/206	50.18

5,679' to Bottom Hole

4,169' to Top Hole

LATITUDE 39 - 22 - 30

LONGITUDE 80 - 47 - 30

Top Hole Coordinates verified by survey grade GPS. As-drilled data and information was provided by Antero Resources Corporation. Allegheny Surveys Inc. (ASI) is not certifying the data and information provided. ASI is not responsible for any errors or inaccuracies with the data and information that has been provided.

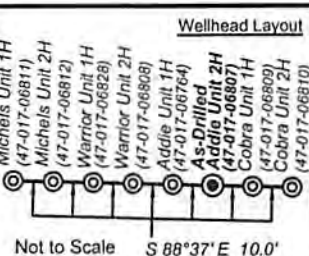

Notes:
West Virginia Coordinate System of 1927, North Zone based upon Differential GPS Measurements.
Well No. Addie Unit 2H Top Hole coordinates are
N: 306,252.87" Latitude: 39°20'00.52"
E: 1,630,697.77" Longitude: 80°48'20.29"
Bottom Hole coordinates are
N: 313,896.95" Latitude: 39°21'15.85"
E: 1,629,187.84" Longitude: 80°48'40.93"
UTM Zone 17, NAD 1983
Top Hole Coordinates Bottom Hole Coordinates
N: 4,353,811.140m N: 4,356,132.238m
E: 516,765.809m E: 516,266.952m
Plat orientation and corner and well references are based upon the grid north meridian.
Well location references are based upon the magnetic meridian.

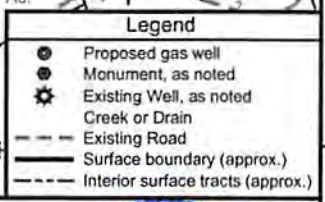

I, the undersigned, hereby certify that this plat is correct to the best of my knowledge and belief and shows all the information required by law and the rules issued and prescribed by the Department of Environmental Protection.

Bradley D. Miller
Bradley D. Miller, P.S. 2167



FILE NO: 55-30-WU-15
DRAWING NO: Addie 2H Well Plat As-Drilled
SCALE: 1" = 1200'
MINIMUM DEGREE OF ACCURACY: Submeter
PROVEN SOURCE OF ELEVATION: WVDOT, Harrisville, WV

STATE OF WEST VIRGINIA
DEPARTMENT OF ENVIRONMENTAL PROTECTION
OIL AND GAS DIVISION

DATE: June 7 20 18
OPERATOR'S WELL NO. Addie Unit 2H
API WELL NO
47 - 017 - 06807
STATE COUNTY PERMIT

WELL TYPE: OIL GAS LIQUID INJECTION WASTE DISPOSAL
(IF GAS) PRODUCTION: STORAGE DEEP SHALLOW
LOCATION: ELEVATION: 891' As-Drilled WATERSHED: Headwaters Middle Island Creek QUADRANGLE: West Union
DISTRICT: West Union LARRY P. SMITH; S.A. SMITH & C. BURKE MORRIS
SURFACE OWNER: Antero Resources Corp. VIRGINIA SUE GASTON
ROYALTY OWNER: R. E. McCabe, Jr. Trustee & Brooke F. McCabe, Jr, Agent; CORNA BUCK LEASE NO: ACREAGE: 29.57; 79
PROPOSED WORK: DRILL CONVERT DRILL DEEPER FRACTURE OR STIMULATE PLUG OFF OLD FORMATION
 PERFORATE NEW FORMATION OTHER PHYSICAL CHANGE IN WELL (SPECIFY) As-Drilled ACREAGE: 25.9 20; 25; 20; 53
 PLUG AND ABANDON CLEAN OUT AND REPLUG TARGET FORMATION: Marcellus Shale ESTIMATED DEPTH: 6,460' TVD
ESTIMATED DEPTH: 14,749' MD

WELL OPERATOR: Antero Resources Corporation DESIGNATED AGENT: Dianna Stamper - CT Corporation System
ADDRESS: 1615 Wynkoop Street ADDRESS: 5400 D Big Tyler Road
Denver, CO 80202 Charleston, WV 25313