

LATITUDE 39°15'00" TO BOTTOM HOLE  
LATITUDE 39°15'00"

LONGITUDE 80°52'30" TO BOTTOM HOLE  
LONGITUDE 80°52'30"

4,801' TO BOTTOM HOLE  
13,858' TO BOTTOM HOLE  
LONGITUDE 80°52'30"

Antero Resources Corporation  
Well No. Cool Unit 1H

LINE	BEARING	DISTANCE
L1	S 77°58' E	1375.64'
L2	S 76°33' E	1804.51'
L3	S 75°04' E	1554.60'
L4	S 65°46' E	1596.34'
L5	S 64°01' E	1381.04'
L6	S 63°52' E	1636.75'
L7	S 60°37' E	1513.41'
L8	S 56°06' E	1345.06'
L9	S 51°10' E	1175.91'
L10	S 48°41' E	1020.78'
L11	S 44°24' E	1202.08'
L12	S 41°37' E	1125.94'
L13	S 32°54' E	947.63'
L14	S 28' E	1151.29'
L15	S 17°06' E	1113.08'
L16	S 08°23' E	1115.22'
L17	S 01°58' W	1414.85'
L18	S 05°17' W	1426.29'
L19	S 23°05' W	1806.45'
L20	S 42°21' W	1288.64'
L21	S 67°20' W	1416.97'
L22	S 73°44' W	1425.05'

A - STANLEY WEBB D.B. 282 PG. 633 T.J. 15 PAR. 022 0.75 AC.  
 B - STANLEY WEBB D.B. 172 PG. 322 T.J. 15 PAR. 023 4.03 AC.  
 C - STEAN WEBB D.B. 192 PG. 327 T.J. 15 PAR. 027 2.11 AC.  
 D - SUEAN WEBB D.B. 192 PG. 327 T.J. 15 PAR. 024 0.47 AC.  
 E - ROBERT F. HAROLD ET AL D.B. 249 PG. 494 T.J. 15 PAR. 029 1 AC.  
 F - EDWARD WEBB ET AL D.B. 229 PG. 169 T.J. 15 PAR. 028 1.88 AC.  
 G - DARLENE D. WIDENHILLER ET AL D.B. 246 PG. 540 T.J. 15 PAR. 032 0.12 AC.  
 H - JAMES E. WEBB D.B. 273 PG. 443 T.J. 15 PAR. 0215 0.26 AC.

AS DRILLED DATA:  
 WELL 1H TOP HOLE INFORMATION:  
 N: 271,365ft E: 1,609,229ft  
 LAT: 39°14'12.55" LON: 80°52'46.68"  
 BOTTOM HOLE INFORMATION:  
 N: 262,266ft E: 1,611,905ft  
 LAT: 39°12'43.03" LON: 80°52'10.91"  
 WEST VIRGINIA COORDINATE SYSTEM OF 1927 NORTH ZONE ZONE WAS DERIVED FROM MEASUREMENTS TAKEN WITH TRIMBLE GEOXT SUBMETER MAPPING GRADE GPS UNIT. PLAT ORIENTATION, CORNER, AND WELL REFERENCE TIE LINES ARE BASED ON GRID NORTH.

(NAD) 83 (UTM) ZONE 17 COORDS:  
 WELL 1H TOP HOLE INFORMATION:  
 N: 4,343,073m E: 510,403m  
 BOTTOM HOLE INFORMATION:  
 N: 4,340,315m E: 511,264m



WV NORTH ZONE GRID NORTH

03/08/2019

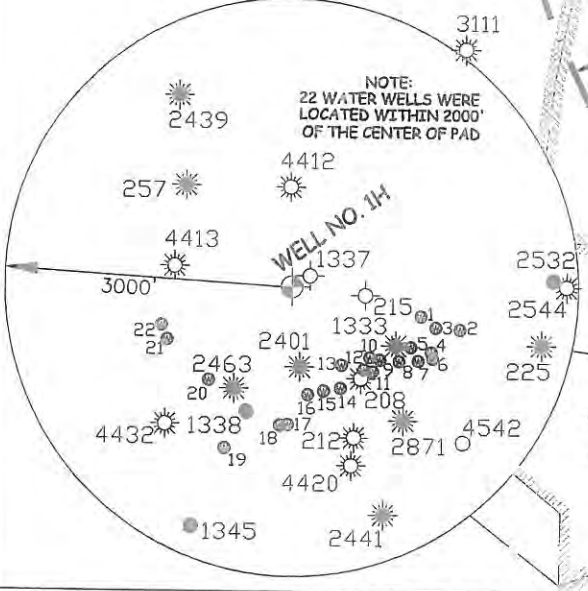

NOTE:  
 22 WATER WELLS WERE LOCATED WITHIN 2000' OF THE CENTER OF PAD

PAD LAYOUT

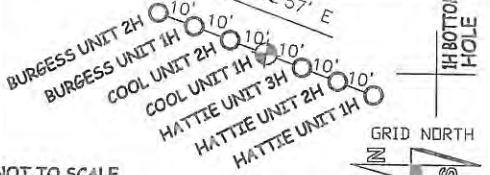

NOT TO SCALE

**LEGEND**

- Surface Owner Boundary Lines +/-
- Interior Surface Tracts +/-
- Proposed Well Path
- As Drilled Well Path

DOUGLAS R. ROWE P.S. 2202

DATE 01/29/19

OPERATOR'S WELL# COOL UNIT 1H

API WELL # 47 - 017 - 06833

STATE COUNTY PERMIT

**NOTES**

- NO OCCUPIED DWELLINGS OR BUILDINGS TWO THOUSAND FIVE HUNDRED (2,500) SQUARE FEET OR LARGER USED TO HOUSE OR SHELTER DAIRY CATTLE OR POULTRY HUSBANDRY ARE LOCATED WITHIN SIX HUNDRED TWENTY-FIVE (625) FEET OF THE CENTER OF THE WELL PAD.
- TOP HOLE DATA SHOWN HEREON WAS PROVIDED BY ALLEGHENY SURVEYS, INC.
- AS DRILLED DATA WAS PROVIDED BY ANTERO RESOURCES CORPORATION.
- WLS IS NOT CERTIFYING THE DATA AND INFORMATION PROVIDED LISTED IN NOTES 2 AND 3, ONLY THE RELATIONSHIP TO THE DATA AND INFORMATION PROVIDED TO THE LEASE BOUNDARIES.
- WLS IS BY NO MEANS RESPONSIBLE FOR ANY ERRORS OR INACCURACIES WITH THE DATA AND INFORMATION THAT HAS BEEN PROVIDED.

I THE UNDERSIGNED, HEREBY CERTIFY THAT THIS PLAT IS CORRECT TO THE BEST OF MY KNOWLEDGE AND BELIEF AND SHOWS ALL THE INFORMATION REQUIRED BY LAW AND THE RULES ISSUED AND PRESCRIBED BY THE DEPARTMENT OF ENVIRONMENTAL PROTECTION.



STATE OF WEST VIRGINIA, DIVISION OF ENVIRONMENTAL PROTECTION, OFFICE OF OIL AND GAS

WILLOW LAND SURVEYING PLLC  
 220 MASONIC AVE. PENNSBORO WEST VIRGINIA 26415

STATE OF WEST VIRGINIA DEPARTMENT OF ENERGY DIVISION OF OIL AND GAS WELL TYPE: OIL GAS X LIQUID INJECTION WASTE DISPOSAL (IF "GAS") PRODUCTION X STORAGE DEEP SHALLOW X LOCATION: ELEVATION 1,095' AS BUILT WATERSHED NORTH FORK HUGHES RIVER QUADRANGLE PULLMAN 7.5' (TOP HOLE) OXFORD 7.5' (BOTTOM HOLE) DISTRICT CENTRAL COUNTY DODDRIDGE SURFACE OWNER STANLEY WEBB ET AL ACREAGE 59.18 ACRES +/- OIL & GAS ROYALTY OWNER RALPH LEGGETT ET UX; HAROLD BURGESS ET UX; HAROLD BURGESS ET UX; GUSSIE LEGGETT; SUE ELLEN ABERNATHY; S. BYRL ROSS ET UX; RUSSELL GRAY ET AL LEASE ACREAGE 75 ACRES +/-; 43.5 ACRES +/-; 29 ACRES +/-; 169 ACRES +/-; 65 ACRES +/-; 195 ACRES +/-; 225 ACRES +/- PROPOSED WORK: DRILL CONVERT DRILL DEEPER REDRILL FRACTURE OR STIMULATE PLUG OFF OLD FORMATION PERFORATE NEW FORMATION OTHER PHYSICAL CHANGE IN WELL (SPECIFY) AS DRILLED PLUG & ABANDON CLEAN OUT & REPLUG TARGET FORMATION MARCELLUS ESTIMATED DEPTH 6,591' TVD 16,227' MD WELL OPERATOR ANTERO RESOURCES CORP. DESIGNATED AGENT DIANNA STAMPER ADDRESS 1615 WYNKOOP STREET ADDRESS CT CORPORATION SYSTEM 5400 D BIG TYLER ROAD CHARLESTON, WV 25313

FORM WW-6