

Notes:
 West Virginia Coordinate System of 1927, North Zone based upon Differential GPS Measurements.
 Well No. Jimmy Unit 3H Top Hole coordinates are
 N: 305,688.79' Latitude: 39°19'55.82"
 E: 1,636,850.15' Longitude: 80°47'01.90"
 Bottom Hole coordinates are
 N: 297,806.50' Latitude: 39°18'38.49"
 E: 1,640,906.12' Longitude: 80°46'08.87"
UTM Zone 17, NAD 1983
 Top Hole Coordinates Bottom Hole Coordinates
 N: 4,353,670.613m N: 4,351,289.904m
 E: 518,643.001m E: 519,918.711m
 Plat orientation and corner and well references are based upon the grid north meridian.
 Well location references are based upon the magnetic meridian.

- Legend**
- ⊙ Proposed gas well
 - ⊗ Found corner, as noted
 - Creek or Drain
 - Existing Road
 - Surface boundary (approx.)
 - Interior surface tracts (approx.)
 - ⊙ Existing well, as noted

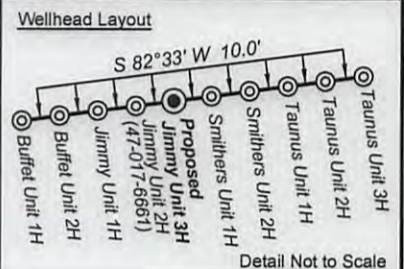

Tag	Par	Tax Map 4 Owner	Bk / Pg	Ac.
1	35	Matthew Alexander	276 / 12	5.89
2	29	Phillip S. Underwood Patricia Cooper Katherine S. Sisler	WB 51/709	0.46
3	24	Karen Ann Smith	248 / 254	35.34
4	23	Christian Church	49/71 & 72	0.85
5	30	Kathryn J. Sisler, et al	211/302	30.50
6	14.1	John M. & Andrea Fitzgerald	282/418	27.21

(⊙) Denotes Location of Well on United States Topographical Maps

	Bearing	Dist.
L1	N 64°22' E	956.1'
L2	N 88°46' E	746.8'
L3	N 50°56' E	989.0'
L4	S 65°25' E	1970.2'
L5	N 69°52' W	1212.7'

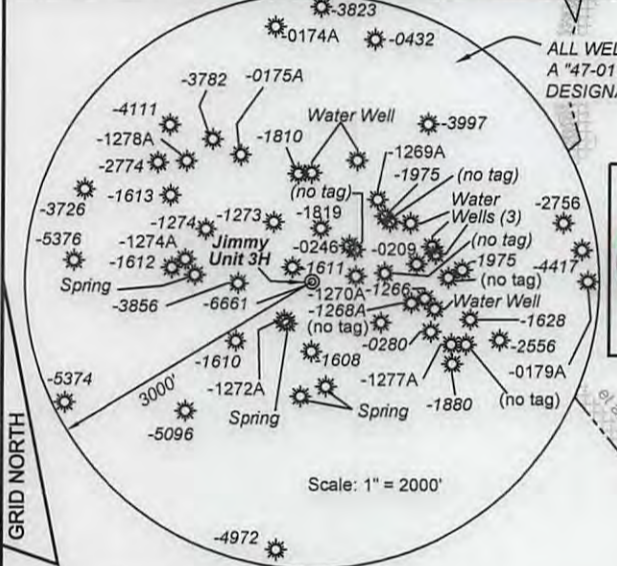

I, the undersigned, hereby certify that this plat is correct to the best of my knowledge and belief and shows all the information required by law and the rules issued and prescribed by the Department of Environmental Protection.

Kenneth J. Plum
Kenneth J. Plum, P.S. 2216

FILE NO: 50-30-WU-14
 DRAWING NO: Jimmy Unit 3H Plat 11-16
 SCALE: 1" = 1200'
 MINIMUM DEGREE OF ACCURACY: Submeter
 PROVEN SOURCE OF ELEVATION: WVDOT, Harrisville, WV

STATE OF WEST VIRGINIA
 DEPARTMENT OF ENVIRONMENTAL PROTECTION
OIL AND GAS DIVISION

DATE: March 22 2017
 OPERATOR'S WELL NO: Jimmy Unit 3H
 API WELL NO: 47 - 017 - 06839
 STATE COUNTY PERMIT

WELL TYPE: OIL GAS LIQUID INJECTION WASTE DISPOSAL
 (IF GAS) PRODUCTION: STORAGE DEEP SHALLOW
 LOCATION: ELEVATION: Existing Grade 1076' Proposed Grade 1065' WATERSHED: Headwaters Middle Island Creek QUADRANGLE: West Union
 DISTRICT: West Union COUNTY: Doddridge
 SURFACE OWNER: John Paul Strickling, et al B.J. (Sally) Underwood Joseph Freeman, et ux Freeman P. Smith, et ux
 ROYALTY OWNER: Charles C. Smith, et al; William Ashburn Heirs; William A. Farr LEASE NO: ACREAGE: 357.75 31; 450; 600
 PROPOSED WORK: DRILL CONVERT DRILL DEEPER FRACTURE OR STIMULATE PLUG OFF OLD FORMATION
 PERFORATE NEW FORMATION OTHER PHYSICAL CHANGE IN WELL (SPECIFY) 7,100' TVD
 PLUG AND ABANDON CLEAN OUT AND REPLUG TARGET FORMATION: Marcellus Shale ESTIMATED DEPTH: 17,300 MD

WELL OPERATOR: Antero Resources Corporation DESIGNATED AGENT: Dianna Stamper - CT Corporation System
 ADDRESS: 1615 Wynkoop Street ADDRESS: 5400 D Big Tyler Road
 Denver, CO 80202 Charleston, WV 25313

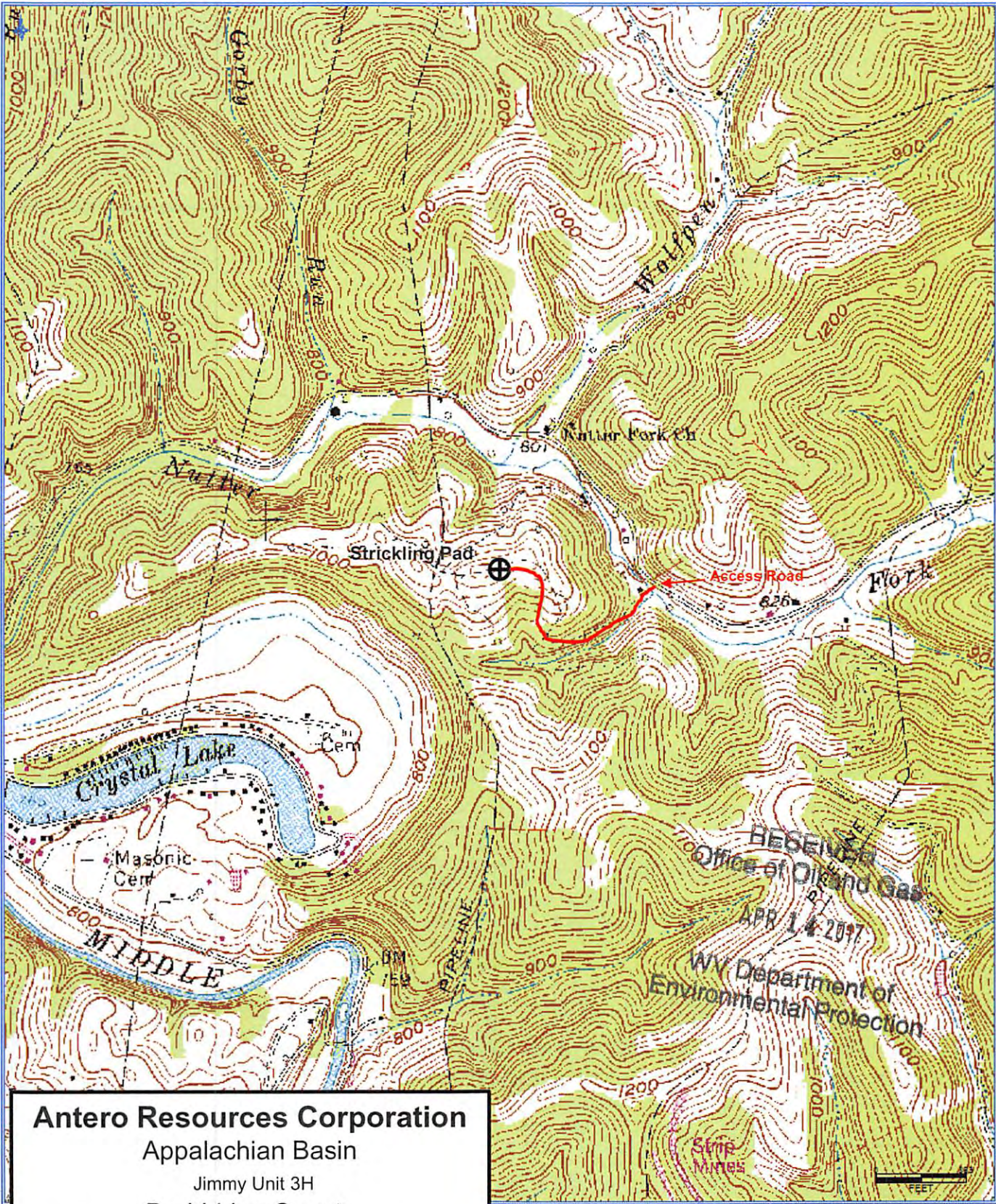

Antero Resources Corporation
Appalachian Basin
Jimmy Unit 3H
Doddridge County

Quadrangle: West Union
Watershed: Headwaters Middle Island Creek
District: West Union
Date: 9-09-2014

4701706830

07/14/2017