

9,553' to Top Hole

2,242' to Bottom Hole

BTM HOLE LATITUDE 39 - 22 - 30

TOP HOLE LATITUDE 39 - 20 - 00

BTM HOLE LONGITUDE 80 - 47 - 30

TOP HOLE LONGITUDE 80 - 45 - 00

284' to Top Hole

6,502' to Bottom Hole

**Antero Resources**  
**Well No. Taurus Unit 1H**  
**As-Drilled Plat**  
**Antero Resources Corporation**

Top Hole Coordinates, as-drilled data and information was provided by Antero Resources Corporation. Allegheny Surveys Inc. (ASI) is not certifying the data and information provided. ASI is not responsible for any errors or inaccuracies with the data and information that has been provided.

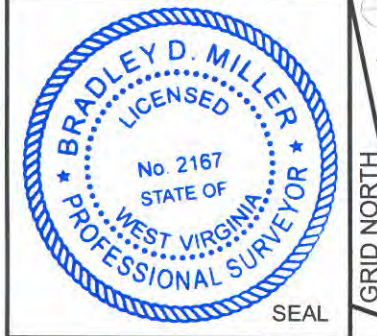

**Legend**

- ⊙ Proposed gas well
- ⊗ Found corner, as noted
- Creek or Drain
- Existing Road
- Surface boundary (approx.)
- Interior surface tracts (approx.)
- ☀ Existing well, as noted

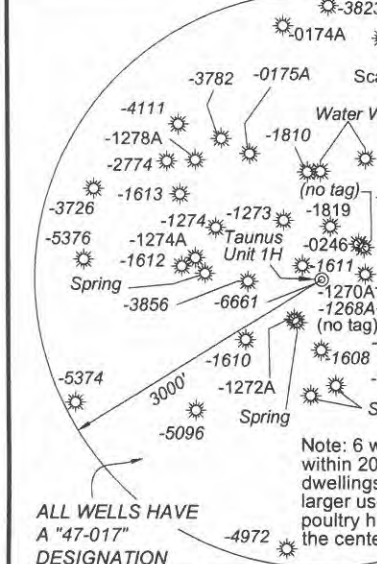

**Notes:**  
**West Virginia Coordinate System of 1927, North Zone based upon Differential GPS Measurements.**  
 Well No. Taurus Unit 1H Top Hole coordinates are  
 N: 305,692.37' Latitude: 39°19'55.86"  
 E: 1,636,879.81' Longitude: 80°47'01.52"  
 Bottom Hole coordinates are  
 N: 314,816.00' Latitude: 39°21'25.42"  
 E: 1,632,624.10' Longitude: 80°47'57.36"  
**UTM Zone 17, NAD 1983**  
 Top Hole Coordinates Bottom Hole Coordinates  
 N: 4,353,671.855m N: 4,356,429.725m  
 E: 518,652.018m E: 517,309.140m  
 Plat orientation and corner and well references are based upon the grid north meridian. Well location references are based upon the magnetic meridian.

**Leases**

A	Jeffrey W. Smith Lease
B	Sam Horton Lease
C	Madeline Williams, et al Lease
D	Madeline Williams, et al Lease
E	Lawrence R. Weekly Lease

ID	TMPar	Owner	Bk/Pg	Acres
1	1/9	Jeffrey Lee & Beth Ann Myer	227/1	1
2	1/6.1	James M. Friend, et al	241/281	0.88
3	2/8	Lawrence R. Weekly	WB 40/120	1.03
4	2/4.3	Robert B. & Mary E. Simpson	152/657	0.25

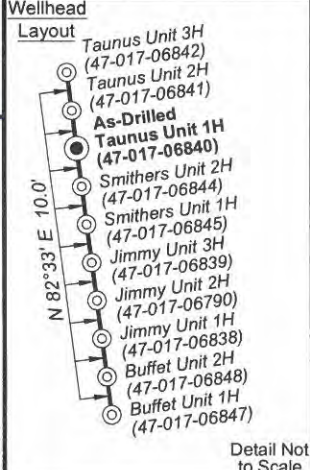

I, the undersigned, hereby certify that this plat is correct to the best of my knowledge and belief and shows all the information required by law and the rules issued and prescribed by the Department of Environmental Protection.

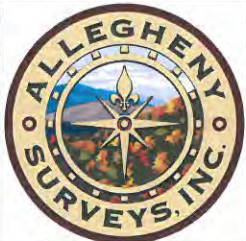

Bearing	Dist.
L1 N 88°33' E	776.7'
L2 S 84°35' W	441.5'
L3 S 54°28' E	255.4'
L4 N 69°12' W	1186.2'

FILE NO: 43-30-WU-14  
 DRAWING NO: Taurus 1H As-Drilled Plat  
 SCALE: 1" = 1200'  
 MINIMUM DEGREE OF ACCURACY: Submeter  
 PROVEN SOURCE OF ELEVATION: WVDOT, Harrisville, WV

**STATE OF WEST VIRGINIA**  
 DEPARTMENT OF ENVIRONMENTAL PROTECTION  
**OIL AND GAS DIVISION**

DATE: December 27 2018  
 OPERATOR'S WELL NO. Taurus Unit 1H  
**API WELL NO**  
 47 - 017 - 06840  
 STATE COUNTY PERMIT

WELL TYPE:  OIL  GAS  LIQUID INJECTION  WASTE DISPOSAL  
 (IF GAS) PRODUCTION:  STORAGE  DEEP  SHALLOW

LOCATION: ELEVATION: As-Built - 1065' WATERSHED: Headwaters Middle Island Creek QUADRANGLE: West Union  
 DISTRICT: West Union COUNTY: Doddridge

SURFACE OWNER: John Paul Strickling, et al Mary Haught Post, et al; Elsie Smith, et al; Freeman P. Smith, et al; Madeline Williams, et al ACREAGE: 357.75 23  
 ROYALTY OWNER: Joseph Freeman, et ux; W. F. Smith, et al; Carl W. Ash, et ux LEASE NO: ACREAGE: 125; 368; 63.75; 600 20.3; 64

PROPOSED WORK:  DRILL  CONVERT  DRILL DEEPER  FRACTURE OR STIMULATE  PLUG OFF OLD FORMATION  
 PERFORATE NEW FORMATION  OTHER PHYSICAL CHANGE IN WELL (SPECIFY) As-Drilled  
 PLUG AND ABANDON  CLEAN OUT AND REPLUG TARGET FORMATION: Marcellus Shale ESTIMATED DEPTH: 6,687' TVD 16,997' MD

WELL OPERATOR: Antero Resources Corporation DESIGNATED AGENT: Dianna Stamper - CT Corporation System  
 ADDRESS: 1615 Wynkoop Street ADDRESS: 5400 D Big Tyler Road  
 Denver, CO 80202 Charleston, WV 25313