

Notes:
West Virginia Coordinate System of 1927, North Zone based upon Differential GPS Measurements.
 Well No. Buffett Unit 2H Top Hole coordinates are
 N: 305,684.93" Latitude: 39°19'55.78"
 E: 1,636,820.28" Longitude: 80°47'02.28"
 Bottom Hole coordinates are
 N: 296,096.98" Latitude: 39°18'21.35"
 E: 1,639,164.03" Longitude: 80°46'30.72"
UTM Zone 17, NAD 1983
 Top Hole Coordinates Bottom Hole Coordinates
 N: 4,353,669.285m N: 4,350,760.228m
 E: 518,633.920m E: 519,396.671m
 Plat orientation and corner and well references are based upon the grid north meridian.
 Well location references are based upon the magnetic meridian.

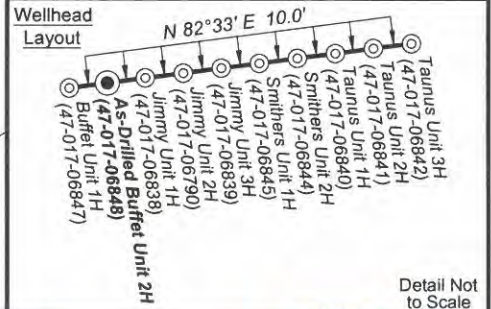

(+) Denotes Location of Well on United States Topographical Maps

	Bearing	Dist.
L1	N 89°02' E	717.0'
L2	N 04°10' W	728.1'
L3	S 64°57' E	1944.7'
L4	N 70°30' W	1239.5'

Top Hole Coordinates, As-drilled data and information was provided by Antero Resources Corporation. Allegheny Surveys Inc. (ASI) is not certifying the data and information provided. ASI is not responsible for any errors or inaccuracies with the data and information that has been provided.

Legend

- ⊙ Proposed gas well
- ⊗ Found corner, as noted
- - - Creek or Drain
- - - Existing Road
- Surface boundary (approx.)
- - - Interior surface tracts (approx.)
- ☼ Existing well, as noted

Tag	TM/Par	Surface Owner	Bk / Pg	Ac.
1	4/35	Matthew Alexander	276 / 12	5.89
2	4/29	Phillip S. Underwood & Patricia Cooper & Katherine S. Sisler	WB 51/709	0.46
3	4/24	Karen Ann Smith	248 / 254	35.34
4	4/23	Christian Church	49/71 & 72	0.85
5	4/30	Kathryn J. Sisler, et al	211/302	30.50
6	4/14.1	John M. & Andrea Fitzgerald	282/418	27.21
7	7/32	CNG Transmission Corp.	110/195	2.44
8	7/15	WV Dept. of Tran. D.O.H.	262/617	1.26
9	7/17.3	Hope Gas Company	110/198	3.61
10	7/26.2	Monongahela Power Co.	187/658	3.29
11	7/28	Same Owners as Par. 27	WB 62/674	14.50
12	11/5	Same Owners as Par. 27	WB 62/674	2.19
13	7/26	Same Owners as Par. 27	WB 62/674	61.46

I, the undersigned, hereby certify that this plat is correct to the best of my knowledge and belief and shows all the information required by law and the rules issued and prescribed by the Department of Environmental Protection.

Bradley D. Miller
Bradley D. Miller, P.S. 2167

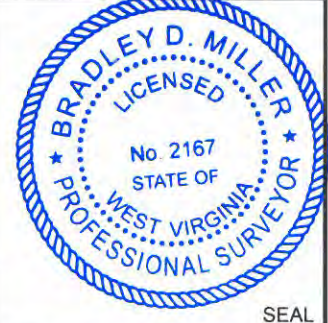
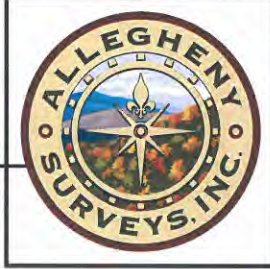

ALL WELLS HAVE A "47-017" DESIGNATION

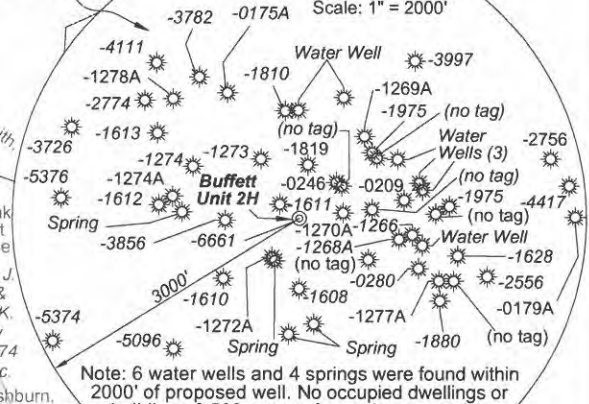

Note: 6 water wells and 4 springs were found within 2000' of proposed well. No occupied dwellings or buildings 2,500 square feet or larger used to house or shelter dairy cattle or poultry husbandry are located within 625' of the center of the well pad.

FILE NO: 51-30-WU-14
 DRAWING NO: Buffett 2H As-Drilled Plat
 SCALE: 1" = 1200'
 MINIMUM DEGREE OF ACCURACY: Submeter
 PROVEN SOURCE OF ELEVATION: WVDOT, Harrisville, WV

STATE OF WEST VIRGINIA
 DEPARTMENT OF ENVIRONMENTAL PROTECTION
OIL AND GAS DIVISION

DATE: December 28 2018
 OPERATOR'S WELL NO. Buffett Unit 2H
 API WELL NO. 47 - 017 - 06848
 STATE COUNTY PERMIT

WELL TYPE: OIL GAS LIQUID INJECTION WASTE DISPOSAL
 (IF GAS) PRODUCTION: STORAGE DEEP SHALLOW

LOCATION: ELEVATION: As-Built - 1065' WATERSHED: Headwaters Middle Island Creek QUADRANGLE: West Union
 DISTRICT: West Union COUNTY: Doddridge

SURFACE OWNER: John Paul Strickling, et al Claude L. Smith, et ux G. Frank Ash, et al; ACREAGE: 357.75 90; 600
 ROYALTY OWNER: Charles C. Smith, et al; Joseph Freeman, et ux; Ida F. Ford LEASE NO: ACREAGE: 140;114; 450

PROPOSED WORK: DRILL CONVERT DRILL DEEPER FRACTURE OR STIMULATE PLUG OFF OLD FORMATION
 PERFORATE NEW FORMATION OTHER PHYSICAL CHANGE IN WELL (SPECIFY) As-Drilled 6,758' TVD
 PLUG AND ABANDON CLEAN OUT AND REPLUG TARGET FORMATION: Marcellus Shale ESTIMATED DEPTH: 16,930' MD

WELL OPERATOR: Antero Resources Corporation DESIGNATED AGENT: Dianna Stamper - CT Corporation System
 ADDRESS: 1615 Wynkoop Street ADDRESS: 5400 D Big Tyler Road
 Denver, CO 80202 Charleston, WV 25313