

LATITUDE 39°20'00"

10,759'

LATITUDE 39°20'00" 8,297' TO BOTTOM HOLE

Antero Resources Corporation Well No. Peggy Unit 1H

NOTES:
WELL 1H TOP HOLE INFORMATION:
 N: 294,991ft E: 1,647,312ft
 LAT: 39°18'11.55" LON: 80°44'46.87"
BOTTOM HOLE INFORMATION:
 N: 292,523ft E: 1,649,741ft
 LAT: 39°17'47.49" LON: 80°44'15.54"
 WEST VIRGINIA COORDINATE SYSTEM OF 1927 NORTH ZONE. ZONE WAS DERIVED FROM MEASUREMENTS TAKEN WITH TRIMBLE GEOXT SUBMETER MAPPING GRADE GPS UNIT. PLAT ORIENTATION, CORNER, AND WELL REFERENCE TIE LINES ARE BASED ON GRID NORTH.

(NAD) 83 (UTM) ZONE 17 COORDS:
WELL 1H TOP HOLE INFORMATION:
 N: 4,350,465m E: 521,885m
BOTTOM HOLE INFORMATION:
 N: 4,349,725m E: 522,637m

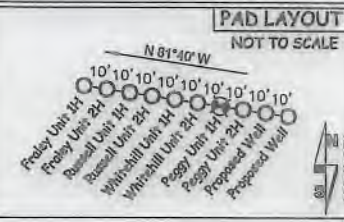

West Union District - Doddridge County		West Union District - Doddridge County	
27-02	Joseph Towner	12-07	Harold Robison
27-03	Mark Richards	12-09	John Smith
27-05	Robert Moore	12-10	John Smith
27-08	Karen Adams	12-11	John Smith
27-8.1	Denver Cox Jr.	12-16	Janice Brooks
27-8.2	Virginia Williams	12-17	George Wyckoff
27-09	Alfred Dotsen	12-17.4	George Wyckoff
27-9.1	Alfred Dotsen	12-17.5	Schawn Wyckoff
27-10	Kathryn Cork	12-26	Carol Mayle
27-11	Joseph Dotson	12-57	Mary Thompson
27-15	George Egnon	12-59	Spencer Enterp. LLC
27-16	Donna Parsons	12-60	Francis Schoolcraft
27-17	Victoria Rastle	12-60.1	Betty Stephenson
27-18	Matthew Kimball	12-60.2	Gary Stevenson
27-19	Denver Stubbs	12-60.3	Charles Myers
27-20	Vernon Randolph	12-67	Ronald Spencer
27-25	Gerald Knicely	12-68	Spencer Enterp. LLC
27-27.1	Smithburg U. M. Church	12-68.2	W.V. Dept. of Highways
27-28	Smithburg U. M. Church	12-72.2	Warren Bee
27-28.1	Smithburg U. M. Church	12-72.3	Arthur Calhoun
27-30	Smithburg U. M. Church	12-72.5	Michael McCombe
27-36	Kitty Parsons	12-72.6	Larry Gonzalez
27-36.1	Alice Jacobs	12-72.7	Michael McCombe
27-37	Board of Education	12-72.8	Warren Bee
27-37.1	Jeffrey Kase	12-72.9	Mark Oliver
27-37.2	Jeffrey Kase	12-72.17	Town of West Union
27-42	Spencer Enterp. LLC	12-98	Rocky Mayle
		12-99	John Smith
		16-07	Doddridge Co. Park & Rec.
		16-09	Dominion Transmission
		16-9.2	Clinton Means
		16-10	James McKinney
		16-12	Larsena Slater
		16-13	Betty Steul
		16-14	Thomas Deak
		16-14.1	Thomas Deak
		16-15	Marlowest Liberty Midstream
		16-19.2	Marlowest Liberty Midstream
		New Allitto District - Doddridge County	
		01-02	Doddridge Co. Court
		01-03	Elwood Hill

West Union District - Doddridge County	
28-08	Doddridge Co. Senior Citizens
28-15	Doddridge Co. Senior Citizens
28-17	Doddridge Co. Senior Citizens
28-18	Doddridge Co. Senior Citizens
28-29	Woodford Development Co.
28-33	Doddridge Co. Senior Citizens
28-43	Doddridge Co. Senior Citizens
28-50	BSCC Company
28-51	Doddridge Co. Senior Citizens
28-52	Edith Richards

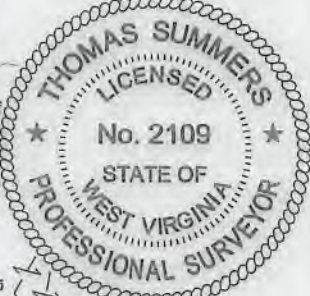

WV NORTH ZONE GRID NORTH

13,407' TO BOTTOM HOLE

10,972'

LONGITUDE 80°42'30"

LONGITUDE 80°42'30"

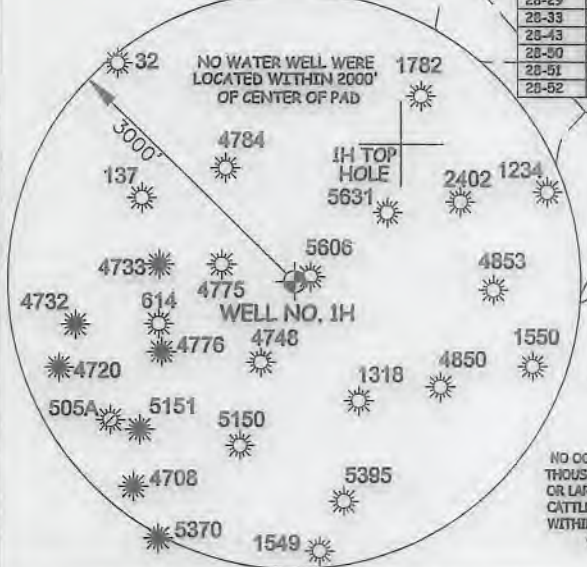

NOTE
 NO OCCUPIED DWELLINGS OR BUILDINGS TWO THOUSAND FIVE HUNDRED (2,500) SQUARE FEET OR LARGER USED TO HOUSE OR SHELTER DAIRY CATTLE OR POULTRY HUSBANDRY ARE LOCATED WITHIN SIX HUNDRED TWENTY-FIVE (625) FEET OF THE CENTER OF THE WELL PAD.

I THE UNDERSIGNED, HEREBY CERTIFY THAT THIS PLAT IS CORRECT TO THE BEST OF MY KNOWLEDGE AND BELIEF AND SHOWS ALL THE INFORMATION REQUIRED BY LAW AND THE RULES ISSUED AND PERSCRIBED BY THE DEPARTMENT OF ENVIRONMENTAL PROTECTION.



STATE OF WEST VIRGINIA, DIVISION OF ENVIRONMENTAL PROTECTION, OFFICE OF OIL AND GAS
 WILLOW LAND SURVEYING PLLC
 220 MASONIC AVE. PENNSBORO WEST VIRGINIA 26415

JOB # 19-029WA
 DRAWING # PEGGY 1H:shorty
 SCALE 1" = 2000'
 MINIMUM DEGREE OF ACCURACY SUBMETER
 PROVEN SOURCE OF ELEV. SUBMETER MAPPING GRADE GPS
 STATE OF WEST VIRGINIA DEPARTMENT OF ENERGY DIVISION OF OIL AND GAS

LEGEND
 --- Surface Owner Boundary Lines +/-
 - - - Interior Surface Tracts +/-
 X Existing Fence
 ⊕ Found monument, as noted

THOMAS SUMMERS P.S. 2109
 DATE 11/25/19
 OPERATOR'S WELL# PEGGY UNIT #1H

(NAD) 27 (UTM) ZONE 17 COORDS:
WELL 1H TOP HOLE INFORMATION:
 N: 14,272,435ft E: 1,712,169ft
POINT OF ENTRY INFORMATION:
 N: 14,272,775ft E: 1,713,708ft
BOTTOM HOLE INFORMATION:
 N: 14,270,008ft E: 1,714,638ft

REFERENCES
 1" = 300'
 STAKE/ NAIL, SET
 N 32°33' W 236.0'
 N 56°43' E 170.0'
 WELL NO. 1H

WELL TYPE: OIL ___ GAS X LIQUID INJECTION ___ WASTE DISPOSAL ___ 47 ___ 017 - 06898 W40
 (IF "GAS") PRODUCTION X STORAGE ___ DEEP ___ SHALLOW X STATE COUNTY PERMIT
 LOCATION: ELEVATION 1,275' - AS BUILT WATERSHED HEADWATERS MIDDLE ISLAND CREEK
 QUADRANGLE SMITHBURG 7.5 DISTRICT WEST UNION COUNTY DODDRIDGE
 SURFACE OWNER SAMUEL AND PEGGY SMITH ACREAGE 28.956 ACRES +/-
 OIL & GAS ROYALTY OWNER ELAINE DEBOLT; R. L. BARNES ET UX; JOAN M. STUTLER ET AL LEASE ACREAGE 84.8 AC.±; 222 AC.±; 100 AC.±

PROPOSED WORK: DRILL X CONVERT ___ DRILL DEEPER ___ REDRILL ___ FRACTURE OR STIMULATE X
 PLUG OFF OLD FORMATION ___ PERFORATE NEW FORMATION X OTHER PHYSICAL CHANGE IN WELL (SPECIFY) ___
 TARGET FORMATION MARCELLUS ESTIMATED DEPTH 7,500' TVD 12,400' MD
 WELL OPERATOR ANTERO RESOURCES CORP. DESIGNATED AGENT DIANNA STAMPER - CT CORPORATION SYSTEM
 ADDRESS 1615 WYNKOOP ST. ADDRESS 5400 D BIG TYLER ROAD
 DENVER, CO 80202 CHARLESTON, WV 25313

COUNTY NAME

PERMIT