

State of West Virginia
Department of Environmental Protection - Office of Oil and Gas
Well Operator's Report of Well Work

API 47-017-06899 County Dooldridge ~~Tyler~~ District West Union
Quad Smithburg 7.5' Pad Name Peggy June Field/Pool Name ----
Farm name Samuel and Peggy Smith Well Number Peggy 2H
Operator (as registered with the OOG) Antero Resources Corporation
Address 1615 Wynkoop Street City Denver State CO Zip 80202

As Drilled location NAD 83/UTM Attach an as-drilled plat, profile view, and deviation survey
Top hole Northing 4350464m Easting 521888m
Landing Point of Curve Northing 4350489.67m Easting 522691.33m
Bottom Hole Northing 4347060m Easting 523858m

Elevation (ft) 1275' GL Type of Well New Existing Type of Report Interim Final
Permit Type Deviated Horizontal Horizontal 6A Vertical Depth Type Deep Shallow
Type of Operation Convert Deepen Drill Plug Back Redrilling Rework Stimulate
Well Type Brine Disposal CBM Gas Oil Secondary Recovery Solution Mining Storage Other _____
Type of Completion Single Multiple Fluids Produced Brine Gas NGL Oil Other _____
Drilled with Cable Rotary

Drilling Media Surface hole Air Mud Fresh Water Intermediate hole Air Mud Fresh Water Brine
Production hole Air Mud Fresh Water Brine
Mud Type(s) and Additive(s)
Air - Foam & 4% KCL
Mud - Polymer

Date permit issued 1/28/2020 Date drilling commenced 2/6/2020 Date drilling ceased 1/11/2021
Date completion activities began 3/10/2021 Date completion activities ceased 5/8/2021
Verbal plugging (Y/N) N/A Date permission granted N/A Granted by N/A RECEIVED
Office of Oil and Gas

Please note: Operator is required to submit a plugging application within 5 days of verbal permission to plug AUG 30 2021

Freshwater depth(s) ft 320' Open mine(s) (Y/N) depths No WV Department of Environmental Protection
Salt water depth(s) ft 1603' Void(s) encountered (Y/N) depths No
Coal depth(s) ft 1601' Cavern(s) encountered (Y/N) depths No
Is coal being mined in area (Y/N) No

Reviewed

Reviewed by:
SDW
9/10/21
10/01/2021

API 47- 017 - 06899 Farm name Samuel and Peggy Smith Well number Peggy 2H

CASING STRINGS	Hole Size	Casing Size	Depth	New or Used	Grade wt/ft	Basket Depth(s)	Did cement circulate (Y/N) * Provide details below*
Conductor	24"	20"	80'	New	94#, H-40	N/A	Y
Surface	17-1/2"	13-3/8"	419'	New	54.5#, J-55	N/A	Y
Coal							
Intermediate 1	12-1/4"	9-5/8"	2723'	New	36#, K-55	N/A	Y
Intermediate 2							
Intermediate 3							
Production	8-3/4"/8-1/2"	5-1/2"	20102'	New	20#, P-110	N/A	Y
Tubing		2-3/8"	7620'		4.7#, P-110		
Packer type and depth set		N/A					

Comment Details _____

CEMENT DATA	Class/Type of Cement	Number of Sacks	Slurry wt (ppg)	Yield (ft ³ /sks)	Volume (ft ³)	Cement Top (MD)	WOC (hrs)
Conductor	Class A	204 sx	15.6	1.20	43	0'	8 Hrs.
Surface	Class A	364 sx	15.6	1.20	78	0'	8 Hrs.
Coal							
Intermediate 1	Class A	929 sx	15.6	1.20	197	0'	8 Hrs.
Intermediate 2							
Intermediate 3							
Production	Class H	792 sx (Lead) 2990 sx (Tail)	13.5 (Lead), 15.2 (Tail)	1.4 (Lead), 1.16 (Tail)	701	-500' into Intermediate Casing	8 Hrs.
Tubing							

Drillers TD (ft) 20152' MD, 6900' TVD (BHL), 6900' (Deepest Point Drilled) Loggers TD (ft) 20152' MD
 Deepest formation penetrated Marcellus Plug back to (ft) N/A
 Plug back procedure N/A

Kick off depth (ft) 6737'

Check all wireline logs run caliper density deviated/directional induction
 neutron resistivity gamma ray temperature sonic

Well cored Yes No Conventional Sidewall Were cuttings collected Yes No

DESCRIBE THE CENTRALIZER PLACEMENT USED FOR EACH CASING STRING _____

Conductor - 0
 Surface - 1 above guide shoe, 1 above insert float, 1 every 4th joint to surface
 Intermediate - 1 above float joint, 1 above float collar, 1 every 4th joint to surface
 Production - 1 above float joint, 1 below float collar, 1 every 3rd joint to top of cement

RECEIVED
Office of Oil and Gas
AUG 30 2021

WAS WELL COMPLETED AS SHOT HOLE Yes No DETAILS _____

WV Department of Environmental Protection

WAS WELL COMPLETED OPEN HOLE? Yes No DETAILS _____

WERE TRACERS USED Yes No TYPE OF TRACER(S) USED N/A

API 47- 017 - 06899 Farm name Samuel and Peggy Smith Well number Peggy 2H

PERFORATION RECORD

Stage No.	Perforation date	Perforated from MD ft.	Perforated to MD ft.	Number of Perforations	Formation(s)
*PLEASE SEE ATTACHED EXHIBIT 1					

Please insert additional pages as applicable.

STIMULATION INFORMATION PER STAGE

Complete a separate record for each stimulation stage.

Stage No.	Stimulations Date	Ave Pump Rate (BPM)	Ave Treatment Pressure (PSI)	Max Breakdown Pressure (PSI)	ISIP (PSI)	Amount of Proppant (lbs)	Amount of Water (bbls)	Amount of Nitrogen/other (units)
*PLEASE SEE ATTACHED EXHIBIT 2								

RECEIVED
Office of Oil and Gas
AUG 30 2021
WV Department of
Environmental Protection

Please insert additional pages as applicable.

API 47- 017 - 06899 Farm name Samuel and Peggy Smith Well number Peggy 2H

PRODUCING FORMATION(S)	DEPTHS		
Marcellus	6934' (TOP)	TVD	7684' (TOP) MD

Please insert additional pages as applicable.

GAS TEST Build up Drawdown Open Flow OIL TEST Flow Pump

SHUT-IN PRESSURE Surface 2800 psi Bottom Hole --- psi DURATION OF TEST --- hrs

OPEN FLOW Gas 8410 mcfpd Oil 32 bpd NGL --- bpd Water 29 bpd GAS MEASURED BY Estimated Orifice Pilot

LITHOLOGY/ FORMATION	TOP	BOTTOM	TOP	BOTTOM	DESCRIBE ROCK TYPE AND RECORD QUANTITY AND TYPE OF FLUID (FRESHWATER, BRINE, OIL, GAS, H ₂ S, ETC)
	DEPTH IN FT NAME TVD	DEPTH IN FT TVD	DEPTH IN FT MD	DEPTH IN FT MD	

***PLEASE SEE ATTACHED EXHIBIT 3**

Please insert additional pages as applicable.

Drilling Contractor H & P Drilling
Address 912 N Eagle Valley Rd City Howard State PA Zip 16841

Logging Company Nine Energy Services
Address 6500 West Fwy City Fort Worth State TX Zip 76116

Cementing Company Halliburton Energy Services
Address 300 W. Sam Houston Pkwy City Houston State TX Zip 76114

Stimulating Company Halliburton Energy Services
Address 3000 W. Sam Houston Pkwy City Houston State TX Zip 76114

Please insert additional pages as applicable.

RECEIVED
Office of Oil and Gas
AUG 30 2021
WV Department of
Environmental Protection

Completed by Brandi Hankins Telephone 303-357-7223
Signature  Title Completions Technician Date 8/27/21

Submittal of Hydraulic Fracturing Chemical Disclosure Information Attach copy of FRACFOCUS Registry

10/01/2021

API 47-017-06899 Farm Name <u>Samuel and Peggy Smith</u> Well Number <u>Peggy Unit 2H</u>					
Stage No.	Perforation Date	Perforated from MD ft.	Perforated to MD ft.	Number of Perforations	Formations
1	3/10/2021	20032	19988	36	Marcellus
2	3/10/2021	19947.28863	19735.0204	36	Marcellus
3	3/11/2021	19697.30904	19485.0408	36	Marcellus
4	3/11/2021	19447.32945	19235.0612	36	Marcellus
5	3/11/2021	19197.34985	18985.0816	36	Marcellus
6	3/11/2021	18947.37026	18735.102	36	Marcellus
7	3/12/2021	18697.39067	18485.1224	36	Marcellus
8	3/12/2021	18447.41108	18235.1429	36	Marcellus
9	3/12/2021	18197.43149	17985.1633	36	Marcellus
10	3/12/2021	17947.4519	17735.1837	36	Marcellus
11	3/13/2021	17697.4723	17485.2041	36	Marcellus
12	3/13/2021	17447.49271	17235.2245	36	Marcellus
13	3/13/2021	17197.51312	16985.2449	36	Marcellus
14	3/14/2021	16947.53353	16735.2653	36	Marcellus
15	3/14/2021	16697.55394	16485.2857	36	Marcellus
16	3/14/2021	16447.57434	16235.3061	36	Marcellus
17	3/14/2021	16197.59475	15985.3265	36	Marcellus
18	3/15/2021	15947.61516	15735.3469	36	Marcellus
19	3/15/2021	15697.63557	15485.3673	36	Marcellus
20	3/15/2021	15447.65598	15235.3878	36	Marcellus
21	3/15/2021	15197.67638	14985.4082	36	Marcellus
22	3/16/2021	14947.69679	14735.4286	36	Marcellus
23	3/16/2021	14697.7172	14485.449	36	Marcellus
24	3/16/2021	14447.73761	14235.4694	36	Marcellus
25	3/16/2021	14197.75802	13985.4898	36	Marcellus
26	3/16/2021	13947.77843	13735.5102	36	Marcellus
27	3/17/2021	13697.79883	13485.5306	36	Marcellus
28	3/17/2021	13447.81924	13235.551	36	Marcellus
29	3/17/2021	13197.83965	12985.5714	36	Marcellus
30	3/17/2021	12947.86006	12735.5918	36	Marcellus
31	3/18/2021	12697.88047	12485.6122	36	Marcellus
32	3/18/2021	12447.90087	12235.6327	36	Marcellus
33	3/18/2021	12197.92128	11985.6531	36	Marcellus
34	3/18/2021	11947.94169	11735.6735	36	Marcellus
35	3/18/2021	11697.9621	11485.6939	36	Marcellus
36	3/19/2021	11447.98251	11235.7143	36	Marcellus
37	3/19/2021	11198.00292	10985.7347	36	Marcellus
38	3/19/2021	10948.02332	10735.7551	36	Marcellus
39	3/19/2021	10698.04373	10485.7755	36	Marcellus
40	3/20/2021	10448.06414	10235.7959	36	Marcellus
41	3/20/2021	10198.08455	9985.81633	36	Marcellus
42	3/21/2021	9948.104956	9735.83673	36	Marcellus
43	3/21/2021	9698.125364	9485.85714	36	Marcellus
44	3/21/2021	9448.145773	9235.87755	36	Marcellus
45	3/21/2021	9198.166181	8985.89796	36	Marcellus
46	3/22/2021	8948.186589	8735.91837	36	Marcellus
47	3/22/2021	8698.206997	8485.93878	36	Marcellus
48	3/22/2021	8448.227405	8235.95918	36	Marcellus
49	3/22/2021	8198.247813	7985.97959	36	Marcellus
50	3/22/2021	7948.268222	7736	36	Marcellus

RECEIVED
Office of Oil and Gas
AUG 30 2021
WV Department of
Environmental Protection

10/01/2021

EXHIBIT 2

Stage No.	Stimulations Date	Avg Pump Rate	Avg Treatment Pressure (PSI)	Max Breakdown Pressure (PSI)	ISIP (PSI)	Amount of Proppant (lbs)	Amount of Water (bbls)	Amount of Nitrogen/ other (units)
1	3/10/2021	68.39	8558	8316	3946	178552	369947	N/A
2	3/10/2021	80.4	8712	6248	4636	501272	390933	N/A
3	3/11/2021	80.99	8714	4937	4319	501218	384515	N/A
4	3/11/2021	83.45	8704	5093	4630	501190	377622	N/A
5	3/11/2021	84.7	8690	5121	4421	501395	373760	N/A
6	3/11/2021	85.86	8602	4776	4529	503530	382222	N/A
7	3/12/2021	84.98	8709	5622	4271	501335	365697	N/A
8	3/12/2021	87.79	8700	6376	4491	500804	365451	N/A
9	3/12/2021	86.11	8587	5457	4630	501881	366888	N/A
10	3/12/2021	87.05	8664	7689	4279	501321	375461	N/A
11	3/13/2021	89.04	8748	4879	4322	503971	364964	N/A
12	3/13/2021	89.42	8735	3887	4506	501344	360433	N/A
13	3/13/2021	86.31	8575	4101	4506	501307	360768	N/A
14	3/14/2021	87.78	8711	4507	4399	500855	361443	N/A
15	3/14/2021	87.98	8654	3869	4170.42	501339	358751	N/A
16	3/14/2021	86.15	8695	5173	4195	501894	355463	N/A
17	3/14/2021	88.77	8631	4902	4477	501225	358202	N/A
18	3/15/2021	90.38	8714	5660	4474	502693	364662	N/A
19	3/15/2021	92.34	8727	3961	4631	501332	354851	N/A
20	3/15/2021	88.64	8669	3473	4517	501658	354459	N/A
21	3/15/2021	90.64	8644	5565	4698	501094	364625	N/A
22	3/16/2021	89.66	8661	5599	4520	501317	360941	N/A
23	3/16/2021	88.83	8748	4944	4220	501423	357450	N/A
24	3/16/2021	92.15	8751	4240	4465	501221	358101	N/A
25	3/16/2021	91.35	8759	3002	4345	501455	353777	N/A
26	3/16/2021	94.33	8727	4755	4926	501700	356246	N/A
27	3/17/2021	94.73	8781	5957	4709	501380	355544	N/A
28	3/17/2021	92.83	8652	4866	4793	503404	358510	N/A
29	3/17/2021	90.89	8698	4883	4786	501544	356333	N/A
30	3/17/2021	94.98	8809	5304	4524	500981	353743	N/A
31	3/18/2021	98.37	8785	5794	4496	501000	356965	N/A
32	3/18/2021	95.11	8774	5109	4339	501370	362093	N/A
33	3/18/2021	96.75	8675	3814	4422	501398	356141	N/A
34	3/18/2021	95.96	8528	5172	4373	501231	358128	N/A
35	3/18/2021	98.76	8478	5280	4632	502800	354449	N/A
36	3/19/2021	98.02	8664	5398	4293	501350	353866	N/A
37	3/19/2021	98.24	8659	5752	4441	502060	352453	N/A
38	3/19/2021	98.39	8416	4902	4181	501469	357990	N/A
39	3/19/2021	98.04	8659	3442	3950	497807	352897	N/A
40	3/20/2021	97.52	8721	6203	3840	501763	353222	N/A
41	3/20/2021	97.91	8675	5500	4449	501500	370459	N/A
42	3/21/2021	97.36	8745	5882	4434	501260	366724	N/A
43	3/21/2021	94.17	8250	5033	4031	504683	378417	N/A
44	3/21/2021	92.89	8319	5819	4032	501623	362343	N/A
45	3/21/2021	98.45	8724	4374	4182	501440	368827	N/A
46	3/22/2021	98.07	8615	5667	4373	501340	368582	N/A
47	3/22/2021	97.48	8183	6922	4544	501511	366651	N/A
48	3/22/2021	99.55	8275	5197	3961	501267	370627	N/A
49	3/22/2021	98.71	8130	5035	4169	501160	360523	N/A
50	3/22/2021	99.14	7851	3951	4474	501020	363136	N/A
	AVG=	92	8,617	5,148	4,399	24,754,687	18,156,255	TOTAL

RECEIVED
Office of Oil and Gas

AUG 30 2021

WV Department of
Environmental Protection

10/01/2021

EXHIBIT 3

LITHOLOGY/ FORMATION	TOP DEPTH (TVD)	BOTTOM DEPTH (TVD)	TOP DEPTH (MD)	BOTTOM DEPTH (MD)
	From Surface	From Surface	From Surface	From Surface
Shaley Siltstone	120	210	120	210
Shale	210	390	210	390
Silty Shale	390	480	390	480
Shale	480	810	480	810
Silty Shale	810	840	810	840
Shaley Sandstone	840	960	840	960
Shaley Sandstone	960	1,050	960	1,050
Shale	1,050	1,110	1,050	1,110
Sandy Shale	1,110	1,230	1,110	1,230
Shaley Sandstone	1,230	1,290	1,230	1,290
Sandstone, Tr Shale, Tr Silt	1,290	1,710	1,290	1,710
Shaley Sandstone, Occ Coal	1,710	1,890	1,710	1,890
Sandy Shale, Tr Coal, Tr Limestone	1,890	2,145	1,890	2,269
Big Lime	2,175	2,762	2,299	2,935
Fifty Foot Sandstone	2,762	2,860	2,935	3,042
Gordon	2,860	3,136	3,042	3,346
Fifth Sandstone	3,136	3,340	3,346	3,571
Bayard	3,340	3,975	3,571	4,264
Speechley	3,975	4,279	4,264	4,597
Balltown	4,279	4,666	4,597	5,023
Bradford	4,666	5,137	5,023	5,542
Benson	5,137	5,455	5,542	5,891
Alexander	5,455	6,730	5,891	7,302
Sycamore	6,490	6,700	7,024	7,272
Middlesex	6,700	6,843	7,272	7,485
Burkett	6,843	6,872	7,485	7,537
Tully	6,872	6,934	7,537	7,684
Marcellus	6,934	NA	7,684	NA

*Please note Antero determines formation tops based on mud logs that are only run on one well on a multi-well pad. The measured depth (MD) data on subsequent wells may be slightly different due to the well's unique departure.

RECEIVED
Office of Oil and Gas

AUG 30 2021

WV Department of
Environmental Protection

10/01/2021

Hydraulic Fracturing Fluid Product Component Information Disclosure

Job Start Date:	3/10/2021
Job End Date:	3/22/2021
State:	West Virginia
County:	Doddridge
API Number:	47-017-06899-00-00
Operator Name:	Antero Resources Corporation
Well Name and Number:	PEGGY UNIT 2H
Latitude:	39.30321000
Longitude:	-80.74632000
Datum:	NAD83
Federal Well:	NO
Indian Well:	NO
True Vertical Depth:	7,009
Total Base Water Volume (gal):	18,968,670
Total Base Non Water Volume:	0



Hydraulic Fracturing Fluid Composition:

Trade Name	Supplier	Purpose	Ingredients	Chemical Abstract Service Number (CAS #)	Maximum Ingredient Concentration in Additive (% by mass)**	Maximum Ingredient Concentration in HF Fluid (% by mass)**	Comments
Produced Water Mixture	Halliburton	Base Fluid					
			Water	7732-18-5	100.00000	86.56640	Density = 8.50
Ingredient	Listed Above	Listed Above					
			Water	7732-18-5	100.00000	0.05947	

RECEIVED
 Office of Oil and Gas
 West Virginia Department of Environmental Protection
 AUG 10 2021

HYDROCHLORIC ACID, 22 BAUME	Halliburton	Solvent					
				Listed Below			
OPTIFLO-II DELAYED RELEASE BREAKER	Halliburton	Breaker					
				Listed Below			
HAI-501	Halliburton	Acid Corrosion Inhibitor					
				Listed Below			
Sand-Common White-100 Mesh, SSA-2	Halliburton	Proppant					
				Listed Below			
WG-36 GELLING AGENT	Halliburton	Gelling Agent					
				Listed Below			
FLUID Enviro-Syn HCR-7000-WL	Fluid Energy Group	Acid Replacement					
				Listed Below			
Excelerate LX-15	Halliburton	Friction Reducer					
				Listed Below			
MC B-8614A	MultiChem	Biocide					
				Listed Below			

Department of
 Environmental Protection

AUG 30 2021

RECEIVED
 Office of Oil and Gas

Items above are Trade Names with the exception of Base Water . Items below are the individual ingredients.

			Crystalline silica, quartz	14808-60-7	100.00000	13.29081	
			Complex Amine Compound	Proprietary	60.00000	0.03620	
			Hydrotreated light petroleum distillate	64742-47-8	30.00000	0.01810	
			Proprietary	Proprietary	20.00000	0.01083	
			Proprietary	Proprietary	10.00000	0.00542	
			Guar gum	9000-30-0	100.00000	0.00490	
			Hydrochloric acid	7647-01-0	30.00000	0.00442	
			Sorbitan, mono-9-octadecenoate, (Z)	1338-43-8	5.00000	0.00302	
			Surfactant	Proprietary	5.00000	0.00302	
			Glutaraldehyde	111-30-8	30.00000	0.00257	
			Ethoxylated alcohols	Proprietary	5.00000	0.00060	
			Alkoxylated polyhydric alcohol	Proprietary	1.00000	0.00060	
			Organic chloride compound	Proprietary	1.00000	0.00060	
			Alkyl (C12-16) dimethylbenzyl ammonium chloride	68424-85-1	5.00000	0.00043	
			Ammonium persulfate	7727-54-0	100.00000	0.00011	
			Ethanol	64-17-5	1.00000	0.00009	
			Oxylated phenolic resin	Proprietary	30.00000	0.00003	
			Methanol	67-56-1	100.00000	0.00003	
			Modified thiourea polymer	Proprietary	30.00000	0.00001	
			Mixture of dimer and trimer fatty acids of indefinite composition derived from tall oil	61790-12-3	30.00000	0.00001	
			Organic salt #2	Proprietary	0.01000	0.00001	
			Sodium glycolate	2836-32-0	0.01000	0.00001	
			Sodium hydroxide	1310-73-2	0.01000	0.00001	
			Nitrated acetate salt	Proprietary	0.01000	0.00001	

RECEIVED
 Office of Oil and Gas
 AUG 3 2021
 W / Department of
 Environmental Protection

			Acrylamide	79-06-1	0.01000	0.00001	
			Organic salt #1	Proprietary	0.01000	0.00001	
			Formaldehyde	50-00-0	0.01000	0.00001	
			Hexadecene	629-73-2	5.00000	0.00000	
			Propargyl alcohol	107-19-7	5.00000	0.00000	
			C.I. pigment Orange 5	3468-63-1	1.00000	0.00000	

* Total Water Volume sources may include various types of water including fresh water, produced water, and recycled water

** Information is based on the maximum potential for concentration and thus the total may be over 100%

*** If you are calculating a percentage of total ingredients do not add the water volume below the green line to the water volume above the green line

Note: For Field Development Products (products that begin with FDP), MSDS level only information has been provided.

Ingredient information for chemicals subject to 29 CFR 1910.1200(i) and Appendix D are obtained from suppliers Material Safety Data Sheets (MSDS)

RECEIVED
Office of Oil and Gas
WV Department of
Environmental Protection
AUG 30 2021

LATITUDE 39°20'00"

10,749'

LATITUDE 39°17'30" 4,319' TO BOTTOM HOLE

Antero Resources Corporation Well No. Peggy Unit 2H

NOTES: WELL 2H TOP HOLE INFORMATION: N: 294,990ft E: 1,647,322ft LAT: 39°18'11.54" LON: 80°44'46.74" BOTTOM HOLE INFORMATION: N: 283,711ft E: 1,653,602ft LAT: 39°16'20.92" LON: 80°43'24.91" WEST VIRGINIA COORDINATE SYSTEM OF 1927 NORTH ZONE. ZONE WAS DERIVED FROM MEASUREMENTS TAKEN WITH TRIMBLE GEOXT SUBMETER MAPPING GRADE GPS UNIT. PLAT ORIENTATION, CORNER, AND WELL REFERENCE TIE LINES ARE BASED ON GRID NORTH.

(NAD) 83 (UTM) ZONE 17 COORDS: WELL 2H TOP HOLE INFORMATION: N: 4,350,464m E: 521,888m BOTTOM HOLE INFORMATION: N: 4,347,060m E: 523,858m

WELL 2H POINT OF ENTRY INFORMATION: N: 295,558ft E: 1,649,847ft LAT: 39°18'17.50" LON: 80°44'14.73" N: 4,350,651m E: 522,654m

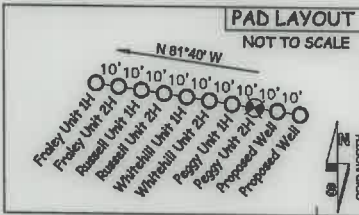

NO WATER WELL WERE LOCATED WITHIN 2000' OF CENTER OF PAD

2H TOP HOLE

Table listing landowners and lease numbers for West Union District - Doddridge County. Includes names like David Spengler, Michael O'Brien, John Smith, etc.

6,990' TO BOTTOM HOLE 10,974' LONGITUDE 80°42'30"

I THE UNDERSIGNED, HEREBY CERTIFY THAT THIS PLAT IS CORRECT TO THE BEST OF MY KNOWLEDGE AND BELIEF AND SHOWS ALL THE INFORMATION REQUIRED BY LAW AND THE RULES ISSUED AND PERSCRIBED BY THE DEPARTMENT OF ENVIRONMENTAL PROTECTION.



STATE OF WEST VIRGINIA, DIVISION OF ENVIRONMENTAL PROTECTION, OFFICE OF OIL AND GAS

WILLOW LAND SURVEYING PLLC 220 MASONIC AVE. PENNSBORO WEST VIRGINIA 26415

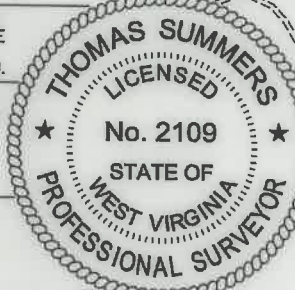

- A = BRYAN E. HAGEDORN ET UX
B = WILLIAM M. SMITH
C = MARK A. OWENS
D = ALBIN HART ET UX
E = ALBIN HART ET UX
F = VIRGINIA LEE NICHOLSON
G = CASSANDRA DAWN EWING

JOB # 19-029WA
DRAWING # PEGGY2HAD
SCALE 1" = 2000'
MINIMUM DEGREE OF ACCURACY SUBMETER
PROVEN SOURCE OF ELEV. SUBMETER MAPPING GRADE GPS

LEGEND: Surface Owner Boundary Lines +/-, Interior Surface Tracts +/-, Proposed Well Path, As Drilled Well Path. Includes signature of Thomas Summers.

NOTE: 1. NO OCCUPIED DWELLINGS OR BUILDINGS TWO THOUSAND FIVE HUNDRED (2,500) SQUARE FEET OR LARGER USED TO HOUSE OR SHELTER DAIRY CATTLE OR POULTRY HUSBANDRY ARE LOCATED WITHIN SIX HUNDRED TWENTY-FIVE (625) FEET OF THE CENTER OF THE WELL PAD.

Table listing landowners and lease numbers for New Milton District - Doddridge County. Includes names like Elwood Rill, Patrick Price, etc.

STATE OF WEST VIRGINIA DEPARTMENT OF ENERGY DIVISION OF OIL AND GAS
WELL TYPE: OIL GAS X LIQUID INJECTION WASTE DISPOSAL 47 017 06899
(IF "GAS") PRODUCTION X STORAGE DEEP SHALLOW X STATE COUNTY PERMIT
LOCATION: ELEVATION 1,275' - AS BUILT WATERSHED HEADWATERS MIDDLE ISLAND CREEK
QUADRANGLE SMITHBURG 7.5 DISTRICT WEST UNION COUNTY DODDRIDGE

SURFACE OWNER SAMUEL AND PEGGY SMITH
OIL & GAS ROYALTY OWNER ELAINE DEBOLT; R. L. BARNES ET UX; V. B. CHAPMAN ET UX; R. L. BARNES ET UX;
JOAN M. STUTLER ET AL; E. C. JONES ET AL; SPENCER ENTERPRISES LLC; WYDOH; WVSRA; WVDNR; CASSANDRA DAWN EWING;
NEIL JONES HARSHBARGER; SUSAN H. JONES; GEN HOLDINGS LLC; A.E. FITZWILLIAMS ET AL; KENNETH KOEBE; ROBERT L. MOORE ET AL
ACREAGE 28.956 ACRES +/- 10701/2021
LEASE ACREAGE 84.8 AC +/- 222 AC +/- 156 AC +/- 15.86 AC +/-
100 AC +/- 390 AC +/- 9.91 AC +/- 38.5 AC +/- 301.19 AC +/- 777 AC +/- 2.28 AC +/-
69 AC +/- 36 AC +/- 27.63 AC +/- 138.5 AC +/- 27.94 AC +/- 95.12 AC +/-
PROPOSED WORK: DRILL CONVERT DRILL DEEPER REDRILL FRACTURE OR STIMULATE
PLUG OFF OLD FORMATION PERFORATE NEW FORMATION OTHER PHYSICAL CHANGE IN WELL
(SPECIFY) AS DRILLED
TARGET FORMATION MARCELLUS PLUG & ABANDON CLEAN OUT & REPLUG
WELL OPERATOR ANTERO RESOURCES CORP. ESTIMATED DEPTH 6,900' TVD 20,152' MD
ADDRESS 1615 WYNKOOP ST. DESIGNATED AGENT DIANNA STAMPER - CT CORPORATION SYSTEM
FORM WW-6 DENVER, CO 80202 ADDRESS 5400 D BIG TYLER ROAD CHARLESTON, WV 25313