

LATITUDE 39°20'00"

10,799'

LATITUDE 39°17'30" 7,858' TO BOTTOM HOLE

Antero Resources Corporation Well No. Russell Unit 1H

NOTES: WELL 1H TOP HOLE INFORMATION: N: 294,997ft E: 1,647,273ft LAT: 39°18'11.60" LON: 80°44'47.38" BOTTOM HOLE INFORMATION: N: 284,906ft E: 1,650,078ft LAT: 39°16'32.25" LON: 80°44'09.92" WEST VIRGINIA COORDINATE SYSTEM OF 1927 NORTH ZONE. ZONE WAS DERIVED FROM MEASUREMENTS TAKEN WITH TRIMBLE GEOXT SUBMETER MAPPING GRADE GPS UNIT. PLAT ORIENTATION, CORNER, AND WELL REFERENCE TIE LINES ARE BASED ON GRID NORTH.

(NAD) 83 (UTM) ZONE 17 COORDS: WELL 1H TOP HOLE INFORMATION: N: 4,350,466m E: 521,873m BOTTOM HOLE INFORMATION: N: 4,347,406m E: 522,779m

PAD LAYOUT NOT TO SCALE



NO WATER WELL WERE LOCATED WITHIN 2000' OF CENTER OF PAD

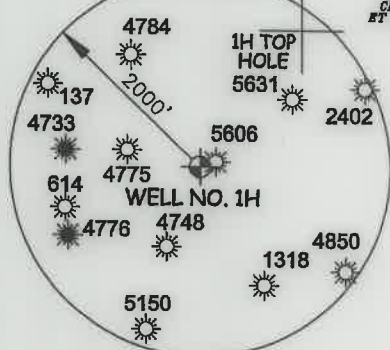

Table listing West Union District - Doddridge County with columns for well ID and owner name. Includes entries like 08-49 David Sponagle, 12-08 John Smith, etc.

5,843' TO BOTTOM HOLE LONGITUDE 80°42'30"

10,967' LONGITUDE 80°42'30"

I THE UNDERSIGNED, HEREBY CERTIFY THAT THIS PLAT IS CORRECT TO THE BEST OF MY KNOWLEDGE AND BELIEF AND SHOWS ALL THE INFORMATION REQUIRED BY LAW AND THE RULES ISSUED AND PERSCRIBED BY THE DEPARTMENT OF ENVIRONMENTAL PROTECTION.



STATE OF WEST VIRGINIA, DIVISION OF ENVIRONMENTAL PROTECTION, OFFICE OF OIL AND GAS

WILLOW LAND SURVEYING PLLC 220 MASONIC AVE. PENNSBORO WEST VIRGINIA 26415

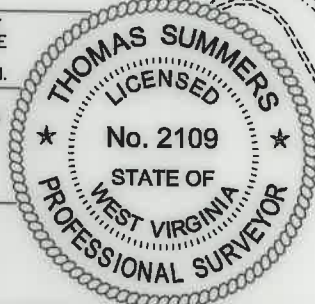

JOB # 19-030WA

DRAWING # RUSSELL1HAD

SCALE 1" = 2000'

MINIMUM DEGREE OF ACCURACY SUBMETER

PROVEN SOURCE OF ELEV. SUBMETER MAPPING GRADE GPS

STATE OF WEST VIRGINIA DEPARTMENT OF ENERGY DIVISION OF OIL AND GAS

LEGEND: Surface Owner Boundary Lines +/-, Interior Surface Tracts +/-, Proposed Well Path, As Drilled Well Path

THOMAS SUMMERS P.S. 2109

DATE 08/03/21

OPERATOR'S WELL# RUSSELL UNIT #1H

NOTE: 1. NO OCCUPIED DWELLINGS OR BUILDINGS TWO THOUSAND FIVE HUNDRED (2,500) SQUARE FEET OR LARGER USED TO HOUSE OR SHELTER DAIRY CATTLE OR POULTRY HUSBANDRY ARE LOCATED WITHIN SIX HUNDRED TWENTY-FIVE (625) FEET OF THE CENTER OF THE WELL PAD. 2. TOP HOLE DATA SHOWN HEREON WAS PROVIDED BY ANTERO RESOURCES CORPORATION. 3. AS DRILLED DATA WAS PROVIDED BY ANTERO RESOURCES CORPORATION. 4. WLS IS NOT CERTIFYING THE DATA AND INFORMATION PROVIDED LISTED IN NOTES 2 AND 3, ONLY THE RELATIONSHIP TO THE DATA AND INFORMATION PROVIDED TO THE LEASE BOUNDARIES. 5. WLS IS BY NO MEANS RESPONSIBLE FOR ANY ERRORS OR INACCURACIES WITH THE DATA AND INFORMATION THAT HAS BEEN PROVIDED.

WELL 1H POINT OF ENTRY INFORMATION: N: 294,786ft E: 1,646,907ft LAT: 39°18'09.46" LON: 80°44'51.99" N: 4,350,400m E: 521,762m

WELL TYPE: OIL ___ GAS X LIQUID INJECTION ___ WASTE DISPOSAL ___ 47 - 017 - 06900 (IF "GAS") PRODUCTION X STORAGE ___ DEEP ___ SHALLOW X

LOCATION: ELEVATION 1,275' - AS BUILT WATERSHED HEADWATERS MIDDLE ISLAND CREEK QUADRANGLE SMITHBURG 7.5 DISTRICT WEST UNION COUNTY DODDRIDGE

SURFACE OWNER SAMUEL AND PEGGY SMITH ACREAGE 28.956 ACRES +/-

OIL & GAS ROYALTY OWNER ELAINE DEBOLT; CAROLYN ROBINSON ET AL; R.L. BARNES ET UX; AMERICAN ENERGY-MARCELLUS MINERALS, LLC LEASE ACREAGE 84.8 AC +/- 26 AC +/- 222 AC +/-

C.M. TATE ET UX; THOMAS L. BARNES ET UX; WVDNR; WVSRA; EQT PRODUCTION COMPANY; 102 AC +/- 9 AC +/- 54.48 AC +/- 301.19 AC +/- 75 AC +/-

ALTON J. CHILDERS ET AL; PATHFINDER RESOURCES, LLC; MARY N. KISSINGER; W.L. DAVIS ET UX 99 AC +/- 136.58 AC +/- 61.58 AC +/- 265 AC +/-

PROPOSED WORK: DRILL ___ CONVERT ___ DRILL DEEPER ___ REDRILL ___ FRACTURE OR STIMULATE ___

(SPECIFY) AS DRILLED PLUG & ABANDON CLEAN OUT & REPLUG

TARGET FORMATION MARCELLUS ESTIMATED DEPTH 6,896' TVD 17,616' MD

WELL OPERATOR ANTERO RESOURCES CORP. DESIGNATED AGENT DIANNA STAMPER - CT CORPORATION SYSTEM

ADDRESS 1615 WYNNKOOP ST. ADDRESS 5400 D BIG TYLER ROAD

FORM WW-6 DENVER, CO 80202 CHARLESTON, WV 25313

COUNTY NAME PERMIT