

State of West Virginia  
Department of Environmental Protection - Office of Oil and Gas  
Well Operator's Report of Well Work

API 47-017-06901 County Tyler District West Union  
Quad Smithburg 7.5' Pad Name Peggy June Field/Pool Name ----  
Farm name Samuel and Peggy Smith Well Number Russell Unit 2H  
Operator (as registered with the OOG) Antero Resources Corporation  
Address 1615 Wynkoop Street City Denver State CO Zip 80202

As Drilled location NAD 83/UTM Attach an as-drilled plat, profile view, and deviation survey  
Top hole Northing 4350466m Easting 521876m  
Landing Point of Curve Northing 4350370.85m Easting 522073.83m  
Bottom Hole Northing 4347244m Easting 523144m

Elevation (ft) 1275' GL Type of Well  New  Existing Type of Report  Interim  Final  
Permit Type  Deviated  Horizontal  Horizontal 6A  Vertical Depth Type  Deep  Shallow  
Type of Operation  Convert  Deepen  Drill  Plug Back  Redrilling  Rework  Stimulate  
Well Type  Brine Disposal  CBM  Gas  Oil  Secondary Recovery  Solution Mining  Storage  Other \_\_\_\_\_  
Type of Completion  Single  Multiple Fluids Produced  Brine  Gas  NGL  Oil  Other \_\_\_\_\_  
Drilled with  Cable  Rotary

Drilling Media Surface hole  Air  Mud  Fresh Water Intermediate hole  Air  Mud  Fresh Water  Brine  
Production hole  Air  Mud  Fresh Water  Brine  
Mud Type(s) and Additive(s)  
Air - Foam & 4% KCL  
Mud - Polymer

Date permit issued 1/28/2020 Date drilling commenced 2/18/2020 Date drilling ceased 2/6/2021  
Date completion activities began 3/24/2021 Date completion activities ceased 5/10/2021  
Verbal plugging (Y/N) N/A Date permission granted N/A Granted by N/A

RECEIVED  
Office of Oil and Gas

Please note: Operator is required to submit a plugging application within 5 days of verbal permission to plug

AUG 30 2021

Freshwater depth(s) ft 320' Open mine(s) (Y/N) depths No  
Salt water depth(s) ft 1603' Void(s) encountered (Y/N) depths No  
Coal depth(s) ft 1601' Cavern(s) encountered (Y/N) depths No  
Is coal being mined in area (Y/N) No

WV Department of  
Environmental Protection

Reviewed

Reviewed by:  
SDW  
9/8/21  
10/01/2021

API 47- 017 - 06901 Farm name Samuel and Peggy Smith Well number Russell Unit 2H

CASING STRINGS	Hole Size	Casing Size	Depth	New or Used	Grade wt/ft	Basket Depth(s)	Did cement circulate (Y/ N) * Provide details below*
Conductor	24"	20"	80'	New	94#, H-40	N/A	Y
Surface	17-1/2"	13-3/8"	438'	New	54.5#, J-55	N/A	Y
Coal							
Intermediate 1	12-1/4"	9-5/8"	2573'	New	36#, K-55	N/A	Y
Intermediate 2							
Intermediate 3							
Production	8-3/4"/8-1/2"	5-1/2"	18410'	New	20#,P-110	N/A	Y
Tubing		2-3/8"	7218'		4.7#, P-110		
Packer type and depth set		N/A					

Comment Details \_\_\_\_\_

CEMENT DATA	Class/Type of Cement	Number of Sacks	Slurry wt (ppg)	Yield (ft <sup>3</sup> /sks)	Volume (ft <sup>3</sup> )	Cement Top (MD)	WOC (hrs)
Conductor	Class A	204 sx	15.6	1.20	43	0'	8 Hrs.
Surface	Class A	368 sx	15.6	1.20	79	0'	8 Hrs.
Coal							
Intermediate 1	Class A	877 sx	15.6	1.19	186	0'	8 Hrs.
Intermediate 2							
Intermediate 3							
Production	Class H	792 sx (Lead) 2672 sx (Tail)	13.5 (Lead), 15.2(Tail)	1.4 (Lead), 1.16 (Tail)	625	~500' into Intermediate Casing	8 Hrs.
Tubing							

Drillers TD (ft) 18460' MD, 6880' TVD (BHL), 7009' (Deepest Point Drilled) Loggers TD (ft) 18460' MD  
 Deepest formation penetrated Marcellus Plug back to (ft) N/A  
 Plug back procedure N/A

Kick off depth (ft) 6165'

Check all wireline logs run  caliper  density  deviated/directional  induction  
 neutron  resistivity  gamma ray  temperature  sonic

Well cored  Yes  No Conventional Sidewall Were cuttings collected  Yes  No

DESCRIBE THE CENTRALIZER PLACEMENT USED FOR EACH CASING STRING \_\_\_\_\_

Conductor - 0  
 Surface - 1 above guide shoe, 1 above insert float, 1 every 4th joint to surface  
 Intermediate - 1 above float joint, 1 above float collar, 1 every 4th joint to surface  
 Production - 1 above float joint, 1 below float collar, 1 every 3rd joint to top of cement

WAS WELL COMPLETED AS SHOT HOLE  Yes  No DETAILS \_\_\_\_\_

WAS WELL COMPLETED OPEN HOLE?  Yes  No DETAILS \_\_\_\_\_

WERE TRACERS USED  Yes  No TYPE OF TRACER(S) USED N/A

RECEIVED  
 Office of Oil and Gas  
 AUG 30 2021  
 WV Department of Environmental Protection

API 47-017 - 06901 Farm name Samuel and Peggy Smith Well number Russell Unit 2H

PERFORATION RECORD

Stage No.	Perforation date	Perforated from MD ft.	Perforated to MD ft.	Number of Perforations	Formation(s)
<b>*PLEASE SEE ATTACHED EXHIBIT 1</b>					

Please insert additional pages as applicable.

STIMULATION INFORMATION PER STAGE

Complete a separate record for each stimulation stage.

Stage No.	Stimulations Date	Ave Pump Rate (BPM)	Ave Treatment Pressure (PSI)	Max Breakdown Pressure (PSI)	ISIP (PSI)	Amount of Proppant (lbs)	Amount of Water (bbls)	Amount of Nitrogen/other (units)
<b>*PLEASE SEE ATTACHED EXHIBIT 2</b>								

Please insert additional pages as applicable.

RECEIVED  
Office of Oil and Gas  
AUG 30 2021  
WV Department of  
Environmental Protection

API 47- 017 - 06901 Farm name Samuel and Peggy Smith Well number Russell Unit 2H

PRODUCING FORMATION(S)	DEPTHS	
Marcellus	6927' (TOP) TVD	7238' (TOP) MD

Please insert additional pages as applicable.

GAS TEST  Build up  Drawdown  Open Flow OIL TEST  Flow  Pump

SHUT-IN PRESSURE Surface 2800 psi Bottom Hole --- psi DURATION OF TEST --- hrs

OPEN FLOW Gas 8453 mcfpd Oil 33 bpd NGL --- bpd Water 29 bpd GAS MEASURED BY  Estimated  Orifice  Pilot

LITHOLOGY/ FORMATION	TOP	BOTTOM	TOP	BOTTOM	DESCRIBE ROCK TYPE AND RECORD QUANTITY AND TYPE OF FLUID (FRESHWATER, BRINE, OIL, GAS, H <sub>2</sub> S, ETC)
	DEPTH IN FT NAME TVD	DEPTH IN FT TVD	DEPTH IN FT MD	DEPTH IN FT MD	

**\*PLEASE SEE ATTACHED EXHIBIT 3**

Please insert additional pages as applicable.

Drilling Contractor H & P Drilling  
Address 912 N Eagle Valley Rd City Howard State PA Zip 16841

Logging Company Nine Energy Services  
Address 6500 West Fwy City Fort Worth State TX Zip 76116

Cementing Company Halliburton Energy Services  
Address 300 W. Sam Houston Pkwy City Houston State TX Zip 76114

Stimulating Company Halliburton Energy Services  
Address 3000 W. Sam Houston Pkwy City Houston State TX Zip 76114

Please insert additional pages as applicable.

Completed by Brandi Hankins Telephone 303-357-7223  
Signature  Title Completions Technician Date 8/27/2021

Submittal of Hydraulic Fracturing Chemical Disclosure Information Attach copy of FRACFOCUS Registry

RECEIVED  
Office of Oil and Gas  
AUG 30 2021  
WV Department of  
Environmental Protection

10/01/2021

API 47-017-06901 Farm Name Samuel and Peggy Smith Well Number Russell Unit 2H

Stage No.	Perforation Date	Perforated from MD ft.	Perforated to MD ft.	Number of Perforations	Formations
1	3/24/2021	18352	18313	36	Marcellus
2	3/24/2021	18271.93333	18057.5333	36	Marcellus
3	3/25/2021	18019.46667	17805.0667	36	Marcellus
4	3/26/2021	17767	17552.6	36	Marcellus
5	3/26/2021	17514.53333	17300.1333	36	Marcellus
6	3/26/2021	17262.06667	17047.6667	36	Marcellus
7	3/26/2021	17009.6	16795.2	36	Marcellus
8	3/27/2021	16757.13333	16542.7333	36	Marcellus
9	3/27/2021	16504.66667	16290.2667	36	Marcellus
10	3/27/2021	16252.2	16037.8	36	Marcellus
11	3/27/2021	15999.73333	15785.3333	36	Marcellus
12	3/28/2021	15747.26667	15532.8667	36	Marcellus
13	3/28/2021	15494.8	15280.4	36	Marcellus
14	3/28/2021	15242.33333	15027.9333	36	Marcellus
15	3/28/2021	14989.86667	14775.4667	36	Marcellus
16	3/29/2021	14737.4	14523	36	Marcellus
17	3/29/2021	14430	14215.6	36	Marcellus
18	3/29/2021	14182.65714	13968.2571	36	Marcellus
19	3/29/2021	13935.31429	13720.9143	36	Marcellus
20	3/29/2021	13687.97143	13473.5714	36	Marcellus
21	3/30/2021	13440.62857	13226.2286	36	Marcellus
22	3/30/2021	13193.28571	12978.8857	36	Marcellus
23	3/30/2021	12945.94286	12731.5429	36	Marcellus
24	3/30/2021	12698.6	12484.2	36	Marcellus
25	3/31/2021	12451.25714	12236.8571	36	Marcellus
26	3/31/2021	12203.91429	11989.5143	36	Marcellus
27	3/31/2021	11956.57143	11742.1714	36	Marcellus
28	3/31/2021	11709.22857	11494.8286	36	Marcellus
29	4/1/2021	11461.88571	11247.4857	36	Marcellus
30	4/1/2021	11214.54286	11000.1429	36	Marcellus
31	4/1/2021	10967.2	10752.8	36	Marcellus
32	4/1/2021	10719.85714	10505.4571	36	Marcellus
33	4/2/2021	10472.51429	10258.1143	36	Marcellus
34	4/2/2021	10225.17143	10010.7714	36	Marcellus
35	4/2/2021	9977.828571	9763.42857	36	Marcellus
36	4/2/2021	9730.485714	9516.08571	36	Marcellus
37	4/3/2021	9483.142857	9268.74286	36	Marcellus
38	4/3/2021	9235.8	9021.4	36	Marcellus
39	4/3/2021	8988.457143	8774.05714	36	Marcellus
40	4/3/2021	8741.114286	8526.71429	36	Marcellus
41	4/3/2021	8493.771429	8279.37143	36	Marcellus
42	4/4/2021	8246.428571	8032.02857	36	Marcellus
43	4/4/2021	7999.085714	7784.68571	36	Marcellus
44	4/4/2021	7751.742857	7537.34286	36	Marcellus
45	4/4/2021	7504.4	7290	36	Marcellus

RECEIVED  
Office of Oil and Gas

AUG 30 2021

WV Department of  
Environmental Protection

10/01/2021



**EXHIBIT 2**

Stage No.	Stimulations Date	Avg Pump Rate	Avg Treatment Pressure (PSI)	Max Breakdown Pressure (PSI)	ISIP (PSI)	Amount of Proppant (lbs)	Amount of Water (bbls)	Amount of Nitrogen/ other (units)
1	3/24/2021	75.14	8115	6270	4296	168383	211037	N/A
2	3/24/2021	84.86	8734	5084	4825	499237	374388	N/A
3	3/25/2021	85.25	8708	5151	4199	499500	371998	N/A
4	3/26/2021	85.91	8652	4985	4197	506000	372172	N/A
5	3/26/2021	84.8	8528	5287	4446	499569	382285	N/A
6	3/26/2021	87.06	8687	5263	4553	499893	377983	N/A
7	3/26/2021	87.44	8822	5359	4499	498720	363041	N/A
8	3/27/2021	86.31	8827	5461	4556	499080	356423	N/A
9	3/27/2021	78.98	8758	4715	4198	499425	378910	N/A
10	3/27/2021	85.82	8780	5277	4200	499538	360146	N/A
11	3/27/2021	83.3	8817	5795	4726	502985	361953	N/A
12	3/28/2021	86.84	8777	5105	4935	499340	359157	N/A
13	3/28/2021	86.5	8829	5013	4290	499705	362166	N/A
14	3/28/2021	87.23	8867	5811	4864	499870	361012	N/A
15	3/28/2021	85.83	8802	5128	4648	499720	359253	N/A
16	3/29/2021	86.16	8803	5288	4654	499980	357445	N/A
17	3/29/2021	90.38	8787	5200	4566	499883	367180	N/A
18	3/29/2021	89.47	8825	4724	4420	499635	360241	N/A
19	3/29/2021	91.01	8750	5180	4632	499678	354536	N/A
20	3/29/2021	91.1	8806	5386	4681	500680	357652	N/A
21	3/30/2021	94.36	8698	4942	4526.2	499140	358119	N/A
22	3/30/2021	87.09	8686.71	4819.72	4463.94	499497	365320	N/A
23	3/30/2021	86.46	8768	5502	4148	499128	356696	N/A
24	3/30/2021	90.33	8592	5439	4307	499625	359708	N/A
25	3/31/2021	89.5	8690	5402	4216	499072	355352	N/A
26	3/31/2021	90.89	8320	4989	4520	500135	361882	N/A
27	3/31/2021	95.21	8647	5501	4271	500127	372770	N/A
28	3/31/2021	92.63	8708	5773	4051	500454	367076	N/A
29	4/1/2021	93.68	8711	5505	4022	505523	368031	N/A
30	4/1/2021	93.22	8391	5549	4409	499736	373220	N/A
31	4/1/2021	92.68	8428	5722	4101	498717	368623	N/A
32	4/1/2021	97.01	8712	6077	4299	499786	367175	N/A
33	4/2/2021	98.06	8683	4696	4303	499832	369028	N/A
34	4/2/2021	97.39	8501	5080	4940	499705	371035	N/A
35	4/2/2021	98.99	8462	5105	3838	500489	370515	N/A
36	4/2/2021	99.19	8525	5784	4837	499457	365842	N/A
37	4/3/2021	98.5	7929	5782	4811.45	499963	362240	N/A
38	4/3/2021	98.81	8019	5943	4787	510820	370671	N/A
39	4/3/2021	99.57	7852	5679	4345	499705	369670	N/A
40	4/3/2021	98.98	8071	5669	3817	499546	372142	N/A
41	4/3/2021	98.54	7977	6006	3812	500542	365485	N/A
42	4/4/2021	98.54	7920	5239	3936	499600	362193	N/A
43	4/4/2021	99.43	7708	6027	4044	499806	365741	N/A
44	4/4/2021	97.77	7438	5763	3909	499586	366171	N/A
45	4/4/2021	100.13	7553	5885	4585	501648	372701	N/A
	AVG=	91	8,504	5,408	4,393	22,182,460	16,306,384	TOTAL

RECEIVED  
 Department of Oil and Gas  
 0 2021  
 Department of Environmental Protection

## EXHIBIT 3

LITHOLOGY/ FORMATION	TOP DEPTH (TVD)	BOTTOM DEPTH (TVD)	TOP DEPTH (MD)	BOTTOM DEPTH (MD)
	From Surface	From Surface	From Surface	From Surface
Shaley Siltstone	120	210	120	210
Shale	210	390	210	390
Silty Shale	390	480	390	480
Shale	480	810	480	810
Silty Shale	810	840	810	840
Shaley Sandstone	840	960	840	960
Shaley Sandstone	960	1,050	960	1,050
Shale	1,050	1,110	1,050	1,110
Sandy Shale	1,110	1,230	1,110	1,230
Shaley Sandstone	1,230	1,290	1,230	1,290
Sandstone, Tr Shale, Tr Silt	1,290	1,710	1,290	1,710
Shaley Sandstone, Occ Coal	1,710	1,890	1,710	1,890
Sandy Shale, Tr Coal, Tr Limestone	1,890	2,145	1,890	2,145
Big Lime	2,175	2,771	2,175	2,772
Fifty Foot Sandstone	2,771	2,855	2,772	2,856
Gordon	2,855	3,143	2,856	3,147
Fifth Sandstone	3,143	3,346	3,147	3,354
Bayard	3,346	3,980	3,354	3,999
Speechley	3,980	4,287	3,999	4,313
Balltown	4,287	4,673	4,313	4,706
Bradford	4,673	5,164	4,706	5,208
Benson	5,164	5,467	5,208	5,515
Alexander	5,467	6,728	5,515	6,838
Sycamore	6,483	6,698	6,557	6,808
Middlesex	6,698	6,838	6,808	7,031
Burkett	6,838	6,868	7,031	7,091
Tully	6,868	6,927	7,091	7,238
Marcellus	6,927	NA	7,238	NA

\*Please note Antero determines formation tops based on mud logs that are only run on one well on a multi-well pad. The measured depth (MD) data on subsequent wells may be slightly different due to the well's unique departure.

RECEIVED  
Office of Oil and Gas

AUG 30 2021

WV Department of  
Environmental Protection

10/01/2021

# Hydraulic Fracturing Fluid Product Component Information Disclosure

Job Start Date:	3/24/2021
Job End Date:	4/4/2021
State:	West Virginia
County:	Doddridge
API Number:	47-017-06901-00-00
Operator Name:	Antero Resources Corporation
Well Name and Number:	RUSSELL UNIT 2H
Latitude:	39.30322000
Longitude:	-80.74646000
Datum:	NAD83
Federal Well:	NO
Indian Well:	NO
True Vertical Depth:	7,009
Total Base Water Volume (gal):	16,920,009
Total Base Non Water Volume:	0



## Hydraulic Fracturing Fluid Composition:

Trade Name	Supplier	Purpose	Ingredients	Chemical Abstract Service Number (CAS #)	Maximum Ingredient Concentration in Additive (% by mass)**	Maximum Ingredient Concentration in HF Fluid (% by mass)**	Comments
Produced Water Mixture	Halliburton	Base Fluid					
			Water	7732-18-5	100.00000	86.52712	Density = 8.50
Ingredients	Listed Above	Listed Above					
			Water	7732-18-5	100.00000	0.05140	

RECEIVED  
 Office of Oil and Gas  
 Environmental Protection  
 Department of  
 Environmental Protection  
 AUG 30 2021



Sand-Common White-100 Mesh, SSA-2	Halliburton	Proppant					
				Listed Below			
FLUID Enviro-Syn HCR-7000-WL	Fluid Energy Group	Acid Replacement					
				Listed Below			
OPTIFLO-II DELAYED RELEASE BREAKER	Halliburton	Breaker					
				Listed Below			
MC B-8614A	MultiChem	Biocide					
				Listed Below			
HYDROCHLORIC ACID, 22 BAUME	Halliburton	Solvent					
				Listed Below			
WG-36 GELLING AGENT	Halliburton	Gelling Agent					
				Listed Below			
HAI-501	Halliburton	Acid Corrosion Inhibitor					
				Listed Below			
Excelerate LX-15	Halliburton	Friction Reducer					
				Listed Below			

WV Department of Environmental Protection

AUG 30 2021

RECEIVED  
 Office of Oil and Gas

Items above are Trade Names with the exception of Base Water . Items below are the individual ingredients.

		Crystalline silica, quartz	14808-60-7	100.00000	13.34574
		Complex Amine Compound	Proprietary	60.00000	0.02638
		Hydrotreated light petroleum distillate	64742-47-8	30.00000	0.01319
		Proprietary	Proprietary	20.00000	0.01076
		Proprietary	Proprietary	10.00000	0.00538
		Hydrochloric acid	7647-01-0	30.00000	0.00495
		Guar gum	9000-30-0	100.00000	0.00426
		Glutaraldehyde	111-30-8	30.00000	0.00256
		Sorbitan, mono-9-octadecenoate, (Z)	1338-43-8	5.00000	0.00220
		Surfactant	Proprietary	5.00000	0.00220
		Ethoxylated alcohols	Proprietary	5.00000	0.00044
		Organic chloride compound	Proprietary	1.00000	0.00044
		Alkoxylated polyhydric alcohol	Proprietary	1.00000	0.00044
		Alkyl (C12-16) dimethylbenzyl ammonium chloride	68424-85-1	5.00000	0.00043
		Ethanol	64-17-5	1.00000	0.00009
		Ammonium persulfate	7727-54-0	100.00000	0.00008
		Methanol	67-56-1	100.00000	0.00003
		Oxylated phenolic resin	Proprietary	30.00000	0.00002
		Modified thiourea polymer	Proprietary	30.00000	0.00001
		Mixture of dimer and trimer fatty acids of indefinite composition derived from tall oil	61790-12-3	30.00000	0.00001
		Organic salt #2	Proprietary	0.01000	0.00000
		Formaldehyde	50-00-0	0.01000	0.00000
		Nitrated acetate salt	Proprietary	0.01000	0.00000
		Sodium hydroxide	1310-73-2	0.01000	0.00000

RECEIVED  
 Office of Oil and Gas  
 AUG 30 2021  
 WV Department of  
 Environmental Protection

			Acrylamide	79-06-1	0.01000	0.00000	
			Sodium glycolate	2836-32-0	0.01000	0.00000	
			Organic salt #1	Proprietary	0.01000	0.00000	
			Hexadecene	629-73-2	5.00000	0.00000	
			Propargyl alcohol	107-19-7	5.00000	0.00000	
			C.I. pigment Orange 5	3468-63-1	1.00000	0.00000	

\* Total Water Volume sources may include various types of water including fresh water, produced water, and recycled water

\*\* Information is based on the maximum potential for concentration and thus the total may be over 100%

\*\*\* If you are calculating a percentage of total ingredients do not add the water volume below the green line to the water volume above the green line

Note: For Field Development Products (products that begin with FDP), MSDS level only information has been provided.

Ingredient information for chemicals subject to 29 CFR 1910.1200(i) and Appendix D are obtained from suppliers Material Safety Data Sheets (MSDS)

RECEIVED  
Office of Oil and Gas  
WV Department of  
Environmental Protection  
AUG 30 2021

LATITUDE 39°20'00"

10,789'

6,660' TO BOTTOM HOLE

LATITUDE 39°17'30"

Antero Resources Corporation Well No. Russell Unit 2H

NOTES: WELL 2H TOP HOLE INFORMATION: N: 294,996ft E: 1,647,283ft LAT: 39°18'11.59" LON: 80°44'47.25" BOTTOM HOLE INFORMATION: N: 284,354ft E: 1,651,269ft LAT: 39°16'26.96" LON: 80°43'54.69" WEST VIRGINIA COORDINATE SYSTEM OF 1927 NORTH ZONE. ZONE WAS DERIVED FROM MEASUREMENTS TAKEN WITH TRIMBLE GEOXT SUBMETER MAPPING GRADE GPS UNIT. PLAT ORIENTATION, CORNER, AND WELL REFERENCE TIE LINES ARE BASED ON GRID NORTH.

(NAD) 83 (UTM) ZONE 17 COORDS: WELL 2H TOP HOLE INFORMATION: N: 4,350,466m E: 521,876m BOTTOM HOLE INFORMATION: N: 4,347,244m E: 523,144m

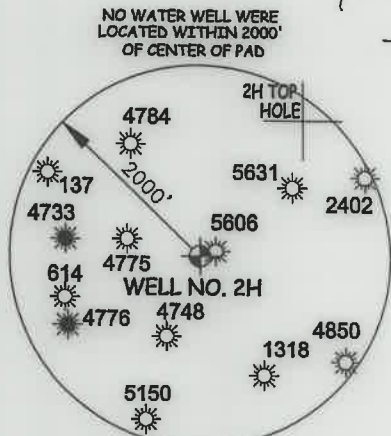
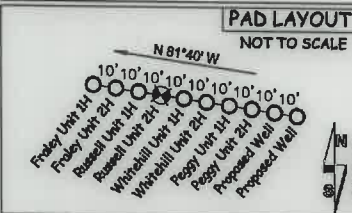

NO WATER WELL WERE LOCATED WITHIN 2000' OF CENTER OF PAD

Table listing landowners and lease numbers for the West Union District - Doddridge County. Includes names like David Sponagle, Michael O'Brien, John Smith, etc.

6,379' TO BOTTOM HOLE

10,968'

LONGITUDE 80°42'30"

LONGITUDE 80°42'30"

I THE UNDERSIGNED, HEREBY CERTIFY THAT THIS PLAT IS CORRECT TO THE BEST OF MY KNOWLEDGE AND BELIEF AND SHOWS ALL THE INFORMATION REQUIRED BY LAW AND THE RULES ISSUED AND PERSCRIBED BY THE DEPARTMENT OF ENVIRONMENTAL PROTECTION.



STATE OF WEST VIRGINIA, DIVISION OF ENVIRONMENTAL PROTECTION, OFFICE OF OIL AND GAS

WILLOW LAND SURVEYING PLLC 220 MASONIC AVE. PENNSBORO WEST VIRGINIA 26415

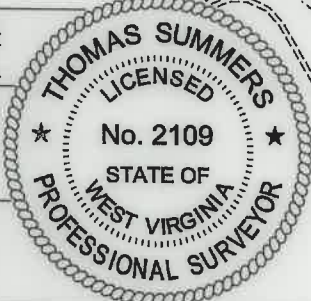

JOB # 19-030WA DRAWING # RUSSELL2HAD SCALE 1" = 2000' MINIMUM DEGREE OF ACCURACY SUBMETER PROVEN SOURCE OF ELEV. SUBMETER MAPPING GRADE GPS

LEGEND: Surface Owner Boundary Lines +/- Interior Surface Tracts +/- Proposed Well Path As Drilled Well Path. Includes signature of Thomas Summers and name THOMAS SUMMERS P.S. 2109.

NOTE: 1. NO OCCUPIED DWELLINGS OR BUILDINGS TWO THOUSAND FIVE HUNDRED (2,500) SQUARE FEET OR LARGER USED TO HOUSE OR SHELTER DAIRY CATTLE OR POULTRY HUSBANDRY ARE LOCATED WITHIN SIX HUNDRED TWENTY-FIVE (625) FEET OF THE CENTER OF THE WELL PAD. 2. TOP HOLE DATA SHOWN HEREON WAS PROVIDED BY ANTERO RESOURCES CORPORATION. 3. AS DRILLED DATA WAS PROVIDED BY ANTERO RESOURCES CORPORATION. 4. WLS IS NOT CERTIFYING THE DATA AND INFORMATION PROVIDED LISTED IN NOTES 2 AND 3, ONLY THE RELATIONSHIP TO THE DATA AND INFORMATION PROVIDED TO THE LEASE BOUNDARIES. 5. WLS IS BY NO MEANS RESPONSIBLE FOR ANY ERRORS OR INACCURACIES WITH THE DATA AND INFORMATION THAT HAS BEEN PROVIDED.

WELL 2H POINT OF ENTRY INFORMATION: N: 295,010ft E: 1,647,876ft LAT: 39°18'11.82" LON: 80°44'39.70" N: 4,350,474m E: 522,056m

Form containing well details: WELL TYPE: OIL GAS X LIQUID INJECTION WASTE DISPOSAL 47 017 06901 (IF "GAS") PRODUCTION X STORAGE DEEP SHALLOW X STATE COUNTY PERMIT LOCATION: ELEVATION 1,275' - AS BUILT WATERSHED HEADWATERS MIDDLE ISLAND CREEK QUADRANGLE SMITHBURG 7.5 DISTRICT WEST UNION COUNTY DODDRIDGE SURFACE OWNER SAMUEL AND PEGGY SMITH ACREAGE 28.956 ACRES +/- 10/01/2021 OIL & GAS ROYALTY OWNER ELAINE DEBOLT; R.L. BARNES ET UX; EQT PRODUCTION COMPANY; HARLAND E. SISLER; WVSRA; WVDNR; PATHFINDER RESOURCES, LLC; MARY N. KISSINGER; W.L. DAVIS ET UX; CNX GAS COMPANY LLC; PAULA LAFFERTY LEASE ACREAGE 84.8 AC +/- 222 AC +/- 75 AC +/- 7 AC +/- 301.19 AC +/- 54.48 AC +/- 138.58 AC +/- 81.58 AC +/- 265 AC +/- 1.32 AC +/- 44.9 AC +/- PROPOSED WORK: DRILL CONVERT DRILL DEEPER REDRILL FRACTURE OR STIMULATE PLUG OFF OLD FORMATION PERFORATE NEW FORMATION OTHER PHYSICAL CHANGE IN WELL (SPECIFY) AS DRILLED TARGET FORMATION MARCELLUS PLUG & ABANDON CLEAN OUT & REPLUG WELL OPERATOR ANTERO RESOURCES CORP. ESTIMATED DEPTH 6,880' TVD 18,460' MD DESIGNATED AGENT DIANNA STAMPER - CT CORPORATION SYSTEM ADDRESS 1615 WYNKOOP ST. DENVER, CO 80202 ADDRESS 5400 D BIG TYLER ROAD CHARLESTON, WV 25313