

LATITUDE 39°17'30"

2,254'

LATITUDE 39°17'30"

2,992' TO BOTTOM HOLE

6,952' TO BOTTOM HOLE

14,039'

LONGITUDE 80°47'30"

Antero Resources Corporation Well No. Redwood 2H

NOTES:

WELL 2H TOP HOLE INFORMATION: N: 276,964ft E: 1,631,974ft LAT: 39°15'11.24" LON: 80°47'58.66" BOTTOM HOLE INFORMATION: N: 284,061ft E: 1,631,339ft LAT: 39°16'21.29" LON: 80°48'08.04" WEST VIRGINIA COORDINATE SYSTEM OF 1927 NORTH ZONE. ZONE WAS DERIVED FROM MEASUREMENTS TAKEN WITH TRIMBLE GEOXT SUBMETER MAPPING GRADE GPS UNIT. PLAT ORIENTATION, CORNER, AND WELL REFERENCE TIE LINES ARE BASED ON GRID NORTH.

(NAD) 83 (UTM) ZONE 17 COORDS: WELL 2H TOP HOLE INFORMATION: N: 4,344,895m E: 517,303m BOTTOM HOLE INFORMATION: N: 4,347,054m E: 517,074m

(NAD) 27 (UTM) ZONE 17 COORDS: WELL 2H TOP HOLE INFORMATION: N: 14,254,161ft E: 1,697,139ft POINT OF ENTRY INFORMATION: N: 14,254,099ft E: 1,697,211ft BOTTOM HOLE INFORMATION: N: 14,261,244ft E: 1,696,386ft

NOTE: NO OCCUPIED DWELLINGS OR BUILDINGS TWO THOUSAND FIVE HUNDRED (2,500) SQUARE FEET OR LARGER USED TO HOUSE OR SHELTER DAIRY CATTLE OR POULTRY HUSBANDRY ARE LOCATED WITHIN SIX HUNDRED TWENTY-FIVE (625) FEET OF THE CENTER OF THE WELL PAD.

Table listing landowners and lease information for the West Union District, including names like Alfred Perine, Gail DeBerry, Lisa Meyer, Dennis Hayes, Marvin Rollins, Glenn Whitehair, Mark Smith, Michael Mignaneli, Richard Leggett, Richard Leggett, Richard Leggett, Mary Neeler, Danny Harris, Roger Batten, Danny Harris, Coastal Forest Resources Co, Doddridge County Board of Education, Coastal Forest Resources Co, Coastal Forest Resources Co, Coastal Forest Resources Co, Drexelene Perrine, Michael Wilkinson, John Trent, Loren Smith, Kenneth Hughes, Glade Perine, Donald Perine, EQM Gathering OPCO LLC, Michael Britton, Russell Nielson, Arnold Creek UB Church, Michael Wilkinson, Loren Smith, EQM Gathering OPCO LLC, Loren Smith, Jessie Vanscoy, Loren Smith, Diane Bennett, CNE Transmission Corp, Loren Smith, and Mary Secrist.

WV NORTH ZONE GRID NORTH



I THE UNDERSIGNED, HEREBY CERTIFY THAT THIS PLAT IS CORRECT TO THE BEST OF MY KNOWLEDGE AND BELIEF AND SHOWS ALL THE INFORMATION REQUIRED BY LAW AND THE RULES ISSUED AND PERSCRIBED BY THE DEPARTMENT OF ENVIRONMENTAL PROTECTION.



STATE OF WEST VIRGINIA, DIVISION OF ENVIRONMENTAL PROTECTION, OFFICE OF OIL AND GAS. WILLOW LAND SURVEYING PLLC, 220 MASONIC AVE. PENNSBORO WEST VIRGINIA 26415.

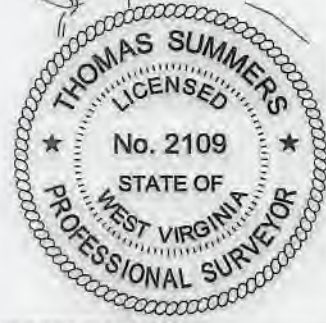

JOB # 19-039WA DRAWING # REDWOOD2H SCALE 1" = 2000' MINIMUM DEGREE OF ACCURACY SUBMETER PROVEN SOURCE OF ELEV. SUBMETER MAPPING GRADE GPS STATE OF WEST VIRGINIA DEPARTMENT OF ENERGY DIVISION OF OIL AND GAS

LEGEND: Surface Owner Boundary Lines +/-, Adjoining Surface Tracts +/-, Found monument, as noted. Signature of Thomas Summers, P.S. 2109. DATE 08/04/22 OPERATOR'S WELL # REDWOOD 2H

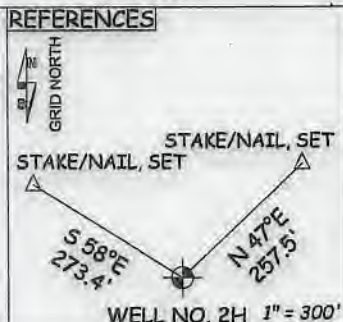
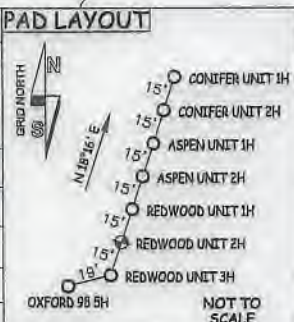

WELL TYPE: OIL \_\_\_ GAS X LIQUID INJECTION \_\_\_ WASTE DISPOSAL \_\_\_ 47 - 017 - 06931 (IF "GAS") PRODUCTION X STORAGE \_\_\_ DEEP \_\_\_ SHALLOW X STATE COUNTY PERMIT LOCATION: ELEVATION 1,120' - AS BUILT WATERSHED HEADWATERS MIDDLE ISLAND CREEK QUADRANGLE WEST UNION 7.5 DISTRICT WEST UNION COUNTY DODDRIDGE SURFACE OWNER MICHAEL R. BRITTON & ANGELA D. PRATT ACREAGE 136.56 ACRES +/- OIL & GAS ROYALTY OWNER MICHAEL S. FRANCIS ET AL; RICHARD W. MINNIS ET AL; LEASE ACREAGE 173 AC±; 69 AC±; JAMES P. GAINES ET UX; SHIRLEY W. FLEMING; FRANKLIN L. BUTLER; J.S.NETZER ET UX; 200 AC±; 29 AC±; 109 AC±; 85 AC±; WILMER ROLLINS ET UX; EMORY ROLLINS ET UX; A. K. ROLLINS ET UX; 75 AC±; 44 AC±; 40 AC± PROPOSED WORK: DRILL \_\_\_ CONVERT \_\_\_ DRILL DEEPER X REDRILL \_\_\_ FRACTURE OR STIMULATE X PLUG OFF OLD FORMATION \_\_\_ PERFORATE NEW FORMATION X OTHER PHYSICAL CHANGE IN WELL (SPECIFY) MOD-BHL PLUG & ABANDON CLEAN OUT & REPLUG TARGET FORMATION MARCELLUS ESTIMATED DEPTH 6,600' TVD 16,400' MD WELL OPERATOR ANTERO RESOURCES CORP. DESIGNATED AGENT DIANNA STAMPER - CT CORPORATION SYSTEM ADDRESS 1615 WYNKOOP ST. DENVER, CO 80202 ADDRESS 5400 D BIG TYLER ROAD CHARLESTON, WV 25313

09/02/2022

COUNTY NAME

PERMIT