

LATITUDE 39°20'00"

3882'

LATITUDE 39°17'30"

Antero Resources Corporation Well No. Phebe Unit 1H

AS DRILLED DATA:

WELL 1H TOP HOLE INFORMATION: N: 303,156ft E: 1,666,088ft LAT: 39°19'34.75" LON: 80°40'49.39" BOTTOM HOLE INFORMATION: N: 289,185ft E: 1,671,938ft LAT: 39°17'17.42" LON: 80°39'32.66" WEST VIRGINIA COORDINATE SYSTEM OF 1927 NORTH ZONE. ZONE WAS DERIVED FROM MEASUREMENTS TAKEN WITH TRIMBLE GEOXT SUBMETER MAPPING GRADE GPS UNIT. PLAT ORIENTATION, CORNER, AND WELL REFERENCE TIE LINES ARE BASED ON GRID NORTH.

(NAD) 83 (UTM) ZONE 17 COORDS: WELL 1H TOP HOLE INFORMATION: N: 4,353,048m E: 527,563m BOTTOM HOLE INFORMATION: N: 4,348,821m E: 529,417m

PAD LAYOUT

NOT TO SCALE

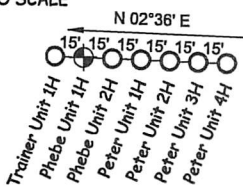

NOTE

- 1. NO OCCUPIED DWELLINGS OR BUILDINGS TWO THOUSAND FIVE HUNDRED (2,500) SQUARE FEET OR LARGER USED TO HOUSE OR SHELTER DAIRY CATTLE OR POULTRY HUSBANDRY ARE LOCATED WITHIN SIX HUNDRED TWENTY-FIVE (625) FEET OF THE CENTER OF THE WELL PAD.
2. TOP HOLE DATA SHOWN HEREON WAS PROVIDED BY ANTERO RESOURCES CORPORATION.
3. AS DRILLED DATA WAS PROVIDED BY ANTERO RESOURCES CORPORATION.
4. WLS IS NOT CERTIFYING THE DATA AND INFORMATION PROVIDED LISTED IN NOTES 2 AND 3, ONLY THE RELATIONSHIP TO THE DATA AND INFORMATION PROVIDED TO THE LEASE BOUNDARIES.
5. WLS IS BY NO MEANS RESPONSIBLE FOR ANY ERRORS OR INACCURACIES WITH THE DATA AND INFORMATION THAT HAS BEEN PROVIDED.

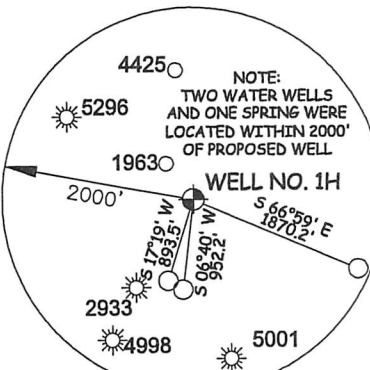

GRANT DISTRICT - DODDRIDGE COUNTY

Table listing land grant information for various parcels, including parcel numbers (e.g., 9-34, 10-25, 13-05) and owner names (e.g., HFP LLC, DENNIS POWELL, JEFFERY HILL, DANNY MARSHALL).

(NAD) 27 (UTM) ZONE 17 COORDS: WELL 1H TOP HOLE INFORMATION: N: 14,280,909ft E: 1,730,800ft POINT OF ENTRY INFORMATION: N: 14,281,291ft E: 1,732,020ft BOTTOM HOLE INFORMATION: N: 14,267,042ft E: 1,736,880ft

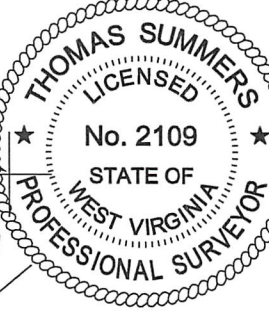

MINERAL OWNERSHIP

Table listing mineral ownership for various parcels, including owner names and parcel numbers (e.g., CREED JONES ET AL, DEBORIS NADINE DAVIS, MARIETTE LEMLEY ET AL).



STATE OF WEST VIRGINIA, DIVISION OF ENVIRONMENTAL PROTECTION, OFFICE OF OIL AND GAS

WILLOW LAND SURVEYING PLLC 220 MASONIC AVE. PENNSBORO WEST VIRGINIA 26415

LEGEND

- Surface Owner Boundary Lines +/-
Interior Surface Tracts +/-
Proposed Well Path
As Drilled Well Path

THOMAS SUMMERS P.S. 2109

DATE 05/09/23

OPERATOR'S WELL# PHEBE UNIT #1H

API WELL # 47 - 017 - 06937

STATE COUNTY PERMIT

JOB # 17-030WA
DRAWING # PHEBE1HAD
SCALE 1" = 2000'
MINIMUM DEGREE OF ACCURACY SUBMETER
PROVEN SOURCE OF ELEV. SUBMETER MAPPING GRADE GPS

STATE OF WEST VIRGINIA DEPARTMENT OF ENERGY DIVISION OF OIL AND GAS
WELL TYPE: OIL GAS X LIQUID INJECTION WASTE DISPOSAL
(IF "GAS") PRODUCTION X STORAGE DEEP SHALLOW X
LOCATION: ELEVATION 1,304' AS BUILT WATERSHED MCELROY CREEK
QUADRANGLE SMITHBURG 7.5' DISTRICT GRANT COUNTY DODDRIDGE

SURFACE OWNER BRIAN D. LEMLEY & CHRISTY M. LEMASTER ET AL ACREAGE 59.08 ACRES +/-
OIL & GAS ROYALTY OWNER MARIETTE LEMLEY ET AL; SIDNEY AUSTIN SMITH TRUST LLC; CHAD W. JOHNSON; LEASE ACREAGE 66.87 AC±; 50 AC±; 31.96 AC±; JOYCE A. BATES; SIDNEY THOMPSON; PAULA KAY REYNOLDS; Z.T. BALL ET UX; WILLIAM C. HUNTER; ANTERO MINERALS LLC; WILLIAM C. HUNTER; 47.88 AC±; 98 AC±; 79.06 AC±; 138 AC±; 11.85 AC±; 6.29 AC±; 21.75 AC±; GARY G. WILCOX; EMAX GAS CO. ET AL; EMAX GAS CO. ET AL; PERRY TATE; F. G. ORR ET AL; LINDA R. NEPPS; RANDALL E. SHEARER 6.9 AC±; 49.5 AC±; 81 AC±; 70 AC±; 172 AC±; 189.88 AC±; 212.5 AC±

PROPOSED WORK: DRILL CONVERT DRILL DEEPER REDRILL FRACTURE OR STIMULATE
PLUG OFF OLD FORMATION PERFORATE NEW FORMATION OTHER PHYSICAL CHANGE IN WELL
(SPECIFY) AS DRILLED PLUG & ABANDON CLEAN OUT & REPLUG

TARGET FORMATION MARCELLUS ESTIMATED DEPTH 7,169' TVD 22,748' MD
WELL OPERATOR ANTERO RESOURCES CORP. DESIGNATED AGENT KEVIN ELLIS
ADDRESS 1615 WYNKOOP STREET ADDRESS 535 WHITE OAKS BLVD
FORM WW-6 DENVER, CO 80202 BRIDGEPORT, WV 26330

02/09/2024

COUNTY PERMIT NAME