

Antero Resources Corporation
Well No. Trainer Unit 1H

AS DRILLED DATA:
WELL 1H TOP HOLE INFORMATION:
N: 303,171ft E: 1,666,089ft
LAT: 39°19'34.90" LON: 80°40'49.39"
BOTTOM HOLE INFORMATION:
N: 288,827ft E: 1,670,626ft
LAT: 39°17'13.72" LON: 80°39'49.30"
WEST VIRGINIA COORDINATE SYSTEM OF 1927 NORTH ZONE. ZONE WAS DERIVED FROM MEASUREMENTS TAKEN WITH TRIMBLE GEOXT SUBMETER MAPPING GRADE GPS UNIT. PLAT ORIENTATION, CORNER, AND WELL REFERENCE TIE LINES ARE BASED ON GRID NORTH.

(NAD) 83 (UTM) ZONE 17 COORDS:
WELL 1H TOP HOLE INFORMATION:
N: 4,353,052m E: 527,564m
BOTTOM HOLE INFORMATION:
N: 4,348,705m E: 529,019m

WV NORTH ZONE
GRID NORTH

MINERAL OWNERSHIP

A	CNX GAS COMPANY, LLC
B	CREED JONES ET AL
C	DEBORIS NADINE DAVIS
D	MARIETTE LEMLEY ET AL
E	SIDNEY AUSTIN SMITH TRUST LLC
F	LIDIA MAE ROLLINS
G	JOYCE A. BATES
H	JOYCE A. BATES
I	KEITH SMITH
J	SIDNEY THOMPSON
K	DAVIS & ELKINS COLLEGE
L	RITA FORSYTHE
M	U.C. AMETT ET UX
N	Z.T. BALL ET UX
O	DELBERT E. LEATHERMAN
P	EARL BALIS SR.
Q	DEPI
R	LARRY C. CALICOAT
S	GARY G. WILCOX
T	CAROL DIANE BOYD
U	EMAX GAS CO. ET AL
V	PERRY TATE
W	EMAX GAS CO. ET AL
X	STANLEY E. DAVIS ET UX
Y	RANDALL B. SHEARER

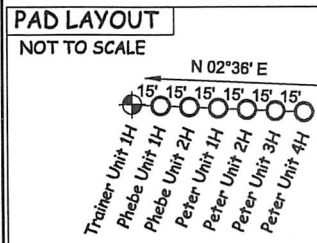

GRANT DISTRICT - DODDRIDGE COUNTY

9-34	HFF LLC
10-25	DENNIS POWELL
13-05	HFF LLC
13-11	JEFFERY HILL
13-11.1	JEFFERY HILL
13-11.2	JEFFERY HILL
13-20	DANNY MARSHALL
13-20.2	SIVLINE COMMUNICATIONS
13-20.4	DANNY MARSHALL
13-25	ALDEN MOORE
13-26	JOHN ARCHER
13-35	JEFFERY HILL
14-03	ANDREW LETT
14-12	ANDREW LETT
14-12.1	ANDREW LETT
14-13	ETHEL CHILDERS
14-27	JOHN ARCHER
14-28	JOHN ARCHER
14-29	SARAH BUTLER
14-31.1	MARVIN SWENTZEL
14-32	JOHN ARCHER
14-33	NEIL SWENTZEL
14-33.1	NEIL SWENTZEL
14-33.2	ALVIN SWENTZEL
14-39	PAUL BAKER
14-43	DANNY MARSHALL
14-44	CHARLES POWELL
16-03	CAROL BOYD
17-02	MARVIN SWENTZEL
17-03	ALVIN SWENTZEL
17-09	DWAYNE BUNTING
17-9.1	SHIRLEY BUNTING
17-9.2	SHIRLEY BUNTING
17-11	DOUGLAS LUTZ
17-18	TOBEY NUTT
17-19	GARY HYATT
17-31	KIMBERLY TUSTIN
17-31.1	SAMMY GAIN
17-31.2	TOBY GAIN
17-32.1	DAVID KIMBALL
17-33	SHARON POWELL
17-51	RICHARD NICHOLSON
17-52	PATRICIA WOLFORD
17-53	MARK MATHENY
17-54	CHELOTTIE SAMPLES
17-55	LARRY FERGUSON
17-56	RICHARD BARNETT
17-57	DAVID KIMBALL
17-58	JOSHUA HARRIS
17-59	TOD INGRAM
17-60	ALFRED GEISLER
17-61	MARK MATHENY
17-62	DAVY WETZEL
17-63	RICHARD DAVIS
17-64	COLE DOTSON
17-66	JULIE MATHENY

(NAD) 27 (UTM) ZONE 17 COORDS:
WELL 1H TOP HOLE INFORMATION:
N: 14,280,924ft E: 1,730,801ft
POINT OF ENTRY INFORMATION:
N: 14,280,849ft E: 1,730,755ft
BOTTOM HOLE INFORMATION:
N: 14,266,662ft E: 1,735,574ft

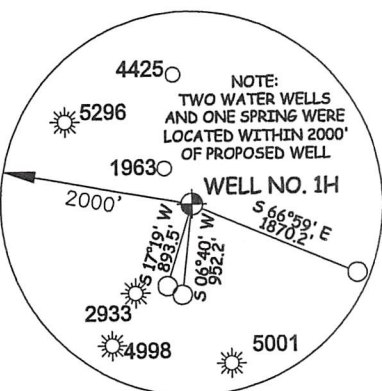

JOB # 17-030WA
DRAWING # TRAINER1HAD
SCALE 1" = 2000'
MINIMUM DEGREE OF ACCURACY SUBMETER
PROVEN SOURCE OF ELEV. SUBMETER MAPPING GRADE GPS

I THE UNDERSIGNED, HEREBY CERTIFY THAT THIS PLAT IS CORRECT TO THE BEST OF MY KNOWLEDGE AND BELIEF AND SHOWS ALL THE INFORMATION REQUIRED BY LAW AND THE RULES ISSUED AND PERSCRIBED BY THE DEPARTMENT OF ENVIRONMENTAL PROTECTION.



STATE OF WEST VIRGINIA, DIVISION OF ENVIRONMENTAL PROTECTION, OFFICE OF OIL AND GAS

WILLOW LAND SURVEYING PLLC
220 MASONIC AVE. PENNSBORO WEST VIRGINIA 26415

LEGEND
--- Surface Owner Boundary Lines +/-
--- Interior Surface Tracts +/-
○ Proposed Well Path
⊗ As Drilled Well Path

THOMAS SUMMERS P.S. 2109
DATE 05/09/23

OPERATOR'S WELL# TRAINER UNIT 1H
API WELL # 47 - 017 - 06939
STATE COUNTY PERMIT

STATE OF WEST VIRGINIA DEPARTMENT OF ENERGY DIVISION OF OIL AND GAS
WELL TYPE: OIL GAS LIQUID INJECTION WASTE DISPOSAL
(IF "GAS") PRODUCTION STORAGE DEEP SHALLOW
LOCATION: ELEVATION 1,304' AS BUILT WATERSHED MCELROY CREEK
QUADRANGLE SMITHBURG 7.5' DISTRICT GRANT COUNTY DODDRIDGE
SURFACE OWNER BRIAN D. LEMLEY & CHRISTY M. LEMASTER ET AL ACREAGE 59.08 ACRES +/-
OIL & GAS ROYALTY OWNER MARIETTE LEMLEY ET AL; CNX GAS COMPANY, LLC; JOYCE A. BATES; LYDIA MAE ROLLINS; JOYCE A. BATES; KEITH SMITH; SIDNEY THOMPSON; DAVIS & ELKINS COLLEGE; U.G. AMETT ET UX; Z.T. BALL ET UX; DELBERT E. LEATHERMAN; EARL BALIS SR.; GARY G. WILCOX; EMAX GAS CO. ET AL; PERRY TATE; EMAX GAS CO. ET AL; STANLEY E. DAVIS ET UX LEASE ACREAGE 66.87 AC±; 19.56 AC±; 0.5 AC±; 66.5 AC±; 47.88 AC±; 27.8 AC±; 98 AC±; 89 AC±; 28 AC±; 138 AC±; 52 AC±; 52 AC±; 62 AC±; 81 AC±; 70 AC±; 40.75 AC±; 100 AC±
PROPOSED WORK: DRILL CONVERT DRILL DEEPER REDRILL FRACTURE OR STIMULATE
PLUG OFF OLD FORMATION PERFORATE NEW FORMATION OTHER PHYSICAL CHANGE IN WELL
(SPECIFY) AS DRILLED PLUG & ABANDON CLEAN OUT & REPLUG
TARGET FORMATION MARCELLUS ESTIMATED DEPTH 7,146' TVD 22,436' MD
WELL OPERATOR ANTERO RESOURCES CORP. DESIGNATED AGENT KEVIN ELLIS
ADDRESS 1615 WYNKOOP STREET ADDRESS 535 WHITE OAKS BLVD
FORM WW-6 DENVER, CO 80202 ADDRESS BRIDGEPORT, WV 26330

05/09/2024

COUNTY NAME PERMIT