

State of West Virginia  
Department of Environmental Protection - Office of Oil and Gas  
Well Operator's Report of Well Work

API 47-017-06946 County Doddridge District Southwest  
Quad Oxford 7.5' Pad Name Locke Field/Pool Name -----  
Farm name Antero Resources Corporation Well Number Shotter Unit 2H  
Operator (as registered with the OOG) Antero Resources Corporation  
Address 1615 Wynkoop Street City Denver State CO Zip 80202

As Drilled location NAD 83/UTM Attach an as-drilled plat, profile view, and deviation survey  
Top hole Northing 4336498m Easting 514381m  
Landing Point of Curve Northing 4328388m Easting 543120m  
Bottom Hole Northing 4333632m Easting 515320m

Elevation (ft) 1100.5' GL Type of Well  New  Existing Type of Report  Interim  Final  
Permit Type  Deviated  Horizontal  Horizontal 6A  Vertical Depth Type  Deep  Shallow  
Type of Operation  Convert  Deepen  Drill  Plug Back  Redrilling  Rework  Stimulate  
Well Type  Brine Disposal  CBM  Gas  Oil  Secondary Recovery  Solution Mining  Storage  Other \_\_\_\_\_  
Type of Completion  Single  Multiple Fluids Produced  Brine  Gas  NGL  Oil  Other \_\_\_\_\_  
Drilled with  Cable  Rotary

Drilling Media Surface hole  Air  Mud  Fresh Water Intermediate hole  Air  Mud  Fresh Water  Brine  
Production hole  Air  Mud  Fresh Water  Brine  
Mud Type(s) and Additive(s)  
Air - Foam & 4% KCL  
Mud - Polymer

Date permit issued 1/30/2023 Date drilling commenced 3/2/2023 Date drilling ceased 5/4/2023  
Date completion activities began 6/14/2023 Date completion activities ceased 7/31/2023  
Verbal plugging (Y/N) N/A Date permission granted N/A Granted by N/A

Please note: Operator is required to submit a plugging application within 5 days of verbal permission to plug

Freshwater depth(s) ft 775, 781' Open mine(s) (Y/N) depths No  
Salt water depth(s) ft 1733, 1750' Void(s) encountered (Y/N) depths No  
Coal depth(s) ft N/A Cavern(s) encountered (Y/N) depths No  
Is coal being mined in area (Y/N) No

Reviewed by:  
KG-12/0/23  
**12/08/2023**

API 47- 017 - 06946 Farm name Antero Resources Corporation Well number Shotter Unit 2H

CASING STRINGS	Hole Size	Casing Size	Depth	New or Used	Grade wt/ft	Basket Depth(s)	Did cement circulate (Y/N) * Provide details below*
Conductor	28"	20"	130'	New	91.59#, J-55	N/A	Y
Surface	17-1/2"	13-3/8"	444'	New	54.5#, J-55	N/A	Y
Coal							
Intermediate 1	12-1/4"	9-5/8"	2883'	New	36#, J-55	N/A	Y
Intermediate 2							
Intermediate 3							
Production	8-3/4"/8-1/2"	5-1/2"	16978'	New	23#, P-110-ICY	N/A	Y
Tubing		2-3/8"	6658'		4.7#, P-110		
Packer type and depth set		N/A					

Comment Details \_\_\_\_\_

CEMENT DATA	Class/Type of Cement	Number of Sacks	Slurry wt (ppg)	Yield (ft <sup>3</sup> /sks)	Volume (ft <sup>3</sup> )	Cement Top (MD)	WOC (hrs)
Conductor	Class A	204 sx	15.6	1.18	241	0'	8 Hrs.
Surface	Class A	418 sx	15.8	1.17	486	0'	8 Hrs.
Coal							
Intermediate 1	Class A	1095 sx	15.8	1.16	1270	0'	8 Hrs.
Intermediate 2							
Intermediate 3							
Production	Class H	3625 sx (Lead)	13 (Lead), 12 (Tail)	2.17 (Lead), 2.65 (Tail)	9606	-500' into Intermediate Casing	8 Hrs.
Tubing							

Drillers TD (ft) 19300' MD, 7000' TVD (BHL), (Deepest Point Drilled) Loggers TD (ft) 19300' MD  
 Deepest formation penetrated Marcellus Plug back to (ft) N/A  
 Plug back procedure N/A

RECEIVED  
Office of Oil and Gas

OCT 27 2023

Kick off depth (ft) 5757'

WV Department of Environmental Protection

Check all wireline logs run  caliper  density  deviated/directional  induction  
 neutron  resistivity  gamma ray  temperature  sonic

Well cored  Yes  No Conventional  Sidewall Were cuttings collected  Yes  No

DESCRIBE THE CENTRALIZER PLACEMENT USED FOR EACH CASING STRING \_\_\_\_\_

Conductor - 0  
 Surface - 1 above guide shoe, 1 above insert float, 1 every 4th joint to surface  
 Intermediate - 1 above float joint, 1 above float collar, 1 every 4th joint to surface  
 Production - 1 above float joint, 1 below float collar, 1 every 3rd joint to top of cement

WAS WELL COMPLETED AS SHOT HOLE  Yes  No DETAILS \_\_\_\_\_

WAS WELL COMPLETED OPEN HOLE?  Yes  No DETAILS \_\_\_\_\_

WERE TRACERS USED  Yes  No TYPE OF TRACER(S) USED N/A

12/08/2023

API 47-017 - 06946 Farm name Antero Resources Corporation Well number Shotter Unit 2H

PERFORATION RECORD

Stage No.	Perforation date	Perforated from MD ft.	Perforated to MD ft.	Number of Perforations	Formation(s)
<b>*PLEASE SEE ATTACHED EXHIBIT 1</b>					

Please insert additional pages as applicable.

STIMULATION INFORMATION PER STAGE

Complete a separate record for each stimulation stage.

Stage No.	Stimulations Date	Ave Pump Rate (BPM)	Ave Treatment Pressure (PSI)	Max Breakdown Pressure (PSI)	ISIP (PSI)	Amount of Proppant (lbs)	Amount of Water (bbls)	Amount of Nitrogen/other (units)
<b>*PLEASE SEE ATTACHED EXHIBIT 2</b>								

RECEIVED  
Office of Oil and Gas  
OCT 27 2023  
WV Department of Environmental Protection

Please insert additional pages as applicable.

API 47- 017 - 06946 Farm name Antero Resources Corporation Well number Shotter Unit 2H

<u>PRODUCING FORMATION(S)</u>	<u>DEPTHS</u>		
<u>Marcellus</u>	<u>6876' (TOP)</u>	<u>TVD</u>	<u>6489' (TOP)</u> <u>MD</u>
_____	_____	_____	_____
_____	_____	_____	_____
_____	_____	_____	_____

Please insert additional pages as applicable.

GAS TEST  Build up  Drawdown  Open Flow OIL TEST  Flow  Pump

SHUT-IN PRESSURE Surface 1979 psi Bottom Hole --- psi DURATION OF TEST --- hrs

OPEN FLOW Gas 10426 mcfpd Oil 115 bpd NGL --- bpd Water 913 bpd GAS MEASURED BY  Estimated  Orifice  Pilot

<u>LITHOLOGY/ FORMATION</u>	<u>TOP</u>		<u>BOTTOM</u>		<u>DESCRIBE ROCK TYPE AND RECORD QUANTITY AND TYPE OF FLUID (FRESHWATER, BRINE, OIL, GAS, H<sub>2</sub>S, ETC)</u>
	<u>DEPTH IN FT NAME TVD</u>	<u>DEPTH IN FT TVD</u>	<u>DEPTH IN FT MD</u>	<u>DEPTH IN FT MD</u>	

**\*PLEASE SEE ATTACHED EXHIBIT 3**

					RECEIVED
					Office of Oil and Gas
					OCT 27 2023
					WV Department of
					Environmental Protection

Please insert additional pages as applicable.

Drilling Contractor H & P Drilling  
Address 912 N Eagle Valley Rd City Howard State PA Zip 16841

Logging Company GR Energy Services  
Address 2315 PA-66 City Delmont State PA Zip 15626

Cementing Company Halliburton Energy Services  
Address 3000 W. Sam Houston Pkwy City Houston State TX Zip 76114

Stimulating Company Halliburton  
Address 3000 W. Sam Houston Pkwy City Houston State TX Zip 76114

Please insert additional pages as applicable.

Completed by Carly Marvel Telephone 303-357-7373  
Signature Carly Marvel Title Permitting Agent Date 10/11/2023

API 47-017-06946 Farm Name Antero Resources Corporation Well Number Shotter Unit 2H

**Exhibit 1**

Stage No.	Perforation Date	Perforated from MD ft.	Perforated to MD ft.	Number of Perforations	Formations
1	6/14/2023	16842.5	16799.5	60	Marcellus
2	6/14/2023	16761.93027	16596.0816	60	Marcellus
3	6/15/2023	16560.5119	16394.6633	60	Marcellus
4	6/15/2023	16359.09354	16193.2449	60	Marcellus
5	6/15/2023	16157.67517	15991.8265	60	Marcellus
6	6/16/2023	15956.2568	15790.4082	60	Marcellus
7	6/17/2023	15754.83844	15588.9898	60	Marcellus
8	6/17/2023	15553.42007	15387.5714	60	Marcellus
9	6/17/2023	15352.0017	15186.1531	60	Marcellus
10	6/18/2023	15150.58333	14984.7347	60	Marcellus
11	6/18/2023	14949.16497	14783.3163	60	Marcellus
12	6/19/2023	14747.7466	14581.898	60	Marcellus
13	6/19/2023	14546.32823	14380.4796	60	Marcellus
14	6/20/2023	14344.90986	14179.0612	60	Marcellus
15	6/20/2023	14143.4915	13977.6429	60	Marcellus
16	6/21/2023	13942.07313	13776.2245	60	Marcellus
17	6/21/2023	13740.65476	13574.8061	60	Marcellus
18	6/22/2023	13539.23639	13373.3878	60	Marcellus
19	6/22/2023	13337.81803	13171.9694	60	Marcellus
20	6/23/2023	13136.39966	12970.551	60	Marcellus
21	6/23/2023	12934.98129	12769.1327	60	Marcellus
22	6/23/2023	12733.56293	12567.7143	60	Marcellus
23	6/23/2023	12532.14456	12366.2959	60	Marcellus
24	6/23/2023	12330.72619	12164.8776	60	Marcellus
25	6/24/2023	12129.30782	11963.4592	60	Marcellus
26	6/24/2023	11927.88946	11762.0408	60	Marcellus
27	6/24/2023	11726.47109	11560.6224	60	Marcellus
28	6/24/2023	11525.05272	11359.2041	60	Marcellus
29	6/25/2023	11323.63435	11157.7857	60	Marcellus
30	6/25/2023	11122.21599	10956.3673	60	Marcellus
31	6/25/2023	10920.79762	10754.949	60	Marcellus
32	6/25/2023	10719.37925	10553.5306	60	Marcellus
33	6/25/2023	10517.96088	10352.1122	60	Marcellus
34	6/26/2023	10316.54252	10150.6939	60	Marcellus
35	6/26/2023	10115.12415	9949.27551	60	Marcellus
36	6/26/2023	9913.705782	9747.85714	60	Marcellus
37	6/26/2023	9712.287415	9546.43878	60	Marcellus
38	6/27/2023	9510.869048	9345.02041	60	Marcellus
39	6/27/2023	9309.45068	9143.60204	60	Marcellus
40	6/27/2023	9108.032313	8942.18367	60	Marcellus
41	6/27/2023	8906.613946	8740.76531	60	Marcellus
42	6/27/2023	8705.195578	8539.34694	60	Marcellus
43	6/28/2023	8503.777211	8337.92857	60	Marcellus
44	6/28/2023	8302.358844	8136.5102	60	Marcellus
45	6/28/2023	8100.940476	7935.09184	60	Marcellus
46	6/28/2023	7899.522109	7733.67347	60	Marcellus
47	6/28/2023	7698.103741	7532.2551	60	Marcellus
48	6/29/2023	7496.685374	7330.83673	60	Marcellus
49	6/29/2023	7295.267007	7129.41837	60	Marcellus
50	6/29/2023	7093.848639	6928	60	Marcellus

RECEIVED  
Office of Oil and Gas

OCT 27 2023

WV Department of  
Environmental Protection

12/08/2023

API 47-017-06946 Farm Name Antero Resources Corporation Well Number Shotter Unit 2H

EXHIBIT 2

Stage No.	Stimulations Date	Avg Pump Rate	Avg Treatment Pressure (PSI)	Max Breakdown Pressure (PSI)	ISIP (PSI)	Amount of Proppant (lbs)	Amount of Water (bbls)	Amount of Nitrogen/ other (units)
1	6/14/2023	82.3	8481.0	6519.0	4072.7	172400	4627.0	N/A
2	6/14/2023	88.4	8495.3	4240.0	3949.0	408420	7183.2	N/A
3	6/15/2023	90.1	8425.5	5778.1	3304.2	408850	7148.9	N/A
4	6/15/2023	96.0	8481.5	5420.8	3811.0	408790	7090.9	N/A
5	6/15/2023	93.9	8475.3	5227.7	3703.0	412340	7190.0	N/A
6	6/16/2023	96.1	8457.2	5553.6	3584.0	416360	7265.0	N/A
7	6/17/2023	97.0	8507.4	5751.7	3920.0	398430	7031.7	N/A
8	6/17/2023	95.8	8602.4	6026.6	3404.0	411640	7042.3	N/A
9	6/17/2023	96.2	8211.0	3561.8	3781.0	411210	7113.3	N/A
10	6/18/2023	96.9	8297.2	4769.9	3486.0	400270	6834.3	N/A
11	6/18/2023	96.1	8435.7	5081.4	3238.0	400570	7035.4	N/A
12	6/19/2023	97.2	8449.8	5418.4	3319.0	414560	7050.7	N/A
13	6/19/2023	97.6	8472.0	3434.9	3898.0	415930	7471.1	N/A
14	6/20/2023	95.5	8342.0	6016.9	3014.0	410070	7071.4	N/A
15	6/20/2023	86.1	8091.7	5789.5	3050.8	396820	8475.1	N/A
16	6/21/2023	90.3	8464.0	5297.6	3024.0	396550	6798.4	N/A
17	6/21/2023	95.0	8622.0	6161.7	2935.9	417900	7356.2	N/A
18	6/22/2023	93.9	8669.6	6273.6	3024.0	408910	6942.7	N/A
19	6/22/2023	97.5	8619.8	6262.8	3007.0	414530	7075.0	N/A
20	6/23/2023	96.8	8341.0	3599.3	3070.0	416640	7028.0	N/A
21	6/23/2023	97.7	8417.1	5758.1	3123.0	399570	6819.0	N/A
22	6/23/2023	95.5	8300.8	5727.3	3040.0	417150	7186.5	N/A
23	6/23/2023	96.6	8424.1	5256.5	2637.0	397940	6854.5	N/A
24	6/23/2023	97.5	8277.1	5444.4	2935.0	406330	6888.4	N/A
25	6/24/2023	98.3	8237.0	4954.8	2986.0	418030	7192.0	N/A
26	6/24/2023	93.8	7616.5	4007.3	3075.0	412990	6952.3	N/A
27	6/24/2023	95.9	8201.4	6020.0	2996.0	403510	6918.0	N/A
28	6/24/2023	96.7	8240.0	5669.5	2964.0	410620	6816.9	N/A
29	6/25/2023	98.1	7771.3	3369.8	3061.0	413060	6971.7	N/A
30	6/25/2023	97.4	8220.7	5153.6	2702.0	397270	6866.0	N/A
31	6/25/2023	97.6	8056.7	6054.9	2871.0	401870	6870.1	N/A
32	6/25/2023	93.4	8106.4	5960.1	3211.0	400980	8622.1	N/A
33	6/25/2023	91.8	8026.5	5247.7	2820.9	400910	6633.5	N/A
34	6/26/2023	99.0	7859.3	4865.6	2989.0	418690	6982.1	N/A
35	6/26/2023	97.7	7763.9	5723.4	2823.0	401540	6822.8	N/A
36	6/26/2023	96.1	7556.6	5514.4	3000.0	409130	7063.6	N/A
37	6/26/2023	99.1	7838.0	5211.0	2903.0	398360	6804.3	N/A
38	6/27/2023	97.8	7568.8	5262.5	3013.0	403220	6734.2	N/A
39	6/27/2023	97.4	7643.8	6000.2	2955.0	401710	6809.9	N/A
40	6/27/2023	96.7	7566.1	5210.4	2836.0	399400	6758.7	N/A
41	6/27/2023	96.3	7717.1	5487.0	2706.0	399810	6641.7	N/A
42	6/27/2023	96.7	7472.9	6058.9	2834.0	410040	6924.0	N/A
43	6/28/2023	97.4	7490.6	5688.4	2681.0	416550	6967.3	N/A
44	6/28/2023	97.7	7380.3	5097.0	2842.0	418930	6987.2	N/A
45	6/28/2023	97.6	7325.7	4951.0	3111.0	397040	6712.5	N/A
46	6/28/2023	98.4	7255.3	5489.7	2885.0	414540	6805.9	N/A
47	6/28/2023	98.2	6769.7	4334.2	3116.0	397820	6554.8	N/A
48	6/29/2023	98.2	7134.9	5028.4	3005.0	404240	6738.2	N/A
49	6/29/2023	97.3	7120.5	6023.0	2715.0	396840	6726.5	N/A
50	6/29/2023	98.1	6617.1	4738.0	2912.0	414900	7066.9	N/A
	AVERAGE	96	8,018	5,310	3,127	20,124,180	348,522	TOTAL

RECEIVED  
Office of Oil and Gas  
OCT 27 2023  
WV Department of  
Environmental Protection

12/08/2023

## EXHIBIT 3

LITHOLOGY/ FORMATION	TOP DEPTH (TVD)	BOTTOM DEPTH (TVD)	TOP DEPTH (MD)	BOTTOM DEPTH (MD)
	From Surface	From Surface	From Surface	From Surface
Sandstone	120	470	120	470
Sandy Siltstone	470	620	470	620
Siltstone, occ SS	620	770	620	770
Sandy Siltstone, occ LS	770	870	770	870
Siltstone, occ SS, tr LS	870	970	870	970
Silty Sandstone, tr shale	970	1,070	970	1,070
Sandstone	1,070	1,170	1,070	1,170
Silty Sandstone	1,170	1,270	1,170	1,270
Shaly Siltstone, tr coal	1,270	1,370	1,270	1,370
Sandy Siltstone, occ shale	1,370	1,620	1,370	1,620
Silty Sandstone, tr coal	1,620	1,870	1,620	1,870
Siltstone, occ LS	1,870	1,844	1,870	1,851
Big Lime	1,874	2,400	1,851	2,418
Fifty Foot Sandstone	2,400	2,525	2,388	2,545
Gordon	2,525	2,830	2,515	2,857
Fifth Sandstone	2,830	2,960	2,827	2,989
Bayard	2,960	3,644	2,959	3,689
Speechley	3,644	3,809	3,659	3,858
Balltown	3,809	4,425	3,828	4,479
Bradford	4,425	4,834	4,449	4,894
Benson	4,834	5,075	4,864	5,138
Alexander	5,075	6,326	5,108	6,454
Sycamore	6,109	6,296	6,196	6,424
Middlesex	6,296	6,410	6,424	6,615
Burkett	6,410	6,463	6,615	6,768
Tully	6,463	6,489	6,768	6,876
Marcellus	6,489	NA	6,876	NA

\*Please note Antero determines formation tops based on mud logs that are only run on one well on a multi-well pad. The measured depth (MD) data on subsequent wells may be slightly different due to the well's unique departure.

RECEIVED  
Office of Oil and Gas

OCT 27 2023

WV Department of  
Environmental Protection

12/08/2023

## Hydraulic Fracturing Fluid Product Component Information Disclosure

Job Start Date:	6/13/2023
Job End Date:	6/29/2023
State:	West Virginia
County:	Doddridge
API Number:	47-017-06946-00-00
Operator Name:	Antero Resources Corporation
Well Name and Number:	Shotter 2H
Latitude:	39.17759500
Longitude:	-80.83350500
Datum:	WGS84
Federal Well:	NO
Indian Well:	NO
True Vertical Depth:	6,554
Total Base Water Volume (gal):	15,095,818
Total Base Non Water Volume:	0



### Hydraulic Fracturing Fluid Composition:

Trade Name	Supplier	Purpose	Ingredients	Chemical Abstract Service Number (CAS #)	Maximum Ingredient Concentration in Additive (% by mass)**	Maximum Ingredient Concentration in HF Fluid (% by mass)**	Comments
Produced Water	Halliburton	Base Fluid	Water	7732-18-5	100.00000	86.26412	Density = 8.50
Ingredients	Listed Above	Listed Above	Water	7732-18-5	100.00000	0.17495	



MC B-8614A	MultiChem	Biocide					
				Listed Below			
HYDROCHLORIC ACID, 22 BAUME	Halliburton	Solvent					
				Listed Below			
Sand-Common White-100 Mesh, SSA-2	Halliburton	Proppant					
				Listed Below			
FDP-S1464-22	Halliburton	Friction Reducer					
				Listed Below			
WG-36 GELLING AGENT	Halliburton	Gelling Agent					
				Listed Below			
HAI-501	Halliburton	Acid Corrosion Inhibitor					
				Listed Below			
OPTIFLO-II DELAYED RELEASE BREAKER	Halliburton	Breaker					
				Listed Below			
Items above are Trade Names with the exception of Base Water . Items below are the individual ingredients.							
			Crystalline silica, quartz	14808-60-7	100.00000	13.53363	
			Hydrochloric acid	7647-01-0	30.00000	0.04010	
			Complex amine compound	Proprietary	60.00000	0.03292	

RECEIVED  
 Office of Oil and Gas  
 OCT 27 2023  
 WV Department of Environmental Protection

			Hydrotreated distillate	Proprietary	30.00000	0.01646	
			Guar gum	9000-30-0	100.00000	0.00502	
			Ammonium chloride	12125-02-9	5.00000	0.00274	
			Fatty nitrogen derived amides	Proprietary	5.00000	0.00274	
			Ethoxylated alcohol	Proprietary	5.00000	0.00274	
			Glutaraldehyde	111-30-8	30.00000	0.00251	
			Sobitan, mono-9-octadecenoate, (Z)	1338-43-8	1.00000	0.00055	
			Sorbitan monooleate polyoxyethylene derivative	9005-65-6	1.00000	0.00055	
			Alkyl (C12-16) dimethylbenzyl ammonium chloride	68424-85-1	5.00000	0.00042	
			Methanol	67-56-1	100.00000	0.00025	
			Ammonium persulfate	7727-54-0	100.00000	0.00010	
			Ethanol	64-17-5	1.00000	0.00008	
			Modified thiourea polymer	Proprietary	30.00000	0.00008	
			Mixture of dimer and trimer fatty acids of indefinite composition derived from tall oil	61790-12-3	30.00000	0.00008	
			Oxylated phenolic resin	Proprietary	30.00000	0.00003	
			Hexadecene	629-73-2	5.00000	0.00001	
			Ethoxylated alcohols	Proprietary	5.00000	0.00001	
			Propargyl alcohol	107-19-7	5.00000	0.00001	
			C.I. pigment Orange 5	3468-63-1	1.00000	0.00000	

\* Total Water Volume sources may include various types of water including fresh water, produced water, and recycled water

\*\* Information is based on the maximum potential for concentration and thus the total may be over 100%

\*\*\* If you are calculating a percentage of total ingredients do not add the water volume below the green line to the water volume above the green line

Note: For Field Development Products (products that begin with FDP), MSDS level only information has been provided.

Ingredient information for chemicals subject to 29 CFR 1910.1200(i) and Appendix D are obtained from suppliers Material Safety Data Sheets (MSDS)

WV Department of  
Environmental Protection

OCT 27 2023

RECEIVED  
Office of Oil and Gas

LATITUDE 39°12'30" 98'

LATITUDE 39°10'00" 8,850' TO BOTTOM HOLE

5,464' TO BOTTOM HOLE

11,226'

LONGITUDE 80°47'30"

LONGITUDE 80°50'00"

Antero Resources Corporation Well No. Shoter #2H

AS DRILLED DATA: WELL 2H TOP HOLE INFORMATION: N: 249,569ft E: 1,621,923ft LAT: 39°10'39.04" LON: 80°50'01.25" BOTTOM HOLE INFORMATION: N: 240,112ft E: 1,624,848ft LAT: 39°09'06.00" LON: 80°49'22.34" WEST VIRGINIA COORDINATE SYSTEM OF 1927 NORTH ZONE. ZONE WAS DERIVED FROM MEASUREMENTS TAKEN WITH TRIMBLE GEOXT SUBMETER MAPPING GRADE GPS UNIT. PLAT ORIENTATION, CORNER, AND WELL REFERENCE TIE LINES ARE BASED ON GRID NORTH.

(NAD) 83 (UTM) ZONE 17 COORDS: WELL 2H TOP HOLE INFORMATION: N: 4,336,498m E: 514,381m BOTTOM HOLE INFORMATION: N: 4,333,632m E: 515,320m

(NAD) 27 (UTM) ZONE 17 COORDS: WELL 2H TOP HOLE INFORMATION: N: 14,226,613ft E: 1,687,550ft POINT OF ENTRY INFORMATION: N: 14,226,730ft E: 1,687,371ft BOTTOM HOLE INFORMATION: N: 14,217,209ft E: 1,690,631ft

WV NORTH ZONE GRID NORTH

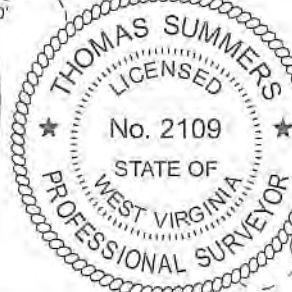
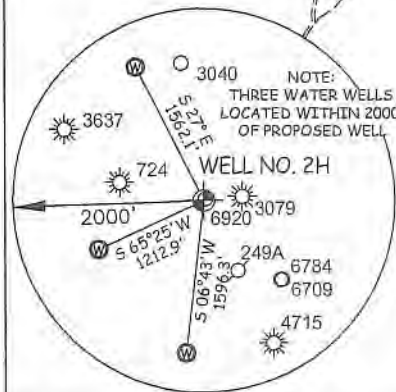

I THE UNDERSIGNED, HEREBY CERTIFY THAT THIS PLAT IS CORRECT TO THE BEST OF MY KNOWLEDGE AND BELIEF AND SHOWS ALL THE INFORMATION REQUIRED BY LAW AND THE RULES ISSUED AND PERSCRIBED BY THE DEPARTMENT OF ENVIRONMENTAL PROTECTION.



STATE OF WEST VIRGINIA, DIVISION OF ENVIRONMENTAL PROTECTION, OFFICE OF OIL AND GAS

WILLOW LAND SURVEYING PLLC 220 MASONIC AVE. PENNSBORO WEST VIRGINIA 26415

Table listing landowners and leaseholders in the southwest district of Doddridge County, West Virginia, including names like Mansfield Leeson, Larry Gander, and Robert Lee Brownfield Jr.

JOB # 21-005WA DRAWING # SHOTTER2HAD SCALE 1" = 2000' MINIMUM DEGREE OF ACCURACY SUBMETER PROVEN SOURCE OF ELEV. SUBMETER MAPPING GRADE GPS STATE OF WEST VIRGINIA DEPARTMENT OF ENERGY DIVISION OF OIL AND GAS

LEGEND: Surface Owner Boundary Lines +/-, Interior Surface Tracts +/-, Proposed Well Path, As Drilled Well Path. Includes signature of Thomas Summers and date 10/24/23.

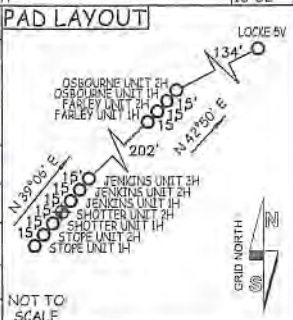

NOTE: 1. NO OCCUPIED DWELLINGS OR BUILDINGS TWO THOUSAND FIVE HUNDRED (2,500) SQUARE FEET OR LARGER USED TO HOUSE OR SHELTER DAIRY CATTLE OR POULTRY... 2. TOP HOLE DATA SHOWS HEREIN WAS PROVIDED BY ANTERO RESOURCES CORPORATION.

WELL TYPE: OIL \_\_\_ GAS X LIQUID INJECTION \_\_\_ WASTE DISPOSAL \_\_\_ (IF "GAS") PRODUCTION X STORAGE \_\_\_ DEEP \_\_\_ SHALLOW X STATE COUNTY PERMIT LOCATION: ELEVATION 1,100.5' - AS BUILT WATERSHED SOUTH FORK HUGHES RIVER QUADRANGLE OXFORD 7.5' DISTRICT SOUTHWEST COUNTY DODDRIDGE SURFACE OWNER ANTERO RESOURCES CORPORATION ACREAGE 59.74 ACRES +/- LEASE ACREAGE 180 ACRES +/-

PROPOSED WORK: DRILL \_\_\_ CONVERT \_\_\_ DRILL DEEPER \_\_\_ REDRILL \_\_\_ FRACTURE OR STIMULATE \_\_\_ PLUG OFF OLD FORMATION \_\_\_ PERFORATE NEW FORMATION \_\_\_ OTHER PHYSICAL CHANGE IN WELL (SPECIFY) AS DRILLED PLUG & ABANDON CLEAN OUT & REPLUG TARGET FORMATION MARCELLUS ESTIMATED DEPTH 6,504' TVD 16,978' MD WELL OPERATOR ANTERO RESOURCES CORP. DESIGNATED AGENT KEVIN ELLIS ADDRESS 1615 WYNKOOP ST. ADDRESS 535 WHITE OAKS BLVD

Antero Resources Corporation Well No. Shotter #2H

AS DRILLED DATA: WELL 2H TOP HOLE INFORMATION: N: 249,569ft E: 1,621,923ft LAT: 39°10'39.04" LON: 80°50'01.25" BOTTOM HOLE INFORMATION: N: 240,112ft E: 1,624,848ft LAT: 39°09'06.00" LON: 80°49'22.34" WEST VIRGINIA COORDINATE SYSTEM OF 1927 NORTH ZONE. ZONE WAS DERIVED FROM MEASUREMENTS TAKEN WITH TRIMBLE GEOXT SUBMETER MAPPING GRADE GPS UNIT. PLAT ORIENTATION, CORNER, AND WELL REFERENCE TIE LINES ARE BASED ON GRID NORTH.

(NAD) 83 (UTM) ZONE 17 COORDS: WELL 2H TOP HOLE INFORMATION: N: 4,336,498m E: 514,381m BOTTOM HOLE INFORMATION: N: 4,333,632m E: 515,320m

(NAD) 27 (UTM) ZONE 17 COORDS: WELL 2H TOP HOLE INFORMATION: N: 14,226,613ft E: 1,687,550ft POINT OF ENTRY INFORMATION: N: 14,226,730ft E: 1,687,371ft BOTTOM HOLE INFORMATION: N: 14,217,209ft E: 1,690,631ft

GRID NORTH

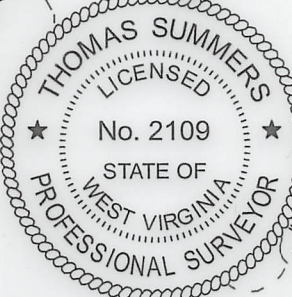
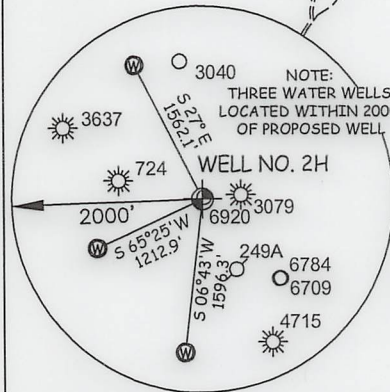

I THE UNDERSIGNED, HEREBY CERTIFY THAT THIS PLAT IS CORRECT TO THE BEST OF MY KNOWLEDGE AND BELIEF AND SHOWS ALL THE INFORMATION REQUIRED BY LAW AND THE RULES ISSUED AND PERSCRIBED BY THE DEPARTMENT OF ENVIRONMENTAL PROTECTION.

Table with columns for Lease Number, Leaseholder Name, and Leaseholder Address. Includes leases for Larry Gander, John Waitkus, Brian Prim, Robert Lee Brownfield Jr., Antero Resources Corporation, Delbert Osborne, Stephen Harris, Delbert Osborne, Anthony Ramey, Gary Sanchez, Kerry Junkins, Robert Lee Brownfield Jr., Hunter Jenkins, David Ball Jr., James Haught, Mansfield Leeson, Hunter Jenkins, Jacqueline Payne, Harold Hinzman, Ernest Seeds, Michael McCloy, Dana Long, Dana Long, James Haught, James Haught, Floyd Stout Jr., Judith Moran, Steven Adams, Dana Long, Robert Lee Brownfield Jr., Coy Adams, and Utahona Williams.



STATE OF WEST VIRGINIA, DIVISION OF ENVIRONMENTAL PROTECTION, OFFICE OF OIL AND GAS

WILLOW LAND SURVEYING PLLC 220 MASONIC AVE. PENNSBORO WEST VIRGINIA 26415

JOB # 21-005WA DRAWING # SHOTTER2HAD SCALE 1" = 2000' MINIMUM DEGREE OF ACCURACY SUBMETER PROVEN SOURCE OF ELEV. SUBMETER MAPPING GRADE GPS STATE OF WEST VIRGINIA DEPARTMENT OF ENERGY DIVISION OF OIL AND GAS

LEGEND: Surface Owner Boundary Lines +/- Interior Surface Tracts +/- Proposed Well Path As Drilled Well Path THOMAS SUMMERS P.S. 2109 DATE 10/24/23 OPERATOR'S WELL# SHOTTER #2H

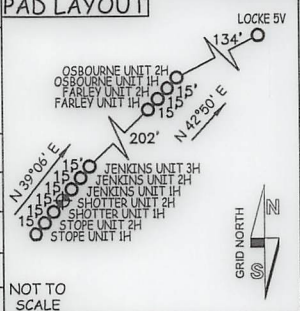

NOTE: 1. NO OCCUPIED DWELLINGS OR BUILDINGS TWO THOUSAND FIVE HUNDRED (2,500) SQUARE FEET OR LARGER USED TO HOUSE OR SHELTER DAIRY CATTLE OR POULTRY HUSBANDRY ARE LOCATED WITHIN SIX HUNDRED TWENTY-FIVE (625) FEET OF THE CENTER OF THE WELL PAD. 2. TOP HOLE DATA SHOWN HEREON WAS PROVIDED BY ANTERO RESOURCES CORPORATION. 3. AS DRILLED DATA WAS PROVIDED BY ANTERO RESOURCES CORPORATION. 4. WLS IS NOT CERTIFYING THE DATA AND INFORMATION PROVIDED LISTED IN NOTES 2 AND 3, ONLY THE RELATIONSHIP TO THE DATA AND INFORMATION PROVIDED TO THE LEASE BOUNDARIES. 5. WLS IS BY NO MEANS RESPONSIBLE FOR ANY ERRORS OR INACCURACIES WITH THE DATA AND INFORMATION THAT HAS BEEN PROVIDED.

WELL TYPE: OIL GAS X LIQUID INJECTION WASTE DISPOSAL 47 - 017 - 06946 (IF "GAS") PRODUCTION X STORAGE DEEP SHALLOW X STATE COUNTY PERMIT LOCATION: ELEVATION 1,100.5' - AS BUILT WATERSHED SOUTH FORK HUGHES RIVER QUADRANGLE OXFORD 7.5' DISTRICT SOUTHWEST COUNTY DODDRIDGE SURFACE OWNER ANTERO RESOURCES CORPORATION ACREAGE 59.74 ACRES +/- LEASE ACREAGE 180 ACRES±

PROPOSED WORK: DRILL CONVERT DRILL DEEPER REDRILL FRACTURE OR STIMULATE PLUG OFF OLD FORMATION PERFORATE NEW FORMATION OTHER PHYSICAL CHANGE IN WELL (SPECIFY) AS DRILLED PLUG & ABANDON CLEAN OUT & REPLUG TARGET FORMATION MARCELLUS ESTIMATED DEPTH 6,504' TVD 16,978' MD WELL OPERATOR ANTERO RESOURCES CORP. DESIGNATED AGENT KEVIN ELLIS ADDRESS 1615 WYNKOOP ST. ADDRESS 535 WHITE OAKS BLVD