

Antero Resources
Well No. Coldwater 1H
BHL MOD
Antero Resources Corporation

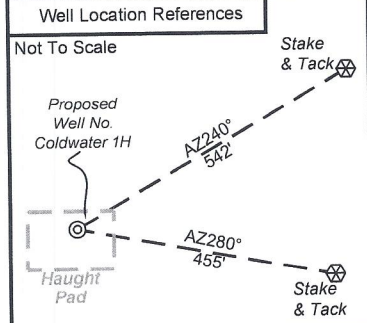
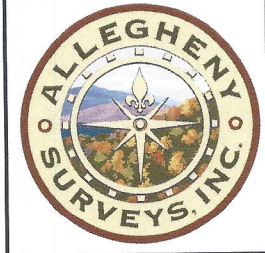

I, the undersigned, hereby certify that this plat is correct to the best of my knowledge and belief and shows all the information required by law and the rules issued and prescribed by the Department of Environmental Protection.

Bradley D. Miller

Bradley D. Miller, P.S. 2167

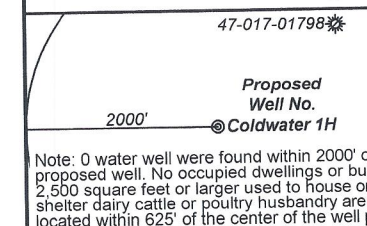
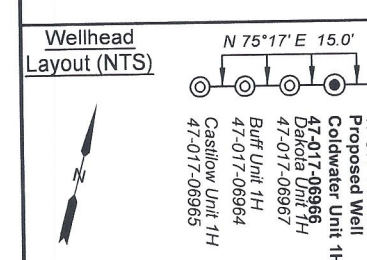
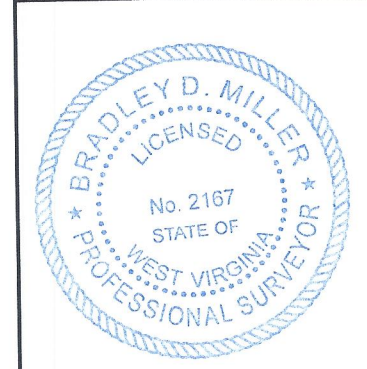

- Legend**
- Proposed gas well
 - ⊗ Monument, as noted
 - ☀ Existing Well, as noted
 - ☀ Digitized Well, as noted
 - Creek or Drain
 - Road
 - Surface boundary (approx.)
 - Interior surface tracts (approx.)
 - District Line

Notes

West Virginia Coordinate System of 1927, North Zone based upon Differential GPS Measurements.

Well No. Coldwater Unit 1H Top Hole coordinates are
 N: 252,603.97' Latitude: 39°11'15.00"
 E: 1,665,129.01' Longitude: 80°40'53.14"
 Bottom Hole coordinates are
 N: 238,201.60' Latitude: 39°08'53.37"
 E: 1,670,663.56' Longitude: 80°39'40.49"
 UTM Zone 17, NAD 1983

Top Hole Coordinates Bottom Hole Coordinates
 N: 4,337,642.205m N: 4,333,282.707m
 E: 527,527.966m E: 529,287.243m

Plat orientation and corner and well references are based upon the grid north meridian. Well location references are based upon the magnetic meridian.

Notes:

Well No. Coldwater Unit 1H UTM Zone 17, NAD 1927

Top Hole Coordinates
 N: 14,230,365.54'
 E: 1,730,683.59'

Point of Entry Coordinates
 N: 14,230,173.79'
 E: 1,732,053.64'

Bottom Hole Coordinates
 N: 14,216,062.57'
 E: 1,736,455.23'

	Bearing	Dist.
L1	S 31°20' E	1,865.2'
L2	S 10°12' E	1,693.8'
L3	S 63°53' W	3,227.0'
L4	N 79°30' W	2,494.6'
L5	S 81°05' E	1,383.9'

FILE NO: 264-30-N-22
 DRAWING NO: Coldwater 1H Well Plat
 SCALE: 1" = 2000'
 MINIMUM DEGREE OF ACCURACY: Submeter
 PROVEN SOURCE OF ELEVATION: WVDOT, Harrisville, WV

STATE OF WEST VIRGINIA
 DEPARTMENT OF ENVIRONMENTAL PROTECTION
OIL AND GAS DIVISION

DATE: November 16 2023
 OPERATOR'S WELL NO. Coldwater 1H
 API WELL NO
 47 - 017 - 06966
 STATE COUNTY PERMIT

WELL TYPE: OIL GAS LIQUID INJECTION WASTE DISPOSAL
 (IF GAS) PRODUCTION: STORAGE DEEP SHALLOW

LOCATION: ELEVATION: Proposed 1,194' WATERSHED: Headwaters Middle Island Creek QUADRANGLE: New Milton
 DISTRICT: New Milton Susan Haught COUNTY: Doddridge
 SURFACE OWNER: Gido, et al ACREAGE: 264
 ROYALTY OWNER: O.C. Haught, et ux LEASE NO: ACREAGE: 264

PROPOSED WORK: DRILL CONVERT DRILL DEEPER FRACTURE OR STIMULATE PLUG OFF OLD FORMATION
 PERFORATE NEW FORMATION OTHER PHYSICAL CHANGE IN WELL (SPECIFY) BHL MOD
 PLUG AND ABANDON CLEAN OUT AND REPLUG TARGET FORMATION: Marcellus Shale ESTIMATED DEPTH: 24,700' MD 7,700' TVD

WELL OPERATOR: Antero Resources Corporation DESIGNATED AGENT: Kevin Ellis
 ADDRESS: 1615 Wynkoop Street ADDRESS: 535 White Oaks Blvd.
 Denver, CO 80202 Bridgeport, WV 26330

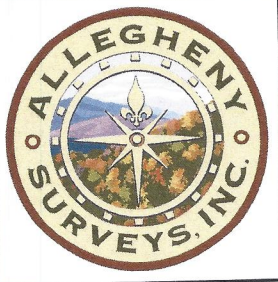

Leases	
A	O.C.Haught, et ux
B	Haught Family Trust, et al
C	Susan B. Gum
D	Michael B. Duffelmeyer
E	Mary K. Post Revocable Trust - 2017, et al
F	Michael Brent Duffelmeyer
G	Mary K. Post Revocable Trust - 2017, et al
H	O.C.Haught, et al
I	Warren Bee, et ux
J	HG Energy II Appalachia, LLC
K	HG Energy II Appalachia, LLC
L	Trever S. Gum
M	Michael Dale & Janet L. Nicholson
N	Haught Family Trust

ID	TM-Par	Owner	Bk/Pg	Acres
1	15-15	Susan Haught Gido, et al	WB62/407	264.00
2	15-6	Susan Haught Gido, et al	WB62/407	119.23
3	16-14	Melvin L. & Misty D. Davis	445/159	104.13
4	19-6	Garry R. Norton	176/265	68.49
5	16-15	Garry R. Norton	176/265	104.40
6	20-1	Leonard Gandy	193/66	21.25
7	20-2	BOE	15/216	0.38
8	19-5	Susan Haught Gido, et al	WB62/407	86.26
9	19-7	Susan Haught Gido, et al	WB62/407	269.50
10	20-3	Warren & Judy Bee	218/585	56.00
11	20-20.1	Harvey C. Woodruff, III	252/715	92.69
12	20-20.2	Harvey C. Woodruff, III	257/292	33.73
13	20-21	Trever S. Gum	364/471	100.28
14	24-1	Michael & Janet Nicholson	472/87	83.74

RECEIVED
Office of Oil and Gas
DEC 21 2023
WV Department of
Environmental Protection

FILE NO: 264-30-N-22
DRAWING NO: Coldwater 1H Well Plat
SCALE: 1" = 2000'
MINIMUM DEGREE OF ACCURACY:
Submeter
PROVEN SOURCE OF ELEVATION:
WVDOT, Harrisville, WV

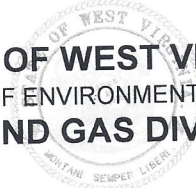
STATE OF WEST VIRGINIA
DEPARTMENT OF ENVIRONMENTAL PROTECTION
OIL AND GAS DIVISION

DATE: November 16 2023
OPERATOR'S WELL NO. Coldwater 1H
API WELL NO
47 - 017 - 06966
STATE COUNTY PERMIT

WELL TYPE: OIL GAS LIQUID INJECTION WASTE DISPOSAL
(IF GAS) PRODUCTION: STORAGE DEEP SHALLOW

LOCATION: ELEVATION: Proposed 1,194' WATERSHED: Headwaters Middle Island Creek QUADRANGLE: New Milton
DISTRICT: New Milton SURFACE OWNER: Susan Haught Gido, et al COUNTY: Dodridge
ROYALTY OWNER: O.C. Haught, et ux LEASE NO: _____ ACREAGE: 264
PROPOSED WORK: DRILL CONVERT DRILL DEEPER FRACTURE OR STIMULATE PLUG OFF OLD FORMATION
 PERFORATE NEW FORMATION OTHER PHYSICAL CHANGE IN WELL (SPECIFY) BHL MOD
 PLUG AND ABANDON CLEAN OUT AND REPLUG TARGET FORMATION: Marcellus Shale ESTIMATED DEPTH: 24,700' TD

WELL OPERATOR: Antero Resources Corporation DESIGNATED AGENT: Kevin Ellis
ADDRESS: 1615 Wynkoop Street ADDRESS: 535 White Oaks Blvd.
Denver, CO 80202 Bridgeport, WV 26330