



---

west virginia department of environmental protection

---

Office of Oil and Gas  
601 57<sup>th</sup> Street, S.E.  
Charleston, WV 25304  
(304) 926-0450  
fax: (304) 926-0452

Harold D. Ward, Cabinet Secretary  
[www.dep.wv.gov](http://www.dep.wv.gov)

Friday, March 13, 2026  
PERMIT MODIFICATION APPROVAL  
Horizontal 6A / New Drill

ANTERO RESOURCES CORPORATION  
1615 WYNKOOP STREET

DENVER, CO 80202

Re: Permit Modification Approval for Norton Unit 1H  
47-017-06998-00-00

**Extended Lateral**

ANTERO RESOURCES CORPORATION

The Office of Oil and Gas has reviewed the attached permit modification for the above referenced permit. The attached modification has been approved and well work may begin. Please be reminded that the oil and gas inspector is to be notified twenty-four (24) hours before permitted well work is commenced.

If there are any questions, please feel free to contact me at (304) 926- 0450.

H. Jason Harmon  
Acting Chief

Operator's Well Number: Norton Unit 1H  
Farm Name: Shawn A Glaspell  
U.S. WELL NUMBER: 47-017-06998-00-00  
Horizontal 6A New Drill  
Date Modification Issued: 3/13/2026

Promoting a healthy environment.

03/13/2026

STATE OF WEST VIRGINIA  
DEPARTMENT OF ENVIRONMENTAL PROTECTION, OFFICE OF OIL AND GAS  
WELL WORK PERMIT APPLICATION

1) Well Operator: Antero Resources Corporat 494507062 017-Doddrid McLellan Center Point  
Operator ID County District Quadrangle

2) Operator's Well Number: Norton Unit 1H MOD Well Pad Name: Yeater Pad

3) Farm Name/Surface Owner: Shawn A. Glaspell Public Road Access: Riggins Run Rd

4) Elevation, current ground: 1121' Elevation, proposed post-construction: 1121'

5) Well Type (a) Gas  Oil \_\_\_\_\_ Underground Storage \_\_\_\_\_

Other \_\_\_\_\_

(b) If Gas Shallow  Deep \_\_\_\_\_

Horizontal

6) Existing Pad: Yes or No Yes

7) Proposed Target Formation(s), Depth(s), Anticipated Thickness and Expected Pressure(s): Marcellus Shale: 7600' TVD, Anticipated Thickness- 55 feet, Associated Pressure- 2850#

REC'D  
FEB 23 2026

8) Proposed Total Vertical Depth: 7600' TVD

9) Formation at Total Vertical Depth: Marcellus

10) Proposed Total Measured Depth: 26100' MD

11) Proposed Horizontal Leg Length: 16796.5'

12) Approximate Fresh Water Strata Depths: 422', 514'

13) Method to Determine Fresh Water Depths: 47-017-00027, 47-017-06023

14) Approximate Saltwater Depths: 2297'

15) Approximate Coal Seam Depths: 449'

16) Approximate Depth to Possible Void (coal mine, karst, other): None Anticipated

17) Does Proposed well location contain coal seams directly overlying or adjacent to an active mine? Yes \_\_\_\_\_ No

(a) If Yes, provide Mine Info: Name: \_\_\_\_\_

Depth: \_\_\_\_\_

Seam: \_\_\_\_\_

Owner: \_\_\_\_\_

REC'D  
FEB 23 2026

18)



**CASING AND TUBING PROGRAM**

<b>TYPE</b>	<u>Size (in)</u>	<u>New or Used</u>	<u>Grade</u>	<u>Weight per ft. (lb/ft)</u>	<u>FOOTAGE: For Drilling (ft)</u>	<u>INTERVALS: Left in Well (ft)</u>	<u>CEMENT: Fill-up (Cu. Ft.)/CTS</u>
Conductor	20"	New	J-55	94#	100'	100'	CTS, 96 Cu. Ft.
Fresh Water	13-3/8"	New	J-55	54.5#	564'	564'	CTS, 588 Cu. Ft.
Coal	9-5/8"	New	J-55	36#	3000'	3000'	CTS, 1221 Cu. Ft.
Intermediate							
Production	5-1/2"	New	P-110	23#	26100'	26100'	5649 Cu. Ft
Tubing	2-3/8"	New	N-80	4.7#			
Liners							

<b>TYPE</b>	<u>Size (in)</u>	<u>Wellbore Diameter (in)</u>	<u>Wall Thickness (in)</u>	<u>Burst Pressure (psi)</u>	<u>Anticipated Max. Internal Pressure (psi)</u>	<u>Cement Type</u>	<u>Cement Yield (cu. ft./k)</u>
Conductor	20"	24"	0.438"	1530	50	Class A/L	~1.18
Fresh Water	13-3/8"	17-1/2"	0.38"	2730	1000	Class A/L	~1.18
Coal	9-5/8"	12-1/4"	0.352"	3520	1500	Class A/L	~1.18
Intermediate							
Production	5-1/2"	8-3/4" & 8-1/2"	0.415"	12,630	2500	Lead-H/POZ & Tail - H	H/POZ-1.44 & H-1.8
Tubing	2-3/8"	4.778"	0.19"	11,200			
Liners							

**PACKERS**

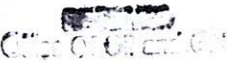
Kind:	N/A			
Sizes:	N/A			
Depths Set:	N/A			

  
**FEB 23 2026**  

19) Describe proposed well work, including the drilling and plugging back of any pilot hole:

Drill, perforate, fracture a new shallow well and complete Marcellus Shale.

20) Describe fracturing/stimulating methods in detail, including anticipated max pressure and max rate:

Antero plans to pump Slickwater into the Marcellus Shale formation in order to ready the well for production. The fluid will be comprised of approximately 99 percent water and sand, with less than 1 percent special-purpose additives as shown in the attached "List of Anticipated Additives Used for Fracturing or Stimulating Well."

Anticipated Max Pressure - 9300 lbs  
Anticipated Max Rate - 80 bpm

21) Total Area to be disturbed, including roads, stockpile area, pits, etc., (acres): 51.92 acres

22) Area to be disturbed for well pad only, less access road (acres): 14.54 acres

23) Describe centralizer placement for each casing string:

Conductor: no centralizers  
Surface Casing: one centralizer 10' above the float shoe, one on the insert float collar and one every 4th joint spaced up the hole to surface.  
Intermediate Casing: one centralizer above float joint, one centralizer 5' above float collar and one every 4th collar to surface.  
Production Casing: one centralizer at shoe joint and one every 3 joints to top of cement in intermediate casing.

24) Describe all cement additives associated with each cement type:

Conductor: no additives, Class A/L cement.  
Surface: Class A/L cement with 2-3% calcium chloride and 1/4 lb of flake  
Intermediate: Class A/L cement with 1/4 lb of flake, 5 gallons of clay treat  
Production: Lead cement- 50/50 Class H/Poz + 1.5% salt + 1% C-45 + 0.5% C-16a + 0.2% C-12 + 0.45% C-20 + 0.05% C-51  
Production: Tail cement- Class H + 45 PPS Calcium Carbonate + 1.0% FL-160 + 0.2% ACGB-47 + 0.05% ACSA-51 + 0.2% ACR-20

25) Proposed borehole conditioning procedures:

Conductor: blowhole clean with air, run casing, 10 bbls fresh water.  
Surface: blowhole clean with air, trip conductor shoe, trip to bottom, blowhole clean with air, trip out, run casing, circulate pip capacity +40 bbls fresh water followed by 25 bbls bentonite mud, 10 bbls fresh water spacer.  
Intermediate: blowhole clean with air, trip to surface casing shoe, trip to bottom, blowhole clean with air, trip out, run casing, circulate 40 bbls brine water followed by 10 bbls fresh water and 25 bbls bentonite mud, pump 10 bbls fresh water.  
Production: circulate with 14 lb/gal NaCl mud, trip to middle of lateral, circulate, pump high viscosity sweep, trip to base of curve, pump high viscosity sweep, trip to top of curve, trip to bottom, circulate, pump high viscosity sweep, trip out, run casing, circulate 10 bbls fresh water, pump 48 bbls barite pill, pump 10 bbls fresh water followed by 48 bbls mud flush and 10 bbls water.

\*Note: Attach additional sheets as needed.

**LEGEND**

- Proposed gas well
- ☼ Existing Well, as noted
- ☼ Digitized Well, as noted



The orientation of this survey is Grid North, and its coordinate base is the West Virginia Coordinate System of 1927, North Zone

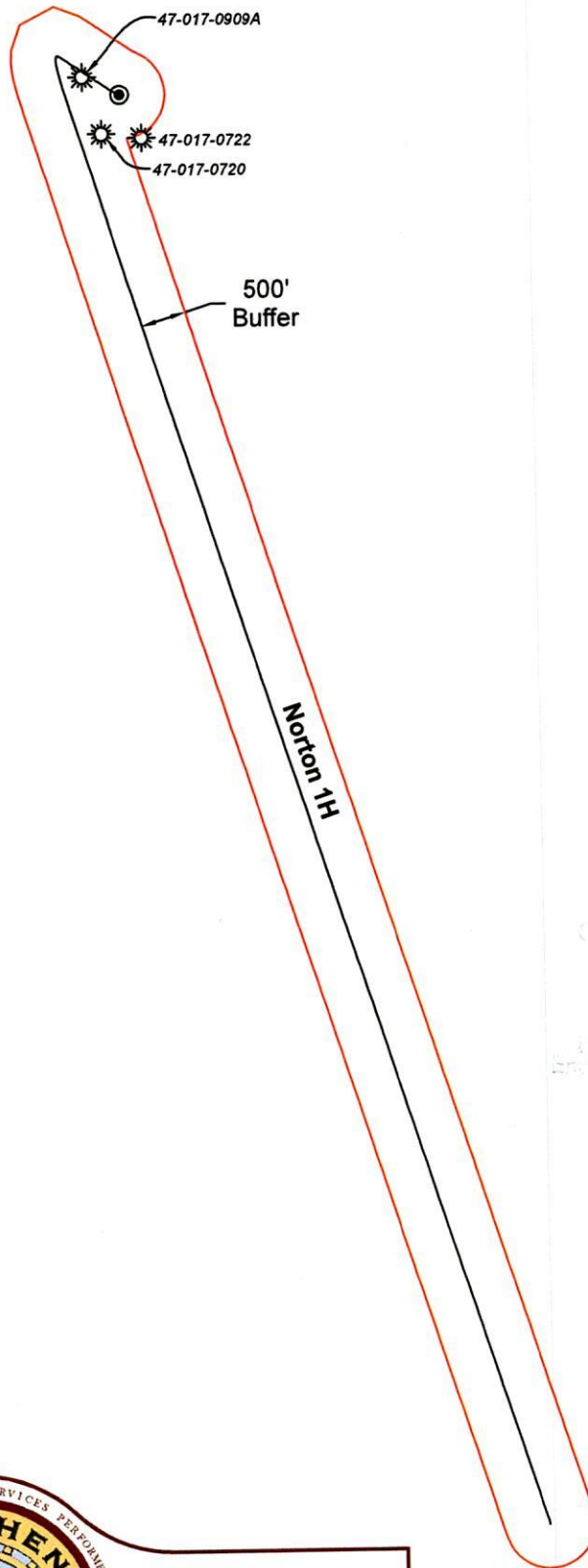

Office of Oil and Gas  
 FEB 23 2026  
 State of West Virginia

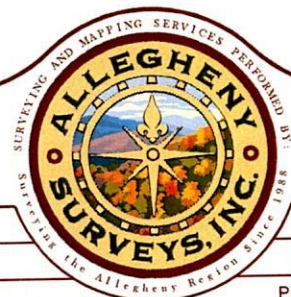

Bridgeport Office Phone: (304) 848-5035 Fax: (304) 848-5037		172 Thompson Drive Bridgeport, WV 26330	
PARTY CHIEF:	C. Lynch	DRAWN BY:	C. Robinson
RESEARCH:	J. Miller	PREPARED:	January 20, 2026
SURVEYED:	Dec. 2016	PROJECT NO:	344-30-M-24
FIELD CREW:	C.L., K.M.	Sheet 1 of 1	DRAWING NO: Norton 1H BHL MOD AOR



Scale: 1 inch = 2000 feet

03/13/2026

UWI (APINum)	Well Name	Well Number	Operator	Historical Operator	TD	Perforated Interval (shallowest, deepest)	Perforated Formation(s)	Producible Formation(s) not perf'd
4701700720	L MAXWELL 15-B	GW-1362	DIVERSIFIED PRODUCTION LLC	COLUMBIAN CARBON CO	1,800		Salt Sands, Big Injun	Weir, Alexander
4701790909								
4701700722	MARY WALTON	5	PRIOR FERRELL L	PRIOR FERRELL L	2,943		Gordon	Weir, Benson, Alexander

FEB 23 2025  
 FEB 23 2025  
 FEB 23 2025

FEB 23 2026  
 FEB 23 2026  
 FEB 23 2026

**Antero Resources**  
**Well No. Norton 1H**  
**BHL MOD**  
**Antero Resources Corporation**

**Page**  
**1 of 2**



Legend

- Proposed gas well
- Monument, as noted
- Existing Well, as noted
- Digitized Well, as noted
- Creek or Drain
- Road
- Surface boundary (approx.)
- Interior surface tracts (approx.)
- District Line

I, the undersigned, hereby certify that this plat is correct to the best of my knowledge and belief and shows all the information required by law and the rules issued and prescribed by the Department of Environmental Protection.

*Bradley D. Miller*  
 Bradley D. Miller, P.S. 2167

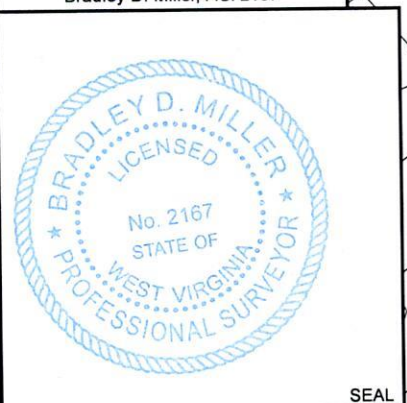

SEAL

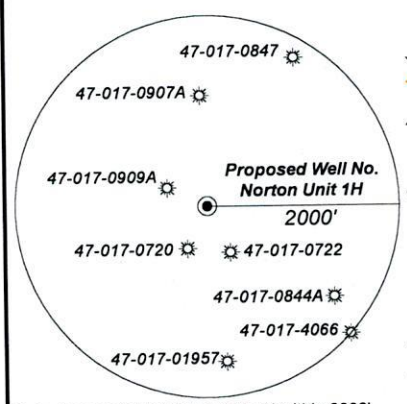

Note: Zero water wells were found within 2000' of proposed well. No occupied dwellings or buildings 2,500 square feet or larger used to house or shelter dairy cattle or poultry husbandry are located within 625' of the center of the well pad.

	Bearing	Dist.
L1	S 06°57' E	750.7'
L2	S 74°30' W	886.3'
L3	N 26°19' W	540.0'
L4	S 64°56' E	460.1'
L5	S 89°17' W	612.1'

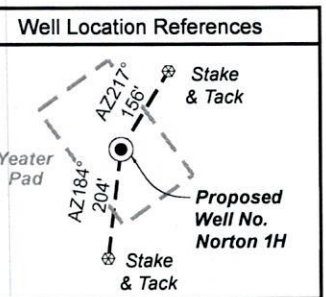

10,682' to Bottom Hole  
 3,658' to Top Hole  
 BHL LATITUDE 39 - 22 - 30  
 THL LATITUDE 39 - 25 - 00

THL LONGITUDE 80 - 40 - 00  
 BHL LONGITUDE 80 - 37 - 30

6,714' to Top Hole  
 7,454' to Bottom Hole

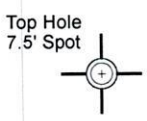
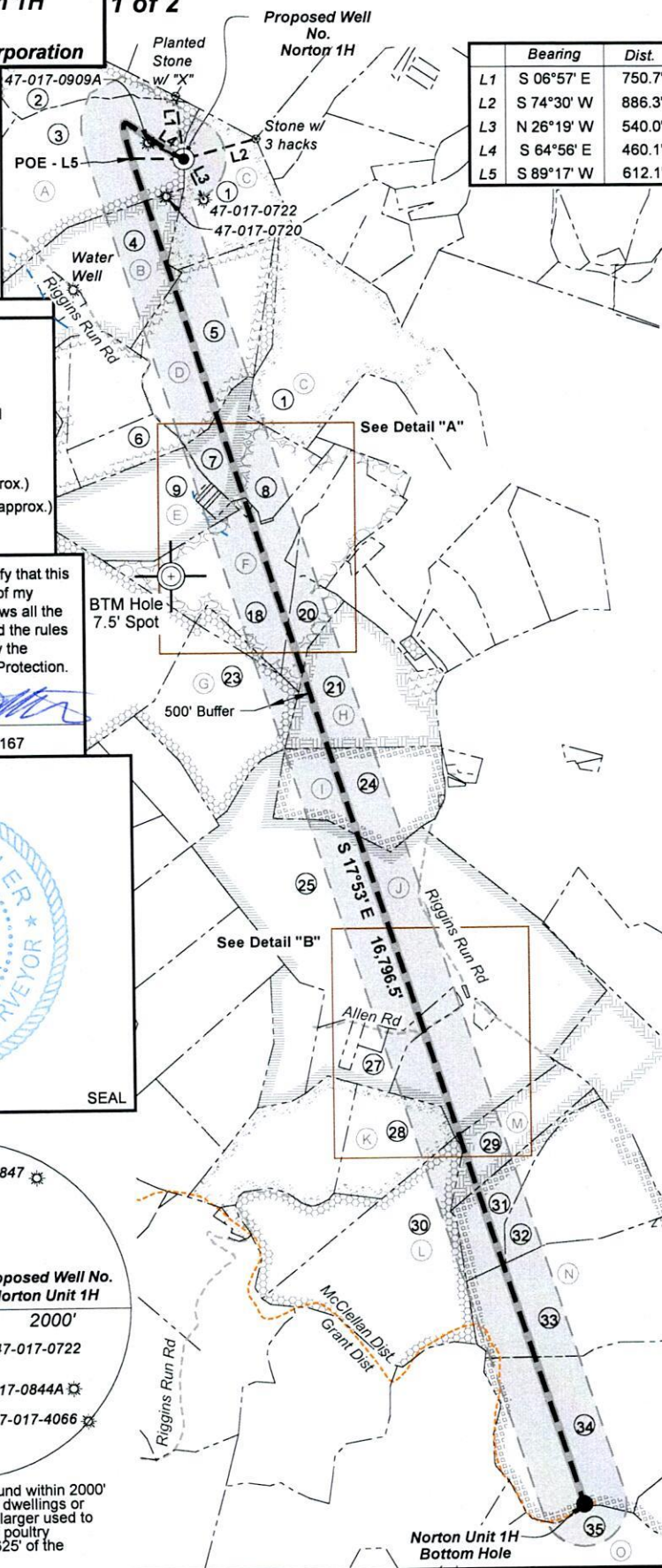

**Notes:**  
 Well No. Norton Unit 1H  
 UTM Zone 17, NAD 1927  
 Top Hole Coordinates  
 N: 14,307,092.87'  
 E: 1,730,927.27'  
 Point of Entry Coordinates  
 N: 14,307,090.32'  
 E: 1,730,315.39'  
 Bottom Hole Coordinates  
 N: 14,291,199.75'  
 E: 1,735,739.48'

**Notes**  
 West Virginia Coordinate System of 1927, North Zone based upon Differential GPS Measurements.  
 Well No. Norton Unit 1H Top Hole coordinates are  
 N: 329,343.34' Latitude: 39°23'53.64"  
 E: 1,666,652.31' Longitude: 80°40'46.60"  
 Bottom Hole coordinates are  
 N: 313,366.74' Latitude: 39°21'16.33"  
 E: 1,671,200.35' Longitude: 80°39'46.03"  
 UTM Zone 17, NAD 1983  
 Top Hole Coordinates Bottom Hole Coordinates  
 N: 4,361,028.755m N: 4,356,184.548m  
 E: 527,602.198m E: 529,068.969m  
 Plat orientation and corner and well references are based upon the grid north meridian.  
 Well location references are based upon the magnetic meridian.

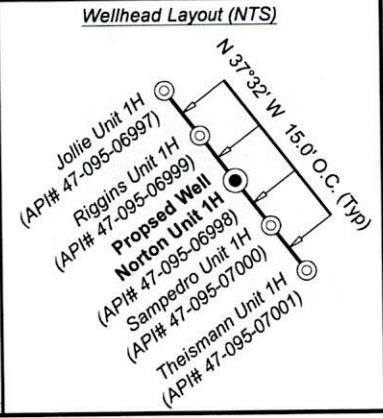

FILE NO: 344-30-M-24  
 DRAWING NO: Norton Unit 1H BHL Well Plat  
 SCALE: 1" = 2000'  
 MINIMUM DEGREE OF ACCURACY: Submeter  
 PROVEN SOURCE OF ELEVATION: WVDOT, Harrisville, WV

**STATE OF WEST VIRGINIA**  
 DEPARTMENT OF ENVIRONMENTAL PROTECTION  
**OIL AND GAS DIVISION**

DATE: February 11 20 26  
 OPERATOR'S WELL NO. Norton Unit 1H  
**API WELL NO**  
 47 - 017 - 06998  
 STATE COUNTY PERMIT

WELL TYPE:  OIL  GAS  LIQUID INJECTION  WASTE DISPOSAL  
 (IF GAS) PRODUCTION:  STORAGE  DEEP  SHALLOW  
 LOCATION: ELEVATION: Proposed: 1,121' WATERSHED: Headwaters of McElroy Creek QUADRANGLE: Centerpoint/Smithburg  
 DISTRICT: McClellan/Grant COUNTY: Doddridge  
 SURFACE OWNER: Shawn A. Glaspell ACREAGE: 254.08 **03/13/2026**  
 ROYALTY OWNER: Donald R. Reynolds LEASE NO: ACREAGE: 358.08  
 PROPOSED WORK:  DRILL  CONVERT  DRILL DEEPER  FRACTURE OR STIMULATE  PLUG OFF OLD FORMATION  
 PERFORATE NEW FORMATION  OTHER PHYSICAL CHANGE IN WELL (SPECIFY) BHL MOD  
 PLUG AND ABANDON  CLEAN OUT AND REPLUG TARGET FORMATION: Marcellus Shale ESTIMATED DEPTH: 7,600' TVD 26,100' MD

WELL OPERATOR: Antero Resources Corporation DESIGNATED AGENT: Conrad Baston  
 ADDRESS: 1615 Wynkoop Street ADDRESS: 535 White Oaks Blvd.  
 Denver, CO 80202 Bridgeport, WV 26330



Leases	
A	Donald R. Reynolds
B	Jacqueline L. Wichman Trust, U/A
C	Jeffrey Z. Groff
D	David E. Bowyer
E	Antero Minerals, LLC
F	Tribune Resources, LLC
G	Sidney Austin Smith Trust, LLC
H	Mary Ellen Guy
I	Pearl T. Shinn, Attorney in Fact for the N.W. Thomas Heirs namely: Minnie Backus, et al
J	J.D. & Ruth Foley
K	Acropolis, Inc.
L	AMP IV, LP
M	A.E. Gaspell, et al
N	J. Cecil Jarvis, Trustee, et al
O	J.D. & Ruth Foley

ID	TM-Par	Owner	Bk/Pg	Acres
1	18 / 1	Betty L. Wintill	360 / 723	116.75
2	11 / 25	Antero Resources Corp.	316 / 389	34.60
3	11 / 34	Shawn A. Gaspell	271 / 230	254.51
4	17 / 3.7	Treasa M. Bonnell	W129 / 201	60.71
5	17-3	Shawn A. Gaspell	283/601	45.26
6	17-3.14	Kathryn Renee Blessing, et al	WB39/506	14.00
7	17-3.8	Shawn A. Gaspell	283/601	13.58
8	17-11	Joseph R. & Dawn Armstrong	254/526	15.00
9	17-10	Kathryn Renee Blessing, et al	WB39/506	48.50
10	17-10.1	Kathryn Renee Blessing, et al	WB39/506	0.25
11	17-3.9	Shawn A. Gaspell	283/601	0.25
12	17-3.10	Shawn A. Gaspell	283/601	0.50
13	17-3.16	Lewis Nicholson	239/260	0.25
14	17-3.11	Shawn A. Gaspell	283/601	1.00
15	17-22	Joseph R. & Dawn G. Armstrong	254/526	0.61
16	17-11.1	Lewis & Eva Nicholson	227/388	0.01
17	17-23	Shawn A. Gaspell	283/601	0.69
18	17-14	Shawn A. Gaspell	283/601	63.05
19	18-34	Anita D. & Randal B. Underwood	515/63	23.84
20	18-35	Dean L., Shannon D. & Desaree D. Ash	WB128/131	11.00
21	18-51	Joey A. & Sherry E. Mills Family Living Trust	522/416	52.00
22	17-3.5	Shawn A. Gaspell	283/601	3.50
23	17-3.2	Shawn A. Gaspell	283/601	135.00
24	18-52	David L. Adams	WB68/312	49.00
25	23-1	Shawn A. Gaspell	288/248	211.15
26	23-1.5	Charles R. III & Michelle R. Henning	448/335	2.00
27	23-1.1	Charles R. & Zelda D. Henning	196/696	21.00
28	23-8.1	Johnie Johnson Jr.	393/716	28.71
29	23-4	Lawanna J. Norton	AB48/125	29.89
30	23-12	Jerry W. Harmon (life)	282/436	73.00
31	23-4.1	Lawanna J. Norton	WB48/540	20.00
32	23-9	Edward R. Bean	AB35/351	48.81
33	23-15	J. Samuel Archer	388/220	127.50
34	23-19	J. Samuel Archer	388/220	127.00
35	10-2	Norman I. & Victoria D. Sines	264/430	200.53

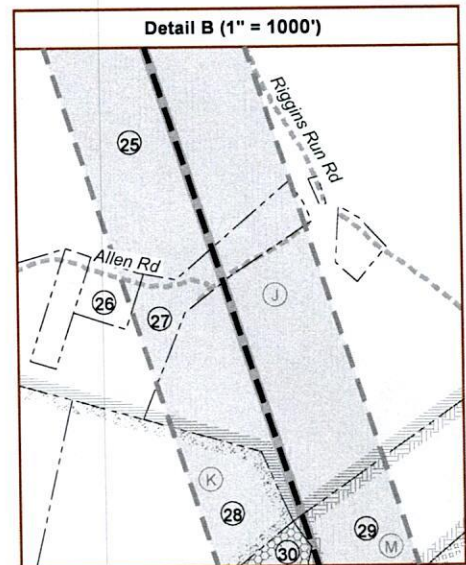
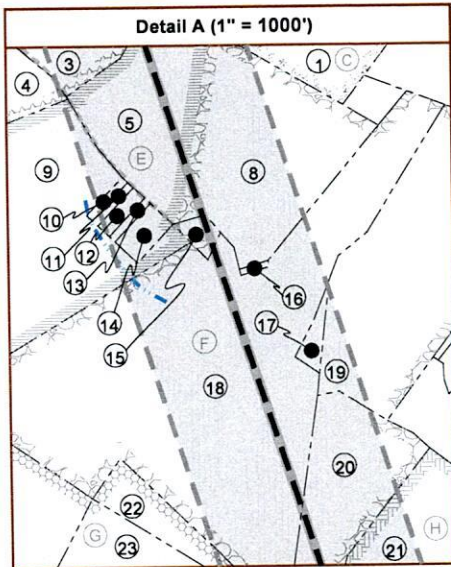

FILE NO: 344-30-M-24  
DRAWING NO: Norton Unit 1H BHL Well Plat  
SCALE: 1" = 2000'  
MINIMUM DEGREE OF ACCURACY:  
Submeter  
PROVEN SOURCE OF ELEVATION:  
WVDOT, Harrisville, WV

**STATE OF WEST VIRGINIA**  
DEPARTMENT OF ENVIRONMENTAL PROTECTION  
**OIL AND GAS DIVISION**

DATE: February 11 20 26  
OPERATOR'S WELL NO. Norton Unit 1H  
API WELL NO  
47 - 017 - 06998  
STATE COUNTY PERMIT

WELL TYPE:  OIL  GAS  LIQUID INJECTION  WASTE DISPOSAL  
(IF GAS) PRODUCTION:  STORAGE  DEEP  SHALLOW  
LOCATION: ELEVATION: Proposed: 1,121' WATERSHED: Headwaters of McElroy Creek QUADRANGLE: Centerpoint/Smithburg  
DISTRICT: McClellan/Grant COUNTY: Doddridge  
SURFACE OWNER: Shawn A. Gaspell ACREAGE: 254.08 03/13/2026  
ROYALTY OWNER: Donald R. Reynolds LEASE NO: ACREAGE: 358.08  
PROPOSED WORK:  DRILL  CONVERT  DRILL DEEPER  FRACTURE OR STIMULATE  PLUG OFF OLD FORMATION  
 PERFORATE NEW FORMATION  OTHER PHYSICAL CHANGE IN WELL (SPECIFY) BHL MOD  
 PLUG AND ABANDON  CLEAN OUT AND REPLUG TARGET FORMATION: Marcellus Shale ESTIMATED DEPTH: 7,600' TVD 26,100' MD

WELL OPERATOR: Antero Resources Corporation  
ADDRESS: 1615 Wynkoop Street  
Denver, CO 80202

DESIGNATED AGENT: Conrad Baston  
ADDRESS: 535 White Oaks Blvd.  
Bridgeport, WV 26330

**INFORMATION SUPPLIED UNDER WEST VIRGINIA CODE  
Chapter 22, Article 6A, Section 5(a)(5)  
IN LIEU OF FILING LEASE(S) AND OTHER CONTINUING CONTRACT(S)**

Under the oath required to make the verification on page 1 of this Notice and Application, I depose and say that I am the person who signed the Notice and Application for the Applicant, and that –

- (1) the tract of land is the same tract described in this Application, partly or wholly depicted in the accompanying plat, and described in the Construction and Reclamation Plan;
- (2) the parties and recordation data (if recorded) for lease(s) or other continuing contract(s) by which the Applicant claims the right to extract, produce or market the oil or gas are as follows:

Lease Name or Number	Grantor, Lessor, etc.	Grantee, Lessee, etc.	Royalty	Book/Page
<b><u>N: J. Cecil Jarvis, Trustee, et al Lease</u></b>				
	J. Cecil Jarvis, Trustee, et al	TAPO Energy LLC	1/8	207/400
	TAPO Energy LLC	Bluestone Energy Partners	Assignment	251/215
	Bluestone Energy Partners	BEP Merger Sub, LP	Merge	288/1
	BEP Merger Sub, LP	Antero Resources Bluestone LLC	Merge	288/1
	<b>Antero Resources Bluestone LLC</b>	<b>Antero Resources Corporation</b>	<b>Merge</b>	<b>WVSOS</b>

  
**FEB 23 2026**  

**Acknowledgement of Possible Permitting/Approval  
In Addition to the Office of Oil and Gas**

The permit applicant for the proposed well work addressed in this application hereby acknowledges the possibility of the need for permits and/or approvals from local, state, or federal entities in addition to the DEP, Office of Oil and Gas, including but not limited to the following:

- WV Division of Water and Waste Management
- WV Division of Natural Resources WV Division of Highways
- U.S. Army Corps of Engineers
- U.S. Fish and Wildlife Service
- County Floodplain Coordinator

The applicant further acknowledges that any Office of Oil and Gas permit in no way overrides, replaces, or nullifies the need for other permits/approvals that may be necessary and further affirms that all needed permits/approvals should be acquired from the appropriate authority before the affected activity is initiated.

Well Operator: Antero Resources Corporation  
 By: Tim Rady   
 Its: Senior Vice President of Land

INFORMATION SUPPLIED UNDER WEST VIRGINIA CODE  
Chapter 22, Article 6A, Section 5(a)(5)  
IN LIEU OF FILING LEASE(S) AND OTHER CONTINUING CONTRACT(S)

Under the oath required to make the verification on page 1 of this Notice and Application, I depose and say that I am the person who signed the Notice and Application for the Applicant, and that –

- (1) the tract of land is the same tract described in this Application, partly or wholly depicted in the accompanying plat, and described in the Construction and Reclamation Plan;
- (2) the parties and recordation data (if recorded) for lease(s) or other continuing contract(s) by which the Applicant claims the right to extract, produce or market the oil or gas are as follows:

Grantor, lessor, etc.	Grantee, lessee, etc.	Royalty	Book/Page
<b>C: Jeffrey Z. Groff Lease</b> Jeffrey Z. Groff	Antero Resources Corporation	1/8+	547/47
<b>A: Donald R. Reynolds Lease</b> Donald R. Reynolds Tribune Resources, LLC	Tribune Resources, LLC Antero Resources Corporation	1/8+ Assignment	501/249 530/325
<b>B: Jacqueline L. Wichman Trust, U/A Lease</b> Jacqueline L. Wichman Trust, U/A	Antero Resources Corporation	1/8+	517/39
<b>C: Jeffrey Z. Groff Lease</b> Jeffrey Z. Groff	Antero Resources Corporation	1/8+	547/47
<b>B: Jacqueline L. Wichman Trust, U/A Lease</b> Jacqueline L. Wichman Trust, U/A	Antero Resources Corporation	1/8+	517/39
<b>D: David E. Bowyer Lease</b> David E. Bowyer	Antero Resources Corporation	1/8+	1798/397
<b>E: Antero Minerals, LLC Lease</b> Antero Minerals, LLC	Antero Resources Corporation	1/8+	561/679
<b>F: Tribune Resources, LLC Lease</b> Tribune Resources, LLC	Antero Resources Corporation	Deed	559/324
<b>H: Mary Ellen Guy Lease</b> Mary Ellen Guy	Antero Resources Corporation	1/8+	562/19
<b>I: Pearl T. Shinn, Attorney in Fact for the N.W. Thomas Heirs namely: Minnie Backus, et al Lease</b> Pearl T. Shinn, Attorney in Fact for the N.W. Thomas Heirs namely: Minnie Backus, et al J & J Enterprises Incorporated Eastern American Energy Corporation TAPO Energy, LLC Bluestone Energy Partners Antero Resources Bluestone, LLC	J & J Enterprises Incorporated Eastern American Energy Corporation TAPO Energy, LLC Bluestone Energy Partners Antero Resources Bluestone, LLC Antero Resources Corporation	1/8 Merge Assignment Assignment Merge Merge	132/138 159/139 221/347 251/242 288/1 WVSOS
<b>J: J.D. &amp; Ruth Foley Lease</b> J.D. & Ruth Foley James F. Scott EMAX Oil Company	James F. Scott EMAX Oil Company Antero Resources Corporation	1/8 Assignment Assignment	100/240 161/1 342/346
<b>M: A.E. Glaspell, et al Lease</b> A.E. Glaspell, et al C.C. Cottrille Penn Resources, Incorporated Clarence W. Mutschelknaus Bluestone Energy Partners Antero Resources Appalachian Corporation	C.C. Cottrille Penn Resources, Incorporated Clarence W. Mutschelknaus Bluestone Energy Partners Antero Resources Appalachian Corporation Antero Resources Corporation	1/8 Assignment Assignment Assignment Merge Name Change	94/288 94/480 169/364 250/651 288/1 46/523

RECORDED  
FEB 23 2026

03/13/2026

INFORMATION SUPPLIED UNDER WEST VIRGINIA CODE  
 Chapter 22, Article 6A, Section 5(a)(5)  
 IN LIEU OF FILING LEASE(S) AND OTHER CONTINUING CONTRACT(S)

Under the oath required to make the verification on page 1 of this Notice and Application, I depose and say that I am the person who signed the Notice and Application for the Applicant, and that –

- (1) the tract of land is the same tract described in this Application, partly or wholly depicted in the accompanying plat, and described in the Construction and Reclamation Plan;
- (2) the parties and recordation data (if recorded) for lease(s) or other continuing contract(s) by which the Applicant claims the right to extract, produce or market the oil or gas are as follows:

Grantor, lessor, etc.	Grantee, lessee, etc.	Royalty	Book/Page
L: AMP IV, LP Lease AMP IV, LP	Antero Resources Corporation	1/8+	532/108
M: A.E. Glaspell, et al Lease A.E. Glaspell, et al C.C. Cottrille Penn Resources, Incorporated Clarence W. Mutschelknaus Bluestone Energy Partners Antero Resources Appalachian Corporation	C.C. Cottrille Penn Resources, Incorporated Clarence W. Mutschelknaus Bluestone Energy Partners Antero Resources Appalachian Corporation Antero Resources Corporation	1/8 Assignment Assignment Assignment Merge Name Change	94/288 94/480 169/364 250/651 288/1 46/523

\*Partial Assignments to Antero Resources Corporation include 100% rights to extract, produce and market the oil and gas from the Marcellus and any other formations completed with this well.

**\*Cotenancy Utilization** - Antero is utilizing the Co-tenancy Modernization and Majority Protection Act to proceed with development of certain royalty owners' interests in this tract.

**\*\*Pooling/Unitization** – Antero has filed a horizontal well unitization application with the West Virginia Oil and Gas Conservation Commission that seeks to pool certain owners in this tract

RECORDED  
 FEB 23 2026  
 WEST VIRGINIA DEPARTMENT OF REVENUE

Hearing Date 3/12/26



February 20<sup>th</sup>, 2026

West Virginia Department of Environmental Protection  
Office of Oil and Gas  
Attn: Mr. Taylor Brewer  
601 57<sup>th</sup> Street  
Charleston, WV 25304

Antero Resources  
1615 Wynkoop Street  
Denver, CO 80202  
Office 303.357.7310  
Fax 303.357.7315

Mr. Brewer:

Antero Resources Corporation (Antero) would like to submit the following permit modifications for approved wells on the Yeater Pad. We are requesting to extend the horizontal lateral length which will change the bottom hole locations of the Norton Unit 1H & Sampedro Unit 1H wells.

Attached you will find the following documents:

- REVISED Form WW-6B, which shows the revised MD and Production Casing/Cement program
- REVISED Form WW-6A1, which shows the leases we will be drilling into
- REVISED Mylar Plat, which shows the new bottom hole location

If you have any questions please feel free to contact me at (303) 357-7373.

Thank you in advance for your consideration.

Sincerely,

Carly Wren  
Permitting Agent  
Antero Resources Corporation

4047871  
12/16/25  
\$ 7,500.00

RECEIVED  
OFFICE OF OIL AND GAS  
FEB 23 2026  
STATE OF WEST VIRGINIA

Enclosures

03/13/2026