

Latitude 39° 27' 30"

88 37' 30"

Longitude



Topo Location

7.5' Loc. 1.22 S 15' Loc. 4.10 S
1.32 W (calc.) 3.55 W

Company _____

Farm C. J. Swiger 5602

15' Quad Centerpoint NC
(sec.)

7.5' Quad Center Point

District McClellan

WELL LOCATION PLAT

County 017 Permit 30075

75A

McClellan District, Doddridge County, W. Va.

By W. J. McCoy, Sistersville, W. Va.

On 100 acres, surface and mineral rights owned by Harry G. Swiger,
Shirley, W. Va.

Drilled before 1929.

Elevation, 1045'.

10" casing, 776'; 8 $\frac{1}{4}$ " , 1443'; 6-5/8" , 2126'.

Coal was encountered at 400-403 and 778-782'.

Abandonment reported to Dept. of Mines Nov. 13, 1933.

Well was shot at 2249-2253'.

Water not recorded.

Oil well; exhausted to extent that it is no longer commercially
productive.

| | Top. | Bottom. | Thickness. |
|--------------------------------------|------|---------|------------|
| Native coal | 400 | - 403 | 3 |
| Pittsburgh Coal | 778 | - 782 | 4 |
| Little Dunkard Sand | 1165 | - 1178 | 13 |
| Big Dunkard Sand | 1232 | - 1280 | 48 |
| Gas Sand | 1410 | - 1454 | 44 |
| First Salt Sand | 1526 | - 1560 | 34 |
| Second Salt Sand | 1617 | - 1867 | 250 |
| Maxton Sand | 1883 | - 1931 | 48 |
| Little Lime | 2074 | - 2092 | 18 |
| Pencil Cave | 2092 | - 2100 | 8 |
| Big Lime | 2100 | - 2160 | 60 |
| Big Injun Sand (oil, 2250 and 2253') | 2160 | | |
| Total depth | | | 2253 |

McClellan District, Doddridge County, W. Va. 75-A
 W. J. McCoy, Sistersville, W. Va. (Hope well originally?)
 On 100 acres, surface and mineral rights owned by Harry G. Swiger,
 Shirley, W. Va.
 Elevation, 1045'.
 10" casing, 776'; 8 1/2", 1043'; 6-5/8", 2126'.
 Abandonment reported to Dept. of Mines, Nov. 13, 1933.
 Well was shot at 2249-2253'.
 Water not recorded.

| | Top. | Bottom. |
|----------------------------------|------|---------|
| Native coal | 400 | 403 |
| Pittsburgh Coal | 776 | 782 |
| Little Dunkard Sand | 1165 | 1178 |
| Big Dunkard Sand | 1232 | 1280 |
| Gas Sand | 1410 | 1454 |
| First Salt Sand | 1526 | 1560 |
| Second Salt Sand | 1617 | 1867 |
| Maxton Sand | 1883 | 1931 |
| Little Lime | 2074 | 2092 |
| Pencil Cave | 2092 | 2100 |
| Big Lime | 2100 | 2160 |
| Big Lafun Sand (oil, 2250-2253') | 2160 | |
| Total depth | | 2253 |

COMPLETION DATA SHEET
No. 8
COMPLETION RECORD

| No. of Wells | Depth | Production | Completion | Notes |
|--------------|-------|------------|------------|-------|
| 1 | | | | |
| 2 | | | | |
| 3 | | | | |
| 4 | | | | |
| 5 | | | | |
| 6 | | | | |
| 7 | | | | |
| 8 | | | | |
| 9 | | | | |
| 10 | | | | |
| 11 | | | | |
| 12 | | | | |
| 13 | | | | |
| 14 | | | | |
| 15 | | | | |
| 16 | | | | |
| 17 | | | | |
| 18 | | | | |
| 19 | | | | |
| 20 | | | | |



1. The location of well 107, of the City of Atterville, Mo. on the City Plan for the District in Atterville, Mo. is shown.

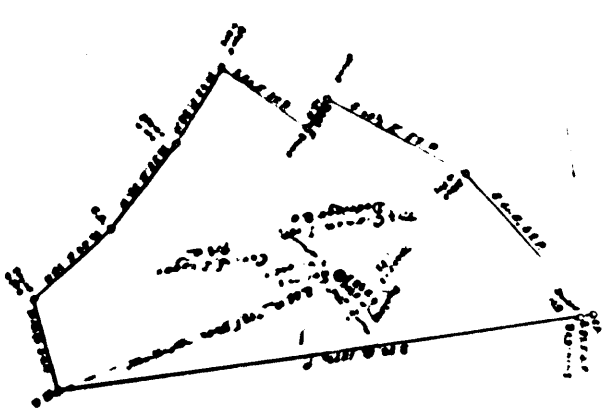

1. The information in this report is based on the data furnished to the City of Atterville, Mo. by the City of Atterville, Mo. on the City Plan for the District in Atterville, Mo. is shown.

By completion engineer on the day of 1937.

[Signature]
[Signature]

617-75A

AFFIDAVIT IN TRIPLICATE TO TIME AND MANNER OF
 PLUGGING AND FILLING WELL
 WEST VIRGINIA DEPARTMENT OF MINES
 (SEE ALSO USES HEREIN)

to and operations in this section. To, of, being

State of West Virginia, County of Putnam, to-wit:

James H. [Name],
 [Address]
 [City, State]

Applicant

STATE OF WEST VIRGINIA,
 County of Putnam

James H. [Name],
 [Address]
 [City, State]

James H. [Name],
 [Address]
 [City, State]

I, the undersigned, being a duly qualified and licensed professional engineer, do hereby certify that the above and foregoing is a true and correct copy of the original as the same appears in the files of the State Department of Mines, at the City of Charleston, West Virginia.

Witness my hand and seal of office this _____ day of _____, 19____.

 State Engineer

J. H. [Signature]
 State Engineer

WEST VIRGINIA DEPARTMENT OF MINES
 (SEE ALSO USES HEREIN)
 PRELIMINARY DATA SHEET No. 1

to and operations in this section. To, of, being

State of West Virginia, County of Putnam, to-wit:

James H. [Name],
 [Address]
 [City, State]

Applicant

STATE OF WEST VIRGINIA,
 County of Putnam

James H. [Name],
 [Address]
 [City, State]

James H. [Name],
 [Address]
 [City, State]

I, the undersigned, being a duly qualified and licensed professional engineer, do hereby certify that the above and foregoing is a true and correct copy of the original as the same appears in the files of the State Department of Mines, at the City of Charleston, West Virginia.

Witness my hand and seal of office this _____ day of _____, 19____.

 State Engineer

J. H. [Signature]
 State Engineer