

Latitude 39°22'30"

75'
+

80°45'00"

Longitude

Topo Location

7.5' Loc. 0.745 15' Loc. 3.645
2.06W (calc.) 2.06W

Company 2086

Farm Jasper Scott

15' Quad West Union EC
(sec.)

7.5' Quad West Union

District West Union

WELL LOCATION PLAT

County 017 Permit 30099

West Union District, Doddridge County, W. Va.
 By Pittsburgh & W. Va. Gas Co., Clarksburg, W. Va.
 On 75 acres (Map Ref, West Union, S.E.2-1); surface owned by
 Jasper Scott, Star Route, West Union, W. Va., and mineral
 rights by Rachel Robinson, R. F. D. No. 1, Mannington, W. Va.
 Well was completed July 8, 1911.
 Elevation, 980' L.
 13" conductor, 16'; 10" casing, 164'; 8 $\frac{1}{4}$ ", 1039'; 6-5/8", 1851'.
 Coal was encountered at 45-47, 326-330, and 577-580'.
 Abandonment reported to Dept. of Mines March 19, 1935.
 Located 3-23-1911; began drg. 6-8-1911; comp. drg. 7-8-1911.
 Fresh water at 880'; salt water at 1675'.
 Well was not shot. 6-5/8" hole. Gas well.

	Top.	Bottom.	Thickness.
Clay, red, soft	0	8	8
Slate, white, soft	8	35	27
Gravel, white, soft	35	37	2
Slate, white, soft	37	45	8
Coal, black, soft	45	47	2
Lime, white, hard	47	57	10
Slate, white, soft	57	97	40
Lime, white, hard	97	107	10
Slate, red, soft	107	157	50
Lime, white, hard	157	172	15
Slate, red, soft	172	212	40
Slate, white, soft	212	250	38
Sand, white, soft	250	265	15
Lime, white, hard	265	289	24
Slate, white, soft	289	305	16
Sand, white, hard	305	320	15
Slate, white, soft	320	326	6
Coal, black, soft	326	330	4
Slate, white, soft	330	340	10
Lime, white, hard	340	355	15
Slate, red, soft	355	400	45
Lime, wed, hard	400	435	35
Slate, red, soft	435	480	45
Slate and shell, white, hard	480	540	60
Slate, red, soft	540	555	15
Slate, white, soft	555	577	22
Pittsburgh Coal, black, soft	577	580	3
Lime, white, hard	580	600	20
Slate and shells, white, hard	600	710	110
Lime, white, hard	710	716	6
Slate, red, soft	716	734	18
Lime, white, hard	734	740	6
Slate, white, soft	740	765	25
Slate, red, soft	765	840	75
Little Dunkard Sand, white, hard (water at 880')	840	884	44
Slate, black, soft	885	900	15
Slate, white, soft	900	915	15
Slate, red, soft	915	955	40
Slate, white, soft	955	1005	50
Big Dunkard Sand, white, hard	1005	1030	25
Slate, black, soft	1030	1075	45

(OVER)

JOSHUA ROBINSON NO. 2086 WELL (Continued).

	Top.	Bottom.	Thickness.
Lime, white, hard	1075	- 1100	25
1st Salt Sand, white, hard	1100	- 1140	40
Slate and shells, white, hard	1140	- 1240	100
Slate, black, soft	1240	- 1260	20
2nd Salt Sand, white, hard	1260	- 1285	25
Slate and shells, white, soft	1285	- 1365	80
Coal, black, soft	1365	- 1371	6
Lime, white, hard	1371	- 1386	15
3rd Salt Sand, white, hard	1386	- 1550	164
Slate, black, soft	1550	- 1650	100
Maxton Sand, white, hard (water, 1675')	1650	- 1755	105
Slate, red, soft	1755	- 1775	20
Little Lime, white, hard	1775	- 1787	12
Slate, black, soft	1787	- 1815	28
Big Lime, white, hard	1815	- 1915	100
Big Injun Sand, white, hard (gas, 1983'; gas, 1995')	1915	- 2015	100
Slate, white, soft	2015	- 2025	10
Squaw Sand, white, hard (gas, 2056')	2025	- 2070	45
Unrecorded, to bottom	2070	- 2082	12

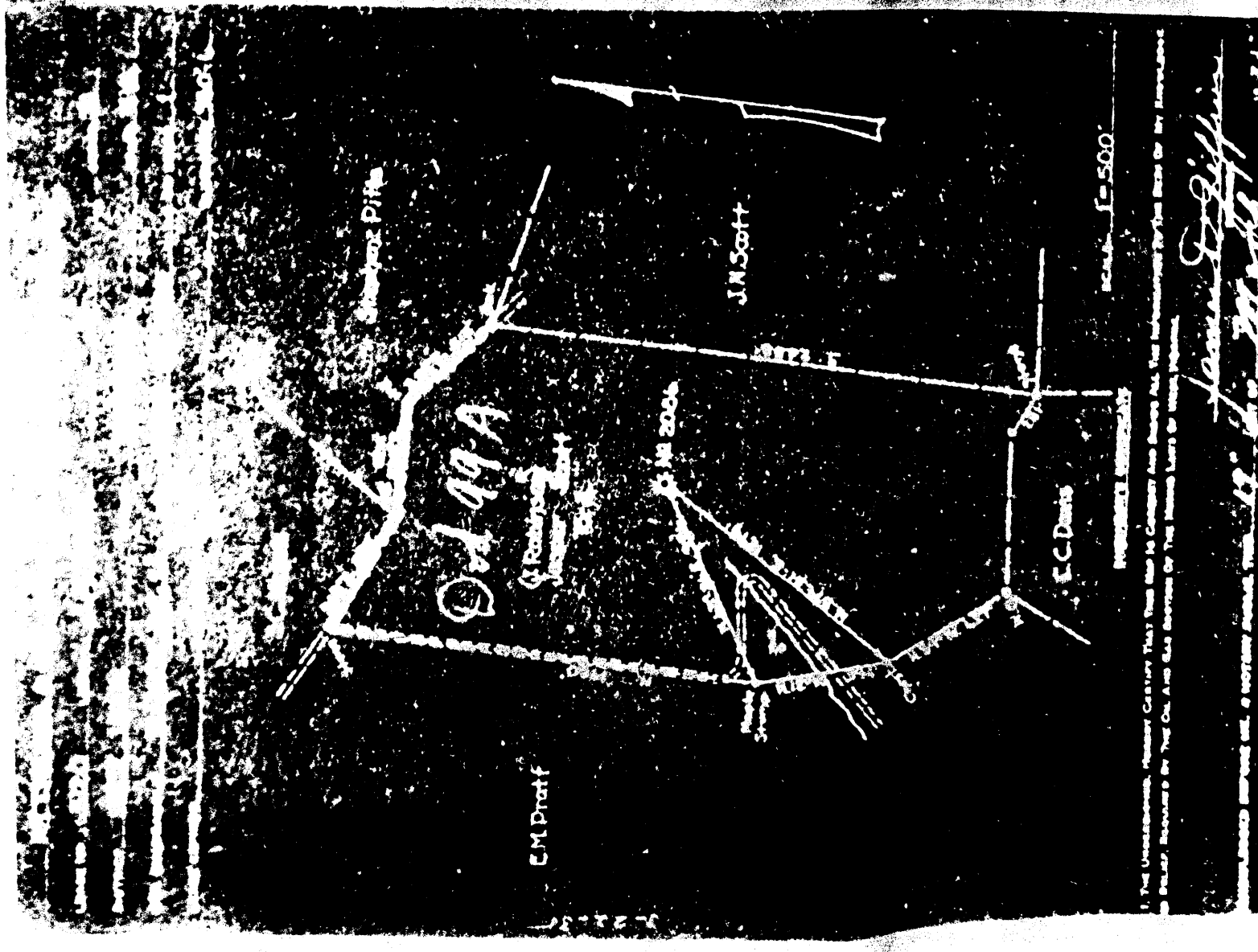

Survey Pits

J.N. Scott

Dad 99-A

R. M. 2006

R. M. 2007

E.C. Davis

E.M. Pratt

SCALE: 1" = 500'

I, THE UNDERSIGNED, HEREBY CERTIFY THAT THIS IS A CORRECT AND COMPLETE COPY OF THE ORIGINAL SURVEY RECORD FOR THIS OIL AND GAS LEASE AS SHOWN ON THE ABOVE MAP AND THAT I AM NOT PROVIDING ANY OTHER INFORMATION.

James P. Griffin
 19. 10. 1911

PITTSBURGH & WEST VA GAS COMPANY
 CLARKSBURG, WEST VA.

COMPLETION DATA SHEET
 NO. 2

FORMATION RECORD

Well No. 2086, Joshua Robinson farm,
 West Union Dist., Doddridge County, W. Va.

Name	Color	Character	(In. Gas or Water)	Top	Bottom	Thickness	Total Depth	Remarks
Clay	Red	Soft		0	8	8	8	
Slate	White	"		8	35	27	35	
Gravel	"	"		35	37	2	37	
Slate	"	"		37	45	8	45	
Coal	"	"		45	47	2	47	
Lime	Black	"		47	57	10	57	
Slate	White	Hard		57	97	40	97	
Lime	"	Hard		97	107	10	107	
Slate	"	Soft		107	157	50	157	
Lime	Red	Soft		157	172	15	172	
Slate	White	Hard		172	212	40	212	
Lime	Red	Soft		212	250	38	250	
Slate	White	"		250	265	15	265	
Sand	"	"		265	269	4	269	
Lime	"	Hard		269	285	16	285	
Slate	"	Soft		285	305	20	305	
Sand	"	Hard		305	330	25	330	
Slate	"	Soft		330	336	6	336	
Coal	"	"		336	330	4	330	
Slate	Black	"		330	340	10	340	
Lime	White	"		340	355	15	355	
Slate	"	Hard		355	400	45	400	
Lime	Red	Soft		400	435	35	435	
Slate	"	Hard		435	480	45	480	
Lime	"	Soft		480	540	60	540	
Slate	White	Hard		540	555	15	555	
Slate	Red	Soft		555	577	22	577	
"	"	"		577	580	3	580	
Pg. Coal	Black	Hard		580	600	20	600	
Lime	White	"		600	710	110	710	
Slate	"	"		710	716	6	716	
Lime	"	"		716	724	8	724	
Slate	Red	Soft		724	740	16	740	
Lime	White	Hard		740	755	15	755	
Slate	"	Soft		755	768	13	768	
"	"	"		768	795	27	795	
"	"	"		795	840	45	840	
"	"	"		840	885	45	885	
Little Dunkard	White	Hard		885	900	15	900	
Slate	Black	Soft		900	915	15	915	
"	White	"		915	935	20	935	
"	Red	"		935	1005	70	1005	
"	White	"		1005	1080	75	1080	
Big Dunkard	White	Hard		1080	1075	5	1075	
Slate	Black	Soft		1075	1100	25	1100	
Lime	White	Hard		1100	1140	40	1140	
Let. Salt Sand	"	"		1140	1240	100	1240	
Slate	"	"		1240	1340	100	1340	
Slate	"	"		1340	1440	100	1440	
Slate	"	"		1440	1540	100	1540	

1540' 65'

Well was not shot at
 Fresh water at 600'
 Not shot.
 Fresh water at 1075'

PITTSBURGH & WEST VA GAS COMPANY
 CLARKSBURG, WEST VA.

COMPLETION DATA SHEET
 NO. 2

FORMATION RECORD

Well No. 2086, Joshua Robinson farm,
 West Union Dist., Doddridge County, W. Va.

Name	Color	Character	(In. Gas or Water)	Top	Bottom	Thickness	Total Depth	Remarks
Slate	Black	Soft		1940	1860	80	1940	
Snd. Salt Sand	White	Hard		1860	1855	5	1855	
Slate	"	Soft		1855	1365	50	1365	
Coal	Black	"		1365	1371	6	1371	
Lime	White	Hard		1371	1386	15	1386	
Snd. Salt Sand	"	"		1386	1550	164	1550	
Slate	Black	Soft		1550	1650	100	1650	
Maron Sand	White	Hard	W-1675'	1650	1795	105	1795	
Slate	Red	Soft		1795	1775	20	1775	
Little Lime	White	Hard		1775	1767	8	1767	
Slate	Black	Soft		1767	1815	28	1815	
Big Lime	White	Hard		1815	1915	100	1915	
Big Lajun	"	"		1915	2015	100	2015	
Slate	"	Soft	G-1985'	2015	2025	10	2025	
Squas Sand	"	"	G-1995'	2025	2070	45	2070	
Un-recorded	"	Hard	G-2056'	2070	2038	32	2038	
Total Depth							2082'	

Well was not shot at
 Not shot.
 Fresh water at 1675'

AFFIDAVIT IN TRIPLICATE TO TIME AND MANNER OF PLUGGING AND FILLING WELL
(Approved by Chapter 5, Article 5, Section 56 of the Code)
WEST VIRGINIA DEPARTMENT OF MINES
OIL AND GAS DIVISION

WELL NO. 2086
WELL AND LOCATION
Star Post, West Union, East Va.
COUNTY Putnam
PLUGGING AND FILLING METHOD
Plugged with cement and iron pipe
DATE OF PLUGGING AND FILLING
March 1935

AFFIDAVIT

STATE OF WEST VIRGINIA,)
County of Putnam,) ss: Joseph Scott
I, the undersigned, being duly sworn, depose and say that the above named well was plugged and filled in the manner and to the time and in the manner herein stated, and that the work of plugging and filling said well was completed on the 11th day of March, 1935, and that the well was plugged and filled in the following manner:

Manner in which said well was plugged: Filled with Clay from total depth 2000' to 1004' Wood Plug 1'94' to 1'91' - Lead Plug 1'91' to 1'90'.
Cut 6-5/8" casing at 1'41 - 1'40 - 1'400 - 1100 - 1040
2" vent pipe welded in with perforations near top.

Manner in which coal was plugged:
Bridged hole outside 2-5/8" casing at 1'4' - Filled with Clay 1/4' to 20' - Cement 20' to surface. Bridged hole inside 6-5/8" casing at 11' - Filled with Cement around 2" vent pipe from 11' to surface. 2" vent pipe extending from 10' below said bridge to 9' above surface. End of 2" vent pipe welded in with perforations near top.
Description of monument. Cement and Iron Pipe Post - West Iron Pipe Co., Putnam, West Va. Co. 1935

and that the work of plugging and filling said well was completed on the 11th day of March, 1935.

WEST VIRGINIA DEPARTMENT OF MINES
OIL AND GAS DIVISION
PRELIMINARY DATA SHEET NO. 1

File No. Dod 99-A Well No. 2086
Pittsburgh & West Virginia Gas Company of Clemburg, J. Va.
containing 78 acres. Location Map W. U. S. E. 2-1 Putnam
West Union District in Putnam County, West Virginia
The surface of the above tract is owned in fee by Joseph Scott

of West Union, Star Route, E. Va. address, and the mineral rights are owned by Rachel Robinson of R. F. D. 1, Mannington, W. Va.

The oil and gas privileges are held under lease by the above named company, and this well is drilled under permit No. (Well Completed 7-8-1911)

Elevation of surface at top of well, 900
The number of feet of the different sized casings used in the well:
16 feet 1 1/2" dia. 130 feet 2" dia. 100 feet 3" dia. 100 feet 4" dia. 100 feet 6 5/8" dia. 100 feet 8" dia. 100 feet 10" dia. 100 feet 12" dia. 100 feet 14" dia. 100 feet 16" dia. 100 feet 18" dia. 100 feet 20" dia. 100 feet 24" dia. 100 feet 30" dia. 100 feet 36" dia. 100 feet 42" dia. 100 feet 48" dia. 100 feet 54" dia. 100 feet 60" dia. 100 feet 66" dia. 100 feet 72" dia. 100 feet 78" dia. 100 feet 84" dia. 100 feet 90" dia. 100 feet 96" dia. 100 feet 102" dia. 100 feet 108" dia. 100 feet 114" dia. 100 feet 120" dia. 100 feet 126" dia. 100 feet 132" dia. 100 feet 138" dia. 100 feet 144" dia. 100 feet 150" dia. 100 feet 156" dia. 100 feet 162" dia. 100 feet 168" dia. 100 feet 174" dia. 100 feet 180" dia. 100 feet 186" dia. 100 feet 192" dia. 100 feet 198" dia. 100 feet 204" dia. 100 feet 210" dia. 100 feet 216" dia. 100 feet 222" dia. 100 feet 228" dia. 100 feet 234" dia. 100 feet 240" dia. 100 feet 246" dia. 100 feet 252" dia. 100 feet 258" dia. 100 feet 264" dia. 100 feet 270" dia. 100 feet 276" dia. 100 feet 282" dia. 100 feet 288" dia. 100 feet 294" dia. 100 feet 300" dia. 100 feet 306" dia. 100 feet 312" dia. 100 feet 318" dia. 100 feet 324" dia. 100 feet 330" dia. 100 feet 336" dia. 100 feet 342" dia. 100 feet 348" dia. 100 feet 354" dia. 100 feet 360" dia. 100 feet 366" dia. 100 feet 372" dia. 100 feet 378" dia. 100 feet 384" dia. 100 feet 390" dia. 100 feet 396" dia. 100 feet 402" dia. 100 feet 408" dia. 100 feet 414" dia. 100 feet 420" dia. 100 feet 426" dia. 100 feet 432" dia. 100 feet 438" dia. 100 feet 444" dia. 100 feet 450" dia. 100 feet 456" dia. 100 feet 462" dia. 100 feet 468" dia. 100 feet 474" dia. 100 feet 480" dia. 100 feet 486" dia. 100 feet 492" dia. 100 feet 498" dia. 100 feet 504" dia. 100 feet 510" dia. 100 feet 516" dia. 100 feet 522" dia. 100 feet 528" dia. 100 feet 534" dia. 100 feet 540" dia. 100 feet 546" dia. 100 feet 552" dia. 100 feet 558" dia. 100 feet 564" dia. 100 feet 570" dia. 100 feet 576" dia. 100 feet 582" dia. 100 feet 588" dia. 100 feet 594" dia. 100 feet 600" dia. 100 feet 606" dia. 100 feet 612" dia. 100 feet 618" dia. 100 feet 624" dia. 100 feet 630" dia. 100 feet 636" dia. 100 feet 642" dia. 100 feet 648" dia. 100 feet 654" dia. 100 feet 660" dia. 100 feet 666" dia. 100 feet 672" dia. 100 feet 678" dia. 100 feet 684" dia. 100 feet 690" dia. 100 feet 696" dia. 100 feet 702" dia. 100 feet 708" dia. 100 feet 714" dia. 100 feet 720" dia. 100 feet 726" dia. 100 feet 732" dia. 100 feet 738" dia. 100 feet 744" dia. 100 feet 750" dia. 100 feet 756" dia. 100 feet 762" dia. 100 feet 768" dia. 100 feet 774" dia. 100 feet 780" dia. 100 feet 786" dia. 100 feet 792" dia. 100 feet 798" dia. 100 feet 804" dia. 100 feet 810" dia. 100 feet 816" dia. 100 feet 822" dia. 100 feet 828" dia. 100 feet 834" dia. 100 feet 840" dia. 100 feet 846" dia. 100 feet 852" dia. 100 feet 858" dia. 100 feet 864" dia. 100 feet 870" dia. 100 feet 876" dia. 100 feet 882" dia. 100 feet 888" dia. 100 feet 894" dia. 100 feet 900" dia. 100 feet 906" dia. 100 feet 912" dia. 100 feet 918" dia. 100 feet 924" dia. 100 feet 930" dia. 100 feet 936" dia. 100 feet 942" dia. 100 feet 948" dia. 100 feet 954" dia. 100 feet 960" dia. 100 feet 966" dia. 100 feet 972" dia. 100 feet 978" dia. 100 feet 984" dia. 100 feet 990" dia. 100 feet 996" dia. 100 feet 1002" dia. 100 feet 1008" dia. 100 feet 1014" dia. 100 feet 1020" dia. 100 feet 1026" dia. 100 feet 1032" dia. 100 feet 1038" dia. 100 feet 1044" dia. 100 feet 1050" dia. 100 feet 1056" dia. 100 feet 1062" dia. 100 feet 1068" dia. 100 feet 1074" dia. 100 feet 1080" dia. 100 feet 1086" dia. 100 feet 1092" dia. 100 feet 1098" dia. 100 feet 1104" dia. 100 feet 1110" dia. 100 feet 1116" dia. 100 feet 1122" dia. 100 feet 1128" dia. 100 feet 1134" dia. 100 feet 1140" dia. 100 feet 1146" dia. 100 feet 1152" dia. 100 feet 1158" dia. 100 feet 1164" dia. 100 feet 1170" dia. 100 feet 1176" dia. 100 feet 1182" dia. 100 feet 1188" dia. 100 feet 1194" dia. 100 feet 1200" dia. 100 feet 1206" dia. 100 feet 1212" dia. 100 feet 1218" dia. 100 feet 1224" dia. 100 feet 1230" dia. 100 feet 1236" dia. 100 feet 1242" dia. 100 feet 1248" dia. 100 feet 1254" dia. 100 feet 1260" dia. 100 feet 1266" dia. 100 feet 1272" dia. 100 feet 1278" dia. 100 feet 1284" dia. 100 feet 1290" dia. 100 feet 1296" dia. 100 feet 1302" dia. 100 feet 1308" dia. 100 feet 1314" dia. 100 feet 1320" dia. 100 feet 1326" dia. 100 feet 1332" dia. 100 feet 1338" dia. 100 feet 1344" dia. 100 feet 1350" dia. 100 feet 1356" dia. 100 feet 1362" dia. 100 feet 1368" dia. 100 feet 1374" dia. 100 feet 1380" dia. 100 feet 1386" dia. 100 feet 1392" dia. 100 feet 1398" dia. 100 feet 1404" dia. 100 feet 1410" dia. 100 feet 1416" dia. 100 feet 1422" dia. 100 feet 1428" dia. 100 feet 1434" dia. 100 feet 1440" dia. 100 feet 1446" dia. 100 feet 1452" dia. 100 feet 1458" dia. 100 feet 1464" dia. 100 feet 1470" dia. 100 feet 1476" dia. 100 feet 1482" dia. 100 feet 1488" dia. 100 feet 1494" dia. 100 feet 1500" dia. 100 feet 1506" dia. 100 feet 1512" dia. 100 feet 1518" dia. 100 feet 1524" dia. 100 feet 1530" dia. 100 feet 1536" dia. 100 feet 1542" dia. 100 feet 1548" dia. 100 feet 1554" dia. 100 feet 1560" dia. 100 feet 1566" dia. 100 feet 1572" dia. 100 feet 1578" dia. 100 feet 1584" dia. 100 feet 1590" dia. 100 feet 1596" dia. 100 feet 1602" dia. 100 feet 1608" dia. 100 feet 1614" dia. 100 feet 1620" dia. 100 feet 1626" dia. 100 feet 1632" dia. 100 feet 1638" dia. 100 feet 1644" dia. 100 feet 1650" dia. 100 feet 1656" dia. 100 feet 1662" dia. 100 feet 1668" dia. 100 feet 1674" dia. 100 feet 1680" dia. 100 feet 1686" dia. 100 feet 1692" dia. 100 feet 1698" dia. 100 feet 1704" dia. 100 feet 1710" dia. 100 feet 1716" dia. 100 feet 1722" dia. 100 feet 1728" dia. 100 feet 1734" dia. 100 feet 1740" dia. 100 feet 1746" dia. 100 feet 1752" dia. 100 feet 1758" dia. 100 feet 1764" dia. 100 feet 1770" dia. 100 feet 1776" dia. 100 feet 1782" dia. 100 feet 1788" dia. 100 feet 1794" dia. 100 feet 1800" dia. 100 feet 1806" dia. 100 feet 1812" dia. 100 feet 1818" dia. 100 feet 1824" dia. 100 feet 1830" dia. 100 feet 1836" dia. 100 feet 1842" dia. 100 feet 1848" dia. 100 feet 1854" dia. 100 feet 1860" dia. 100 feet 1866" dia. 100 feet 1872" dia. 100 feet 1878" dia. 100 feet 1884" dia. 100 feet 1890" dia. 100 feet 1896" dia. 100 feet 1902" dia. 100 feet 1908" dia. 100 feet 1914" dia. 100 feet 1920" dia. 100 feet 1926" dia. 100 feet 1932" dia. 100 feet 1938" dia. 100 feet 1944" dia. 100 feet 1950" dia. 100 feet 1956" dia. 100 feet 1962" dia. 100 feet 1968" dia. 100 feet 1974" dia. 100 feet 1980" dia. 100 feet 1986" dia. 100 feet 1992" dia. 100 feet 1998" dia. 100 feet 2004" dia. 100 feet 2010" dia. 100 feet 2016" dia. 100 feet 2022" dia. 100 feet 2028" dia. 100 feet 2034" dia. 100 feet 2040" dia. 100 feet 2046" dia. 100 feet 2052" dia. 100 feet 2058" dia. 100 feet 2064" dia. 100 feet 2070" dia. 100 feet 2076" dia. 100 feet 2082" dia. 100 feet 2088" dia. 100 feet 2094" dia. 100 feet 2100" dia. 100 feet 2106" dia. 100 feet 2112" dia. 100 feet 2118" dia. 100 feet 2124" dia. 100 feet 2130" dia. 100 feet 2136" dia. 100 feet 2142" dia. 100 feet 2148" dia. 100 feet 2154" dia. 100 feet 2160" dia. 100 feet 2166" dia. 100 feet 2172" dia. 100 feet 2178" dia. 100 feet 2184" dia. 100 feet 2190" dia. 100 feet 2196" dia. 100 feet 2202" dia. 100 feet 2208" dia. 100 feet 2214" dia. 100 feet 2220" dia. 100 feet 2226" dia. 100 feet 2232" dia. 100 feet 2238" dia. 100 feet 2244" dia. 100 feet 2250" dia. 100 feet 2256" dia. 100 feet 2262" dia. 100 feet 2268" dia. 100 feet 2274" dia. 100 feet 2280" dia. 100 feet 2286" dia. 100 feet 2292" dia. 100 feet 2298" dia. 100 feet 2304" dia. 100 feet 2310" dia. 100 feet 2316" dia. 100 feet 2322" dia. 100 feet 2328" dia. 100 feet 2334" dia. 100 feet 2340" dia. 100 feet 2346" dia. 100 feet 2352" dia. 100 feet 2358" dia. 100 feet 2364" dia. 100 feet 2370" dia. 100 feet 2376" dia. 100 feet 2382" dia. 100 feet 2388" dia. 100 feet 2394" dia. 100 feet 2400" dia. 100 feet 2406" dia. 100 feet 2412" dia. 100 feet 2418" dia. 100 feet 2424" dia. 100 feet 2430" dia. 100 feet 2436" dia. 100 feet 2442" dia. 100 feet 2448" dia. 100 feet 2454" dia. 100 feet 2460" dia. 100 feet 2466" dia. 100 feet 2472" dia. 100 feet 2478" dia. 100 feet 2484" dia. 100 feet 2490" dia. 100 feet 2496" dia. 100 feet 2502" dia. 100 feet 2508" dia. 100 feet 2514" dia. 100 feet 2520" dia. 100 feet 2526" dia. 100 feet 2532" dia. 100 feet 2538" dia. 100 feet 2544" dia. 100 feet 2550" dia. 100 feet 2556" dia. 100 feet 2562" dia. 100 feet 2568" dia. 100 feet 2574" dia. 100 feet 2580" dia. 100 feet 2586" dia. 100 feet 2592" dia. 100 feet 2598" dia. 100 feet 2604" dia. 100 feet 2610" dia. 100 feet 2616" dia. 100 feet 2622" dia. 100 feet 2628" dia. 100 feet 2634" dia. 100 feet 2640" dia. 100 feet 2646" dia. 100 feet 2652" dia. 100 feet 2658" dia. 100 feet 2664" dia. 100 feet 2670" dia. 100 feet 2676" dia. 100 feet 2682" dia. 100 feet 2688" dia. 100 feet 2694" dia. 100 feet 2700" dia. 100 feet 2706" dia. 100 feet 2712" dia. 100 feet 2718" dia. 100 feet 2724" dia. 100 feet 2730" dia. 100 feet 2736" dia. 100 feet 2742" dia. 100 feet 2748" dia. 100 feet 2754" dia. 100 feet 2760" dia. 100 feet 2766" dia. 100 feet 2772" dia. 100 feet 2778" dia. 100 feet 2784" dia. 100 feet 2790" dia. 100 feet 2796" dia. 100 feet 2802" dia. 100 feet 2808" dia. 100 feet 2814" dia. 100 feet 2820" dia. 100 feet 2826" dia. 100 feet 2832" dia. 100 feet 2838" dia. 100 feet 2844" dia. 100 feet 2850" dia. 100 feet 2856" dia. 100 feet 2862" dia. 100 feet 2868" dia. 100 feet 2874" dia. 100 feet 2880" dia. 100 feet 2886" dia. 100 feet 2892" dia. 100 feet 2898" dia. 100 feet 2904" dia. 100 feet 2910" dia. 100 feet 2916" dia. 100 feet 2922" dia. 100 feet 2928" dia. 100 feet 2934" dia. 100 feet 2940" dia. 100 feet 2946" dia. 100 feet 2952" dia. 100 feet 2958" dia. 100 feet 2964" dia. 100 feet 2970" dia. 100 feet 2976" dia. 100 feet 2982" dia. 100 feet 2988" dia. 100 feet 2994" dia. 100 feet 3000" dia. 100 feet 3006" dia. 100</