

Latitude 39° 17' 30"

80° 52' 30"

7.5' +

Longitude

Topo Location

7.5' Loc. 1.22S 15' Loc. 4.10S
0.06W (calc.) 2.29W

Company C-1261

Farm E. H. Dotson

15' Quad West Union SC
(sec.)

7.5' Quad Pennsboro

District Central

WELL LOCATION PLAT

County 017 Permit 30124

Dodd 124A

Central District, Doddrige County, W. Va.
 By Hope Cons. & Ref. Co., 445 W. Main St., Clarksburg, W. Va.
 On 40 acres, surface and mineral rights owned by J. L. Young,
 Greenwood, W. Va.

Elevation, 976' l.
 6-5/8" casing, 1902'; 5-3/16", 1900'; 2" tubing, 2010'.
 Coal was encountered at 644-647'.
 Abandonment reported to Dept. of Mines August 7, 1935.
 Well was shot at 1992'.
 Fresh water at 1104'; salt water at 1464'-and 1820'.
 Oil well.

	Top.	Bottom.	Thickness.
Pittsburgh Coal	644	647	3
First Cow Run Sand	974	1015	41
Second Cow Run Sand (water, 1104')	1057	1108	21
First Salt Sand (water, 1464')	1434	1491	57
Second Salt Sand	1511	1701	190
Maxton Sand (water, 1820')	1786	1852	66
Little Lime	1852	1875	23
Pencil Cave	1875	1892	17
Big Lime	1892	1971	79
Big Injun Sand (oil, 1992')	1971	2021	50
Total depth		2021	

Well No. 1001

FORMATION RECORD

Depth	Color	Character	Oil Line or Water	Top	Bottom	Thickness	True Dip	Remarks
1104				644	647	3'	0°	
1104				974	1015	41'	41°	
1104				1097	1106	12'	12°	
1104				1454	1481	97'	97°	
1104				1511	1701	190'	190°	
1104				1796	1888	92'	92°	
1104				1852	1875	23'	23°	
1104				1875	1886	11'	11°	
1104				1882	1871	11'	11°	
1104				1971	2001	30'	30°	
								2001 to 2002 20' 2"

Well was not shot at _____ feet; well was shot at 1992 feet
 Salt _____ feet
 Fresh water at 1104 feet; fresh water at 1464-1620 feet
 Well was _____ producing _____ inch
 dry _____

August 7th, 1935.
 Date

Approved Ego Construction & Refining Company

Well No. 1001

FORMATION RECORD

Depth	Color	Character	Oil Line or Water	Top	Bottom	Thickness	True Dip	Remarks
1104				644	647	3'	0°	
1104				974	1015	41'	41°	
1104				1097	1106	12'	12°	
1104				1454	1481	97'	97°	
1104				1511	1701	190'	190°	
1104				1796	1888	92'	92°	
1104				1852	1875	23'	23°	
1104				1875	1886	11'	11°	
1104				1882	1871	11'	11°	
1104				1971	2001	30'	30°	
								2001 to 2002 20' 2"

Well was not shot at _____ feet; well was shot at 1992 feet
 Salt _____ feet
 Fresh water at 1104 feet; fresh water at 1464-1620 feet
 Well was _____ producing _____ inch
 dry _____

August 7th, 1935.
 Date

Approved Ego Construction & Refining Company

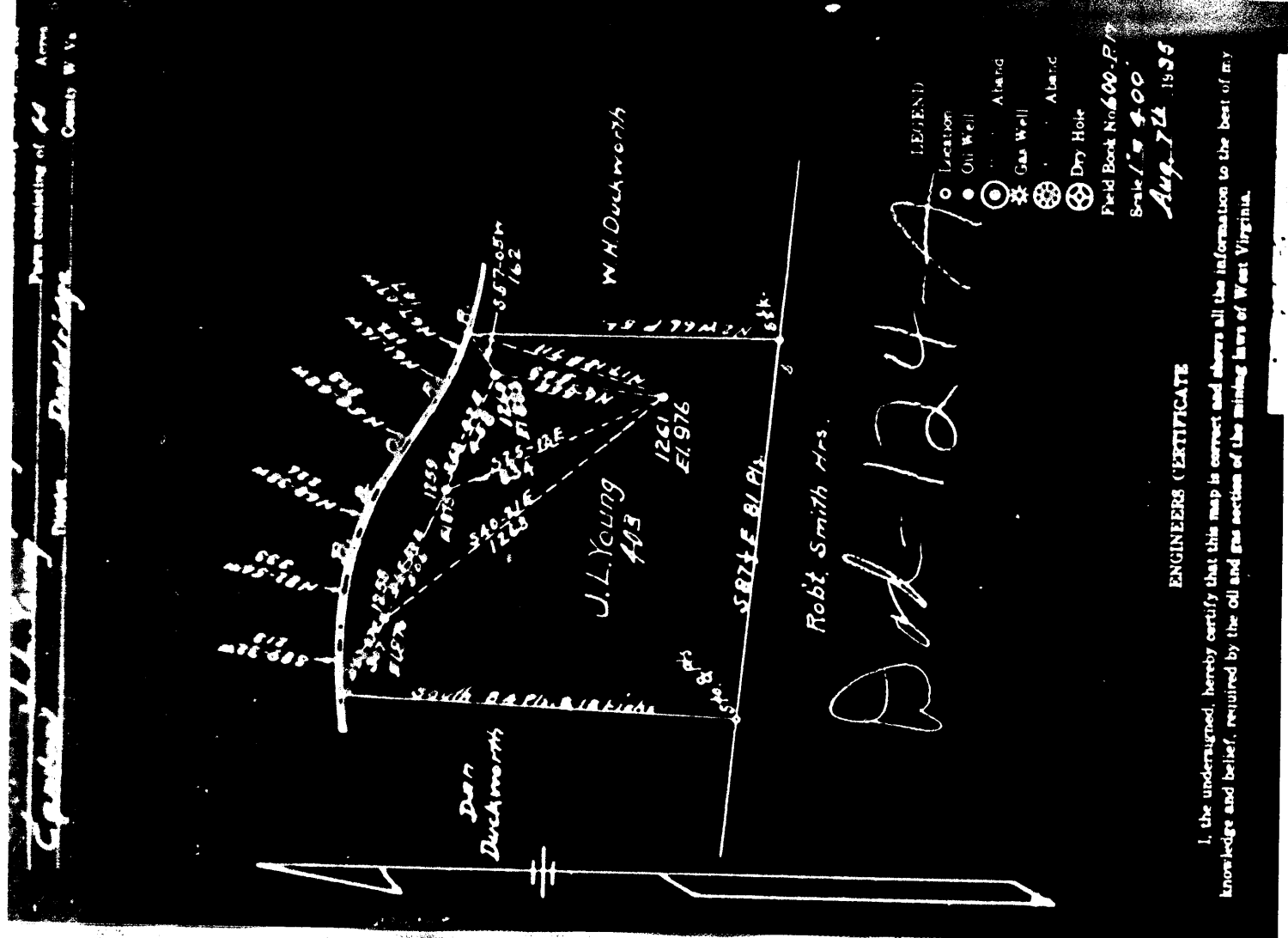

WEST VIRGINIA DEPARTMENT OF MINES

OIL AND GAS DIVISION

PRELIMINARY DATA SHEET NO. 1

Well No. 1261
Rigo Construction & Refining Co., Company of 644 East Main St.,
Clarksburg, W. Va., on the J. L. Young

County, Doddridge County, West Virginia
The surface of the above land is owned in fee by J. L. Young
of Clarksburg, W. Va., address, and the mineral rights are owned by
J. L. Young of Clarksburg, W. Va.

The oil and gas privileges are held under lease by the above named company, and this well is drilled under permit
issued by the West Virginia Department of Mines, Oil and Gas Division

Elevation of surface at top of well 976
The number of feet of the different sized casings used in the well

Table with columns for casing size (e.g., 6-5/8", 4", 3-1/2"), length in feet, and weight. Includes a section for 'Liners were used as follows: (Give details)'.

August 7th, 1928, Date

PLUGGING AND FILLING WELL
WEST VIRGINIA DEPARTMENT OF MINES
OIL AND GAS DIVISION

No Coal Operations in vicinity.
Coal operations at mine
Coal Owner: CHARLES.
WELL AND LOCATION
Clarksburg, W. Va.
September 18th, 1928.
County Doddridge
Well No. 1261
J. L. Young

AFFIDAVIT

STATE OF WEST VIRGINIA,
County of Doddridge

Parlay S. Williams and Albert Rainfall
being first duly sworn according to law depose and say that they are experienced in the work of plugging
and filling oil and gas wells and were employed by Rigo Construction & Refining Company
and participated in the work of plugging and filling the above well, that said work was commenced on the
5th day of August, 1928, and that the well was plugged and filled in
the following manner:

Manner in which well was plugged: Removed 2" tubing filled with clay to 1261'
cemented at 1261' removed 2 3/16" casing, filled with clay to 1200' above
200 lb. lead wool at 1200' slipped 6 5/8" casing at 1179' bridged at 1200'
filled with clay to 1200' cemented at 1200' installed permanent bridge at
1490' filled with clay to 1490' cemented at 1490' permanent bridge at
1190' filled with clay to 1000' cemented at 1000' permanent bridge at 877' filled with
cement from 877' to 684 ft. filled with clay to top of surface

Manner in which coal was plugged:
Cemented from 877 ft to 684 ft.

Description of monument:
Rig still standing will erect concrete monument when rig is torn down
1928
August 7th, 1928

Parlay S. Williams
Albert Rainfall
Circular stamp: RECEIVED SEP 12 1928