

Latitude 39°15'00"

2840.0488

75'
+

Longitude

Topo Location

7.5' Loc. 1.32S 15' Loc. 1.32S
0.28W (calc.) 0.28W

Company C-523

Farm W. H. Douglas

15' Quad (sec.)

7.5' Quad New Milton

District New Milton

WELL LOCATION PLAT

County 017 Permit 30145

Dud-145-A

New Milton District, Doddridge County, W. Va.
 By Hope Construction & Refining Co., 445 W. Main St.,
 Clarksburg, W. Va.

On 218 acres, surface owned by A. L. Keister, New Milton, W. Va.;
 owner of mineral rights, unknown.

Elevation, 1098' L.

8½" casing, 1310'; 6-5/8", 2150'; 2" tubing, 2230'.

Coal was encountered at 225-227 and 762-770'.

Abandonment reported to Dept. of Mines April 21, 1936.

Well was shot at 2206-2211 and 2190-2195'.

No record of water.

Oil well.

	Top.	Bottom.	Thickness.
Native coal	225	- 227	2
Pittsburgh Coal	762	- 770	8
Little Dunkard Sand	1130	- 1145	15
Big Dunkard Sand	1286	- 1302	16
Gas Sand	1310	- 1360	50
First Salt Sand	1490	- 1570	80
Second Salt Sand	1810	- 1900	90
Maxton Sand	2022	- 2042	20
Little Lime	2073	- 2093	20
Pencil Cave	2093	- 2118	25
Big Lime	2118	- 2170	52
Big Injun Sand (oil, 2208-2212')	2170	- 2250	80
Squaw Sand	2252	- 2270	18
Gantz Sand	2365	- 2490	25
Fifty-foot Sand	2600	- 2615	15
Thirty-foot Sand	2690	- 2715	25
Gordon Stray Sand	2813	- 2826	13
Gordon Sand	2835	- 2838	3
Originally drilled to		2892	
Filled and plugged to present total depth		2230	

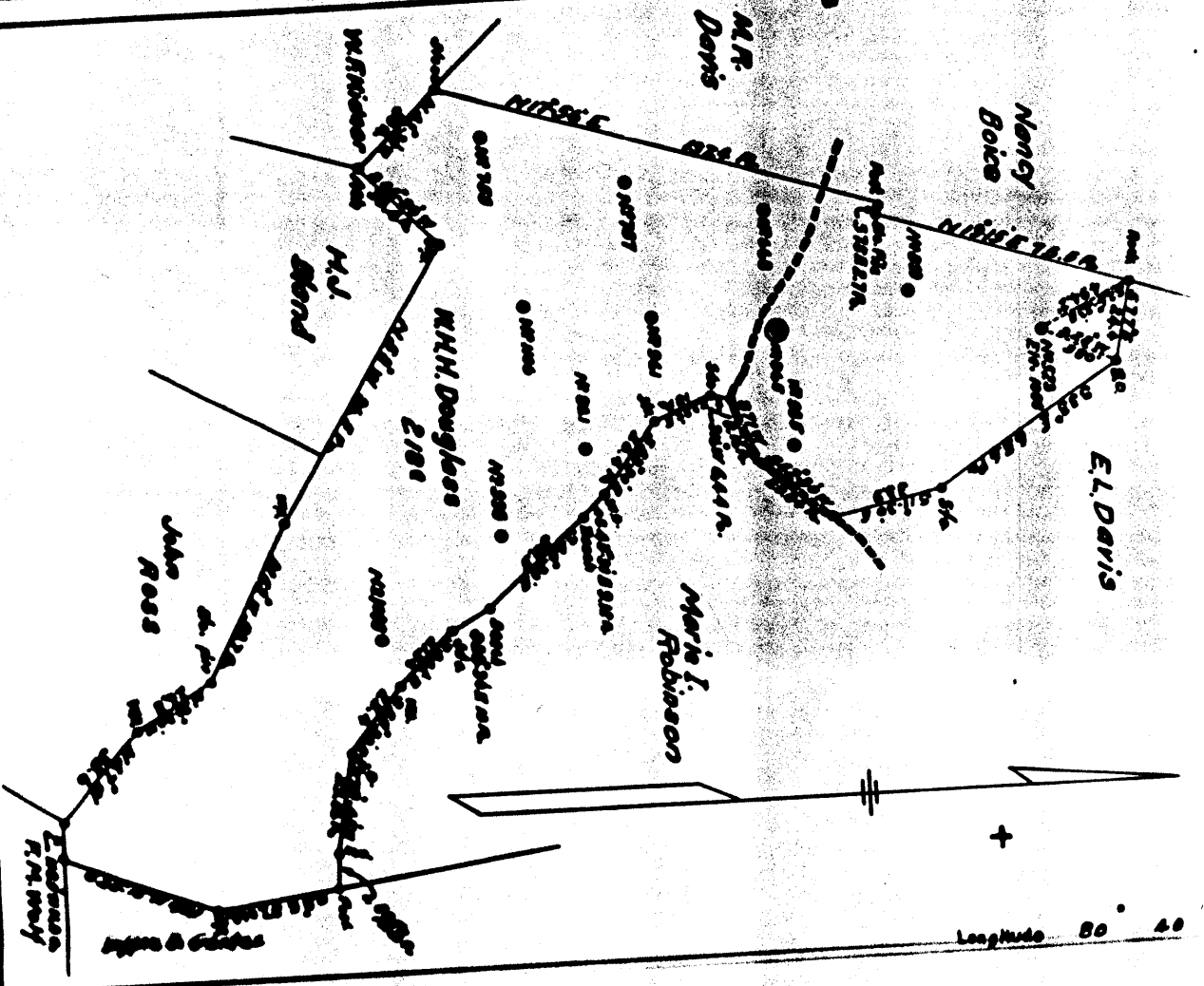

Company **HOPE CONSTRUCTION CO.**
 Address **CLARKSBURG W.V.**
 From **W.H.H. Douglas**
 Tract **June 21/8 Lease No. 827**
 Well (Form) No. **1** Serial No. **528**

STATE OF WEST VIRGINIA
 DEPARTMENT OF MINES
 OIL AND GAS DIVISION
 CHARLESTON

WELL LOCATION MAP
 P.L.S. NO. 600-148

Name	Color	Character	Oil, Gas or Water	Top	Bottom	Thickness	Total Depth	Remarks
Active Coal				775	207	2'		
Pittsburgh Coal				770	770	6'		
Little Dunkard Sand				1130	1145	15'		
Bl - Dunkard Sand				1206	1202	16'		
Gas Sand				1510	1560	50'		
First Salt Sand				1440	1570	10'		
Second Salt Sand				1610	1800	50'		
Marion Sand				022	2042	20'		
Little Line				2075	2065	20'		
Pennell Cove				2005	2118	25'		
Big Line				116	2170	52'		
Big Injun Sand				2170	2250	80'		
Squaw Sand		(11-216-218)		2212	2270	18'		
Gants Sand				2340	2450	25'		
Fifty Foot Sand				2600	2615	15'		
Thirty Foot Sand				2640	2715	22'		
Corda. Stray Sand				2815	2826	15'		
Gordon Sand				2828	2828	3'		
		Ort. finally drilled to - filled and plugged to prevent total depth					2830	

Well was set down at **2106-2211 & 2170-2188** feet
 with **1 1/2** inch casing
 and **1 1/2** inch casing
 and **1 1/2** inch casing

Drilled on **April 21, 1926**
 by **W.H.H. Douglas**
 Approved by **W.H.H. Douglas**
 Owner **W.H.H. Douglas**

NOTE: All bottom formations must be tested on individual plans and all logs made and all data for same sent to the State Department of Mines and Geology for their files.

PRELIMINARY DATA SHEET NO. 1

Well No. 523

File No.

448 Coalfield St.

Hope Construction & Refining Company of

W. Va. in Louisa

Clarksburg, W. Va.

County, West Virginia

containing 216 acres, Location

Doddridge

County, West Virginia

New Milton

District, in

A. L. Felster

The surface of the above tract is owned in fee by

New Milton, W. Va.

address, and the mineral rights are owned by

UNKNOWN

The oil and gas privileges are held under lease by the above named company, and this well is drilled under permit issued by the West Virginia Department of Mines, Oil and Gas Division

No. 100

1006

Right

Elevation of surface at top of well

The number of feet of the different sand coatings used in the well

Wood conductor

1310 feet 8-1/4" dia. sec. 2150 feet 6-5/8" dia. sec.

2230 feet 8" dia. sec. 2150 feet 6-5/8" dia. sec.

feet dia. sec. feet dia. sec.

feet dia. sec. feet dia. sec.

feet dia. sec. feet dia. sec.

feet dia. sec. feet dia. sec.

feet dia. sec. feet dia. sec.

feet dia. sec. feet dia. sec.

feet dia. sec. feet dia. sec.

feet dia. sec. feet dia. sec.

feet dia. sec. feet dia. sec.

feet dia. sec. feet dia. sec.

feet dia. sec. feet dia. sec.

feet dia. sec. feet dia. sec.

feet dia. sec. feet dia. sec.

feet dia. sec. feet dia. sec.

April 21, 1936

Date

Approved Hope Construction & Refining Company

By Ernest P. Casey, Asst. General Supt.

WEST VIRGINIA DEPARTMENT OF MINES
OIL AND GAS DIVISION

COAL FIELD NO. 1

COAL OPERATOR OR OWNER

Coal Field No. 1

Coal Operator or Owner

Coal Operator or Owner

Coal Operator or Owner

Coal Operator or Owner

Coal Operator or Owner

Coal Operator or Owner

Coal Operator or Owner

Coal Operator or Owner

Coal Operator or Owner

Coal Operator or Owner

Coal Operator or Owner

Coal Operator or Owner

Coal Operator or Owner

Coal Operator or Owner

Coal Operator or Owner

Coal Operator or Owner

Coal Operator or Owner

Coal Operator or Owner

Coal Operator or Owner

Coal Operator or Owner

Coal Operator or Owner

Coal Operator or Owner

Coal Operator or Owner

Coal Operator or Owner

Coal Operator or Owner

Coal Operator or Owner

Coal Operator or Owner

Coal Operator or Owner

Coal Operator or Owner

Coal Operator or Owner

Coal Operator or Owner

Coal Operator or Owner

Coal Operator or Owner

Coal Operator or Owner

Coal Operator or Owner

Coal Operator or Owner

Coal Operator or Owner

Coal Operator or Owner

Coal Operator or Owner

Coal Operator or Owner

Coal Operator or Owner

Coal Operator or Owner

Coal Operator or Owner

July 27, 1936

Coal Field No. 1

Coal Operator or Owner

Coal Operator or Owner

Coal Operator or Owner

Coal Operator or Owner

Coal Operator or Owner

Coal Operator or Owner

Coal Operator or Owner

Coal Operator or Owner

Coal Operator or Owner

Coal Operator or Owner

Coal Operator or Owner

Coal Operator or Owner

Coal Operator or Owner

Coal Operator or Owner

Coal Operator or Owner

Coal Operator or Owner

Coal Operator or Owner

Coal Operator or Owner

Coal Operator or Owner

Coal Operator or Owner

Coal Operator or Owner

Coal Operator or Owner

Coal Operator or Owner

Coal Operator or Owner

Coal Operator or Owner

Coal Operator or Owner

Coal Operator or Owner

Coal Operator or Owner

Coal Operator or Owner

Coal Operator or Owner

Coal Operator or Owner

Coal Operator or Owner

Coal Operator or Owner

Coal Operator or Owner

Coal Operator or Owner

Coal Operator or Owner

Coal Operator or Owner

Coal Operator or Owner

Coal Operator or Owner

Coal Operator or Owner

Coal Operator or Owner

AFFIDAVIT

STATE OF WEST VIRGINIA,

COURT OF MARTINSON

Ernest P. Casey

John K. Casey

being first duly sworn according to law depose and say that they are experienced in the work of plugging and filling oil and gas wells and were employed by Hope Construction & Refining Co., and participated in the work of plugging and filling the above well, that said work was commenced on the 21st day of May 1936, and that the well was plugged and filled in the following manner:

Manner in which well was plugged:
Removed 2" tubing, filled with clay and sand to 2150, 20' above Big Injun. Installed bridge and drove 500' of lead wool as a plug. Placed cement plug, consisting of 3 sacks of cement. Could not pull 6-5/8" casing. Ripped out 389 feet. Pulled 1749 ft. Filled hole up to 1320 ft. Set cement plug 1320. Could not pull 6" casing. Ripped out 288 feet. Pulled 1022 ft. Installed permanent bridge at 1150 and set cement plug, filled with clay up to 800 feet, being 30 feet under the Pittsburgh coal.
Manner in which well was plugged:
Filled with cement solid to 742, being 20 feet above Pittsburgh coal. Then filled with clay up to 257 feet, being 30 feet below native coal. Filled with cement to 205 feet, being 20 feet above the native coal. Filled with clay to surface, and erected monument at surface.

and that the work of plugging and filling said well was completed on the 30th day of June 1936.

Ernest P. Casey

John K. Casey