

Latitude 39° 15'

Longitude 80° 50'

Scale 1" = 400'

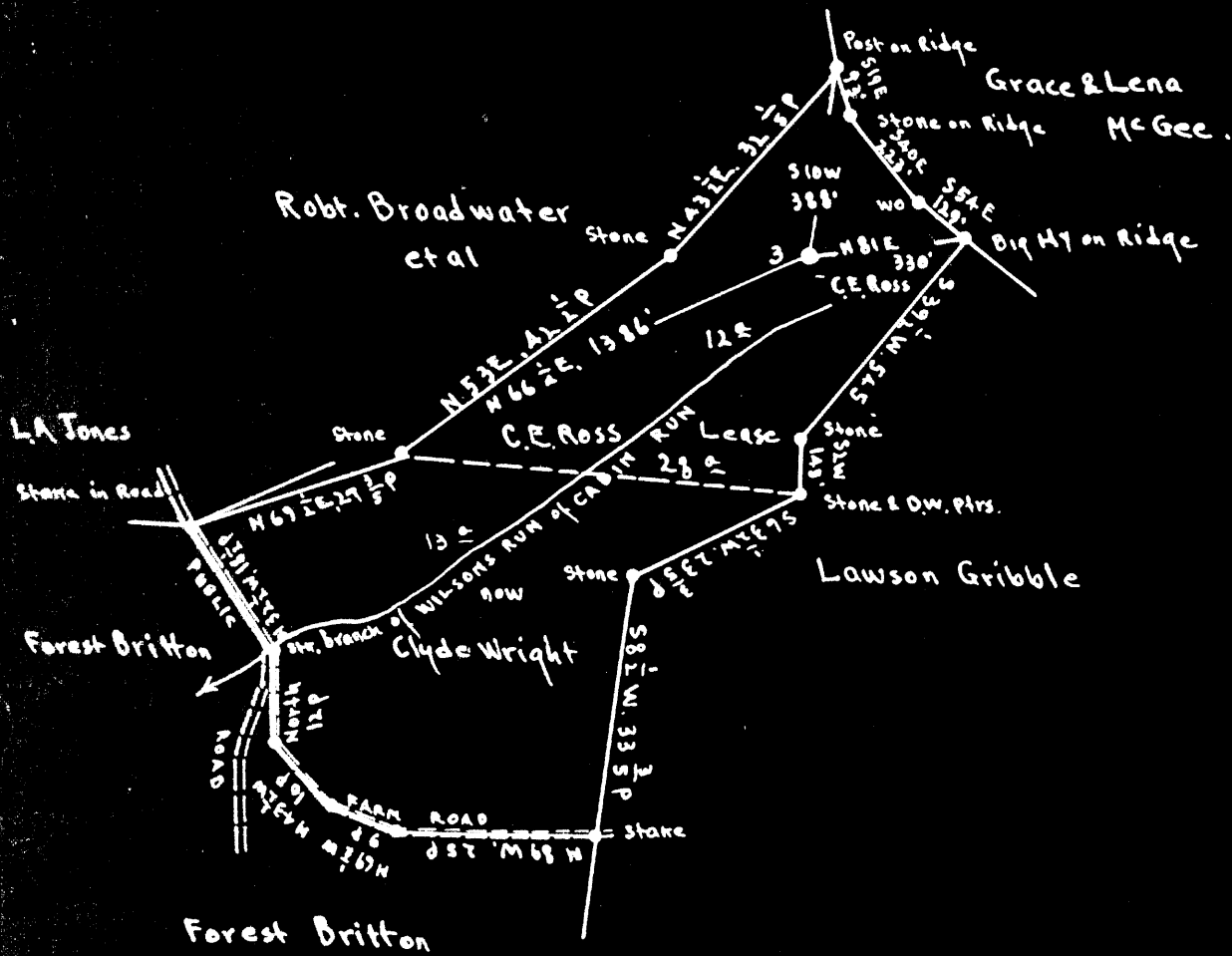

No Commercial Coal, if any.
 Surface, Clyde Wright.
 * 4904, 4th Avenue, Parkersburg W. Va.
 (South Side)

New Location
 Drill Deeper
 Abandonment

S 1.40
 W 2.07

S 15 W 14

Company Road Supply Co.
 Address Salem, W Va
 Farm C.E. Ross
 Tract Acres 28[±] Lease No. _____
 Well (Farm) No. 3 Serial No. _____
 Elevation (Spirit Level) Floor - 1056.59
Ground - 1056.59
 Quadrangle Molbrook
 County Doddridge District Central
 Engineer E.C. Tabler
 Engineer's Registration No. _____
 File No. Aug 30th 1905 Drawing No. _____
 Date _____ Scale 1" = 400'

STATE OF WEST VIRGINIA
 DEPARTMENT OF MINES
 OIL AND GAS DIVISION
 CHARLESTON

WELL LOCATION MAP
 FILE NO. DOD-816-A-2

+ Denotes location of well on United States Topographic Maps, scale 1 to 62,500, latitude and longitude lines being represented by border lines as shown.

- Denotes one inch spaces on border line of original tracing.



STATE OF WEST VIRGINIA
DEPARTMENT OF MINES
OIL AND GAS DIVISION

744

WELL RECORD

Permit No. Ord-816-17

Oil or Gas Well _____ (KIND)

Company Raad Supply Company
Address 184 East Main St., Salem, W. Va.
Farm C. E. Ross Acres 28
Location (waters) _____
Well No. 3 Elev. 1056.59
District Central County Doddridge
The surface of tract is owned in fee by Clyde Wright
4904 Fourth Ave., Address Parkerburg, W. Va. 8 1/2 mi S
Mineral rights are owned by No commercial coal, South Side
if any. Address _____
Drilling commenced 2/25/22
Drilling completed 4/28/22
Date Shot 3/27/22 From 1989 To 1986
With 10/24/44 1996

Casing and Tubing	Used in Drilling	Left in Well	Packers
Size			Kind of Packer
16			
13			
10	570'	None	Size of
8 1/2	1234'	1234'	
6 3/4	1895'	401'	Depth set
5 3/16			
3			Perf. top
2	1988'	None	Perf. bottom
Liners Used			Perf. top
			Perf. bottom

Open Flow _____ /10ths Water in _____ Inch
_____ /10ths Merc. in _____ Inch
Volume _____ Cu. Ft.
Rock Pressure _____ lbs. _____ hrs.
Oil _____ bbls., 1st 24 hrs.
Fresh water _____ feet _____ feet
Salt water _____ feet _____ feet

CASING CEMENTED NO _____ SIZE _____ No. Ft. _____ Date _____
COAL WAS ENCOUNTERED AT 763 FEET 12 INCHES
_____ FEET _____ INCHES _____ FEET _____ INCHES
_____ FEET _____ INCHES _____ FEET _____ INCHES

Formation	Color	Hard or Soft	Top	Bottom	Oil, Gas or Water	Depth Found	Remarks
Pittsburgh Coal			762	763			
Cow Run, 1st.			1090	1101			
Cow Run, 2nd.			1150	1176			
1st Salt			1300	1315			
2nd Salt			1340	1355			
3rd. Salt			1542	1821			
Maxon			1979	1998			
Water			1582		Water		
Oil			1562	1565	Oil		
Oil			1989	1994	Oil		
Gas			1989		Gas		
Total Depth				1998			



NOV 18 1950

