

Latitude 39° 20' 00"

75'
+

80° 17' 30"

Longitude

Topo Location

7.5' Loc. 0.56S 15' Loc. 0.56S
1.53W (calc.) 3.74W

Company 3335

Farm Lawrence Doak

15' Quad Wgt Union SE
(sec.)

7.5' Quad West Union

District Central

WELL LOCATION PLAT

County 017 Permit 30928

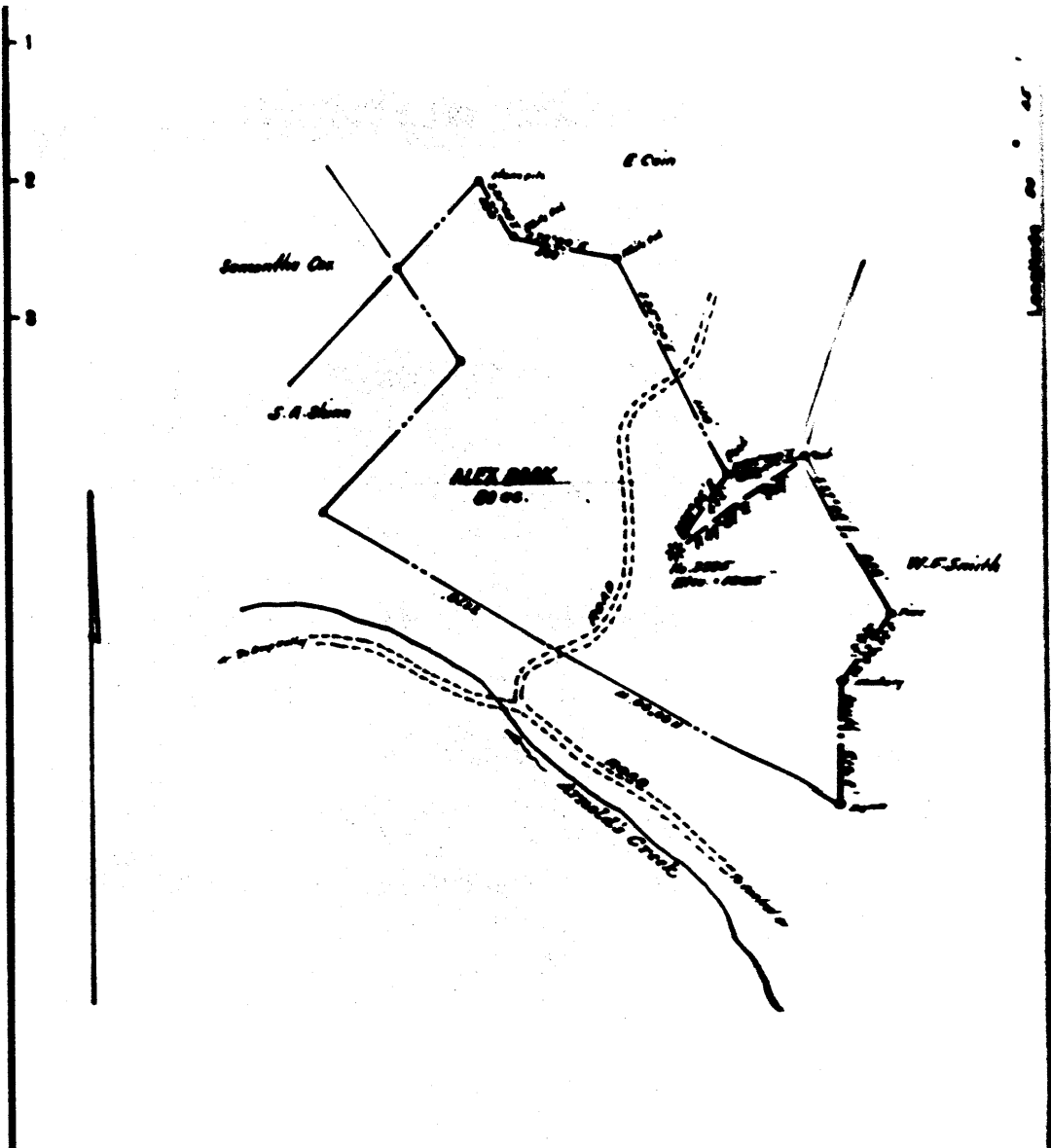

New Location
 Drift Deeper
 Abandonment

No well shown in this tract

Company	W. J. GRIDDLE		
Address	West Union, W. Va.		
Farm	Star Bank		
Tract	Acres	80	Less No.
Well (Farm) No.			Serial No.
Elevation (Spirit Level)	1000		
Quadrangle	West Union		

STATE OF WEST VIRGINIA
 DEPARTMENT OF MINES
 OIL AND GAS DIVISION
 CHARLESTON

WELL LOCATION MAP
 FILE NO. DOE-928A

⬄ Denotes location of well in United States

ALEX. DOAK NO. 3335 WELL.

928A

Central District, Doddridge County, W. Va.

By G. O. Travis, West Union, W. Va.

Abandoned under permit Dod-.....-A?

On 80 acres, on Arnold Creek.

Elevation, 1005' L.

Hope Natural Gas Co. well.

Surface owned by Ora Doak, West Union, W. Va., and minerals by
Doak Heirs, West Union, W. Va.

Date of completion, etc., not given.

10" casing, no record; 8 1/2", 1504'; 6 3/8", 1902'; 2" tubing, 2039'; all left in.

Gas well. Record to Dept. of Mines dated July 31, 1952.

Record to RCT from Mrs. Griffith Dec. 10, 1952. O.F.No.879.

	Top.	Bottom.
Pittsburgh Coal	605	-
Big Bankard Sand	690	- 1070
Salt Sand	1235	- 1485
Marten Sand	1690	- 1720
Big Injun Sand (gas, 1853')	1950	- 2034
Total depth		2050



STATE OF WEST VIRGINIA
DEPARTMENT OF MINES
OIL AND GAS DIVISION

899

Permit No. 928-A

WELL RECORD

Oil or Gas Well _____
(KIND)

Company C. O. Travis
 Address West Union, W. Va.
 Farm Alex Doak Acres 80
 Location (waters) Arnolds Creek
 Well No. 3335- H.N. Gas Co. Elev. 1005
 District Central County Dodderidge
 The surface of tract is owned in fee by Ora Doak
 Address West Union, W. Va.
 Mineral rights are owned by Doak Hrs.
 Address West Union, W. Va.
 Drilling commenced _____
 Drilling completed _____
 Date Shot _____ From _____ To _____
 With _____
 Open Flow _____ /10ths Water in _____ Inch
 _____ /10ths Merc. in _____ Inch
 Volume _____ Cu. Ft.
 Rock Pressure _____ lbs. _____ hrs.
 Oil _____ bbls., 1st 24 hrs.
 Fresh water _____ feet _____ feet
 Salt water _____ feet _____ feet

Casing and Tubing	Used in Drilling	Left in Well	Packers
Size			
16			Kind of Packer
13			
10	no record		Size of
8 3/4	1504	1504	
6	1902	1902	Depth set
5 3/16			
3			Perf. top
2	2039	2059	Perf. bottom
Liners Used			Perf. top
			Perf. bottom

CASING CEMENTED _____ SIZE _____ No. Ft. _____ Date _____
 COAL WAS ENCOUNTERED AT 605 FEET _____ INCHES
 _____ FEET _____ INCHES FEET _____ INCHES
 _____ FEET _____ INCHES FEET _____ INCHES

Formation	Color	Hard or Soft	Top	Bottom	Oil, Gas or Water	Depth Found	Remarks
Pgh. Coal			605				
Big Dunkard			390	1030			
Salt Sand			1805	1485			
Maxon Sand			1690	1720			
Big Ingun Sand			1950	2034			
Total Depth				2050	Gas	1953	



DEC 10 1952
(Over)

AFFIDAVIT OF PLUGGING AND FILLING WELL

AFFIDAVIT SHOULD BE MADE IN TRIPPLICATE. ONE COPY MAILED TO THE DEPARTMENT, ONE COPY TO BE RETAINED BY THE WELL OPERATOR AND THE THIRD COPY (LARGE PRINT) SHOULD BE MAILED TO EACH LOCAL OPERATOR AT THEIR RESPECTIVE ADDRESSES.

WELL OPERATOR OR OWNER: G. O. Trumble
 ADDRESS: West Union, W. Va.
 LOCAL OPERATOR OR OWNER: Central
 ADDRESS: September 29 1952
 WELL AND LOCATION: Central
 DISTRICT: Doddridge
 COUNTY: West Union, W. Va.
 WELL NO.: 3336 H. K. Gas Co.
 FARM: ALICE DEAK

STATE INSPECTOR SUPERVISING PLUGGING: HARRY V. MASS

AFFIDAVIT

STATE OF WEST VIRGINIA, County of Doddridge

do hereby depose and say that I, G. O. Trumble and C. R. TRIMBLE being first duly sworn according to law depose and say that they are experienced in the work of plugging and filling oil and gas wells and were employed by G. O. Trumble well operator, and participated in the work of plugging and filling the above well, that said work was commenced on the 12 day of August, 1952, and that the well was plugged and filled in the following manner:

PLUGGING MATERIAL	PLUGS USED CASES & BAGS	GALLONS OIL USED
Pulled 2" tubing	1933	
Permanent Bridge	2050	2050
2 bags cement 5' stone on bridge		
Red Clay to 1913		
Cement 5' stone 1912-1903		
6-5/8" Cas, Cut off & Pulled at 1200	1881	21'
Red Clay to 1200-1190		
Cement 5' stone 619'		
Red Clay to 619-569		
Cement		
Red Clay to surface		
8-3/4" casing could not be found		
DESCRIPTION OF MONUMENT Cement Slab 36" by 36" square		

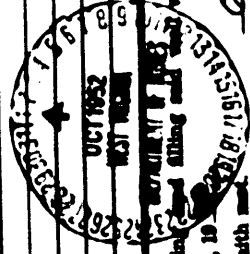

And that the work of plugging and filling said well was completed on the 24 day of September, 1952
 And further deposes with me: G. O. Trumble
C. R. Trumble
 Witness my hand and mine-hand before me this 30th day of Sept., 1952

STATE OF WEST VIRGINIA
 DEPARTMENT OF MINES
 OIL AND GAS DIVISION

INSPECTOR'S PLUGGING REPORT

Permit No. _____ Well No. _____
 COMPANY _____ ADDRESS _____
 FARM _____ DISTRICT _____ COUNTY _____

Filling Material Used _____

Libert	Location	Amount	Packer	Location	BRIDGES	CONSTRUCTION LOCATION	RECOVERED	SIZE	LOOP
CEMENT-THICKNESS	WOOD SIZE	LEAD							
PLUGS USED AND DEPTH PLACED									
CASING AND TUBING									

Drillers' Names _____

Remarks: _____

I hereby certify I visited the above well on this date _____

Harry V. Mass
 STATE INSPECTOR