

Latitude 39007'30"

+ 75'

80°47'30"

Longitude

Topo Location

7.5' Loc. $\frac{0.96S}{0.95W}$ 15' Loc. $\frac{3.84S}{3.18W}$

Company _____ # 4938

Farm D. B. Leggett

15' Quad Halbrook EC
(sec.)

7.5' Quad Auburn

District Southwest

WELL LOCATION PLAT

County 017 Permit 30 929

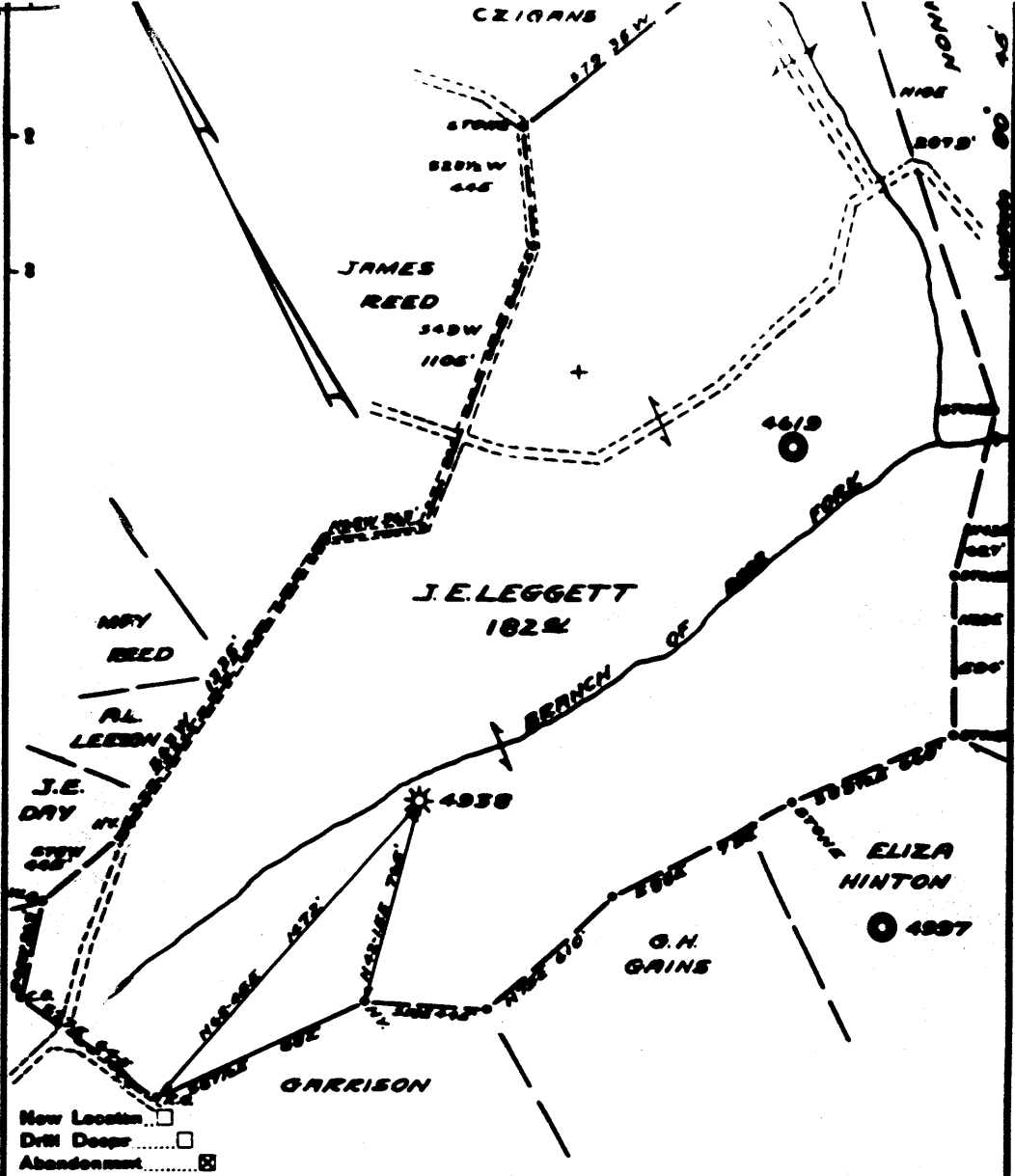

Company EQUITABLE GAS CO. WVA. DIV.
 Address CLARKSBURG, WVA.
 Farm J.E. LEGGETT
 Tract _____ Acres 182 Lease No. 7806
 Well (Farm No. TWO Serial No. 4938)
 Elevation (Spirit Level) 1012'
 Quadrangle HOLBROOK S.E. 2L
 County DODD RIDGE District SOUTHWEST
 Engineer James P. Hoffman

STATE OF WEST VIRGINIA
 DEPARTMENT OF MINES
 OIL AND GAS DIVISION
 CHARLESTON

WELL LOCATION MAP
 FILE NO. DOD-929-A

★ Denotes location of well on United States Topographic Maps, scale 1 to 62,500, latitude and longitude lines being represented by border lines as shown.

STATE OF WEST VIRGINIA
DEPARTMENT OF MINES
OIL AND GAS DIVISION

114

WELL RECORD

No. 999-A
REUTABLE GAS COMPANY-WEST VA DIV.

Oil or Gas Well **"GAS"**
(KIND)

Company Clarksburg, West Va.,
Address J. E. Leggett
Farm Holbrook S/E. 2-1 Acres 1.83
Location (waters) 4938
Well No. Southwest Elev. 1012'
District Southwest County Doddridge
The surface of tract is owned in fee by _____
Address _____
Mineral rights are owned by Reem Spurgeon-Atty-In-Fact
Address Burnt House, W.Va.
Drilling commenced August 13, 1926
Drilling completed September 16, 1926
Date shot _____ Depth of shot _____
Open Flow /10ths Water in _____ Inch
/10ths Merc. in _____ Inch
Volume _____ Cu. Ft.
Rock Pressure _____ lbs. _____ hrs.
Oil _____ bbls., 1st 24 hrs.
Fresh water _____ feet _____ feet
Salt water _____ feet _____ feet

Casing and Tubing	Used in Drilling	Left in Well	Packers
Size			
16			Kind of Packer
13			
10	245'	245'	Size of
8 3/4	946'	946'	
6 5/8	1839'	1839'	Depth set
5 3/16			
3			Perf. top
2			Perf. bottom
Liners Used			Perf. top
			Perf. bottom

CASING CEMENTED _____ SIZE _____ No. Ft. _____ Date _____
COAL WAS ENCOUNTERED AT _____ FEET _____ INCHES
_____ FEET _____ INCHES _____ FEET _____ INCHES
_____ FEET _____ INCHES _____ FEET _____ INCHES

Formation	Color	Hard or Soft	Top	Bottom	Oil, Gas or Water	Depth Found	Remarks
Clay		Soft	0	15			
Slate		"	15	40			
Lime&Red Rock			40	150			
Slate	Light	Soft	150	210			
Lime & Slate		Broken	210	350			
Red Rock		Soft	350	410			
Slate	Dark	"	410	440			
Red Rock & Lime			440	560			
Slate	Light	Soft	560	600			
Lime & Red Rock			600	680			
Slate	White	Soft	680	740			
Lime & Red Rock			740	915			
Gritty Lime			915	930			
Slate			930	934			
Big Dunkard	White	Hard	934	990	Water	980'	
Slate	"	Soft	990	1212			
Gas Sand	"	Hard	1212	1250			
Slate&Shells			1250	1285			
1st.Salt Sand	White	Hard	1285	1330			
Slate&Shells			1330	1460			
2nd.Salt Sand	White	Hard	1460	1480			
Slate&Shells			1480	1620			
Gritty Lime		Hard	1620	1640			
Slate&Shells			1640	1714			
Maxon Sand	White	Hard	1714	1770			
Slate	"	Soft	1770	1778			
Lime	Dark	Hard	1778	1790			
Slate			1790	1794			
Little Lime	White	Hard	1794	1814			
Slate			1814	1825			
Pencil Cave			1825	1829			
Big Lime			1829	1900			
Big Injun			1900	1980	Gas	1908-1920'	
Slate&Shells			1980	2008			
Total Depth				2008			

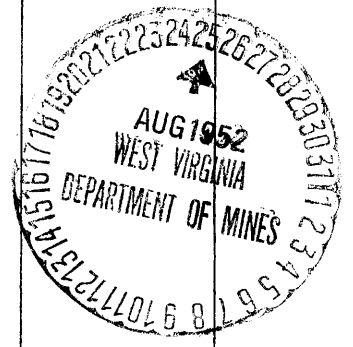

AFFIDAVIT OF PLUGGING AND FILLING WELL

AFFIDAVIT SHOULD BE MADE IN TRIPPLICATE. ONE COPY MAILED TO THE DEPARTMENT, ONE COPY TO BE RETURNED BY THE WELL OPERATOR AND THE THIRD COPY (AND SEVERAL COPIES IF REQUIRED) SHOULD BE MAILED TO EACH DR. OPERATOR AT THEIR RESPECTIVE ADDRESSES.

"No Coal"	EQUITABLE GAS COMPANY WEST VA. DIV.
COAL OPERATOR OR OWNER	NAME OF WELL OPERATOR
ADDRESS	Clarksburg, West Va.
COAL OPERATOR OR OWNER	September 24, 1952.
ADDRESS	WELL AND LOCATION
Ross Spurgeon, Atty-in-Fact for	Southwest District
Hairs, J.S. Leggett deceased.	Doddridge County
Burke House, East Va.	Well No. 4938
	J. E. Leggett. Farm
STATE INSPECTOR SUPERVISING PLUGGING	Not Inspected

AFFIDAVIT

STATE OF WEST VIRGINIA.

County of Doddridge

vs:

Benj. H. Jones and Louis E. Harce being first duly sworn according to law depose and say that they are experienced in the work of plugging and filling oil and gas wells and were employed by Equitable Gas Co., West Va. Div., well operator, and participated in the work of plugging and filling the above well, that said work was commenced on the 26 day of August, 1952, and that the well was plugged and filled in the following manner:

GAS OR OIL BEING PRODUCED	FILLING MATERIAL		PLUGGED	CASINGS	
	QUANTITY	TO		ONE END	ONE LEFT IN
Slate & Shale - Big	Total Depth	8000 Feet			
Injun & Big Line	Clay	2008	1875	(Cut 6-5/8" Casing 1800' & 1720')	
Big Line	Stone	1875	1865		
Big Line	6-5/8" Lead Plug	1865	1864	6-5/8" 1720'	119'
Big Line	Cement	1864	1854		
Slate	Hole Bridged	1200		8-1/4" 965'	
Slate	Cement	1200	(1-Bag)		
Slate & Big Bankard	Clay	1200	965	10" 239'	26'
Big Bankard	Cement	965	955	(10" Casing perforated at 219')	
Line & Slate	Hole Bridged	325			
Line & Slate	Cement	325	(1-Bag)		
Line & Slate	Clay	275	275		
Line & Slate	Cement	275	265	6 feet 6-5/8" Casing and 1 foot of 2" Pipe in marker, 2" Perforated	
Line & Slate-Red Rock &	Clay	265	5	above marker.	
Clay	Cement	5	Surface		
COAL BEAMS	DESCRIPTION OF INSTRUMENT				
(NAME) "No Coal"	Cast Iron Pipe Foot				
(NAME)	Cast Iron Plate Lettered				
(NAME)	Equitable Gas Co., #4938				
(NAME)					

and that the well of WEST VIRGINIA and filling said well was completed on the 22 day of

September

And further deponents saith not

Benj H Jones
Louis E Harce
 294