

Latitude 39° 30'

Longitude 80° 30'

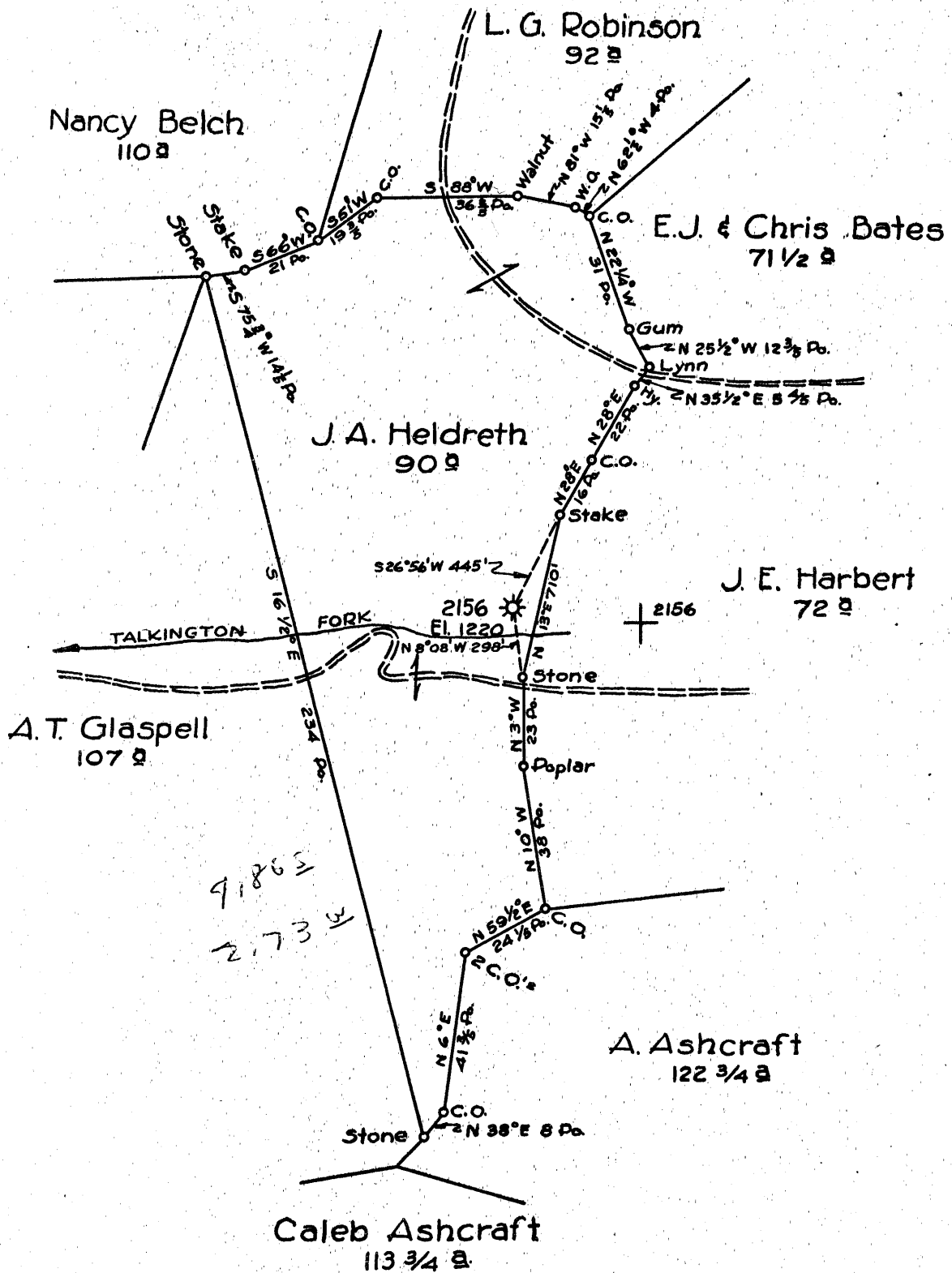

- New Location...
- Drill Deeper.....
- Abandonment.....

Map Sht. 45 ; Sq. S 2, E 4 ; F.B. 545 - P 39

Company HOPE NATURAL GAS COMPANY  
 Address CLARKSBURG, W. VA.  
 Farm HARBERT - HELDRETH  
 Tract \_\_\_\_\_ Acres 72-90 Lease No. 19965-19967  
 Well (Farm) No. \_\_\_\_\_ Serial No. 2156  
 Elevation (Spirit Level) 1220  
 Quadrangle CENTERPOINT  
 County DODDRIDGE District McCLELLAN  
 Engineer Guy H. Bradley  
 Engineer's Registration No. 2425  
 File No. \_\_\_\_\_ Drawing No. \_\_\_\_\_  
 Date APRIL, 13, 1954 Scale 1" = 40 Poles

STATE OF WEST VIRGINIA  
 DEPARTMENT OF MINES  
 OIL AND GAS DIVISION  
 CHARLESTON

WELL LOCATION MAP  
 FILE NO. DOD-1031-A

+ Denotes location of well on United States Topographic Maps, scale 1 to 62,500, latitude and longitude lines being represented by border lines as shown.

- Denotes one inch spaces on border line of original tracing.



STATE OF WEST VIRGINIA  
DEPARTMENT OF MINES  
OIL AND GAS DIVISION

WELL RECORD

945

Center point  
1031A

Permit No. 1031A Oil or Gas Well Gas (KIND)

Company Hope Natural Gas Company  
Address 445 West Main St., Clarksburg, W. Va.  
Farm Harbert Hildreth Acres 90  
Location (waters) \_\_\_\_\_  
Well No. 2156 Elev. 1220'  
District McClellan County Doddridge  
The surface of tract is owned in fee by \_\_\_\_\_  
Address \_\_\_\_\_  
Mineral rights are owned by \_\_\_\_\_  
Address \_\_\_\_\_  
Drilling commenced 3-20-11  
Drilling completed 5-15-11  
Date Shot Not shot From \_\_\_\_\_ To \_\_\_\_\_  
With \_\_\_\_\_  
Open Flow /10ths Water in \_\_\_\_\_ Inch  
/10ths Merc. in \_\_\_\_\_ Inch  
Volume \_\_\_\_\_ Cu. Ft.  
Rock Pressure \_\_\_\_\_ lbs. \_\_\_\_\_ hrs.  
Oil \_\_\_\_\_ bbls., 1st 24 hrs.  
Fresh water None recorded feet \_\_\_\_\_ feet  
Salt water None recorded feet \_\_\_\_\_ feet

Casing and Tubing	Used in Drilling	Left in Well	Packers
Size			Kind of Packer
16			
13			
10			Size of
8 1/4			
6 5/8	2169'	2169'	Depth set
5 3/16	2951'	2951'	
3			Perf. top
2			Perf. bottom
Liners Used			Perf. top
			Perf. bottom

CASING CEMENTED \_\_\_\_\_ SIZE \_\_\_\_\_ No. Ft. \_\_\_\_\_ Date \_\_\_\_\_  
**No cementing**  
COAL WAS ENCOUNTERED AT 896 FEET 108 INCHES  
\_\_\_\_\_ FEET \_\_\_\_\_ INCHES FEET \_\_\_\_\_ INCHES  
\_\_\_\_\_ FEET \_\_\_\_\_ INCHES FEET \_\_\_\_\_ INCHES

Formation	Color	Hard or Soft	Top	Bottom	Oil, Gas or Water	Depth Found	Remarks
Coal			896	905			
Little Dunkard			1260	1285			
Big Dunkard			1395	1455			
Gas Sand			1600	1660			
First Salt			1700	1740			
2nd Salt			1825	1860			
MAXON			1960	2010			
Little Lime			2069	2108			
Pencil Cave			2108	2115			
Big Lime			2125	2195			
Big Injun			2195	2300	Gas	2209	
Berea			2460	2500			
Gantz			2635	2672			
Fifty Foot			2745	2760			
Thirty Foot			2859	2886			
Gordon Stray			2939	2944			
Gordon			2950	2977	Gas	2951-55-60	
Fourth Sand			2980	2985			
Total Depth				3000'			

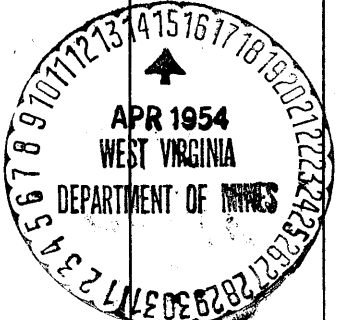

(Over)

NOV 12 1954

