

LATITUDE

39° 20'

80° 50'

o → 7.5' loc.  
KIA  
7/1/91

LONGITUDE

LONGITUDE

7.5 OGIS topo location

7.5' loc 1.155  
0.38W

15' loc 1.155  
(calc.) 0.38W

Company Quaker State

Farm McCendry Dodson 3

SECTION 11

Quad West Union + 15' SC

County \_\_\_\_\_

District Central

WELL LOCATION MAP

File No. Dodd 70065



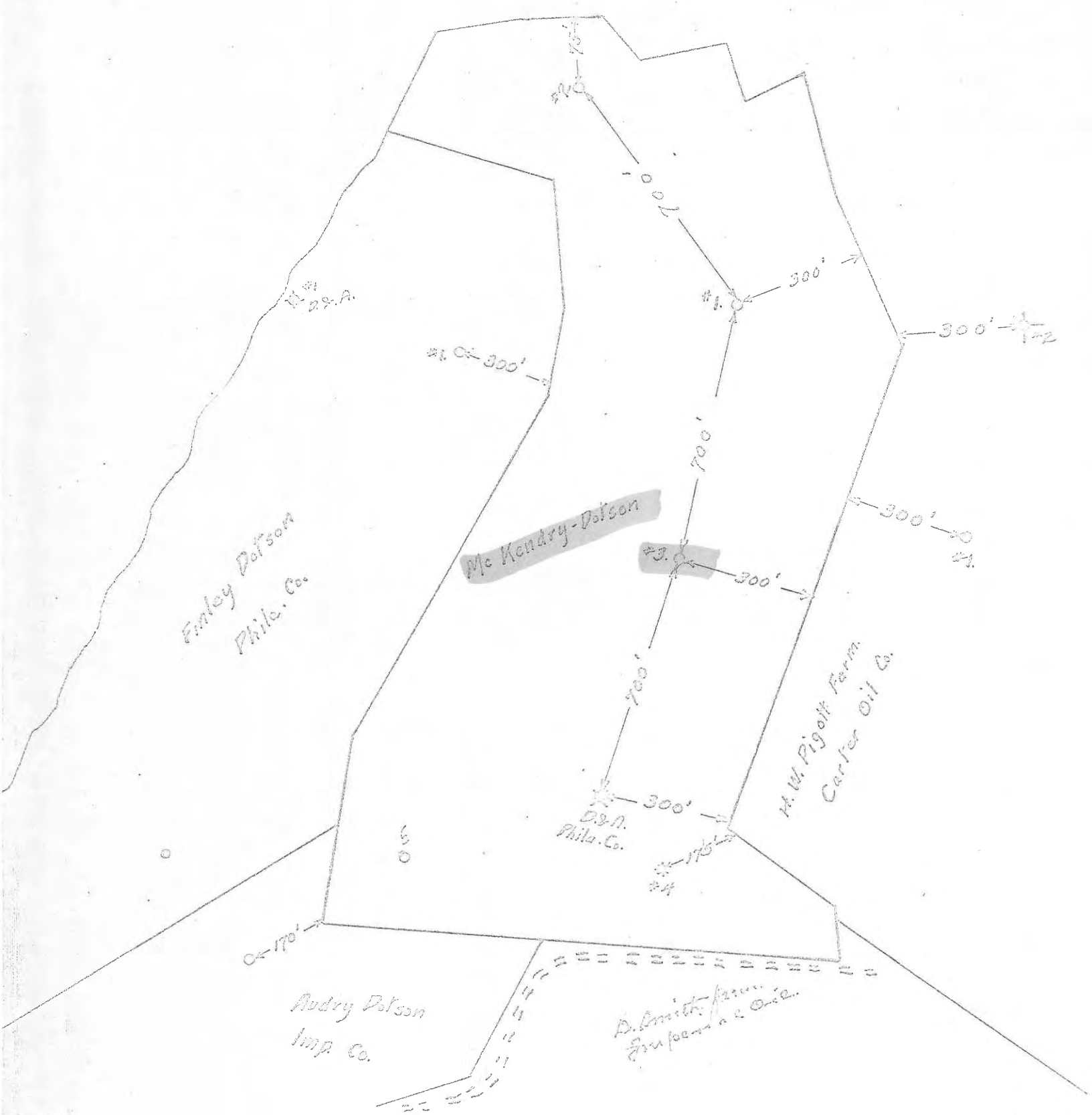

Scale 1" = 300'



# Birdwell

## Gamma-Ray Density

**COMPANY** QUAKER STATE OIL REFINING CORP

**WELL** McKENDRY DOTSON # 3

**FIELD** CENTRAL DISTRICT

**COUNTY** DODDRIDGE **STATE** WEST VA.

**LOCATION:**

**OTHER SERVICES**  
CALIPER

**SEC.** \_\_\_\_\_ **TWP.** \_\_\_\_\_ **RGE.** \_\_\_\_\_

**PERMANENT DATUM** GROUND LEVEL, **ELEV.** NA

**LOG MEASURED FROM** CSG, 1 ft. above perm. datum

**DRILLING MEASURED FROM** CSG

**ELEVATIONS:**  
**KB.** NA  
**DF.** NA  
**GL.** NA

<b>DATE</b>	9-13-66	9-13-66	
<b>RUN NO.</b>	ONE	ONE	
<b>TYPE LOG</b>	GAMMA RAY	DENSITY	
<b>DEPTH - DRILLER</b>	1961'	1961'	
<b>DEPTH - LOGGER</b>	1968'	1968'	
<b>BOTTOM LOGGED INTERVAL</b>	1950'	1968'	<b>COMPLEMENTS OF</b>
<b>TOP LOGGED INTERVAL</b>	1750'	1750'	
<b>TYPE FLUID IN HOLE</b>	NA	NA	<b>QUAKER STATE</b>
<b>SALINITY PPM CL.</b>	NA	NA	
<b>DENSITY LB./GAL.</b>	NA	NA	
<b>LEVEL</b>	NA	NA	
<b>MAX. REC. TEMP. - DEG. F</b>	NA	NA	
<b>OPERATING RIG TIME</b>	ONE HOUR TOTAL		
<b>RECORDED BY</b>	RUGH	RUGH	
<b>WITNESSED BY</b>	MR. W. RAY	MR. W. RAY	
<b>LOCATION</b>	#7, CHARLESTON, WEST VIRGINIA		

RUN NO.	BORE HOLE RECORD			CASING RECORD			
	BIT	FROM	TO	SIZE	WGT.	FROM	TO
1				10"	NA	0	475'
				8 1/2"	NA	0	1120'
				6-5/8"	NA	0	1806'

70065

~~70066~~

ID: COUNTY: 017 (DODDRIDGE) PERMIT: 70065 SFX: W (Worked Over)

REASSIGNED ID #: ()

COMPLETION INFO: ELEVATION: COMP REC FLAG: (from E-LOG)
ELEVATION TYPE: G RIG TYPE:
(Ground Lvl) (???)

\* LOCATION TAX DST:
\* INFO: DEGREES MINUTES MILES
\* 7.5' LATITUDE: 00 00.0 0.00S
\* LONGITUDE: 00 00.0 0.00W
\* QUADRANGLE:
\* 15' LATITUDE: 00 00 0.00S
\* LONGITUDE: 00 00 0.00W
\* QUADRANGLE:
\* 5' SECT:

CLASSIFICATION: DATES: MM/DD/YYYY
INITIAL: (unclassified) SPUD: / / WELL TYPE: 0
FINAL: (unclassified) COMP: / / (Unknown)
FIELD: BATCH: / / CMPL METH:
(?Never assigned) YEAR RPTD: ()

OPEN GAS-BEFORE TREATMENT: (MCFPD) OIL-BEFORE TREATMENT: (BOPD)
FLOW: GAS-AFTER TREATMENT: (MCFPD) OIL-AFTER TREATMENT: (BOPD)

UTM: EASTING: NORTHING:
COORDINATE DIGITIZED (Y/N):

ROCK NATURAL (PSI): 0 TIME (NATURAL, IN HOURS): 0
PRESSURE: TREATED (PSI): 0 TIME (TREATED, IN HOURS): 0

\* OWNER STATUS: C (Cmplt) DATE: / /
\* INFO: SURFACE OWNER: Dotson, McKendry 3
\* OIL&GAS OWNER:
\* COMPANY NUMBER:
\* OPERATOR: 0721 (Quaker State)
\*

DEPTHS: TOTAL FTG: 1961 NEW FTG: 0 EXPL FTG: 0

DEEPEST FM: AT TOTAL DEPTH: 999 372 TESTED: 999 371
(undetermined unit) (undetermined unit)

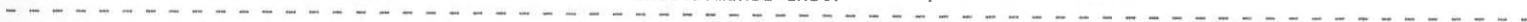

ID: COUNTY: 017 (DODDRIDGE) PERMIT: 70065 SFX: W (Worked Over)

REASSIGNED ID #: ( )

COMPLETION INFO: ELEVATION: COMP REC FLAG: (from E-LOG) RIG TYPE: (???)  
ELEVATION TYPE: G (Ground Lvl)

\* LOCATION TAX DST: \* INFO: DEGREES MINUTES MILES \* 7.5' LATITUDE: 00 00.0 0.00S \* LONGITUDE: 00 00.0 0.00W \* QUADRANGLE: \* 15' LATITUDE: 00 00 0.00S \* LONGITUDE: 00 00 0.00W \* QUADRANGLE: \* 5' SECT:

CLASSIFICATION: DATES: MM/DD/YYYY WELL TYPE: 0  
INITIAL: (unclassified) SPUD: / / (Unknown)  
FINAL: (unclassified) COMP: / /1915  
FIELD: BATCH: / / CMPL METH: ( )  
(?Never assigned) YEAR RPTD:

OPEN GAS-BEFORE TREATMENT: (MCFPD) OIL-BEFORE TREATMENT: (BOPD)  
FLOW: GAS-AFTER TREATMENT: (MCFPD) OIL-AFTER TREATMENT: (BOPD)

\* UTM: EASTING: NORTHING: \* COORDINATE DIGITIZED (Y/N):

ROCK NATURAL (PSI): 0 TIME (NATURAL, IN HOURS): 0  
PRESSURE: TREATED (PSI): 0 TIME (TREATED, IN HOURS): 0

\* OWNER STATUS: C (Cmpltd) DATE: / /1915 \* INFO: SURFACE OWNER: Dotson, McKendry 3 \* OIL&GAS OWNER: \* COMPANY NUMBER: \* OPERATOR: 1626 (Clifton O&G) \*

DEPTHS: TOTAL FTG: 1961 NEW FTG: 0 EXPL FTG: 0

DEEPEST FM: AT TOTAL DEPTH: 999 371 TESTED: 999 371  
(undetermined unit) (undetermined unit)

MECHANICAL LOG INFO:

STATUS: RANGE OF INTERVALS: 1750- 1950 DEEPEST FM LOGGED:  
LOGS AVAILABLE: GR,D,\* MICROFILM ROLL NUMBER(S): 12  
COMMENT: on #12 no permit #  
LOG TYPES: GR-gamma ray; D-density; T-temperature; I-induction; N-neutron; S-sonic; \*Other types not noted

700658

Central District, Rockbridge County, W. Va.

By.....  
 J. W. Trainer, Contractor.  
 Drilling completed Dec. 17, 1915.  
 Elevation.....

10" casing, 475' (pulled); 8" , 1120'; 6" , 1806'; 2" tubing, 1958'.  
 6" x 8" anchor packer on bottom of 6" casing and 6" nipple 3' long  
 below packer with 6" steel shoe on bottom.

Produced 120 bbls. first 24 hrs. after completion.

Shot Dec. 27, 1915, with 10 qts.; top of shell, 1950'; bottom of shell, 1956'.

Shot April 1916, with 27 qts.; top of shell, 1952'; bottom of shell, 1957'.

Shot July 26, 1916, with 50 qts.; top of shell, 1952'; bottom of shell, 1955'.

Shot May 16, 1919, with 60 qts.; top of shell, 1953'; bottom of shell, 1958'. Increased production 12 bbls. per day.

Cleaned and shot April 4, 1922, with 60 qts., same depths as other shots; 20 bbls. per day.

Shot Jan. 29, 1926, with 60 qts., same depths as other shots.

Shot Oct. 17, 1929, with 300# gelatin; increased production from 7" to 16" per week, oil.

Tubed Dec. 4, 1929.

Record in Eastern Petroleum Co. Well Record book of Clifton Oil & Gas Co.

	Top.	Bottom.
Conductor	0	16
Native coal	75	757
Pittsburgh Coal	549	551
Little Dunkard Sand	900	950
Big Dunkard Sand	1018	1035
First Salt Sand	1280	1332
Second Salt Sand	1395	1440
3rd Salt Sand	1535	1605
Maxton Sand	1675	1695
Little Lime	1760	1775
Pencil Cave	1775	1788
Big Lime	1788	1854
Big Injun Sand	1854	1959
(1st gas, 1870') (2nd gas, 1894')		
(3rd gas, 1849-1852', 1 1/2 million ft.)		
(oil, 1952-1956')		
(3rd gas probably at 1949-1952'..ROF)		
Total depth		1961

# WELL RECORD

PRODUCTION FIRST 24  
HOURS FROM

Sand  
Sand

Bbls. Approved.  
Bbls. By

Supt.

McKendry Dotson FARM, No. OF LEASE No. ACRES  
Central DISTRICT Doddridge COUNTY W. Va. STATE  
WELL No. 3 DATE OF LOCATION 19  
RIG COMMENCED 19 }  
RIG COMPLETED 19 } CONTRACTOR  
DRILLING COMMENCED 19 }  
DRILLING COMPLETED Dec. 17, 1915. 19 } J. E. Trainer. CONTRACTOR

### CASING RECORD

Size	CHARGED TO WELL		PUT IN WELL		BOTTOM OF CASING		PULLED OUT OF WELL		LEFT IN WELL		TRANSFERRED Before Completion		LEFT AT WELL NOT IN USE	
	Feet	In.	Feet	In.	Feet	In.	Feet	In.	Feet	In.	Feet	In.	Feet	In.
10"			475				475							
8-1/4"			1120						1120					
6-5/8"			1806						1806					
2"	Tubing								1958					

Formation	Top	Bottom	Remarks
Conductor		16	
Native Coal	75	75	
Pittsburgh Coal	549	551	
Little Dunkard Sand	900	950	
Big Dunkard Sand	1018	1035	
First Salt Sand	1280	1332	
Second Salt Sand	1395	1440	
Water 3 <sup>rd</sup> Salt Sand	1535	1605	
Maxon Sand	1675	1695	
Little Lime	1760	1775	
Pencil Cave	1775	1788	
Big Lime	1788	1854	
Big Injun Sand	1854	1959	
1 <sup>st</sup> Gas	1870		
2 <sup>nd</sup> Gas	1894		
3 <sup>rd</sup> Gas	1849	1852	1 1/2 Mil. Ft.
First Pay Oil	1952	1956	
Second Pay			
Water			
Squaw Sand			
Gantz Sand			
Fifty Foot Sand			
Thirty Foot Sand			
Gordon Stray Sand			
Gordon Sand			
Gas			
First Pay			
Second Pay			
Fourth Sand			
Fifth Sand			
Gas			
Oil			
Bayard Sand			
Total Depth		1961	

6-5/8" x 8-1/4" Anchor Packer on bottom of 6-5/8" Casing and 6-5/8" nipple 3 ft. long below packer with 6-5/8" Steel Shoe on bottom.

Produced 120 Bbls. first 24 hrs. after completion.

Shot Dec. 27, 1915 with 10 Qts.

Top of shell 1950. Bottom of shell 1956.

Shot April 1916, with 27 Qts.

Top of shell 1952. Bottom of shell 1957.

Shot July 26, 1916 with 50 Qts.

Top of shell 1952. Bottom of shell 1955.

Shot May 16, 1919 with 60 Qts.

Top of shell 1953. Bottom of shell 1958.

Increased production 12 Bbls. per day.

*Reamed shot Apr 4-22 - 60 qts. - 20 bbls per day same depth for*

*Shot Jan. 29 - 1926 - 60 qts. other shots*

*Shot - Oct 17 29 300 # well Labeled 1/4-29*

*Increased Prod from 7" to 16" per week then*

ABANDONED ..... 191.....			
Size	Casing Pulled	Casing Left In	

### REMARKS