

EASTERN GAS AND FUEL ASSOCIATES ET AL LEASE

10,244 ACRES ±

WELL NO. WV 508666
STATE PLANE COORDINATES (SOUTH ZONE)

N. 398.778
E. 1.913.639
LAT=(N) 38.094782
LONG=(W) 81.300095

NORTH

WELL NO. WV 508666



11,000 AC± TRACT

- NOTES ON SURVEY**
1. TIES TO WELLS AND CORNERS ARE BASED ON GRID NORTH FOR THE WV STATE PLANE COORDINATE SYSTEM SOUTH ZONE NAD '27.
 2. TIES TO REFERENCES ARE BASED ON MAGNETIC NORTH 4/30/03.
 3. LEASE BOUNDARY SHOWN HEREON TAKEN FROM A PLAT DATED JUNE 5, 1996 PREPARED BY W. J. WHITMAN FOR API# 47-019-0822 AND DEED BOOK 101 AT PAGE 38.
 4. SURFACE OWNER AND ADJOINER INFORMATION TAKEN FROM THE ASSESSOR AND COUNTY CLERK RECORDS OF FAYETTE COUNTY IN APRIL, 2003.
 5. WELL LAT./LONG. ESTABLISHED BY DGPS(SUBMETER GRADE).

REFERENCES

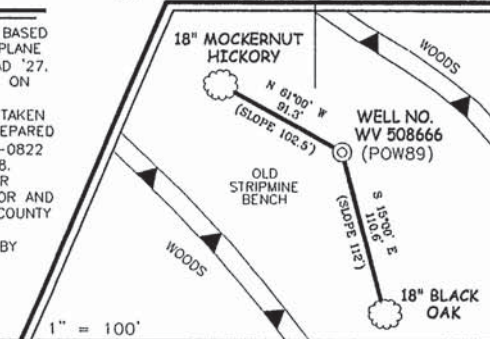

I THE UNDERSIGNED, HEREBY CERTIFY THAT THIS PLAT IS CORRECT TO THE BEST OF MY KNOWLEDGE AND BELIEF AND SHOWS ALL THE INFORMATION REQUIRED BY LAW AND THE REGULATIONS ISSUED AND PRESCRIBED BY THE DIVISION OF ENVIRONMENTAL PROTECTION.

P.S. 677 *Gregory A. Smith*



(+) DENOTES LOCATION OF WELL ON UNITED STATES TOPOGRAPHIC MAPS.
DATE JUNE 10, 20 03
OPERATORS WELL NO. WV 508666
API WELL NO. 47-19-00979
STATE CANCELLED COUNTY PERMIT

MINIMUM DEGREE OF ACCURACY 1/2500 FILE NO. 3788P508666 (145-24)
PROVEN SOURCE OF ELEVATION DGPS (SUBMETER GRADE) SCALE 1" = 2000'

STATE OF WEST VIRGINIA
DIVISION OF ENVIRONMENTAL PROTECTION
OFFICE OF OIL AND GAS

WELL TYPE: OIL GAS LIQUID INJECTION WASTE DISPOSAL IF "GAS" PRODUCTION STORAGE DEEP SHALLOW

LOCATION: ELEVATION 1.957' WATERSHED RIGHT FORK OF BIG RIGHTHAND FORK
DISTRICT VALLEY COUNTY FAYETTE QUADRANGLE POWELLTON 7.5'

SURFACE OWNER EASTERN ASSOCIATED COAL CORPORATION ACREAGE 10,374.85±
ROYALTY OWNER PARDEE RESOURCES GROUP, INC. LEASE ACREAGE 10,244±
PROPOSED WORK: LEASE NO. 013129
DRILL CONVERT DRILL DEEPER REDRILL FRACTURE OR STIMULATE PLUG OFF OLD
FORMATION PERFORATE NEW FORMATION PLUG AND ABANDON CLEAN OUT AND REPLUG OTHER
PHYSICAL CHANGE IN WELL (SPECIFY) _____ TARGET FORMATION DEVONIAN SHALE
ESTIMATED DEPTH 6,810'

WELL OPERATOR EQUITABLE PRODUCTION COMPANY DESIGNATED AGENT STEPHEN G. PERDUE
ADDRESS 1710 PENNSYLVANIA AVENUE ADDRESS 1710 PENNSYLVANIA AVENUE
CHARLESTON, WV 25302 CHARLESTON, WV 25302

COUNTY NAME
PERMIT