



west virginia department of environmental protection

Office of Oil and Gas
601 57th Street SE
Charleston, WV 25304
(304) 926-0450
(304) 926-0452 fax

Earl Ray Tomblin, Governor
Randy C. Huffman, Cabinet Secretary
www.dep.wv.gov

July 09, 2014

WELL WORK PLUGGING PERMIT

Plugging

This permit, API Well Number: 47-2100770, issued to EQT PRODUCTION COMPANY, is evidence of permission granted to perform the specified well work at the location described on the attached pages and located on the attached plat, subject to the provisions of Chapter 22 of the West Virginia Code of 1931, as amended, and all rules and regulations promulgated thereunder, and to all conditions and provisions outlined in the pages attached hereto. Notification shall be given by the operator to the Oil and Gas Inspector at least 24 hours prior to the construction of roads, locations, and/or pits for any permitted work. In addition, the well operator shall notify the same inspector 24 hours before any actual well work is commenced and prior to running and cementing casing. Spills or emergency discharges must be promptly reported by the operator to 1-800-642-3074 and to the Oil and Gas inspector.

Upon completion of the plugging well work, the above named operator will reclaim the site according to the provisions of WV Code 22-6-30. The above named operator will also file, as required in WV Code 22-6-23, an affidavit on form WR-38 by two experienced persons in the operator's employment and the Oil and Gas inspector that the work authorized under this permit was performed and a description given. Failure to abide by all statutory and regulatory provisions governing all duties and operations here under may result in suspensions or revocation of this permit and in addition may result in civil and/or criminal penalties being imposed upon the operator.

This permit will expire in two (2) years from date of issue. If there are any questions, please free to contact me at (304) 926-0499 ext. 1654.

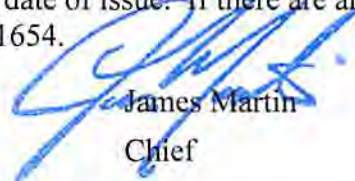

James Martin
Chief

Operator's Well No: 656441 (ARBUCKLE #1643)
Farm Name: ARBUCKLE, J. E.
API Well Number: 47-2100770
Permit Type: Plugging
Date Issued: 07/09/2014

PERMIT CONDITIONS

West Virginia Code § 22-6-11 allows the Office of Oil and Gas to place specific conditions upon this permit. Permit conditions have the same effect as law. Failure to adhere to the specified permit conditions may result in enforcement action.

CONDITIONS

1. All pits must be lined with a minimum of 20 mil thickness synthetic liner.
2. In the event of an accident or explosion causing loss of life or serious personal injury in or about the well or while working on the well, the well operator or its contractor shall give notice, stating the particulars of the accident or explosion, to the oil and gas inspector and the Chief within twenty-four (24) hours.
3. Well work activities shall not constitute a hazard to the safety of persons.
4. This well is under a consent order and must be plugged within two years of the date of issuance of this permit.

Form WW-4 (B)
Permit Copy
(Rev 2/01)

Date: 5-21-14
Operator's Well
Well No. 656441 Arbuckle #1643
API Well No.: 47 021 - 00770

STATE OF WEST VIRGINIA
DIVISION OF ENVIRONMENTAL PROTECTION
OFFICE OF OIL AND GAS

CK 17819
100⁰⁰

APPLICATION FOR A PERMIT TO PLUG AND ABANDON

4) Well Type: Oil Gas X Liquid Injection Waste Disposal:
If Gas, Production X Or Underground storage Deep Shallow X

5) Elevation: 819 Watershed: Spruce Creek of Little Kanawha River
Location: DeKalb County: Gilmer Quadrangle: Tanner
District:

6) Well Operator EQT Production Company 7) Designated Agent: Rex C. Ray
Address: 120 Professional Place Address: 120 Professional Place
Bridgeport, WV 26330 Bridgeport, WV 26330

8) Oil & Gas Bryan Harris 9) Plugging Contractor:
Name: P.O. Box 157 Name: HydroCarbon Well Service
Address: Volga WV 26238 Address: PO BOX 995
 Buckhannon, WV 26201

10) Work Order: The work order for the manner of plugging this well is as follows:
See Attachment for details and procedures.

RECEIVED
Office of Oil and Gas

JUN 13 2014

WV Department of
Environmental Protection

OFFICE USE ONLY

Notification must be given to the district oil and gas inspector 24 hours before permitted work can commence.

Work order approved by inspector Bryan O. Harris Date 6-12-14

PLUGGING PROGNOSIS – Weston

Arbuckle, J.E. # 1643 (656441)

Gilmer, Co., West Virginia
 API # 47-021-00770
 DeKalb Quad

BY: Craig Duckworth
 DATE: 2/12/14

CURRENT STATUS:

10" csg @ 149'
 8 1/4" csg @ 859' (Packer @ 859')
 6 5/8" csg @ 1586' (Packer @ 1520')

TD @ 1744'

Fresh Water @ 100' **Salt Water @ None reported**
1st Salt Sand @ 930' **Coal @ None reported**
Gas Shows @ 785' Sand; 935' 1st Salt Sand; 1222' 3rd Salt Sand; 1450' Maxon Sand; 1564'-1570' Big
 Lime; 1664'-1670' Big Injun
Oil Shows @ None reported
Stimulation: Perfs. @ 1560'-1575'
Elevation : 882'

- CEL HOLES TO 1670'
1. Notify State Inspector, **Bryan Harris 504-553-6087**, 24 hrs. Prior to commencing operations.
 2. TIH w/ tbg @ 1670'; Set 320' C1A Cement Plug @ 1670' to 1350' (Gas Shows @ Big Lime 1564'-1570' & Big Injun 1664' 1670' & 6 5/8" csg @ 1586' & Maxon Sand @ 1450')
 3. TOOH w/ tbg, Free Point 6 5/8", cut 6 5/8" @ free point, TOOH w/ 6 5/8" csg
 4. Set a 100' C1A Cement Plug 50' In/Out of cut. Perf all FW, Coal, Oil and Gas shows below 6 5/8" cut. Do not omit any plugs
 5. TOOH w/ tbg @ 1350'; gel hole @ 1350' to 1222'
 6. TOOH w/ tbg @ 1222'; Set 100' C1A Cement Plug @ 1222' to 1122' (3rd Salt Sand @ 1222')
 7. TOOH w/ tbg @ 1122'; gel hole @ 1122' to 935'
 8. TOOH w/ tbg @ 935'; Set 250' C1A Cement Plug @ 935' to 685' (Gas Shows @ 1st Salt Sand 1935' & Salt Sand @ 930' ; Elevation @ 882'; 8 1/4" @ 859' & Gas Show @ 785')
 9. TOOH w/ tbg @ 800'; gel hole @ 800' to 685'.
 10. Free point 8 1/4" . If unable to pull. Cut at free point
 11. TIH w/ tbg @ 685'; Set 100' C1A Cement Plug @ 685' to 585'
 12. Set a 100' C1A Cement Plug 50' In/Out of cut. Perf all FW, Coal, Oil and Gas shows below 8 1/4" cut. Do not omit any plugs
 13. TIH w/ tbg @ 585' gel hole @ 585' to 200'.
 14. TOOH w/ tbg @ 200'; Set 200' C1A Cement Plug @ 200' to Surface (10" csg @ 149' & Fresh Water @ 100'
 15. Top off as needed
 16. Set Monument to WV-DEP Specifications
 17. Reclaim Location & Road to WV-DEP Specifications

RECEIVED
 Office of Oil and Gas

MAY 22 2014

WV Department of
 Environmental Protection
 07/11/2014

WEST VIRGINIA DEPARTMENT OF MINES
OIL & GAS DIVISION
W E L L R E C O R D

Permit No. Gil 770
Glenville Quad.
Company
Address
Farm
Location
Well No.
District
Surface
Mineral
Commenced
Completed
Volume
Rock Pressure
Fresh Water

Gas Well
CASING & TUBING
Carnegie Natural Gas Company
1015 Frick Bldg., Pittsburgh, Pa. 10 149 149
Jno. E. Arbuckle et al Acres 35 8 1/2 059 059
Cedar Crook 6 5/8 1586 1586
L-1643 Elev. 882'
DeKalb Gilmer County
R.L. and Orpha May Stalnaker, Glenville, W.Va.
Jno. E. and J. Erlo Arbuckle, Glenville, W.Va.
March 25, 1948
May 3, 1948
119,000 G.F.
182 lbs. 48 hrs.
100'

Bottom Hole Packer
Size 8 1/2 x 10 at 859
Anchor 6 5/8 x 8 1/2
Depth 1820
Perf. top 1560
bot 1575

Clay	R	S	0	25	
Slate	Bl	S	25	110	
Red Rock		S	110	185	
Slate	Wh	S	185	250	
Red Rock		S	250	270	
Slate	Wh	S	270	300	
Red Rock		S	300	315	
Slate	Wh	S	315	390	
Red Rock		S	390	417	
Slate Shls.	Wh	SH	417	452	
Slate	Blk	S	452	472	
Slate	Wh	S	472	505	
Sand	Wh	H	505	528	
Slate Shls.	Wh	SH	528	565	
Sand	Wh	H	565	600	
Slate	Wh	S	600	615	
Sand	Wh	H	615	640	
Slate	Wh	S	640	645	
Sand	Wh	H	645	675	
Slate	Wh	S	675	708	
Sand	Wh	H	708	724	
Slate Shls	Wh	S&H	724	770	
Sand	Wh	H	770	790	Show gas 785
Slate	Dk	S	790	795	
Sand	Wh	H	795	835	Big Dunkard
Slate	Wh	S	835	842	
Sand	Wh	H	842	912	Gas Sand
Slate	Dk	S	912	930	
Sand	Wh	H	930	985	Show gas 935 1st Salt Sand
Slate	Dk	S	985	1015	
Sand	Wh	H	1015	1120	2nd Salt Sand
Slate Shls	Blk	SH	1120	1210	
Sand	Wh	H	1210	1257	Show gas 1222 3rd Salt Sand
Slate		S	1257	1259	
Sand	Wh	H	1259	1295	4th Salt Sand
Slate	Dk	S	1295	1435	
Sand	Wh	H	1435	1474	Maxon Sand show gas 1450
Red Rock		S	1474	1477	
Lime	Lt	H.	1477	1493	
Red Rock		S	1493	1498	
Slate	Dk	S	1498	1508	
Lime	Dk	H	1508	1529	Little Lime
Slate Shls	Wh	SH	1529	1550	
Slate	Blk	S	1550	1554	
Lime	Gr	H	1554	1615	Gas 1564-70' Big Lime
Sand	Wh	H	1615	1710	Gas 1664-70' Big Injun
Slate	Wh	S	1710	1723	
Lime	Dk	H	1723	1733	
Slate Shls				1733	
Total Depth				1744	

RECEIVED
Office of Oil and Gas

MAY 22 2014

Latitude 39 00

21 00 770 P.

Longitude 80 50

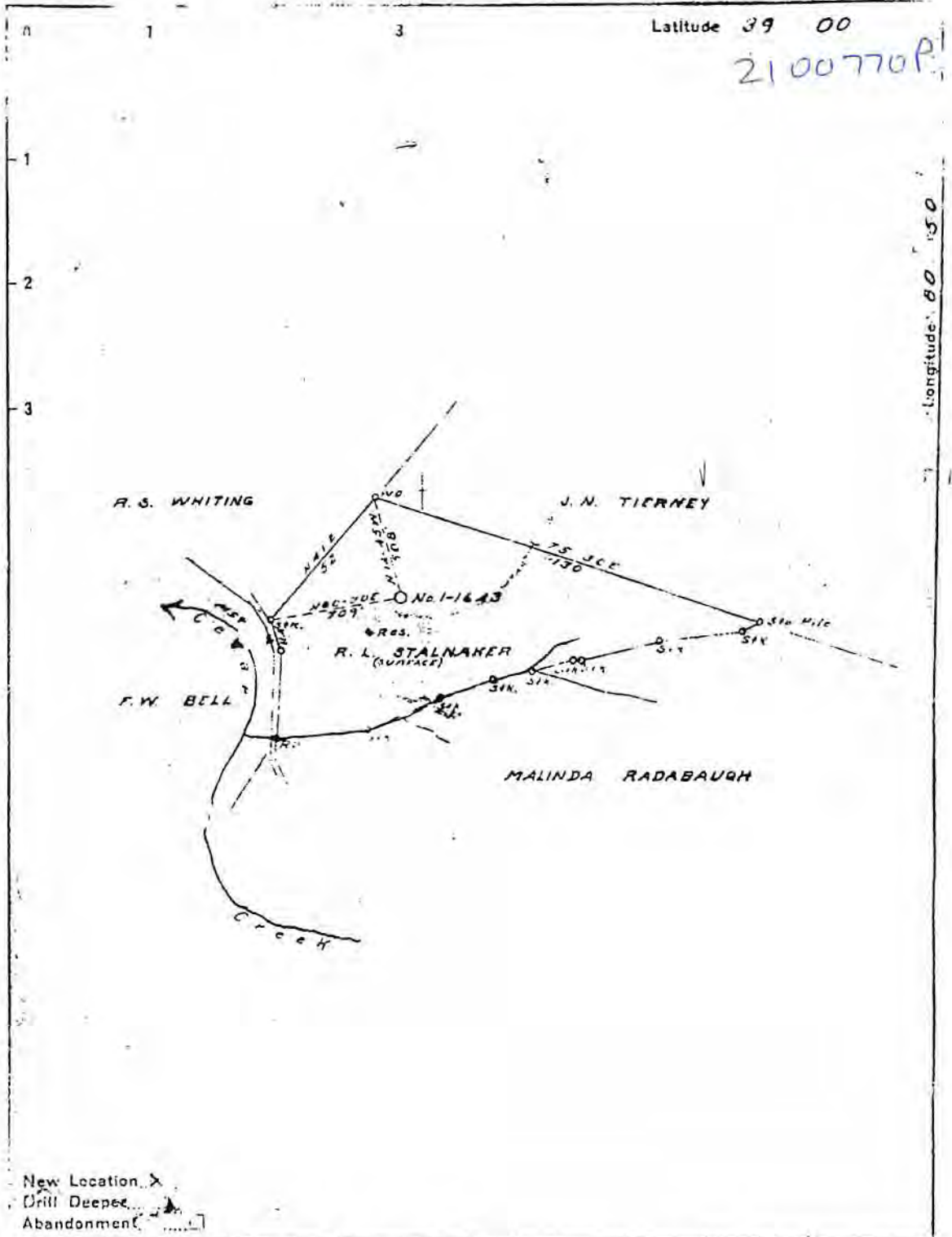

New Location X
 Drill Deeper [Symbol]
 Abandonment [Symbol]

Company CARNEGIE NATURAL GAS
 Address PITTSBURGH, Pa.
 Farm JNO. E. ARBUCKLE ETAL
 Tract _____ Acres 3.5 Lease No. L17221-20
 Well (Farm) No. 1 Serial No. E 1643
 Elevation (Spirit Level) 882'
 Quadrangle GLENVILLE N.W.
 County GILMER District DEKALB
 Engineer R.L. SWEENEY
 Engineer's Registration No. _____
 File No. _____ Drawing No. _____
 Date 12-17-48 Scale 1" = 40 Feet

STATE OF WEST VIRGINIA
 DEPARTMENT OF MINES
 OIL AND GAS DIVISION
 CHARLESTON

WELL LOCATION MAP
 FILE NO. G 511778 Office of Oil and Gas

+ Denotes location of well on United States Topographic Maps, scale 1 to 62,500, latitude and longitude lines being represented by border lines as shown

- Denotes one inch square on border line of original tracing

07/11/2014

1) Date: 5-21-14
2) Operator's Well Number
656441 Arbuckle #1643
3) API Well No.: 47 021 - 00770
State County Permit

STATE OF WEST VIRGINIA - BUREAU OF ENVIRONMENT
DIVISION OF ENVIRONMENTAL PROTECTION, OFFICE OF OIL & GAS
NOTICE AND APPLICATION TO PLUG AND ABANDON WELL

4) Surface Owner(s) to be served:
(a) Name Lucille Stalnaker
Address 815 Lower Cedar Creek Rd
Glenville, WV 26351
(b) Name _____
Address _____
(c) Name _____
Address _____
6) Inspector Bryan Harris
Address P.O. Box 157
Volga WV 26238
Telephone 304.553.6087

5) (a) Coal Operator:
Name None
Address _____
(b) Coal Owner(s) with Declaration
Name Earnest L Arbuckle Family Trust
C/O Security National Trust Co Trustee
Address 1300 Chapline St
Wheeling WV 26003-3348
Name _____
Address _____
(c) Coal Lessee with Declaration
Name None
Address _____

TO THE PERSONS NAMED ABOVE: You should have received this Form and the following documents:

- (1) The application to Plug and Abandon a Well on Form WW-4B, which sets out the parties involved in the work and describes the well its and the plugging work order; and
 - (2) The plat (surveyor's map) showing the well location on Form WW-6.
- The reason you received these documents is that you have rights regarding the application which are summarized in the instructions on the reverses side. However, you are not required to take any action at all.

Take notice that under Chapter 22-6 of the West Virginia Code, the undersigned well operator proposes to file or has filed this Notice and Application and accompanying documents for a permit to plug and abandon a well with the Chief of the Office of Oil and Gas, West Virginia Division of Environmental Protection, with respect to the well at the location described on the attached Application and depicted on the attached Form WW-6. Copies of this Notice, the Application, and the plat have been mailed by registered or certified mail or delivered by hand to the person(s) named above (or by publication in certain circumstances) on or before the day of mailing or delivery to the Chief.

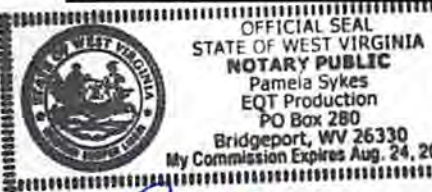

Well Operator: EQT Production Company
Name Victoria J. Roark
Title Permitting Supervisor
Address: PO Box 280
Bridgeport, WV 26330
Telephone: (304) 848-0076

Subscribed and sworn before me this 21 day of May, 2014
My Commission Expires: 8-24-22
Notary Public Pamela Sykes of Oil and Gas

RECEIVED
MAY 22 2014
WV Department of Environmental Protection

The Office of Oil & Gas processes your personal information, such as name, address and phone number, as part of our regulatory duties. Your personal information may be disclosed to other State agencies or third parties in the normal course of business or as needed to comply with statutory or regulatory requirements, including Freedom of Information Act requests. Our office will appropriately secure your personal information. If you have any questions about our use of your personal information, please contact DEP's Chief Privacy Officer at depprivacyofficer@wv.gov

2100770P

neopost[®]
05/21/2014
FIRST-CLASS MAIL
\$07.40
US POSTAGE
ZIP 26330
041L10228992

Lucille Stalnaker
815 Lower Cedar Creek Rd
Glennville, WV 26351

U.S. Postal Service[™]
CERTIFIED MAIL[™] RECEIPT
(Domestic Mail Only; No Insurance Coverage Provided)

For delivery information visit our website at www.usps.com

OFFICIAL USE

Postage	\$	Postmark Here
Certified Fee		
Return Receipt Fee (Endorsement Required)		
Restricted Delivery Fee (Endorsement Required)		

Total: Lucille Stalnaker
815 Lower Cedar Creek Rd
Glennville, WV 26351

Sent To: 656441 Plugging

Street /
or PO B
City, Sta

PS Form 3800, August 2006 See Reverse for Instructions

or on the front if space permits.
1. Article Addressed to:

Lucille Stalnaker
815 Lower Cedar Creek Rd
Glennville, WV 26351

656441 Plugging

2. Article Number
(Transfer from service label)
PS Form 3811, July 2013

4103 2630 0001 7365 6365
Domestic Return Receipt

COMPLETE THIS SECTION ON DELIVERY

A. Signature Agent
X Addressee

B. Received by (Printed Name) C. Date of Delivery

D. Is delivery address different from item 1? Yes
If YES, enter delivery address below: No

3. Service Type
 Certified Mail* Priority Mail Express[™]
 Registered Return Receipt for Merchandise
 Insured Mail Collect on Delivery

4. Restricted Delivery? (Extra Fee) Yes

RECEIVED
Office of Oil and Gas
MAY 22 2014

WV Department of
Environmental Protection
07/11/2014



EQT
C/O Vicki Reark
P.O. Box 280
Bridgeport, WV 26330

2100770P

FIRST-CLASS MAIL
\$07.40
ZIP 26330
041L1022892



Ernest L Arbuckle et al
C/O Security National Trust Co, Trustee
1300 Chapline St
Wheeling, WV 26003-3348

U.S. Postal Service™
CERTIFIED MAIL™ RECEIPT
(Domestic Mail Only; No Insurance Coverage Provided)

For delivery information visit our website at www.usps.com
OFFICIAL USE

Postage	\$	Postmark Here
Certified Fee		
Return Receipt Fee (Endorsement Required)		
Restricted Delivery Fee (Endorsement Required)		

Total Postage: Ernest L Arbuckle et al
C/O Security National Trust Co, Trustee
1300 Chapline St
Wheeling, WV 26003-3348
City, State: 656441 Plugging

PS Form 3800, August 2006 See Reverse for Instructions

SENDER: COMPLETE THIS SECTION

- Complete items 1, 2, and 3. Also complete item 4 if Restricted Delivery is desired.
- Print your name and address on the reverse so that we can return the card to you.
- Attach this card to the back of the mailpiece, or on the front if space permits.

1. Article Addressed to:

Ernest L Arbuckle et al
C/O Security National Trust Co, Trustee
1300 Chapline St
Wheeling, WV 26003-3348
656441 Plugging

2. Article Number
(Transfer from service label)

7013 2630 0001 7365 6297

PS Form 3811, July 2013 Domestic Return Receipt

COMPLETE THIS SECTION ON DELIVERY

A. Signature Agent
X Addressee

B. Received by (Printed Name) C. Date of Delivery

D. Is delivery address different from item 1? Yes
If YES, enter delivery address below: No

3. Service Type
 Certified Mail® Priority Mail Express™
 Registered Return Receipt for Merchandise
 Insured Mail Collect on Delivery

4. Restricted Delivery? (Extra Fee) Yes

EQT
C/O Vicki Roark
P.O. Box 280
Bridgeport, WV 26330

RECEIVED
Office of Oil and Gas

MAY 22 2014

WV Department of
Environmental Protection
07/11/2014

2100770P

neopost
05/21/2014
FIRST-CLASS MAIL
\$02.24⁰
ZIP 26330
041L10228892



Bryan Harris
P.O. Box 157
Volga, WV 26238

EQT
C/O Vicki Roark
P.O. Box 280
Bridgeport, WV 26330

RECEIVED
Office of Oil and Gas

MAY 22 2014

WV Department of
Environmental Protection

07/11/2014

STATE OF WEST VIRGINIA
DEPARTMENT OF ENVIRONMENTAL PROTECTION, OFFICE OF OIL & GAS
CONSTRUCTION AND RECLAMATION PLAN AND SITE REGISTRATION APPLICATION FORM
GENERAL PERMIT FOR OIL AND GAS PIT WASTE DISCHARGE

Operator Name: EQT PRODUCTION COMPANY OP ID: _____
Watershed: Spruce Creek of Little Kanawha River Quadrangle: Tanner
Elevation: 819 County: Gilmer District: DeKalb

Description of anticipated Pit Waste: Formation Fluids

Do you anticipate using more than 5,000 bbls of water to complete the proposed well work? Yes ___ No X
Will synthetic liner be used in the pit? Yes Is so, what ml.? -10 ml 20 ml.

Proposed Disposal Method for Treated Pit Wastes:

- Land Application
- _____ Underground Injection - UIC Permit Number _____
- _____ Reuse (at API Number) _____
- _____ Offsite Disposal Permit #. _____
- _____ Other: Explain _____

Drilling medium anticipated for this well? Air, freshwater, oil based, etc. _____
If oil based, what type? Synthetic, petroleum, etc. _____

Additives to be used? _____

Will closed loop system be used? _____

Drill Cuttings disposal method? Leave in pit, landfill, remove offsite, etc. _____
If left in pit and plan to solidify what medium will be used? Cement, Lime, sawdust _____
Landfill or offsite name/permit number? _____

I certify that I understand and agree to the terms and conditions of the GENERAL WATER POLLUTION PERMIT issued on August 1, 2005, by the Office of Oil and Gas of the West Virginia Division of Environmental Protection. I understand that the provisions of the permit are enforceable by law. Violations of any terms or condition of the general permit and/or other applicable law or regulation can lead to enforcement action.
I certify under penalty of law that I have personally examined and am familiar with the information submitted on this application form and all attachments thereto and that, based on my inquiry of those individuals immediately responsible for obtaining the information, I believe that the information is true, accurate and complete. I am aware that there are significant penalties for submitting false information, including the possibility of fine or imprisonment.

Company Official Signature *Victoria Roark*

Company Official (Typed or Printed) Victoria Roark

Company Official Title Permitting Supervisor-WV

Subscribed and sworn before me this 21 day of May, 2014

Pamela Sykes Notary Public

My Commission Expires 8-24-20

RECEIVED
Office of Oil and Gas
MAY 22 2014



OPERATOR'S WELL NO.:
656441 Arbuckle #1643

LEGEND

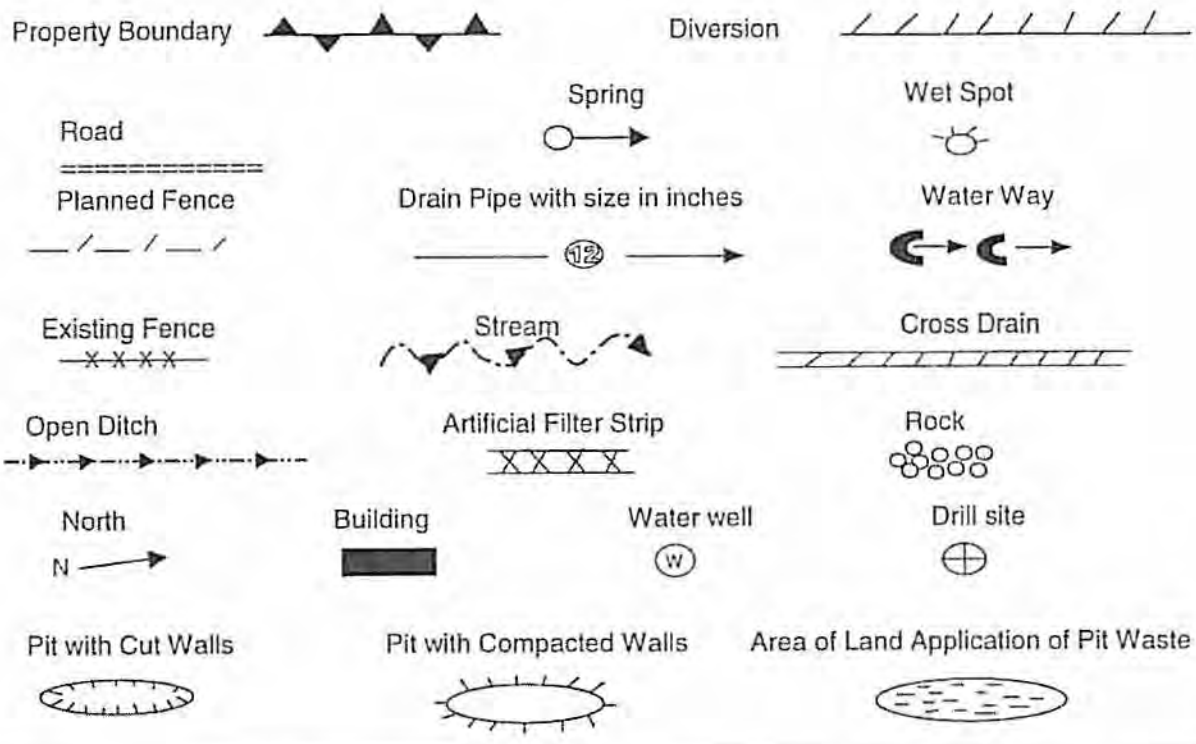

Proposed Revegetation Treatment: Acres Disturbed: 1± Prevegetation pH 5.8
 Lime 3 Tons/acre or to correct to pH 6.5
 Fertilizer (10-20-20) or equivalent 1/3 ton lbs/acre (500 lbs minimum)
 Mulch 2 Tons/acre or hydroseed.

SEED MIXTURES

Area I		Area II	
Seed Type	lbs/acre	Seed Type	lbs/acre
KY-31	40	Orchard Grass	15
Alsike Clover	5	Alsike Clover	5
Annual Rye	15		

RECEIVED
Office of Oil and Gas

ATTACH:
 Drawing(s) of road, location, pit and proposed area for land application.
 Photocopies section of involved 7.5' topographic sheet.

Plan approved by: Dwight D. Hester

Comments: _____

JUN 13 2014

WV Dept. of Environmental Protection

Title: Oil & Gas Inspector Date: 6-12-14
 Field Reviewed? Yes No

2100770P

Topo Quad: Tanner 7.5'

Scale: 1" = 2000'

County: Gilmer

Date: April 15, 2014

District: Dekalb

Project No: 25-19-00-07

47-021-00770 WV 656441 (Arbuckle #1643)

Topo

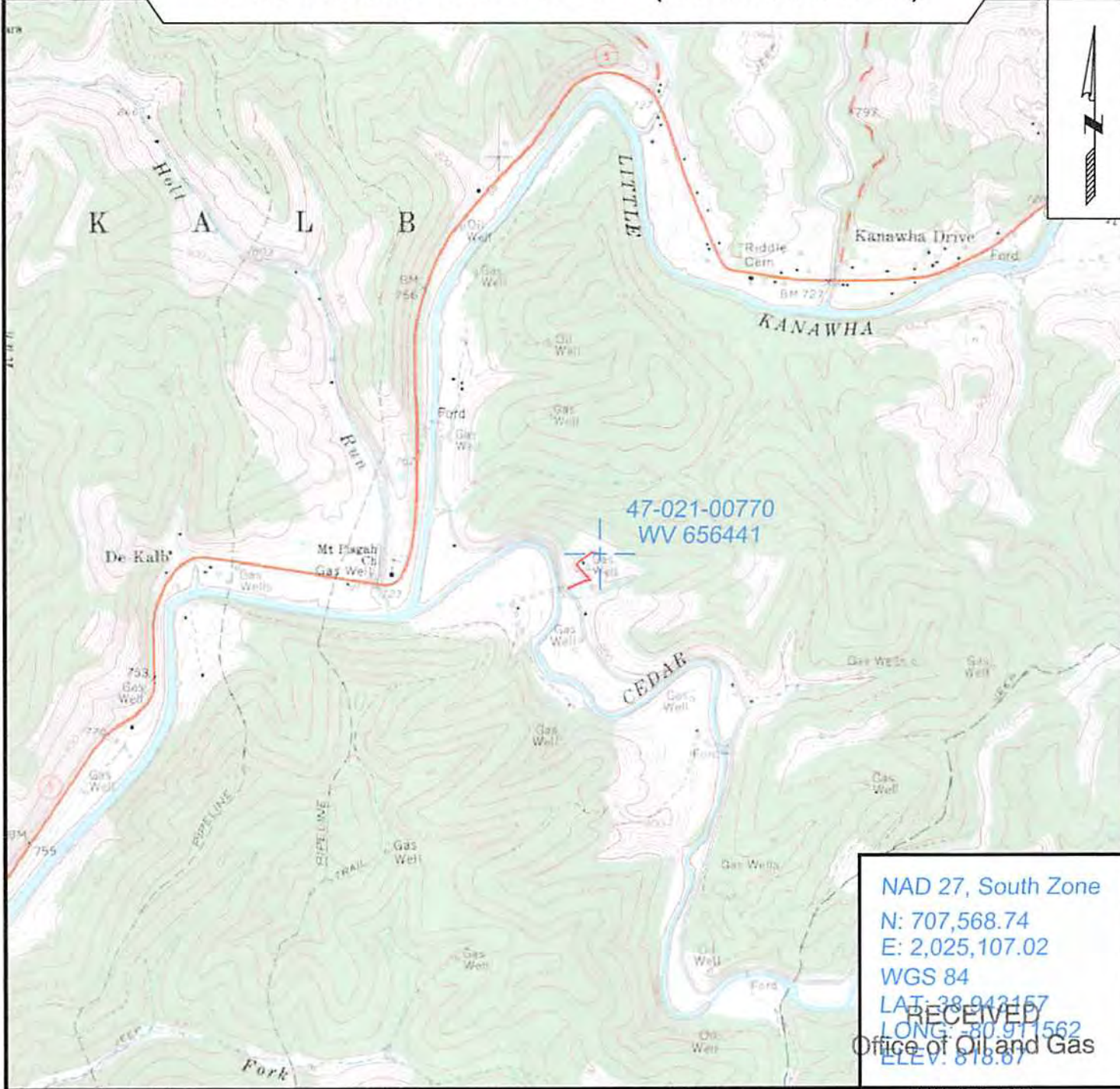

NAD 27, South Zone
 N: 707,568.74
 E: 2,025,107.02
 WGS 84
 LAT: 38.942157
 LONG: -80.911562
 ELEV: 818.87

RECEIVED
 Office of Oil and Gas



SURVEYING AND MAPPING SERVICES PERFORMED BY:
ALLEGHENY SURVEYS, INC.
 1-800-482-8606
 237 Birch River Road
 Birch River, WV 26610
 PH: (304) 649-8606
 FAX: (304) 649-8608

PREPARED FOR: MAY 22 2014
EQT Production Company
 WV Department of
 Environmental Protection
 P.O. Box 280
 Bridgeport, WV 26330

07/11/2014

WW-7
8-30-06



West Virginia Department of Environmental Protection
Office of Oil and Gas
WELL LOCATION FORM: GPS

API: 47-021-00770 WELL NO.: WV 656441 (Arbuckle #1643)

FARM NAME: Jno. E. Arbuckle, et. al.

RESPONSIBLE PARTY NAME: EQT Production Company

COUNTY: Gilmer DISTRICT: Dekalb

QUADRANGLE: Tanner 7.5'

SURFACE OWNER: Lucille Stalnaker

ROYALTY OWNER: Jno. E. Arbuckle, et. al.

UTM GPS NORTHING: 4310472

UTM GPS EASTING: 507664 GPS ELEVATION: 249 m (819 ft)

The Responsible Party named above has chosen to submit GPS coordinates in lieu of preparing a new well location plat for a plugging permit or assigned API number on the above well. The Office of Oil and Gas will not accept GPS coordinates that do not meet the following requirements:

1. Datum: NAD 1983, Zone: 17 North, Coordinate Units: meters, Altitude: height above mean sea level (MSL) – meters.
2. Accuracy to Datum – 3.05 meters
3. Data Collection Method:
Survey grade GPS ; Post Processed Differential
Real-Time Differential
Mapping Grade GPS X; Post Processed Differential X
Real-Time Differential
4. Letter size copy of the topography map showing the well location.

I the undersigned, hereby certify this data is correct to the best of my knowledge and belief and shows all the information required by law and the regulations issued and prescribed by the Office of Oil and Gas.

Signature

PS# 2180
Title

RECEIVED
Office of Oil and Gas
Date 4/25/14 MAY 22 2014
WV Department of
Environmental Protection
07/11/2014



POTENTIAL WATER SAMPLE DATA SHEET

CLIENT: EQT PRODUCTION COMPANY

LEASE NAME AND WELL No. Arbuckle #1643 WV 656441 (47-021-00770)

The initial mapping review of the area surrounding the proposed well site revealed the below listed surface owner(s) that were potentially utilizing groundwater (potable) for Human Consumption or other purposes within 1000' of the existing well site. The following landowners will be notified of the opportunity to request a water sample.

*Please note that the following information is subject to change upon field inspection.

POTENTIAL SAMPLE LOCATIONS

Site: 1 Spacing: 290' +/- Owner: Lucille Stalnaker
Address: 815 Lower Cedar Creek Road, Glenville, WV 26351 Phone No. _____
Comments:

Site: 2 Spacing: 264' +/- Owner: Lucille Stalnaker
Address: 815 Lower Cedar Creek Road, Glenville, WV 26351 Phone No. _____
Comments:

Site: 3 Spacing: 226' +/- Owner: Lucille Stalnaker
Address: 815 Lower Cedar Creek Road, Glenville, WV 26351 Phone No. _____
Comments:

Site: 4 Spacing: 447' +/- Owner: Lucille Stalnaker
Address: 815 Lower Cedar Creek Road, Glenville, WV 26351 Phone No. _____
Comments:

Site: 5 Spacing: 844' +/- Owner: Lucille Stalnaker
Address: 815 Lower Cedar Creek Road, Glenville, WV 26351 Phone No. _____
Comments:

BIRCH RIVER OFFICE
237 Birch River Road
Birch River, WV 26610
phone: 304-649-8606
fax: 304-649-8608

BRIDGEPORT OFFICE
172 Thompson Drive
Bridgeport, WV 26330
phone: 304-848-5035
fax: 304-848-5037

CALDWELL OFFICE
212 Cumberland Street
Caldwell, OH 43724
phone: 740-305-5007
fax: 740-305-5126

RECEIVED
Office of Oil and Gas
REGULATORY SERVICES OFFICE
P.O. Box 108 • 1413 Childress Road
Marysville, WV 25003
MAY 22 2014
phone: 304-756-2949
fax: 304-756-2948

Topo Quad: Tanner 7.5' Scale: 1" = 2000'

County: Gilmer Date: April 15, 2014

District: Dekalb Project No: 25-19-00-07

Water

47-021-00770 WV 656441 (Arbuckle #1643)

5 potential water wells within 1000'

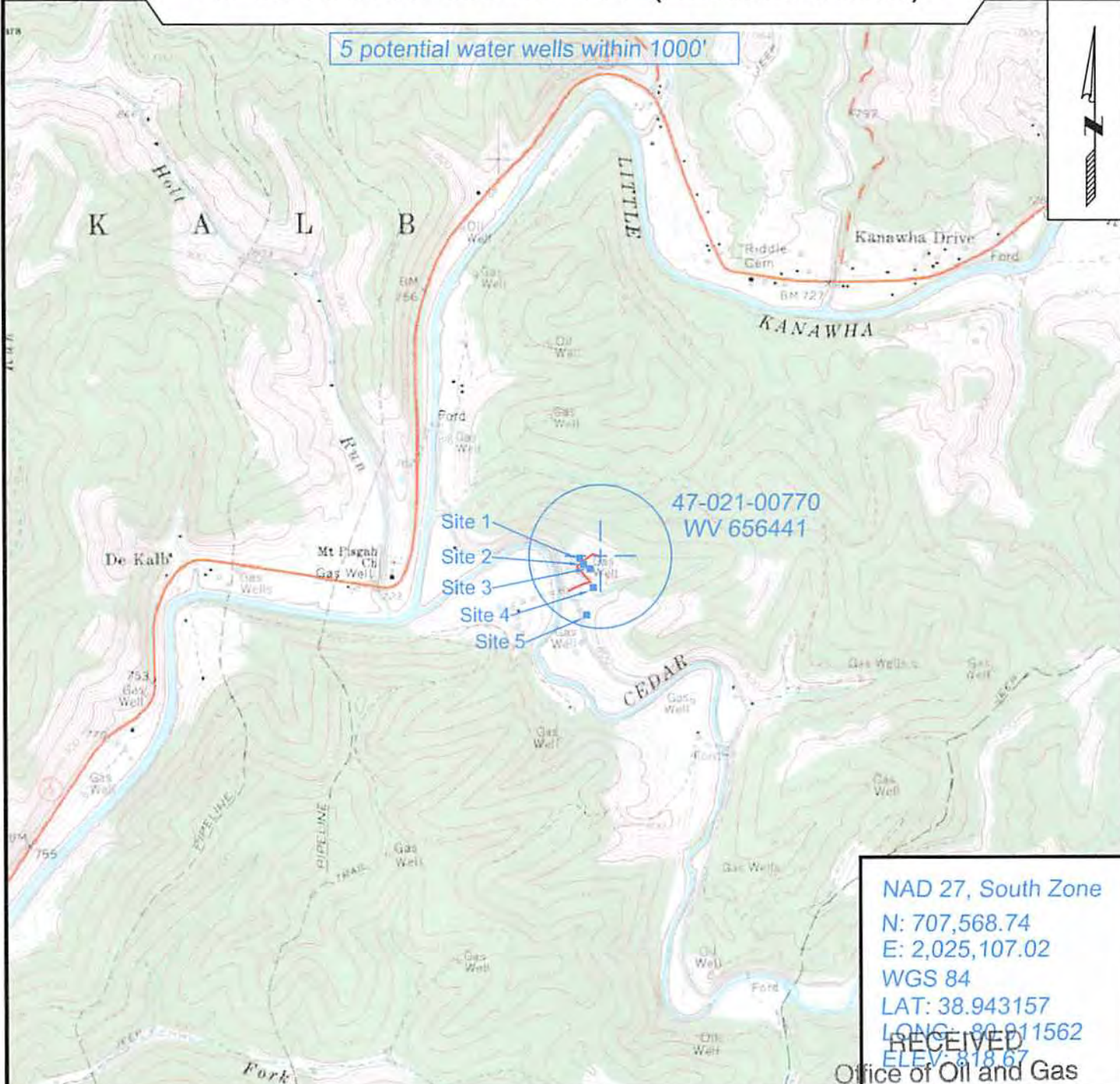

NAD 27, South Zone
 N: 707,568.74
 E: 2,025,107.02
 WGS 84
 LAT: 38.943157
 LONG: -80.911562
 ELEV: 818.67

RECEIVED
 Office of Oil and Gas



SURVEYING AND MAPPING SERVICES PERFORMED BY:
ALLEGHENY SURVEYS, INC.

1-800-482-8606
 237 Birch River Road
 Birch River, WV 26610
 PH: (304) 649-8606
 FAX: (304) 649-8608

PREPARED FOR:

MAY 22 2014
EQT Production Company

W.V. Department of
 Environmental Protection

07/11/2014