

WW-7
8-30-06



West Virginia Department of Environmental Protection
Office of Oil and Gas

WELL LOCATION FORM: GPS

API: 47-021-01640-01722 WELL NO.: #1

FARM NAME: Boilon Heirs

RESPONSIBLE PARTY NAME: Term Energy Corp.

COUNTY: Gilmer DISTRICT: Glenville

QUADRANGLE: Gilmer 7.5'

SURFACE OWNER: Michael L. Chapman

ROYALTY OWNER: _____

UTM GPS NORTHING: 4311260

UTM GPS EASTING: 528424 GPS ELEVATION: 793

The Responsible Party named above has chosen to submit GPS coordinates in lieu of preparing a new well location plat for a plugging permit or assigned API number on the above well. The Office of Oil and Gas will not accept GPS coordinates that do not meet the following requirements:

- Datum: NAD 1983, Zone: 17 North, Coordinate Units: meters, Altitude: height above mean sea level (MSL) – meters.
- Accuracy to Datum – 3.05 meters
- Data Collection Method:
Survey grade GPS ____: Post Processed Differential ____
Real-Time Differential ____
Mapping Grade GPS ____: Post Processed Differential ____
Real-Time Differential ____

RECEIVED
Office of Oil & Gas
JUL 05 2022

WV Department of
Environmental Protection

4. Letter size copy of the topography map showing the well location.

I the undersigned, hereby certify this data is correct to the best of my knowledge and belief and shows all the information required by law and the regulations issued and prescribed by the Office of Oil and Gas.

[Signature] _____ Designated Agent _____ 6-15-2022
Signature Title Date

SUBJECT WELL
Boilen Heirs No.1
47-021-01722

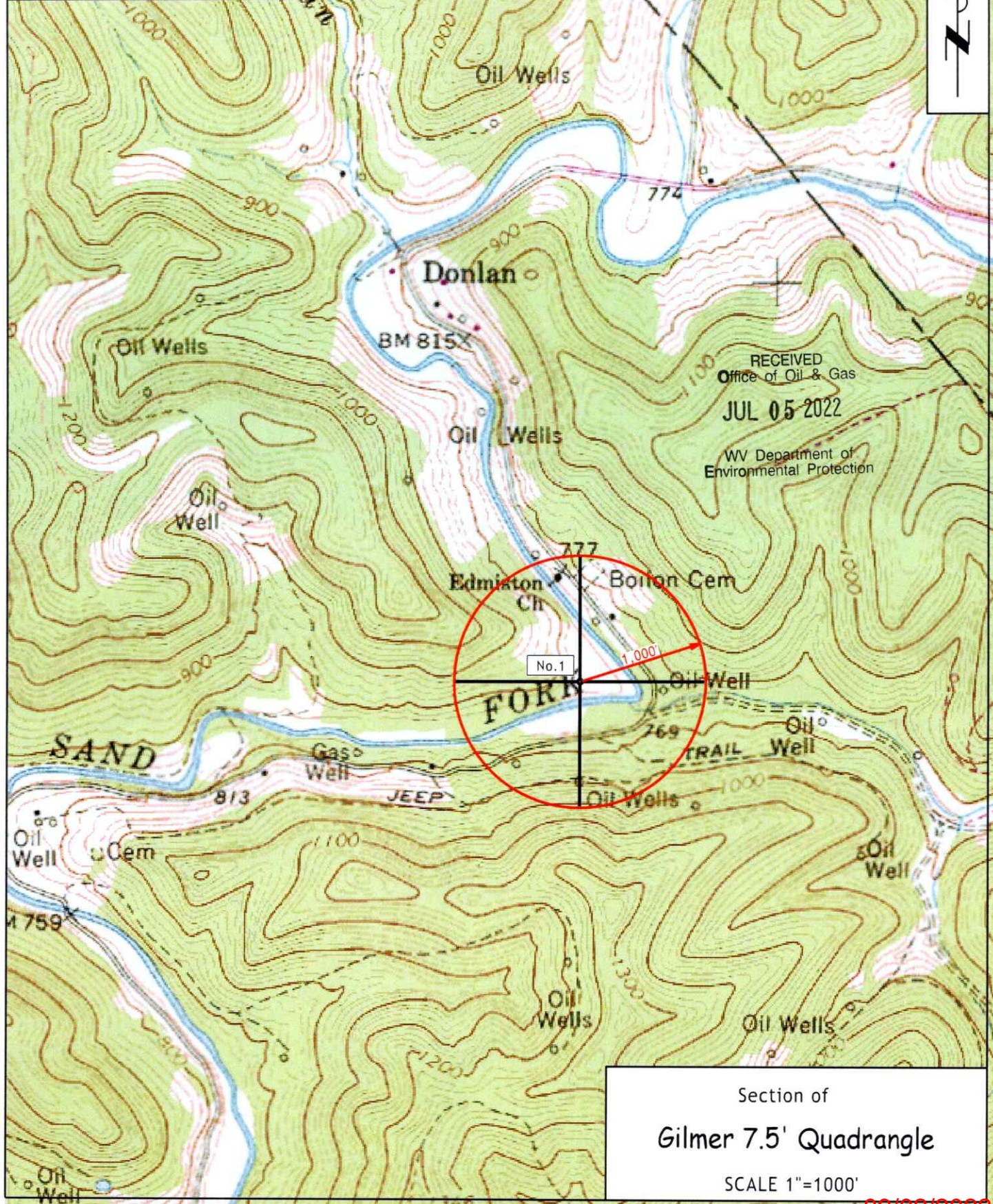

RECEIVED
Office of Oil & Gas
JUL 05 2022
WV Department of
Environmental Protection

Section of
Gilmer 7.5' Quadrangle
SCALE 1"=1000'