

WW-7
8-30-06



West Virginia Department of Environmental Protection
Office of Oil and Gas

WELL LOCATION FORM: GPS

API: 47-021-02424 WELL NO.: WV 157811 (Ervin Lowther Well #1)

FARM NAME: Ervin Lowther

RESPONSIBLE PARTY NAME: EQT Production Company

COUNTY: Gilmer DISTRICT: Glennville

QUADRANGLE: Gilmer 7.5'

SURFACE OWNER: Dan M. Lowther

ROYALTY OWNER: Mavis Lowther, et al.

UTM GPS NORTHING: 4315535

UTM GPS EASTING: 524288 GPS ELEVATION: 321 m (1055 ft)

The Responsible Party named above has chosen to submit GPS coordinates in lieu of preparing a new well location plat for a plugging permit or assigned API number on the above well. The Office of Oil and Gas will not accept GPS coordinates that do not meet the following requirements:

1. Datum: NAD 1983, Zone: 17 North, Coordinate Units: meters, Altitude: height above mean sea level (MSL) – meters.
2. Accuracy to Datum – 3.05 meters
3. Data Collection Method:

Survey grade GPS : Post Processed Differential
Real-Time Differential

Mapping Grade GPS : Post Processed Differential
Real-Time Differential

4. Letter size copy of the topography map showing the well location.

I the undersigned, hereby certify this data is correct to the best of my knowledge and belief and shows all the information required by law and the regulations issued and prescribed by the Office of Oil and Gas.

Received

MAR 19 2014

Signature *Stacy Olson*
Date 3/4/14

PS # 2180
Title

Topo Quad: Gilmer 7.5' Scale: 1" = 2000'
 County: Gilmer Date: February 27, 2014
 District: Glenville Project No: 25-19-00-07

47-021-02424 WV 157811 (Ervin Lowther Well #1)

Topo

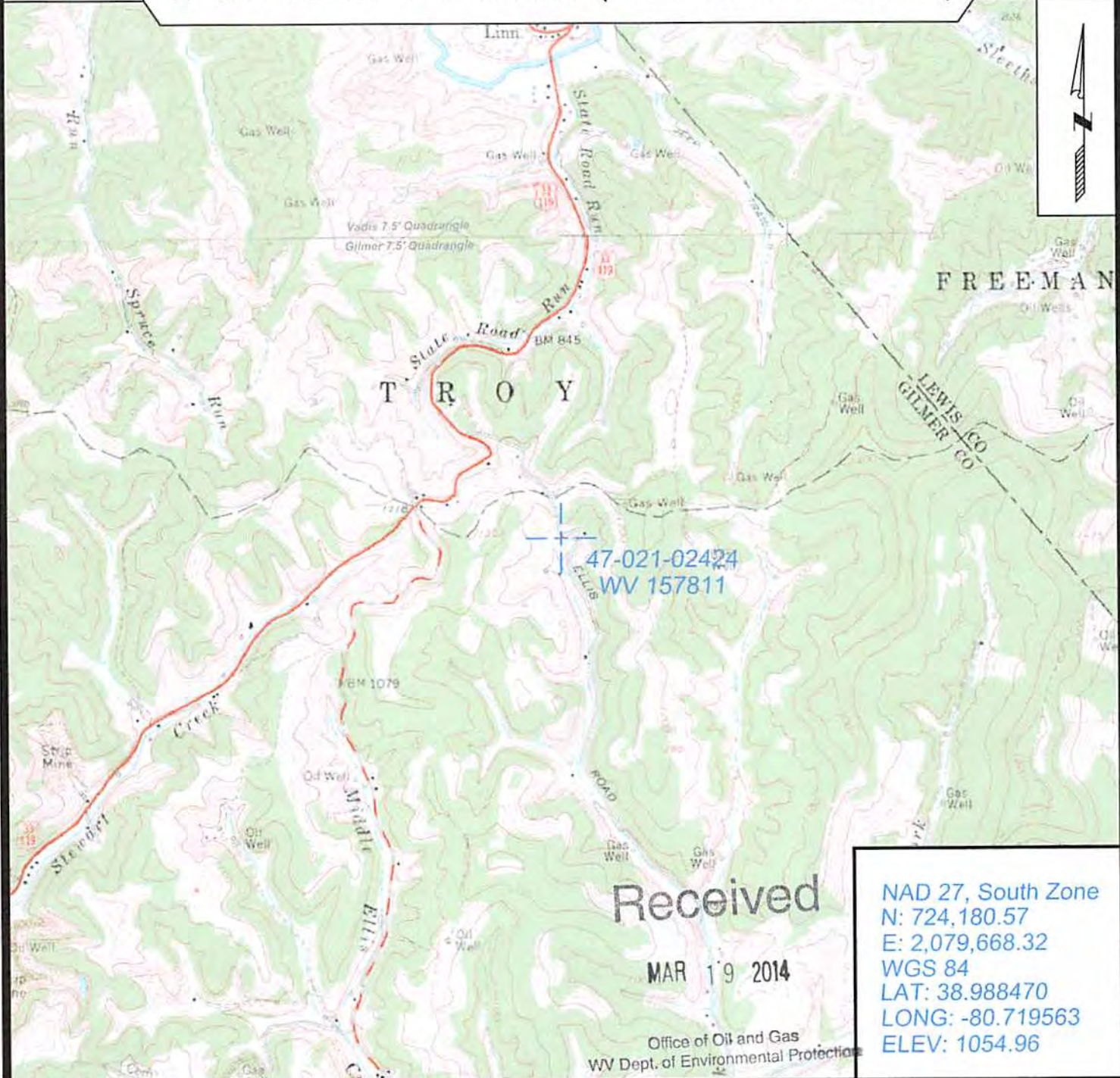

Received

MAR 19 2014

Office of Oil and Gas
WV Dept. of Environmental Protection

NAD 27, South Zone
 N: 724,180.57
 E: 2,079,668.32
 WGS 84
 LAT: 38.988470
 LONG: -80.719563
 ELEV: 1054.96



SURVEYING AND MAPPING SERVICES PERFORMED BY:
ALLEGHENY SURVEYS, INC.
 1-800-482-8606
 P.O. BOX 438
 BIRCH RIVER, WV 26610
 PH: (304) 649-8606
 FAX: (304) 649-8608

PREPARED FOR:
EQT Production Company
 P.O. Box 280
 Bridgeport, WV 26330