

6.57

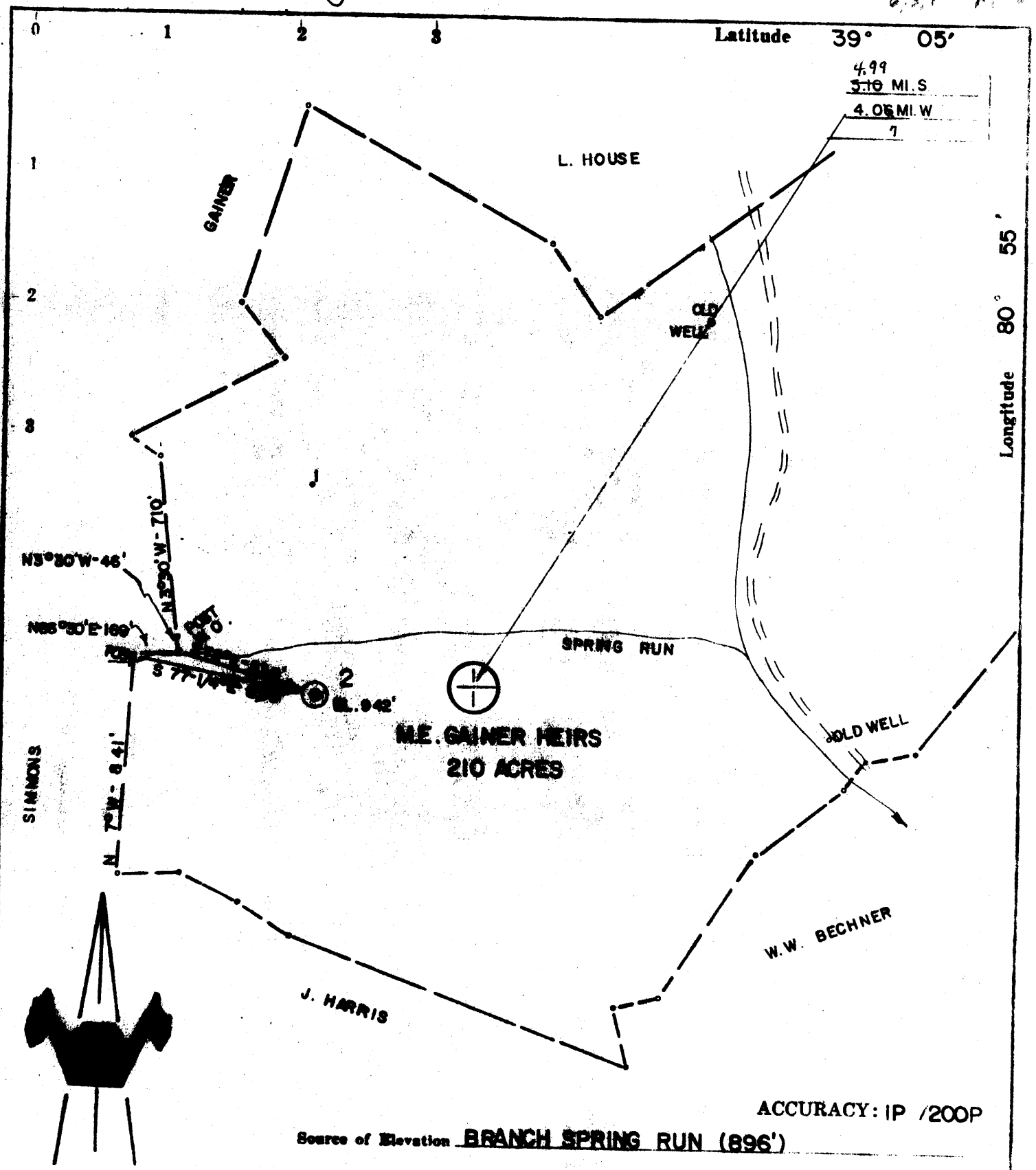

- New Location
- Drill Deeper
- Abandonment
- Fracture
- Redrill

I, the undersigned, hereby certify that this map is correct to the best of my knowledge and belief and shows all the information required by paragraph 6 of the rules and regulations of the oil and gas section of the mining laws of West Virginia.

Chet Waterman

Company **MURVIN OIL CORP.**
 Address **OLNEY, ILL.**
 Farm **M.E. GAINER**
 Tract. Acres **210** Lease No. _____
 Well (Farm) No. **2** Serial No. _____
 Elevation (Spirit Level) **942'**
 Quadrangle **HOLBROOK SW**
 County **GILMER** District **DEKALB**
 Engineer **CHET WATERMAN**
 Engineer's Registration No. **3788**
 File No. **75003-216** Drawing No. _____
 Date **6/2/75** Scale 1" = **300'**

STATE OF WEST VIRGINIA
 DEPARTMENT OF MINES
 OIL AND GAS DIVISION
 CHARLESTON

WELL LOCATION MAP
 FILE NO. **GIL-2549**

Denotes location of well on United States Topographic Maps, scale 1 to 62,500, latitude and longitude lines being represented by border lines as shown.

— Denotes one inch spaces on border line of original tracing.

47-021 JUN 18 1975

6-6 2 300' Bore Burnt House - Lucerne (136)



STATE OF WEST VIRGINIA
DEPARTMENT OF MINES
Oil and Gas Division
WELL RECORD

RECEIVED

JUN 18 1975

OIL & GAS DIVISION
DEPT. OF MINES

Quadrangle Holbrook
Permit No. Gil-2549

Rotary X Oil
Cable _____ Gas X
Recycling _____ Comb. _____
Water Flood _____ Storage _____
Disposal _____ (Kind) _____

Company <u>Murvin Oil Corporation</u>	Casing and Tubing	Used in Drilling	Left in Well	Cement fill up Cu. ft. (Sks.)
Address <u>Box 297, Olney, Ill. 62450</u>				
Farm <u>M. E. Gainer Heirs</u> Acres <u>200</u>	Size			
Location (waters) <u>Spring Run of Laurel Creek</u>	20-16			
Well No. <u>2</u> Elev. <u>942</u>	Cond.			
District <u>DeKalb</u> County <u>Gilmer</u>	13-10"			
The surface of tract is owned in fee by <u>Eustace Frymier</u>	9 5/8			
Address <u>Smithville, W. Va. 26351</u>	8 5/8	220	220	to surface
Mineral rights are owned by <u>M. E. Gainer Heirs</u>	7			
Address <u>Glenville, W.V.</u>	5 1/2			
Drilling Commenced <u>6/15/75</u>	4 1/2	2000	2000	100 sks.
Drilling Completed <u>8/15/75</u>	3			
Initial open flow <u>NT</u> cu. ft. _____ bbls.	2			
Final production <u>500 M</u> cu. ft. per day _____ bbls.	Liners Used			
Well open <u>8</u> hrs. before test <u>110</u> RP.				

Well treatment details: Frac 1000 bbl water - 50 M Sand - 12 holes Attach copy of cementing record. 1906-1924

Coal was encountered at NONE Feet _____ Inches _____
Fresh water 80 ft. Feet _____ Salt Water _____ Feet _____
Producing Sand Big Injun Depth 1860-1924

Formation	Color	Hard or Soft	Top Feet	Bottom Feet	Oil, Gas or Water	* Remarks
Sand & Shale			Surface	1530		Elec. Log Tops
Sand			1530	1540		
Shale			1540	1592		
Sand			1592	1680		
Shale			1680	1742		
Sand			1742	1762		
Shale			1762	1780		
Big Lime			1780	1860		
<u>Big Injun</u> Sand			1860	1924		
Sandy Shale			1924	2000		
Shale			2000	2369		
			To	2369		

(over)

* Indicates Electric Log tops in the remarks section.



STATE OF WEST VIRGINIA
DEPARTMENT OF MINES

RECEIVED

JUN 3 1975

OIL & GAS DIVISION
DEPT. OF MINES

Oil and Gas Division

OIL AND GAS WELL PERMIT APPLICATION

TO THE DEPARTMENT OF MINES,
Charleston, W. Va.

DATE June 3, 1975

Surface Owner Eustace Frymier
Address Smithville, WV 26351
Mineral Owner M. E. Gainer Heirs
Address Kanawha Union Bank, Glenville, WV
Coal Owner none
Address _____
Coal Operator none
Address _____

Company Murvin Oil Corporation
Address P.O. Box 297, Olney, Ill. 62450
Farm M. E. Gainer Heirs Acres 200
Location (waters) Spring Run of Laurel Creek
Well No. 2 Elevation 1112' 942'
District DeKalb County Gilmer
Quadrangle Holbrook

THIS PERMIT MUST BE POSTED AT THE WELL SITE

All provisions being in accordance with Chapter 22 of the W. Va. Code, the location is hereby approved for Drilling. This permit shall expire if operations have not commenced by 10-3-75

Robert Bates
Deputy Director - Oil & Gas Division

INSPECTOR TO BE NOTIFIED: Robert Bates
PH: 269-4846 ADDRESS Weston, W. Va.

GENTLEMEN:

The undersigned well operator is entitled to drill upon the above named farm or tract of land for oil and gas, having fee title thereto, (or as the case may be) under grant or lease dated August 23, 1898 by M. E. Gainer, et ux. made to South Penn Oil Co. and recorded on the _____ day of _____ 1898 in Gilmer County, Book 33 Page 335

NEW WELL _____ DRILL DEEPER _____ REDRILL _____ FRACTURE OR STIMULATE
_____ OIL AND GAS WELL ORIGINALLY DRILLED BEFORE JUNE 5, 1969.

The enclosed plat was prepared by a registered engineer or licensed land surveyor and all coal owners and/or operators have been notified as of the above date.

The above named coal owners and/or operator are hereby notified that any objection they wish to make, or are required to make by Section 3 of the Code, must be received by, or filed with the Department of Mines within ten (10) days. *

Copies of this notice and the enclosed plat were mailed by registered mail, or delivered to the above named coal operators or coal owners at their above shown respective address _____ day _____ before, or on the same day with the mailing or delivery of this copy to the Department of Mines at Charleston, West Virginia.

PLEASE SUBMIT COPIES OF ALL
GEOPHYSICAL LOGS DIRECTLY TO:

West Virginia Geological and Economic Survey
P. O. Box 679
Morgantown, W. Va. 26505
AC 304-296-4461

Very truly yours, Murvin Oil Corporation
(Sign Name) Jessie B. Lawrence - Agt.
Well Operator

Address
of
Well Operator

P. O. 297
Street
Olney,
City or Town
Illinois, 62450
State

*SECTION 3 If no objections are filed or found by the Department of mines, within said period of ten days from the receipt of notice and plat by the department of mines, to said proposed location, the department shall forthwith issue to the well operator a permit reciting the filing of such plat, that no objections have been made by the coal operators or found thereto by the department and that the same is approved and the well operator authorized to proceed.

BLANKET BOND

Dil-2549 PERMIT NUMBER
47-021

