



west virginia department of environmental protection

Office of Oil and Gas
601 57th Street, S.E.
Charleston, WV 25304
(304) 926-0450
fax: (304) 926-0452

Earl Ray Tomblin , Governor
Randy C. Huffman , Cabinet Secretary
www.dep.wv.gov

Monday, November 28, 2016
WELL WORK PERMIT
Vertical / Plugging

ROSS AND WHARTON GAS COMPANY, INC.
RT. 5, BOX 29

BUCKHANNON, WV 262010000

Re: Permit approval for 1
47-021-02994-00-00

This well work permit is evidence of permission granted to perform the specified well work at the location described on the attached pages and located on the attached plat, subject to the provisions of Chapter 22 of the West Virginia Code of 1931, as amended, and all rules and regulations promulgated thereunder, and to any additional specific conditions and provisions outlined in the pages attached hereto. Notification shall be given by the operator to the Oil and Gas Inspector at least 24 hours prior to the construction of roads, locations, and/or pits for any permitted work. In addition, the well operator shall notify the same inspector 24 hours before any actual well work is commenced and prior to running and cementing casing. Spills or emergency discharges must be promptly reported by the operator to 1-800-642-3074 and to the Oil and Gas Inspector.

Please be advised that form WR-35, Well Operators Report of Well Work is to be submitted to this office within 90 days of completion of permitted well work, as should form WR-34 Discharge Monitoring Report within 30 days of discharge of pits, if applicable. Failure to abide by all statutory and regulatory provisions governing all duties and operations hereunder may result in suspension or revocation of this permit and, in addition, may result in civil and/or criminal penalties being imposed upon the operators.

Per 35 CSR 4-5.2.g this permit will expire in two (2) years from the issue date unless permitted well work is commenced. If there are any questions, please feel free to contact me at (304) 926- 0450.

James A. Martin
Chief

Operator's Well Number: 1
Farm Name: BARKER-MARSHALL
U.S. WELL NUMBER: 47-021-02994-00-00
Vertical / Plugging
Date Issued: 11/28/2016

Promoting a healthy environment.

12/02/2016

PERMIT CONDITIONS

West Virginia Code §22-6-11 allows the Office of Oil and Gas to place specific conditions upon this permit. Permit conditions have the same effect as law. Failure to adhere to the specified permit conditions may result in enforcement action.

CONDITIONS

1. All pits must be lined with a minimum of 20 mil thickness synthetic liner.
2. In the event of an accident or explosion causing loss of life or serious personal injury in or about the well or while working on the well, the well operator or its contractor shall give notice, stating the particulars of the accident or explosion, to the oil and gas inspector and the Chief within twenty-four (24) hours.
3. Well work activities shall not constitute a hazard to the safety of persons.

1) Date 8/23, 2016
2) Operator's
Well No. Marshall Barker #1
API Well No. 47-021 02994

STATE OF WEST VIRGINIA DEPARTMENT OF
ENVIRONMENTAL PROTECTION OFFICE OF OIL
AND GAS

APPLICATION FOR A PERMIT TO PLUG AND ABANDON

4) Well Type: Oil ___ / Gas X / Liquid injection ___ / Waste disposal ___ /
(If "Gas, Production X or Underground storage ___) Deep ___ / Shallow x

5) Location: Elevation 1147 Watershed Heather Fork
District Glenville County Gilmer Quadrangle Gilmer

6) Well Operator Ross and Wharton Gas 7) Designated Agent Mike Ross Po Box 219
Company, INC. Address Coalton WV 26257
Address Rt. 5, Box 29, .
Buckhannon WV 26201

Oil and Gas Inspector to be notified 9) Plugging Contractor
Name Danny Mullins Name R & R WELL SERVICE
Address 124 Bid Trace Fork Rd. 220 Jack Acres Rd. Address 42 LYNCH RIDGE
Harts WV 25524 Buckhannon, WV WALTON, WV 25286
PHONE 304 932 6844 26201

10) Work Order: The work order for the manner of plugging this well is as follows:

Remove all equipment used to produce well

Gel hole TD 2284

Cement 2284 to 1950

Freepoint cut and pull 41/2 csg @ +/- 1200'

Cement 1200 to 900' across cut and elevation plug 8 5/8" CASING SEAT @ 950'

Gel 900' to 270

Cement 270 to surface

Set monument with proper API

Gel between all plugs

Signature Mike Ross 10/14/16 Date

notification must be given to the district oil and gas inspector 24 hours before permitted work is to begin.

Work order approved by inspector Danny Mullins

Date 10-14-16

12/02/2016

2102994P

OG-10
Rev. - 9-71



RECEIVED

JUN 16 1978

STATE OF WEST VIRGINIA
DEPARTMENT OF MINES

OIL & GAS DIVISION
DEPT. OF MINES

Oil and Gas Division

WELL RECORD

Rotary _____ Oil _____
Cable *** Gas _____
Recycling _____ Comb. _____
Water Flood _____ Storage _____
Disposal _____ (Kind) _____

Quadrangle Gilmer 7 1/2
Permit No. G11- 2994

Company Rockwell Petroleum Co., dba Ro-Jo
Address P.O. Box 86, Sand Fork, W. Va.
Farm Barker-Marshall Acres 61.50
Location (waters) Heaters Fork
Well No. one Elev. 1147
District Glenville County Gilmer
The surface of tract is owned in fee by French
Barker
Address Sand Fork, W. Va.
Mineral rights are owned by Marshall Estate,
Barker estate Glenville, W. Va.
Address _____
Drilling Commenced 3-30-78
Drilling Completed 5-22-78
Initial open flow 58 cu. ft. _____ bbls.
Final production 1,100 cu. ft. per day _____ bbls.
Well open 6 hrs. before test. 560 RP.

Casing and Tubing	Used in Drilling	Left in Well	Cement fill up Cu. ft. (Sks.)
Size 20-16			
Cond. 13-10"	218	218	To Surface
9 5/8			
8 5/8	950	Pulled	
7			
5 1/2			
4 1/2		2284	100 sks Pozz
3			
2			
Liners Used			

DM

Well treatment details:
Well Fractured 6-12-78

Attach copy of cementing record.
Perforations

45 thousand lb of 20/40 sand	2014 to 2021	10 holes
500 gal of acid		
1000 HHP		
Breakdown 1800 lb		

Coal was encountered at None Feet _____ Inches _____
Fresh water 90 Feet _____ Salt Water _____ Feet _____
Producing Sand Big Injun Depth 2014 to 2021

Formation	Color	Hard or Soft	Top Feet	Bottom Feet	Oil, Gas or Water	* Remarks
Red Rock			0	60		
Sand			60	75		
Red Rock			75	132		
Lime			132	145		
Slate			145	150		
Sand			150	180		
Salte			180	185		
Red Rock			185	205		
Sany Lime			205	230		
Red Rock			230	250		
Slate			250	380		
Red Rock			380	575		
Slate			575	635		
Red Rock			635	650		
Lime			650	670		
Red Rock			670	700		
Slate			700	800		
Sand			800	865		
Slate			865	890		
Sand			890	920		
Slate			920	950		
Sand			950	985		
Slate			985	1015		

(over)

* Indicates Electric Log tops in the remarks section.

12/02/2016

21 02994A

Formation	Color	Hard or Soft	Top Feet	Bottom Feet	Oil, Gas or Water	Remarks
Lime			1015	1050		
Slate			1050	1095		
Sand			1095	1235		
Slate			1235	1270		
Sand			1270	1295		
Shale			1295	1355		
Sand			1355	1380		
Slate			1380	1435		
Sandy shale			1435	1515		
Shale			1515	1570		
Sand			1570	1612		
Shale			1612	1630		
Sand			1630	1660		
Shale			1660	1710		
Sand			1710	1730		
Shale			1730	1760		
Sand			1760	1810		
Shale			1810	1960		
Lime (Little Lime)			1960	1990		
Sandy Shale			1990	2040		
Lime (Big Lime)			2040	2080		
Big Injun			2080	2226	Show gas	2218
Squaw			2226	2275		
Total Depth			2275			

Date June 15 78

APPROVED  Owner
 By Partner

12/02/2016

2102994P
3/23/78

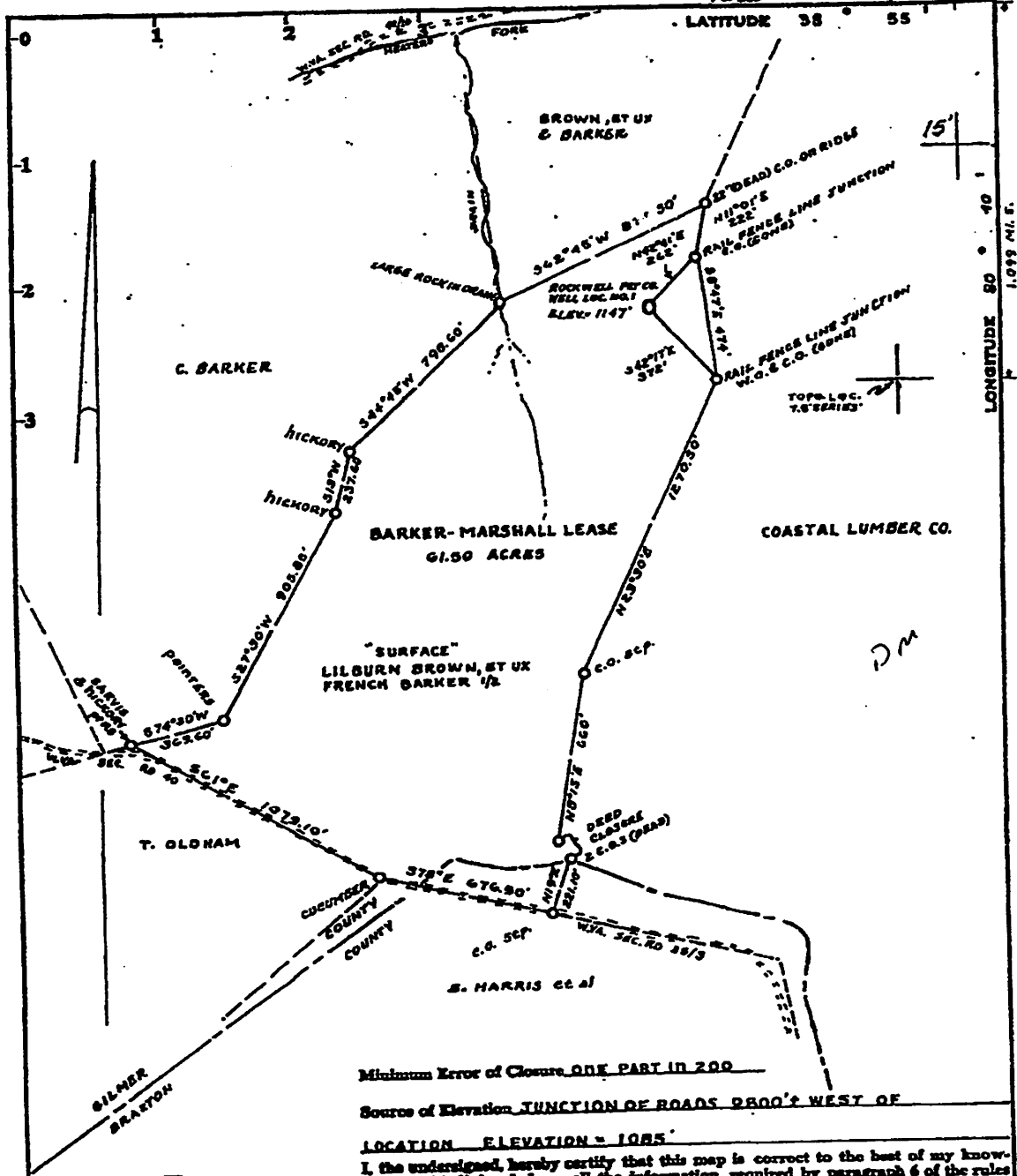

Minimum Error of Closure ONE PART IN 200
Source of Elevation JUNCTION OF ROADS 900' WEST OF

LOCATION ELEVATION = 1085'

I, the undersigned, hereby certify that this map is correct to the best of my knowledge and belief and shows all the information required by paragraph 6 of the rules and regulations of the oil and gas section of the mining laws of West Virginia.

Fracture
 New Location
 Drill Deeper
 Abandonment

Signed: Mark C. Echard
 Squares: N E W

Map No. _____
 Company ROCKWELL PETROLEUM COMPANY
dba RO-VO IND. INC.
 Address P.O. BOX 86 SAND FORK, W.VA. 26430
 Farm FRENCH BARKER
BARKER-MARSHALL LEASE
 Tract _____ Acres 61.50 Lease No. _____
 Well (Farm) No. ONE Serial No. _____
 Elevation (Spirit Level) 1147'
 Quadrangle GILMER 7.5, Burnsville 15'
 County GILMER District GLENVILLE
 Surveyor MARK C. ECHARD
 Surveyor's Registration No. 490
 File No. _____ Drawing No. _____
 Date JANUARY 21, 1978 Scale 1" = 500'

STATE OF WEST VIRGINIA
 DEPARTMENT OF MINES
 OIL AND GAS DIVISION
 CHARLESTON

WELL LOCATION MAP

FILE NO. GIL-2994

+ Denotes location of well on United States Topographic Maps, scale 1 to 24,000, latitude and longitude lines being represented by border lines as shown.
 — Denotes one inch spaces on border line of original tracing. **47-021**

2300' Barker

2102994F

WW-4A
Revised 6-07

1) Date: 8/23/16
2) Operator's Well Number
Marshall Barker #1
3) API Well No.: 47 - 021-02994 -

STATE OF WEST VIRGINIA
DEPARTMENT OF ENVIRONMENTAL PROTECTION, OFFICE OF OIL AND GAS
NOTICE OF APPLICATION TO PLUG AND ABANDON A WELL

4) Surface Owner(s) to be served: (a) Name Peter Pawlowski Address %Matt Hilton, 622 Heater Fork RD, Glenville, WV 26351
(b) Name _____ Address _____
(c) Name _____ Address _____
5) (a) Coal Operator Name None Address _____
(b) Coal Owner(s) with Declaration Name None Address _____
oP.O. _____
(c) Coal Lessee with Declaration Name _____ Address _____
6) Inspector Danny Mullins Address 124 Bid Trace Fork Rd. 220 Jack Acres Rd. Harts WV-25524 Telephone 304 932 6844
Buckhannon, WV 26201

THE PERSONS NAMED ABOVE: You should have received this Form and the following documents:

- (1) The application to Plug and Abandon a Well on Form WW-4B, which sets out the parties involved in the work and describes the well its and the plugging work order; and
- (2) The plat (surveyor's map) showing the well location on Form WW-6.

The reason you received these documents is that you have rights regarding the application which are summarized in the instructions on the reverses side. However, you are not required to take any action at all.

Take notice that under Chapter 22-6 of the West Virginia Code, the undersigned well operator proposes to file or has filed this Notice and Application and accompanying documents for a permit to plug and abandon a well with the Chief of the Office of Oil and Gas, West Virginia Department of Environmental Protection, with respect to the well at the location described on the attached Application and depicted on the attached Form WW-6. Copies of this Notice, the Application, and the plat have been mailed by registered or certified mail or delivered by hand to the person(s) named above (or by publication in certain circumstances) on or before the day of mailing or delivery to the Chic

Well Operator Ross and Wharton Gas Company, INC.
By: Mike Ross
Its: Owner
Address RT 5, Box 29, Buckhannon, WV 26201
Telephone 304 472 4289

Subscribed and sworn before me this 14 day of October 2016
Sept 27, 2020 Brenda K Bush Notary Public
My Commission Expires _____

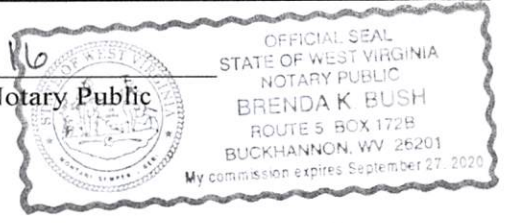

Oil and Gas Privacy Notice

The Office of Oil and Gas processes your personal information, such as name, address and phone number, as a part of our regulatory duties. Your personal information may be disclosed to other State agencies or third parties in the normal course of business or as needed to comply with statutory or regulatory requirements, including Freedom of Information Act requests. Our office will appropriately secure your personal information. If you have any questions about our use of your personal information, please contact DEP's Chief Privacy Officer at depprivacyofficer@wv.gov.

12/02/2016

STATE OF WEST VIRGINIA DEPARTMENT OF
ENVIRONMENTAL PROTECTION OFFICE OF OIL
AND GAS

FLUIDS/ CUTTINGS DISPOSAL & RECLAMATION PLAN

Operator Name Ross and Wharton Gas Company, Inc.

OP Code 305680

Watershed (HUC 10) Heather Fork Quadrangle Glenville

Elevation 1147 County Gilmer District Glenville

Do you anticipate using more than 5,000 bbls of water to complete the proposed well work? Yes _____ No X

Will a pit be used for drill cuttings? Yes _____ No X

If so, please describe anticipated pit waste: _____

Will a synthetic liner be used in the pit? Yes _____ No X If so, what ml.? _____

Proposed Disposal Method For Treated Pit Wastes:

- Land Application
- Underground Injection (UIC Permit Number _____)
- Reuse (at API Number _____)
- Off Site Disposal (Supply form WW-9 for disposal location)
- Other (Explain no fluids are expected in return all to be captured in tank)

*NO LAND APPLICATION.
ANY WELL EFFLUENT MUST BE CONTAINED
IN TANKS BEFORE DISPOSING OFF SITE. gnm*

Will closed loop system be used? _____

Drilling medium anticipated for this well? Air, freshwater, oil based, etc. _____

-If oil based, what type? Synthetic, petroleum, etc. _____

Additives to be used in drilling medium? _____

Drill cuttings disposal method? Leave in pit, landfill, removed offsite, etc. _____

-If left in pit and plan to solidify what medium will be used? (cement, lime, sawdust) _____

-Landfill or offsite name/permit number? _____

I certify that I understand and agree to the terms and conditions of the GENERAL WATER POLLUTION PERMIT issued on August 1, 2005, by the Office of Oil and Gas of the West Virginia Department of Environmental Protection. I understand that the provisions of the permit are enforceable by law. Violations of any term or condition of the general permit and/or other applicable law or regulation can lead to enforcement action.

I certify under penalty of law that I have personally examined and am familiar with the information submitted on this application form and all attachments thereto and that, based on my inquiry of those individuals immediately responsible for obtaining the information, I believe that the information is true, accurate, and complete. I am aware that there are significant penalties for submitting false information, including the possibility of fine or imprisonment.

Company Official Signature Mike Ross

Company Official (Typed Name) Mike Ross

Company Official Title C.O.B.

Subscribed and sworn before me this 14 day of October

Brenda K Bush

My commission expires September 27, 2020

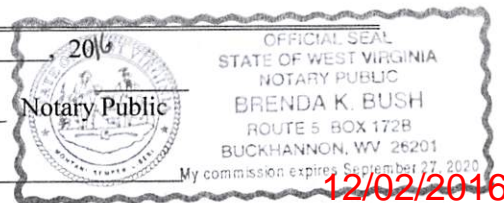

Proposed Revegetation Treatment: Acres Disturbed _____ Prevegetation Ph 6.0
0.5 _____

Lime _____ 2Tons/acre or to correct to pH _____

Fertilizer type _____ 10-20-20 _____

DM

Fertilizer amount _____ 500 lbs/acre

Mulch _____ 2 Tons/acre

Seed Mixtures

Temporary		Permanent	
Seed Type	lbs/acre	Seed Type	lbs/acre
KENTUCKY FESCUE	40	SAME	
ALSIKE CLOVER	5		
ANNUAL RYE	16		

Attach:

Drawing(s) of road, location, pit and proposed area for land application (unless engineered plans including this info have been provided)

Photocopied section of involved 7.5' topographic sheet.

Plan Approved by: _____

Comments: _____

Title: _____ Date: _____

Field Reviewed? () Yes () No

2102994f

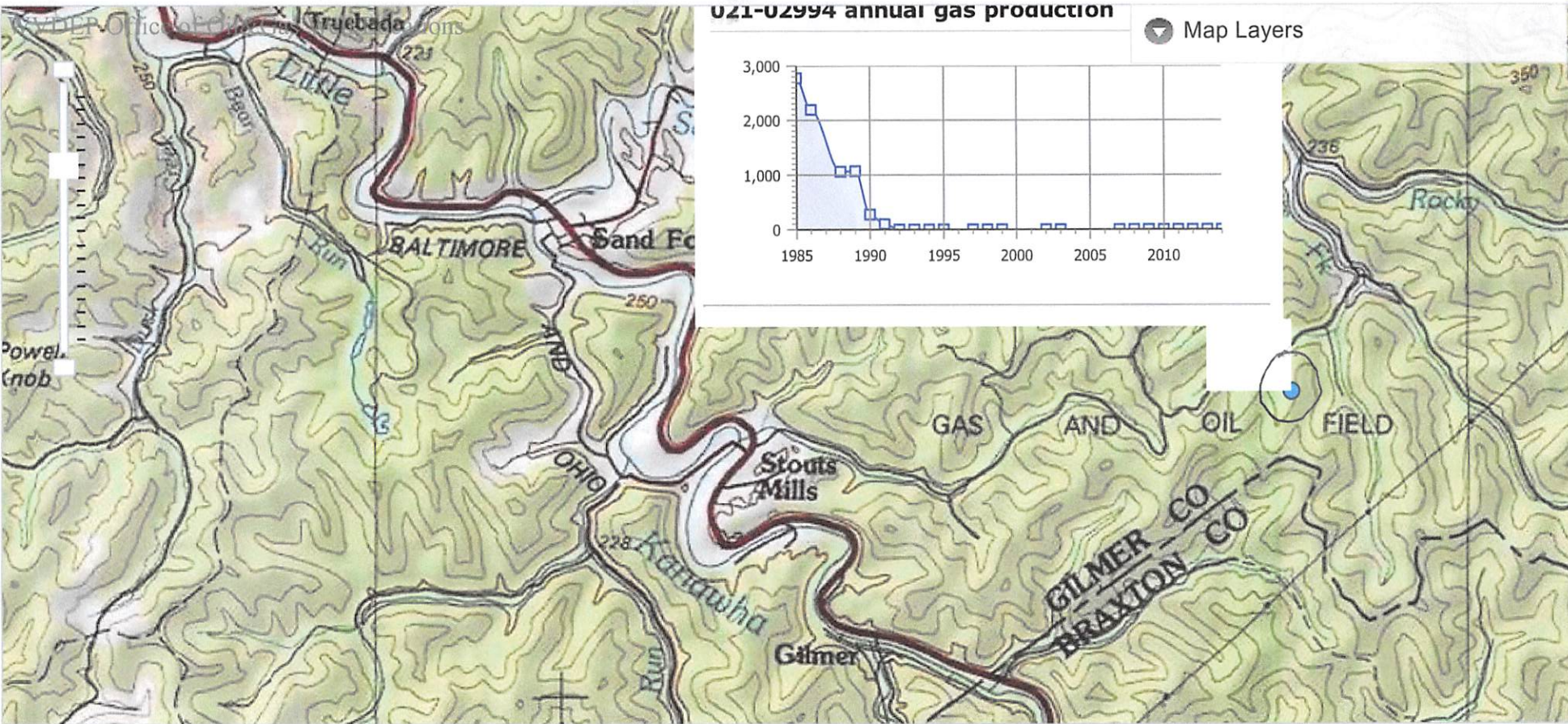

Attribute Search Result Table Location Search Legend About

WW-7
8-30-06



West Virginia Department of Environmental Protection
Office of Oil and Gas
WELL LOCATION FORM: GPS

API: 47-021-02994 WELL NO.: Marshall Barker #1

FARM NAME: Marshall Barker Estate

RESPONSIBLE PARTY NAME: Ross and Wharton Gas Company, Inc.

COUNTY: Gilmer DISTRICT: Glenville

QUADRANGLE: Gilmer

SURFACE OWNER: Peter Pawlowski

ROYALTY OWNER: French Barker

UTM GPS NORTHING: ~~4308843~~ 4305752

UTM GPS EASTING: ~~517645~~ 528423 GPS ELEVATION: 1147
8

The Responsible Party named above has chosen to submit GPS coordinates in lieu of preparing a new well location plat for a plugging permit or assigned API number on the above well. The Office of Oil and Gas will not accept GPS coordinates that do not meet the following requirements:

1. Datum: NAD 1983, Zone: 17 North, Coordinate Units: meters, Altitude: height above mean sea level (MSL) – meters.
2. Accuracy to Datum – 3.05 meters
3. Data Collection Method:

Survey grade GPS _____: Post Processed Differential _____

Real-Time Differential _____

Mapping Grade GPS : Post Processed Differential _____

Real-Time Differential _____

4. Letter size copy of the topography map showing the well location.

I the undersigned, hereby certify this data is correct to the best of my knowledge and belief and shows all the information required by law and the regulations issued and prescribed by the Office of Oil and Gas.

Mike Ross
Signature

C.O.B.
Title

10/14/16
Date

7015 1520 0000 0958 9237

U.S. Postal Service™
CERTIFIED MAIL® RECEIPT
Domestic Mail Only

For delivery information, visit our website at www.usps.com®.

OFFICIAL USE

Certified Mail Fee
 \$

Extra Services & Fees (check box, add fee as appropriate)

<input type="checkbox"/> Return Receipt (hardcopy)	\$
<input type="checkbox"/> Return Receipt (electronic)	\$
<input type="checkbox"/> Certified Mail Restricted Delivery	\$
<input type="checkbox"/> Adult Signature Required	\$
<input type="checkbox"/> Adult Signature Restricted Delivery	\$

Postage
 \$

Total Postage and Fees
 \$

Sent To Peter Pawlowski USPS

Street and Apt. No., or PO Box No.
6000 Heater Park Rd.

City, State, ZIP+4®
Chilenoille WV 26035

PS Form 3800, April 2015 PSN 7530-02-000-9047 See Reverse for Instructions

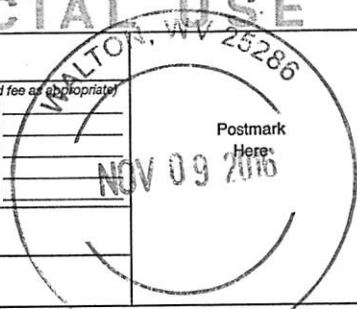

7015 1520 0000 0958 9237

U.S. Postal Service™
CERTIFIED MAIL® RECEIPT
Domestic Mail Only

For delivery information, visit our website at www.usps.com®.

OFFICIAL USE

Certified Mail Fee
 \$

Extra Services & Fees (check box, add fee as appropriate)

<input type="checkbox"/> Return Receipt (hardcopy)	\$
<input type="checkbox"/> Return Receipt (electronic)	\$
<input type="checkbox"/> Certified Mail Restricted Delivery	\$
<input type="checkbox"/> Adult Signature Required	\$
<input type="checkbox"/> Adult Signature Restricted Delivery	\$

Postage
 \$

Total Postage and Fees
 \$

Sent To Peter Pawlowski USPS

Street and Apt. No., or PO Box No.
6000 Heater Park Rd.

City, State, ZIP+4®
Chilenoille WV 26035

PS Form 3800, April 2015 PSN 7530-02-000-9047 See Reverse for Instructions

