

LATITUDE 38° 52' 30"

7 1/2'

LONGITUDE 81° 00'

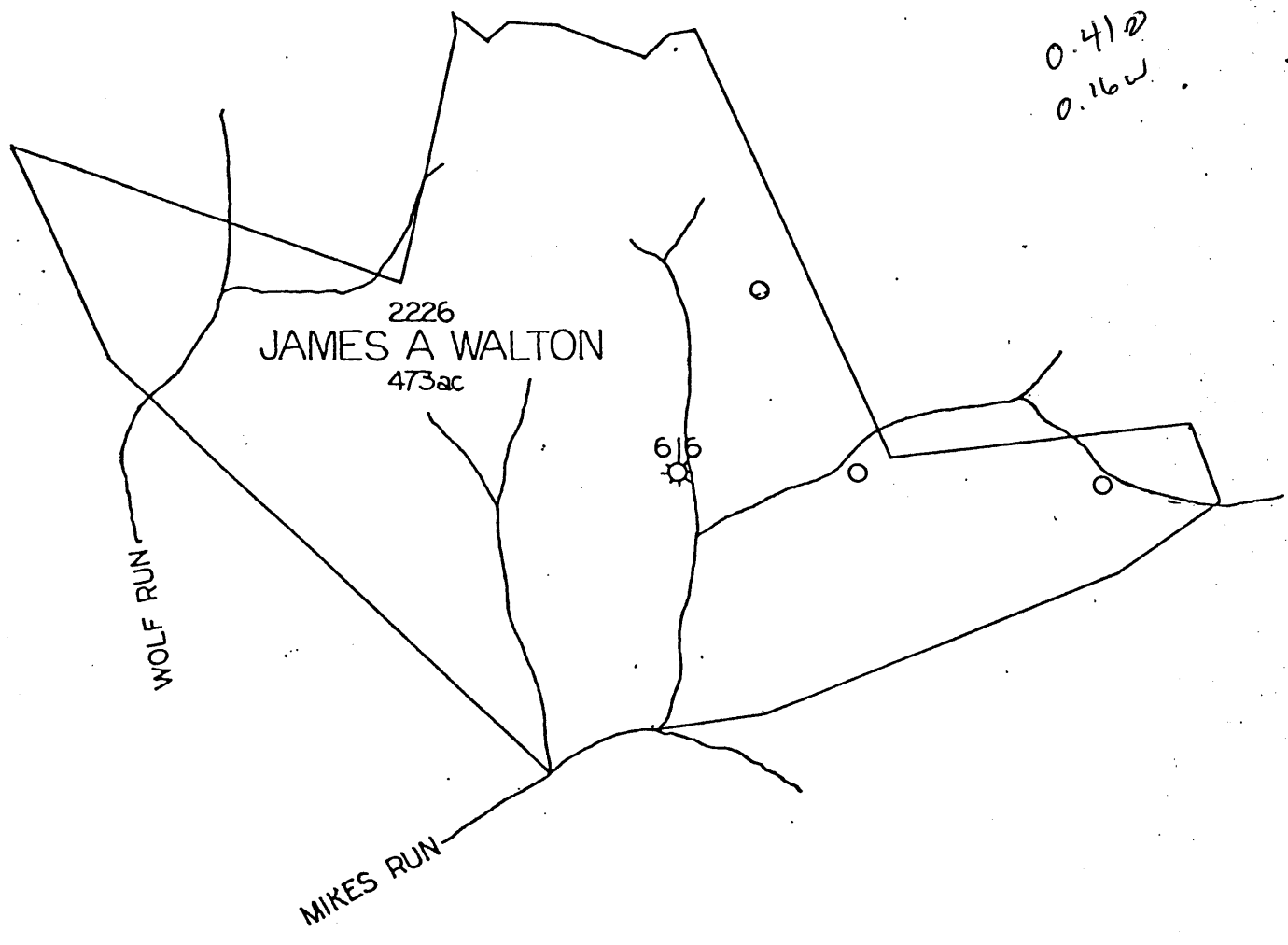

0.41 @
0.16 w

2226
JAMES A WALTON
473ac

616

SOUTHEASTERN GAS COMPANY
AND AFFILIATED COMPANIES
P. O. BOX 2347
CHARLESTON, W. VA. 25328

FILE NO. _____
 DRAWING NO. _____
 SCALE _____
 MINIMUM DEGREE OF ACCURACY _____
 PROVEN SOURCE OF ELEVATION _____

I THE UNDERSIGNED, HEREBY CERTIFY THAT THIS PLAT IS CORRECT TO THE BEST OF MY KNOWLEDGE AND BELIEF AND SHOWS ALL THE INFORMATION REQUIRED BY LAW AND THE REGULATIONS ISSUED AND PRESCRIBED BY THE DEPARTMENT OF MINES.
 (SIGNED) _____
 R.P.E. _____ L.L.S. _____

PLACE SEAL HERE

(+) DEMOTES LOCATION OF WELL ON UNITED STATES TOPOGRAPHIC MAPS
 FORM IV-6
 (8-78)



DATE _____, 19____
 OPERATOR'S WELL NO. _____
 API WELL NO. 47-021-3594
 STATE COUNTY PERMIT

STATE OF WEST VIRGINIA
 DEPARTMENT OF MINES
 OIL AND GAS DIVISION

WELL TYPE: OIL ___ GAS ___ LIQUID INJECTION ___ WASTE DISPOSAL ___
 (IF "GAS", PRODUCTION ___ STORAGE ___ DEEP ___ SHALLOW ___)
 LOCATION: ELEVATION _____ WATER SHED _____
 DISTRICT _____ COUNTY _____
 QUADRANGLE _____
 SURFACE OWNER _____ ACREAGE _____
 OIL & GAS ROYALTY OWNER _____ LEASE NO. _____ LEASE ACREAGE _____
 PROPOSED WORK: DRILL ___ CONVERT ___ DRILL DEEPER ___ REDRILL ___ FRACTURE OR STIMULATE ___ PLUS OFF OLD FORMATION ___ PERFORATE NEW FORMATION ___ OTHER PHYSICAL CHANGE IN WELL (SPECIFY) _____
 PLUS AND ABANDON ___ CLEAN OUT AND REPLUS ___
 TARGET FORMATION _____ ESTIMATED DEPTH _____
 WELL OPERATOR _____ DESIGNATED AGENT _____
 ADDRESS _____ ADDRESS _____