

LATITUDE 38° 52' 30"

7 1/2
0.16
2.25

LONGITUDE 80° 57' 30"

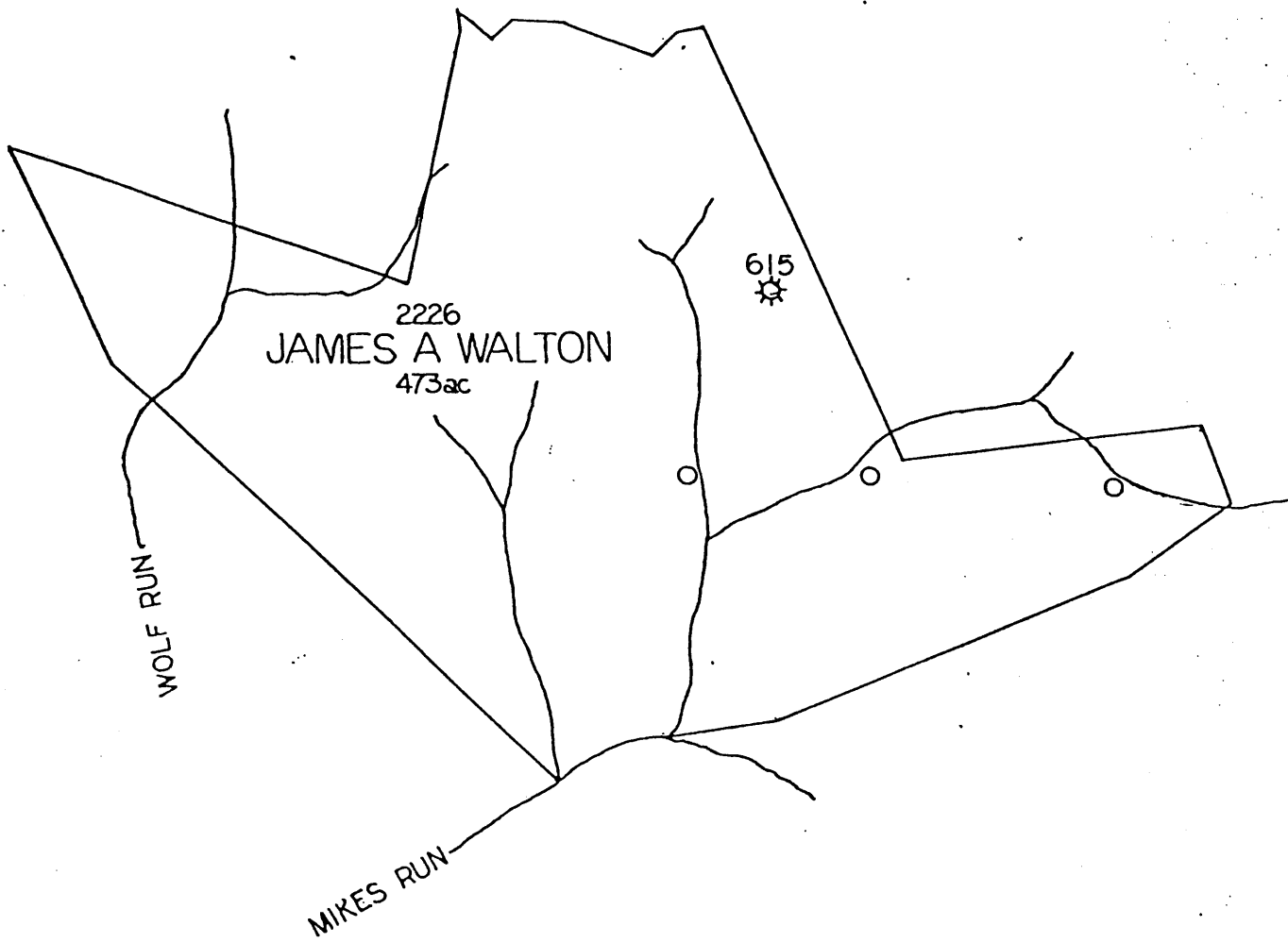

SOUTHEASTERN GAS COMPANY
AND AFFILIATED COMPANIES
P. O. BOX 2347
CHARLESTON, W. VA. 25328

FILE NO. _____
DRAWING NO. _____
SCALE _____
MINIMUM DEGREE OF
ACCURACY _____
PROVEN SOURCE OF
ELEVATION _____

I THE UNDERSIGNED, HEREBY CERTIFY
THAT THIS PLAT IS CORRECT TO THE
BEST OF MY KNOWLEDGE AND BELIEF AND
SHOWS ALL THE INFORMATION REQUIRED
BY LAW AND THE REGULATIONS ISSUED
AND PRESCRIBED BY THE DEPARTMENT OF
MINES.
(SIGNED) _____

R.P.F. _____ L.L.S. _____

PLACE SEAL HERE

(+) DENOTES LOCATION OF
WELL ON UNITED STATES
TOPOGRAPHIC MAPS
FORM IV-6
(8-78)



DATE _____, 19____
OPERATOR'S WELL NO. _____
API WELL NO.
47-021-3595
STATE COUNTY PERMIT

STATE OF WEST VIRGINIA
DEPARTMENT OF MINES
OIL AND GAS DIVISION

WELL TYPE: OIL ___ GAS ___ LIQUID INJECTION ___ WASTE DISPOSAL ___
(IF "GAS", PRODUCTION ___ STORAGE ___ DEEP ___ SHALLOW ___)
LOCATION: ELEVATION _____ WATER SHED _____
DISTRICT _____ COUNTY _____
QUADRANGLE _____

SURFACE OWNER _____ ACREAGE _____
OIL & GAS ROYALTY OWNER _____ LEASE NO. _____ LEASE ACREAGE _____

PROPOSED WORK: DRILL ___ CONVERT ___ DRILL DEEPER ___ REDRILL ___ FRACTURE OR
STIMULATE ___ PLUS OFF OLD FORMATION ___ PERFORATE NEW
FORMATION ___ OTHER PHYSICAL CHANGE IN WELL (SPECIFY) _____

PLUS AND ABANDON ___ CLEAN OUT AND REPLUS ___
TARGET FORMATION _____ ESTIMATED DEPTH _____
WELL OPERATOR _____ DESIGNATED AGENT _____
ADDRESS _____ ADDRESS _____

WELL NUMBER PERMITS TO DRILL AND WELLS COMPLETED, 1980

PERMIT NUMBER	WELL OPERATOR	FARM	WELL NUMBER	ELEV.	DISTRICT	TOTAL DEPTH	OIL-GAS DRY	DATE ISSUED	DATE COMPLETED	INITIAL OPERATOR FLOW GAS - Cu. f OIL - bbls
3577 -	Bowser Gas & Oil Company	Robert Hitchell	5		DeKalb					
3578 -	Pennzoil Company	F. S. Bennett	1		Center					
3579 -	Bell Oil & Gas	Lillie Wigner	1		Tanner					
3580 -	Southeastern Gas Company	Emma DeLong	613		Center					
3581 -	Southeastern Gas Company	Emma DeLong	614		Center					
3583 -	William Grambling	Miller - Bassett	1		DeKalb					
3584 -	Bowser Oil & Gas Company	Robert Hitchell	1		DeKalb					
3585 -	Bowser Oil & Gas Company	Robert Hitchell	3		DeKalb					
3587 -	Gilco Gas, Inc.	J. J. & O. W. Gerwig	2		Center					
3588 -	Gilco Gas, Inc.	J. J. & O. W. Gerwig	3		Center					
3589 -	Gilco Gas, Inc.	Artie Coberly	1		Center					
3590 -	Gilco Gas, Inc.	Viola Curry	1		Center					
3591 -	Gilco Gas, Inc.	T. J. & A. B. Smith	5		Center					
3592 -	Southeastern Gas Company	S. E. Minney	618		Center					
3593 -	Southeastern Gas Company	S. A. Hayes	617		Center					
3594 -	Southeastern Gas Company	Emma DeLong	616		Center					
3595 -	Southeastern Gas Company	Emma DeLong	615		Center					
3596	Simers Oil & Gas Company	Simers Oil & Gas Company	1		DeKalb					