

Latitude 38° 52' 30"

Longitude 80° 47' 30"

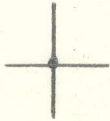

1.83a
1.63w

Topo Location

7.5' Loc. _____ 15' Loc. _____
_____ (calc.) _____

Company Carnegie Natural Gas Co.

Farm R.D. Stout # 1445

15' Quad _____
(sec.)

7.5' Quad Cedarville

District Center

WELL LOCATION PLAT

County 021 Permit 30035

Part of the ...
 U.S. D. Stout
 Location Center
 West Virginia Glenville Co. 1.
 June 1st. 32 Date 800' Elevation 1" = 800' Scale Loan #10696

Gil-35-A

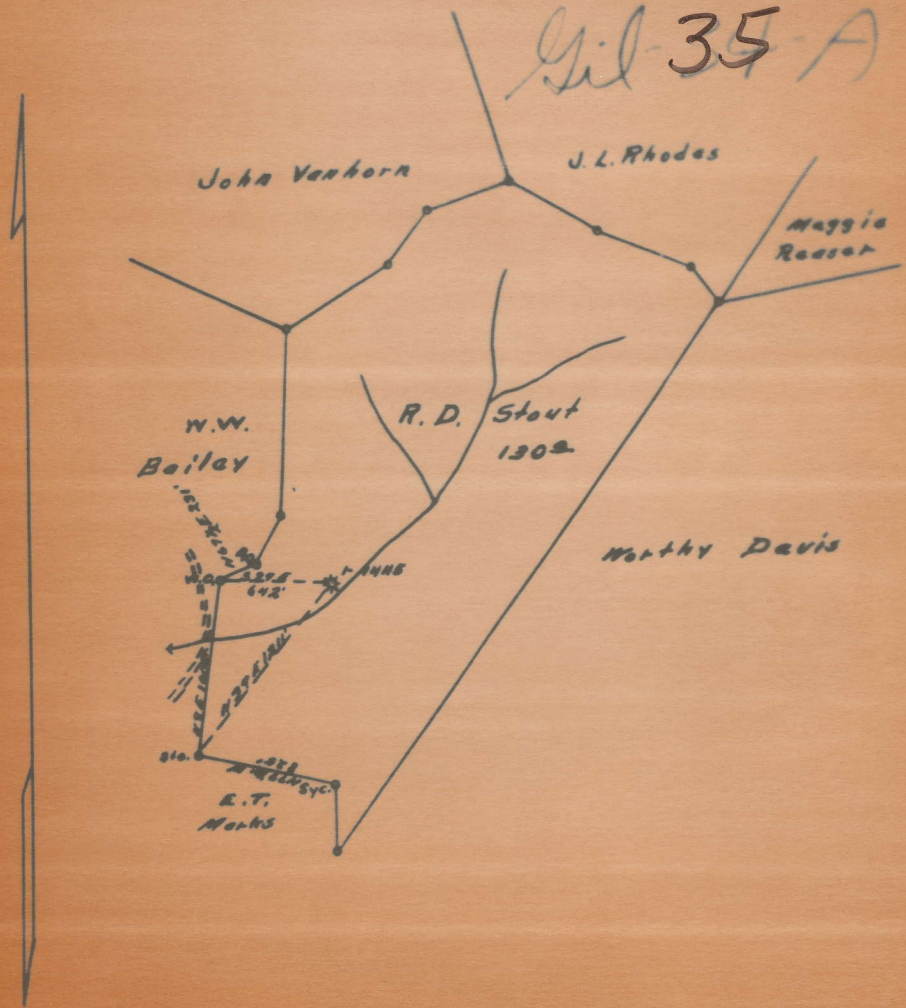

35-A

Center District, Gilmer County, W. Va. 35-A
 Carnegie Natural Gas Co., 962 Frick Bldg. Annex, Pittsburgh, Pa.
 On 135 acres, surface and mineral rights owned by R. D. Stout,
 Cedarville, W. Va.

Elevation, 800' B.

13" conductor, 16'; 10" casing, 72'; 8 1/4", 727' (pulled); 6-5/8", 1781'.

No coal was encountered.

Abandonment reported to Dept. of Mines June 15, 1932.

Well was shot at 1818-1824'.

Small gas well.

	Top.	Bottom.
Conductor	0	16
Little Dunkard Sand	600	610
Big Dunkard Sand	670	700
Gas Sand	735	825
1st Salt Sand	845	965
2nd Salt Sand	1095	1150
3rd Salt Sand	1420	1510
Maxton Sand (show of gas, 1648')	1625	1680
Little Lime	1700	1720
Pencil Cave	1720	1735
Big Lime	1745	1812
Keener Sand (gas, 1818-1822')	1812	1830
Big Injun Sand	1830	1905
Gantz? Sand (slate and shells)	1980	2100
50-Ft. Sand (slate and shells)	2200	2250
30-Ft. Sand (slate and shells)	2275	2325
Gordon Stray Sand (slate and shells)	2440	2445
Gordon Sand (slate and shells)	2460	2475
4th Sand (slate and shells)	2570	2575
5th Sand (slate and shells)	2645	2650
Total depth		2805

CARNEGIE NATURAL GAS
 982 Frick Building Annex,
 Pittsburgh, Penna.

Company
 Address

35-A

COMPLETION DATA SHEET
 NO. 2
 FORMATION RECORD

Well No. 1-1445 - Lease No. 12494

Name	Color	Character	Oil, Gas or Water	Top	Bottom	Thickness	Total Depth	Remarks
Conductor						16		
Little Dunkard				600	610			
Big Dunkard				670	700			
Gas Sand				735	825			
1st Salt Sand				845	965			
2nd Salt Sand				1095	1150			
3rd Salt Sand				1420	1510			
Maxton Sand			Show of Gas 1648	1625	1680			
Little Lime				1700	1720			
Pencil Cave				1720	1735			
Big Lime				1745	1812			
Keener Sand			Gas -1818 - 1822	1812	1830			
Big Injun				1830	1905			
Gantz Sand				1980	2100			Slate & Shells
50 Foot Sand				2200	2250			" "
30 Foot Sand				2275	2325			" "
Gordon Stray				2440	2445			" "
Gordon Sand				2460	2475			" "
4th Sand				2570	2575			" "
5th Sand				2645	2650			" "
							2805	

shot
 Well was ~~shot~~ at 1818 - 1824 feet well was shot at _____ feet.

WEST VIRGINIA DEPARTMENT OF MINES

Oil and Gas Section

Oil-35-A

PRELIMINARY DATA SHEET NO. 1

File No. _____ Lease #12494 _____ Well No. 1445 _____
 CARNEGIE NATURAL GAS Company of 962 Frick Building Annex,
 Pittsburgh, Pa. on the E. D. Stout Farm
 containing 135 acres Location _____
 Center District is Gilmer County, West Virginia
 The surface of the above tract is owned in fee by E. D. Stout
 of Cedarville, W. Va. address and the mineral rights are owned by

LAND

The oil and gas privileges are held under lease by the above named company and this well is drilled under permit No. _____ issued by the West Virginia Department of Mines, Oil and Gas Section.

11

Elevation of surface at top of well		800		Depth Barometric	
The number of feet of the different sized casings used in the well					
		14	feet	18	inches Wood conductor
72	feet	10	inches casing	feet	casing
727	feet	8 1/2	inches casing	feet	casing
1781	feet	6 3/8	inches casing	feet	casing
			packer of		inches, set at
			packer of		inches, set at
			in casing perforated at	feet to	feet
			in casing perforated at	feet to	feet
Coal was encountered at	8000	feet thickness		inches, and at	
feet thickness		inches and at		feet thickness	inches

Liners were used as follows: (Give details)

**AFFIDAVIT IN TRIPPLICATE TO TIME AND MANNER OF
PLUGGING AND FILLING WELL**
(REQUIRED BY SECTION 2, CHAPTER 22, ACTS 1922)
WEST VIRGINIA DEPARTMENT OF MINES
OIL AND GAS SECTION

35-A

No Coal	Carnegie Natural Gas Company,
COAL OPERATOR	960-Frick Building Annex, Pittsburgh, Pennsylvania.
ADDRESS	COMPLETE ADDRESS
COAL OPERATOR	November 22nd. 19 32
ADDRESS	WELL AND LOCATION
COAL OPERATOR	Center District
ADDRESS	Gilmer County
COAL OPERATOR	Well No. 1-1445
ADDRESS	R. D. Stout Farm

AFFIDAVIT TO BE MADE IN TRIPPLICATE. ONE COPY TO BE MAILED BY REGISTERED MAIL TO THE DEPARTMENT. ONE COPY TO BE RETAINED BY THE WELL OPERATOR AND THE THIRD COPY (AND EXTRA COPIES IF REQUIRED) TO BE MAILED TO EACH COAL OPERATOR ABOVE NAMED AT THEIR RESPECTIVE ADDRESSES.

AFFIDAVIT

STATE OF WEST VIRGINIA,

COUNTY OF Ritchie

} ss:

Edward L. DeLo and Luther Davis
being first duly sworn according to law depose and say that they are experienced in the work of plugging

and filling oil and gas wells and were employed by Carnegie Natural Gas Company, well operator, and participated in the work of plugging and filling the above well, that said work was commenced on the

27th day of September, 19 32, and that the well was plugged and filled in the following manner:

Manner in which said well was plugged: Filled hole from total depth 2905' with red mud to 1852' Drove 6 1/2" wood plug at 1852' to 1849' Filled hole with cement from 1849' to 1839' Filled hole with red mud from 1839' to 1798' Drove 6 1/2" wood plug at 1798' to 1795' Drove 6 1/2" lead plug at 1795' to 1793' Pulled 1367' of 6 1/2" casing, leaving in well 414' Filled hole with red from 1793' to 1480' Drove 6 1/2" wood plug at 1480' to 1477' Drove 6 1/2" lead plug at 1477' to 1475' Filled hole with cement from 1475' to 1465' Filled hole with red mud from 1465' to 825' Drove 8 1/2" wood plug at 825' to 821' Filled hole with red mud from 821' to 780' Filled hole with red mud & savings from 780' to 525' Drove 10" wood plug from 525' to 522' Filled hole with red mud from 522' to 82' Drove 10" wood plug at 82' to 78' Pulled 10" casing and filled hole with cement and red mud, Gas would not light when plugging was completed 11-16-1932

EDL
L.D.

We were not able to follow the Department of Mines instructions for a part of the plugging of this well on account of not being able to pull all of the 6 1/2" casing and also after pulling a part of the 6 1/2" casing the hole caved so badly we could not set all the plugs and cement as per instructions, however we were particular and did a good job as gas is completely shut off.

Description of monument: Concrete Monument 18" Square Base, 8" Square at Top, Three feet & 8 inches tall with Brass Tag secured to top with O. N. G. Co. #1445

(THE ABOVE DESCRIPTIONS MUST BE IN DETAIL AND IN ACCORDANCE WITH THE PROVISIONS OF SECTION 10, OIL AND GAS ACT OF 1922.)
and that the work of plugging and filling said well was completed on the 18th day of November,