

Latitude 39° 02' 30"

1.832  
2.09W

Longitude 80° 42' 30"

**Topo Location**

7.5' Loc. \_\_\_\_\_ 15' Loc. \_\_\_\_\_  
(calc.) \_\_\_\_\_

Company Litton Drilling Co

Farm Lydia Earl #1

15' Quad \_\_\_\_\_  
(sec.)

7.5' Quad Vadis

District Troy

**WELL LOCATION PLAT**

County 021 Permit 30057

Map showing Well #1 on Lydia Earl Farm of  
10 Acres Situate in Troy District, Gilmer Co.  
West Virginia, owned by Litton Drilling Co.  
of Charleston W. Va.

57-55A

57-A

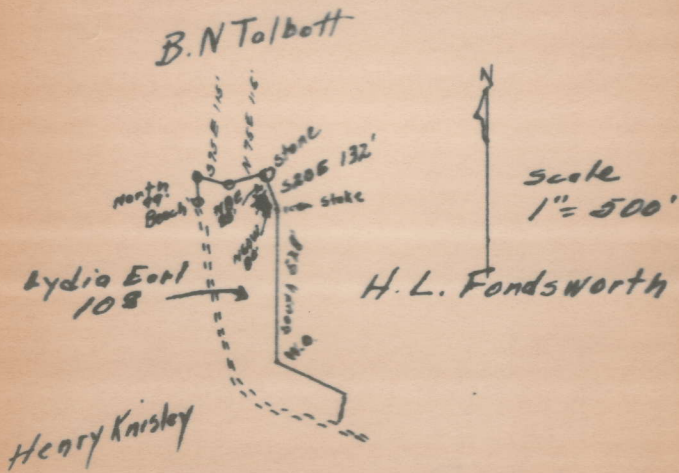

I, H.M. Livezey, do hereby certify that the above  
Map is correct and contains the information required  
by the Bureau of Mines.

H.M. Livezey

Sworn to and subscribed before me this 21 day of May 1934

My commission expires  
May 2nd, 1935.

W.A. Miller  
Notary Public



Troy District, Gilmer County, W. Va.  
 Litton Drilling Co., Charleston, W. Va. (Clint Litton, Pres.)  
 On 10 acres, surface owned by Lydia Earl, Troy, W. Va., and  
 mineral rights by Lydia Earl and John Hayes.

Drilled in 1923.

No elevation given.

13" casing, 127'; 10", 279'; 8 $\frac{1}{4}$ ", 455'; 6-5/8", 1474'.

Completion reported to Dept. of Mines, not dated, but filed May 23, 1934.

	Top.	Bottom.
Little Dunkard Sand	404	- 423
Big Dunkard Sand	485	- 520
Gas Sand	720	- 756
1st Salt Sand	852	- 887?
2nd Salt Sand	882?	- 942
3rd Salt Sand	1137	- 1229
Maxton Sand	1300	- 1322
Little Lime	1435	- 1452
Pencil Cave	1452	- 1457
Big Lime	1457	- 1575
Big Injun Sand	1575	- 1687
Total depth		1707



Litton Drilling Co.

Company

COMPLETION DATA SHEET

Charleston W. Va.

Address

NO. 2

Well No.

1 Earl

FORMATION RECORD

Name	Color	Character	Oil, Gas or Water	Top	Bottom	Thickness	Total Depth	Remarks
Little Dunkard				404	423	19		127- 279- 455-8
Big Dunkard				485	520	35		
Gas sand				720	756	36		
1st Salt sand				852	897	46		
2nd Salt sand				882	942	60		
3rd " "				1137	1229	92		
Maxton				1300	1322	22		
L Lime				1435	1452	17		
Pencil Cave				1452	1457	5		
Big Lime				1457	1575	118		
Big Injun				1575	1697	112		
Total Depth					1707			

shot Well was not shot at \_\_\_\_\_ feet; well was shot at \_\_\_\_\_ feet

Salt Fresh water at \_\_\_\_\_ feet; salt fresh water at \_\_\_\_\_ feet

producing Well was \_\_\_\_\_ hole  
dry

Litton Drilling Co.  
John Litton Pres

WEST VIRGINIA DEPARTMENT OF MINES

OIL AND GAS DIVISION

PRELIMINARY DATA SHEET NO. 1

Bill-57-1

Well No. 1

File No. \_\_\_\_\_ Company, of Charleston

\_\_\_\_\_ on the Lydia Earl Farm

containing 10 acres. Location \_\_\_\_\_

Troy District, in Gilmer County, West Virginia

The surface of the above tract is owned in fee by Lydia Earl

of Troy address, and the mineral rights are owned by

Lydia Earl and John Hayes of \_\_\_\_\_

The oil and gas privileges are held under lease by the above named company, and this well is drilled under permit

No. \_\_\_\_\_ issued by the West Virginia Department of Mines, Oil and Gas Division

Drilled 1923 \_\_\_\_\_ 193 \_\_\_\_\_

Elevation of surface at top of well, \_\_\_\_\_ Spirit Barometric.

The number of feet of the different sized casings used in the well.

\_\_\_\_\_ feet \_\_\_\_\_ size. Wood conductor.

127 feet 13" size, cag. 1474 feet N 5/8" sized cag.

279 feet 10" size, cag. \_\_\_\_\_ feet \_\_\_\_\_ sized cag.

455 feet 8 1/4" size, cag. \_\_\_\_\_ feet \_\_\_\_\_ sized cag.

\_\_\_\_\_ packer of \_\_\_\_\_ size, set at \_\_\_\_\_

\_\_\_\_\_ packer of \_\_\_\_\_ size, set at \_\_\_\_\_

\_\_\_\_\_ in casing perforated at \_\_\_\_\_ feet to \_\_\_\_\_ feet.

\_\_\_\_\_ in casing perforated at \_\_\_\_\_ feet to \_\_\_\_\_ feet.

Gas was encountered at \_\_\_\_\_ feet; thickness \_\_\_\_\_ inches, and at \_\_\_\_\_

feet; thickness \_\_\_\_\_ inches; and at \_\_\_\_\_ feet; thickness \_\_\_\_\_ inches.

Tools were used as follows: (Give details) \_\_\_\_\_

\_\_\_\_\_

Date \_\_\_\_\_

Approved Kitten Drilling Co. Owner.

5723/14



**AFFIDAVIT IN TRIPLICATE TO TIME AND MANNER OF  
PLUGGING AND FILLING WELL**

(REQUIRED BY SECTION 8, ARTICLE 4, CHAPTER 22 OF THE CODE)

**WEST VIRGINIA DEPARTMENT OF MINES  
OIL AND GAS DIVISION**

*U-53-A*

None	Litton Drilling Co.
<small>COAL OPERATOR OR OWNER</small>	<small>NAME OF WELL OPERATOR</small>
ADDRESS	Charleston, W. Va.
<small>COAL OPERATOR OR OWNER</small>	<small>COMPLETE ADDRESS</small>
ADDRESS	January 14, 1935 19
<small>COAL OPERATOR OR OWNER</small>	<small>WELL AND LOCATION</small>
ADDRESS	Troy District
<small>COAL OPERATOR OR OWNER</small>	Gilmer County
ADDRESS	Well No. 1
<small>COAL OPERATOR OR OWNER</small>	Lydia Earl Farm
ADDRESS	

AFFIDAVIT TO BE MADE IN TRIPLICATE. ONE COPY TO BE MAILED BY REGISTERED MAIL TO THE DEPARTMENT. ONE COPY TO BE RETAINED BY THE WELL OPERATOR AND THE THIRD COPY (AND EXTRA COPIES IF REQUIRED) TO BE MAILED TO EACH COAL OPERATOR ABOVE NAMED AT THEIR RESPECTIVE HOMES.

**AFFIDAVIT**

STATE OF WEST VIRGINIA,

COUNTY OF \_\_\_\_\_ } ss:

H. M. Livezey and D. D. Stephens  
being first duly sworn according to law depose and say that they are experienced in the work of plugging and filling oil and gas wells and were employed by Litton Drilling Co., well operator, and participated in the work of plugging and filling the above well, that said work was commenced on the 30 day of April, 1934, and that the well was plugged and filled in the following manner:

Manner in which said well was plugged: Filled with clay from 1620 to 1525, 1525 - 1522 wood plug, 1522 to 1512 cement  
Removed 6 5/8" casing and continued to fill with clay to 1415.  
1415 to 1405 cement  
Permanent bridge at 1259 and filled with clay to 1117, 1117 to 1107 cement.  
Permanent bridge at 972 and filled with clay to 801, 801 to 791 cement  
Permanent bridge at 540 and filled with clay to 485, 485 to 475 cement  
Filled to 390, Tried to pull 8 1/4" casing and parted it at 315.  
~~Placed plug in top of casing left in well and cemented to 300.~~  
Placed plug in top of casing left in well and cemented to 300.  
Filled to 276 and removed 10" casing.  
Continued to fill to surface.

Description of monument: Concrete marker with the name and number of well inscribed thereon.

(THE ABOVE DESCRIPTIONS MUST BE IN DETAIL AND IN ACCORDANCE WITH THE PROVISIONS OF SECTION 10, ARTICLE 4, CHAPTER 22 OF THE CODE.)

said that the work of plugging and filling said well was completed on the 6 day of June 1934 19  

And further deponents saith not.

*H. M. Livezey  
D. D. Stephens*