

Latitude 39° 07' 30"

Longitude 80° 42' 30"



2.05
1.17W

Topo Location

7.5' Loc. _____ 15' Loc. _____
_____ (calc.) _____

Company Hope Cons & Ref. Co.

Farm Lydia F. Gillespie # 1199

15' Quad _____
(sec.)

7.5' Quad Vadis

District Troy

WELL LOCATION PLAT

County 021 Permit 30069

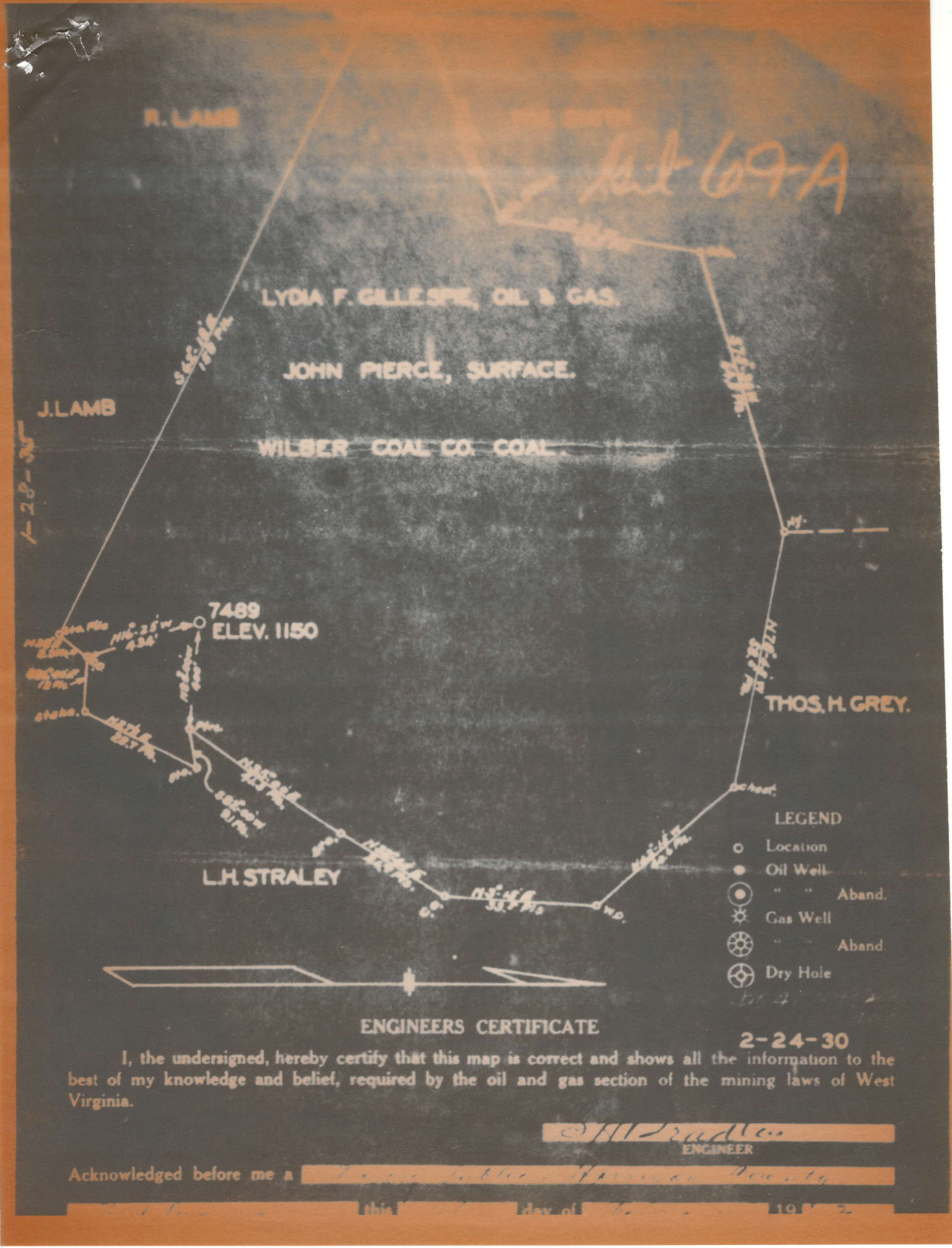

ENGINEERS CERTIFICATE

2-24-30

I, the undersigned, hereby certify that this map is correct and shows all the information to the best of my knowledge and belief, required by the oil and gas section of the mining laws of West Virginia.

H. Pradler
ENGINEER

Acknowledged before me a _____
 _____ this _____ day of _____ 19____

Troy District, Gilmer County, W. Va.
 Hope Cons. & Ref. Co.

69-A

On 140 acres, surface owned by John M. Pierce, Salem, W. Va., and mineral rights by Wilbur Coal & Coke Co., address unknown.

Drilled under permit issued Feb. 28, 1930.

Elevation, 1150' L.

10" casing, 150'; 8", 1111'; 6-5/8", 2125'.

Abandonment reported to Dept. of Mines, Jan. 24, 1935.

Well was shot at 2170-2176'.

No water recorded.

	Top.	Bottom.
Coal	105	109
Little Dunkard Sand	998	1014
Big Dunkard Sand	1090	1160
Gas Sand	1270	1320
First Salt Sand	1425	1515
Second Salt Sand	1640	1720
Third Salt Sand	1835	1989
Maxton Sand	2010	2025
Little Lime	2054	2067
Blue Monday Sand	2069	2093
Pencil Gave	2093	2098
Big Lime	2098	2153
Big Injun Sand (show gas, 2164'; oil, 2170-2176')		2153
Total depth		2200

Name	Color	Character	Oil, Gas or Water	Top	Bottom	Thickness	Total Depth	Remarks
Coal				105	109	4'		
Little Dunkard Sand				998	1014	16'		
Big Dunkard Sand				1090	1160	70'		
Gas Sand				1270	1320	50'		
First Salt Sand				1425	1515	90'		
Second Salt Sand				1640	1720	80'		
Third Salt Sand				1835	1909	74'		
Masses Sand				2010	2025	15'		
Little Lime				2054	2057	3'		
Blue Monday Sand				2059	2095	36'		
Pencil Cove				2095	2096	1'		
Big Lime				2098	2155	57'		
Big Injun Sand				2155			2155	
		Shed gas-2154-2111---2170-2175						

Well was not shut at _____ feet, well was shut at 2170-2175 feet

First water at _____ None reported feet, fresh water at _____ None reported feet

Well was _____ producing with flow exhausted to extent that it is no longer commercially productive.

January 25th, 1935. _____ Approved Hope Construction & Refining Company

WEST VIRGINIA DEPARTMENT OF MINES

OIL AND GAS DIVISION

PRELIMINARY DATA SHEET NO. 1

File No. _____ Well No. 1199

Hope Construction & Refining Company of 445 West Main St.

Clarksburg, W. Va., on the Lydia F. Gillispie Farm

containing 140 acres. Location _____

Troy District, in Gilmer County, West Virginia

The surface of the above tract is owned in fee by John M. Pietsch

of Salem, W. Va., address, and the mineral rights are owned by

Wilbur Coal & Coke Co. of Address Unknown.

The oil and gas privileges are held under lease by the above named company, and this well is drilled under permit

No. Hope Natural Gas Co., issued by the West Virginia Department of Mines, Oil and Gas Division

26th day of February 1930. 193 _____

Elevation of surface at top of well, 1180 Spirit Barometer

The number of feet of the different sized casings used in the well.

feet	size	Wood conductor.
<u>150</u>	<u>10"</u> size, csg. <u>1111</u>	<u>8 1/2"</u> sized csg.
<u>2125</u>	<u>6-5/8"</u> size, csg. <u>2200</u>	<u>2"</u> sized csg.
_____	_____ size, csg. _____	_____ sized csg.

_____ packer of _____ size, set at _____

_____ packer of _____ size, set at _____

_____ in casing perforated at _____ feet to _____ feet.

_____ in casing perforated at _____ feet to _____ feet.

Coal was encountered at 105 feet, thickness 48 inches, and at _____

feet; thickness _____ inches; and at _____ feet; thickness _____ inches.

Liners were used as follows: (Give details) _____

AFFIDAVIT IN TRIPLICATE TO TIME AND MANNER OF
PLUGGING AND FILLING WELLS

WEST VIRGINIA DEPARTMENT OF MINES
OIL AND GAS DIVISION

Wilbur Coal & Coke Company,

Hops Construction & Refining Company

Clarksburg, W. Va.,

Trig

Miller

1189

Lyons, Gallia Co.

AFFIDAVIT

STATE OF WEST VIRGINIA

County of Mingo

Being first of us sworn according to law before me and true to the best of our knowledge and belief

and filling oil and gas wells and were employed by said companies and participated in the work of plugging and filling the above well and well work was completed on the

11th day of November, 1937, and the work was plugged and filled in the following manner:

Manner in which said well was plugged: Filled with clay to 100 ft., 200 ft., 300 ft., 400 ft., 500 ft., 600 ft., 700 ft., 800 ft., 900 ft., 1000 ft., 1100 ft., 1200 ft., 1300 ft., 1400 ft., 1500 ft., 1600 ft., 1700 ft., 1800 ft., 1900 ft., 2000 ft., 2100 ft., 2200 ft., 2300 ft., 2400 ft., 2500 ft., 2600 ft., 2700 ft., 2800 ft., 2900 ft., 3000 ft., 3100 ft., 3200 ft., 3300 ft., 3400 ft., 3500 ft., 3600 ft., 3700 ft., 3800 ft., 3900 ft., 4000 ft., 4100 ft., 4200 ft., 4300 ft., 4400 ft., 4500 ft., 4600 ft., 4700 ft., 4800 ft., 4900 ft., 5000 ft., 5100 ft., 5200 ft., 5300 ft., 5400 ft., 5500 ft., 5600 ft., 5700 ft., 5800 ft., 5900 ft., 6000 ft., 6100 ft., 6200 ft., 6300 ft., 6400 ft., 6500 ft., 6600 ft., 6700 ft., 6800 ft., 6900 ft., 7000 ft., 7100 ft., 7200 ft., 7300 ft., 7400 ft., 7500 ft., 7600 ft., 7700 ft., 7800 ft., 7900 ft., 8000 ft., 8100 ft., 8200 ft., 8300 ft., 8400 ft., 8500 ft., 8600 ft., 8700 ft., 8800 ft., 8900 ft., 9000 ft., 9100 ft., 9200 ft., 9300 ft., 9400 ft., 9500 ft., 9600 ft., 9700 ft., 9800 ft., 9900 ft., 10000 ft., 10100 ft., 10200 ft., 10300 ft., 10400 ft., 10500 ft., 10600 ft., 10700 ft., 10800 ft., 10900 ft., 11000 ft., 11100 ft., 11200 ft., 11300 ft., 11400 ft., 11500 ft., 11600 ft., 11700 ft., 11800 ft., 11900 ft., 12000 ft., 12100 ft., 12200 ft., 12300 ft., 12400 ft., 12500 ft., 12600 ft., 12700 ft., 12800 ft., 12900 ft., 13000 ft., 13100 ft., 13200 ft., 13300 ft., 13400 ft., 13500 ft., 13600 ft., 13700 ft., 13800 ft., 13900 ft., 14000 ft., 14100 ft., 14200 ft., 14300 ft., 14400 ft., 14500 ft., 14600 ft., 14700 ft., 14800 ft., 14900 ft., 15000 ft., 15100 ft., 15200 ft., 15300 ft., 15400 ft., 15500 ft., 15600 ft., 15700 ft., 15800 ft., 15900 ft., 16000 ft., 16100 ft., 16200 ft., 16300 ft., 16400 ft., 16500 ft., 16600 ft., 16700 ft., 16800 ft., 16900 ft., 17000 ft., 17100 ft., 17200 ft., 17300 ft., 17400 ft., 17500 ft., 17600 ft., 17700 ft., 17800 ft., 17900 ft., 18000 ft., 18100 ft., 18200 ft., 18300 ft., 18400 ft., 18500 ft., 18600 ft., 18700 ft., 18800 ft., 18900 ft., 19000 ft., 19100 ft., 19200 ft., 19300 ft., 19400 ft., 19500 ft., 19600 ft., 19700 ft., 19800 ft., 19900 ft., 20000 ft., 20100 ft., 20200 ft., 20300 ft., 20400 ft., 20500 ft., 20600 ft., 20700 ft., 20800 ft., 20900 ft., 21000 ft., 21100 ft., 21200 ft., 21300 ft., 21400 ft., 21500 ft., 21600 ft., 21700 ft., 21800 ft., 21900 ft., 22000 ft., 22100 ft., 22200 ft., 22300 ft., 22400 ft., 22500 ft., 22600 ft., 22700 ft., 22800 ft., 22900 ft., 23000 ft., 23100 ft., 23200 ft., 23300 ft., 23400 ft., 23500 ft., 23600 ft., 23700 ft., 23800 ft., 23900 ft., 24000 ft., 24100 ft., 24200 ft., 24300 ft., 24400 ft., 24500 ft., 24600 ft., 24700 ft., 24800 ft., 24900 ft., 25000 ft., 25100 ft., 25200 ft., 25300 ft., 25400 ft., 25500 ft., 25600 ft., 25700 ft., 25800 ft., 25900 ft., 26000 ft., 26100 ft., 26200 ft., 26300 ft., 26400 ft., 26500 ft., 26600 ft., 26700 ft., 26800 ft., 26900 ft., 27000 ft., 27100 ft., 27200 ft., 27300 ft., 27400 ft., 27500 ft., 27600 ft., 27700 ft., 27800 ft., 27900 ft., 28000 ft., 28100 ft., 28200 ft., 28300 ft., 28400 ft., 28500 ft., 28600 ft., 28700 ft., 28800 ft., 28900 ft., 29000 ft., 29100 ft., 29200 ft., 29300 ft., 29400 ft., 29500 ft., 29600 ft., 29700 ft., 29800 ft., 29900 ft., 30000 ft., 30100 ft., 30200 ft., 30300 ft., 30400 ft., 30500 ft., 30600 ft., 30700 ft., 30800 ft., 30900 ft., 31000 ft., 31100 ft., 31200 ft., 31300 ft., 31400 ft., 31500 ft., 31600 ft., 31700 ft., 31800 ft., 31900 ft., 32000 ft., 32100 ft., 32200 ft., 32300 ft., 32400 ft., 32500 ft., 32600 ft., 32700 ft., 32800 ft., 32900 ft., 33000 ft., 33100 ft., 33200 ft., 33300 ft., 33400 ft., 33500 ft., 33600 ft., 33700 ft., 33800 ft., 33900 ft., 34000 ft., 34100 ft., 34200 ft., 34300 ft., 34400 ft., 34500 ft., 34600 ft., 34700 ft., 34800 ft., 34900 ft., 35000 ft., 35100 ft., 35200 ft., 35300 ft., 35400 ft., 35500 ft., 35600 ft., 35700 ft., 35800 ft., 35900 ft., 36000 ft., 36100 ft., 36200 ft., 36300 ft., 36400 ft., 36500 ft., 36600 ft., 36700 ft., 36800 ft., 36900 ft., 37000 ft., 37100 ft., 37200 ft., 37300 ft., 37400 ft., 37500 ft., 37600 ft., 37700 ft., 37800 ft., 37900 ft., 38000 ft., 38100 ft., 38200 ft., 38300 ft., 38400 ft., 38500 ft., 38600 ft., 38700 ft., 38800 ft., 38900 ft., 39000 ft., 39100 ft., 39200 ft., 39300 ft., 39400 ft., 39500 ft., 39600 ft., 39700 ft., 39800 ft., 39900 ft., 40000 ft., 40100 ft., 40200 ft., 40300 ft., 40400 ft., 40500 ft., 40600 ft., 40700 ft., 40800 ft., 40900 ft., 41000 ft., 41100 ft., 41200 ft., 41300 ft., 41400 ft., 41500 ft., 41600 ft., 41700 ft., 41800 ft., 41900 ft., 42000 ft., 42100 ft., 42200 ft., 42300 ft., 42400 ft., 42500 ft., 42600 ft., 42700 ft., 42800 ft., 42900 ft., 43000 ft., 43100 ft., 43200 ft., 43300 ft., 43400 ft., 43500 ft., 43600 ft., 43700 ft., 43800 ft., 43900 ft., 44000 ft., 44100 ft., 44200 ft., 44300 ft., 44400 ft., 44500 ft., 44600 ft., 44700 ft., 44800 ft., 44900 ft., 45000 ft., 45100 ft., 45200 ft., 45300 ft., 45400 ft., 45500 ft., 45600 ft., 45700 ft., 45800 ft., 45900 ft., 46000 ft., 46100 ft., 46200 ft., 46300 ft., 46400 ft., 46500 ft., 46600 ft., 46700 ft., 46800 ft., 46900 ft., 47000 ft., 47100 ft., 47200 ft., 47300 ft., 47400 ft., 47500 ft., 47600 ft., 47700 ft., 47800 ft., 47900 ft., 48000 ft., 48100 ft., 48200 ft., 48300 ft., 48400 ft., 48500 ft., 48600 ft., 48700 ft., 48800 ft., 48900 ft., 49000 ft., 49100 ft., 49200 ft., 49300 ft., 49400 ft., 49500 ft., 49600 ft., 49700 ft., 49800 ft., 49900 ft., 50000 ft., 50100 ft., 50200 ft., 50300 ft., 50400 ft., 50500 ft., 50600 ft., 50700 ft., 50800 ft., 50900 ft., 51000 ft., 51100 ft., 51200 ft., 51300 ft., 51400 ft., 51500 ft., 51600 ft., 51700 ft., 51800 ft., 51900 ft., 52000 ft., 52100 ft., 52200 ft., 52300 ft., 52400 ft., 52500 ft., 52600 ft., 52700 ft., 52800 ft., 52900 ft., 53000 ft., 53100 ft., 53200 ft., 53300 ft., 53400 ft., 53500 ft., 53600 ft., 53700 ft., 53800 ft., 53900 ft., 54000 ft., 54100 ft., 54200 ft., 54300 ft., 54400 ft., 54500 ft., 54600 ft., 54700 ft., 54800 ft., 54900 ft., 55000 ft., 55100 ft., 55200 ft., 55300 ft., 55400 ft., 55500 ft., 55600 ft., 55700 ft., 55800 ft., 55900 ft., 56000 ft., 56100 ft., 56200 ft., 56300 ft., 56400 ft., 56500 ft., 56600 ft., 56700 ft., 56800 ft., 56900 ft., 57000 ft., 57100 ft., 57200 ft., 57300 ft., 57400 ft., 57500 ft., 57600 ft., 57700 ft., 57800 ft., 57900 ft., 58000 ft., 58100 ft., 58200 ft., 58300 ft., 58400 ft., 58500 ft., 58600 ft., 58700 ft., 58800 ft., 58900 ft., 59000 ft., 59100 ft., 59200 ft., 59300 ft., 59400 ft., 59500 ft., 59600 ft., 59700 ft., 59800 ft., 59900 ft., 60000 ft., 60100 ft., 60200 ft., 60300 ft., 60400 ft., 60500 ft., 60600 ft., 60700 ft., 60800 ft., 60900 ft., 61000 ft., 61100 ft., 61200 ft., 61300 ft., 61400 ft., 61500 ft., 61600 ft., 61700 ft., 61800 ft., 61900 ft., 62000 ft., 62100 ft., 62200 ft., 62300 ft., 62400 ft., 62500 ft., 62600 ft., 62700 ft., 62800 ft., 62900 ft., 63000 ft., 63100 ft., 63200 ft., 63300 ft., 63400 ft., 63500 ft., 63600 ft., 63700 ft., 63800 ft., 63900 ft., 64000 ft., 64100 ft., 64200 ft., 64300 ft., 64400 ft., 64500 ft., 64600 ft., 64700 ft., 64800 ft., 64900 ft., 65000 ft., 65100 ft., 65200 ft., 65300 ft., 65400 ft., 65500 ft., 65600 ft., 65700 ft., 65800 ft., 65900 ft., 66000 ft., 66100 ft., 66200 ft., 66300 ft., 66400 ft., 66500 ft., 66600 ft., 66700 ft., 66800 ft., 66900 ft., 67000 ft., 67100 ft., 67200 ft., 67300 ft., 67400 ft., 67500 ft., 67600 ft., 67700 ft., 67800 ft., 67900 ft., 68000 ft., 68100 ft., 68200 ft., 68300 ft., 68400 ft., 68500 ft., 68600 ft., 68700 ft., 68800 ft., 68900 ft., 69000 ft., 69100 ft., 69200 ft., 69300 ft., 69400 ft., 69500 ft., 69600 ft., 69700 ft., 69800 ft., 69900 ft., 70000 ft., 70100 ft., 70200 ft., 70300 ft., 70400 ft., 70500 ft., 70600 ft., 70700 ft., 70800 ft., 70900 ft., 71000 ft., 71100 ft., 71200 ft., 71300 ft., 71400 ft., 71500 ft., 71600 ft., 71700 ft., 71800 ft., 71900 ft., 72000 ft., 72100 ft., 72200 ft., 72300 ft., 72400 ft., 72500 ft., 72600 ft., 72700 ft., 72800 ft., 72900 ft., 73000 ft., 73100 ft., 73200 ft., 73300 ft., 73400 ft., 73500 ft., 73600 ft., 73700 ft., 73800 ft., 73900 ft., 74000 ft., 74100 ft., 74200 ft., 74300 ft., 74400 ft., 74500 ft., 74600 ft., 74700 ft., 74800 ft., 74900 ft., 75000 ft., 75100 ft., 75200 ft., 75300 ft., 75400 ft., 75500 ft., 75600 ft., 75700 ft., 75800 ft., 75900 ft., 76000 ft., 76100 ft., 76200 ft., 76300 ft., 76400 ft., 76500 ft., 76600 ft., 76700 ft., 76800 ft., 76900 ft., 77000 ft., 77100 ft., 77200 ft., 77300 ft., 77400 ft., 77500 ft., 77600 ft., 77700 ft., 77800 ft., 77900 ft., 78000 ft., 78100 ft., 78200 ft., 78300 ft., 78400 ft., 78500 ft., 78600 ft., 78700 ft., 78800 ft., 78900 ft., 79000 ft., 79100 ft., 79200 ft., 79300 ft., 79400 ft., 79500 ft., 79600 ft., 79700 ft., 79800 ft., 79900 ft., 80000 ft., 80100 ft., 80200 ft., 80300 ft., 80400 ft., 80500 ft., 80600 ft., 80700 ft., 80800 ft., 80900 ft., 81000 ft., 81100 ft., 81200 ft., 81300 ft., 81400 ft., 81500 ft., 81600 ft., 81700 ft., 81800 ft., 81900 ft., 82000 ft., 82100 ft., 82200 ft., 82300 ft., 82400 ft., 82500 ft., 82600 ft., 82700 ft., 82800 ft., 82900 ft., 83000 ft., 83100 ft., 83200 ft., 83300 ft., 83400 ft., 83500 ft., 83600 ft., 83700 ft., 83800 ft., 83900 ft., 84000 ft., 84100 ft., 84200 ft., 84300 ft., 84400 ft., 84500 ft., 84600 ft., 84700 ft., 84800 ft., 84900 ft., 85000 ft., 85100 ft., 85200 ft., 85300 ft., 85400 ft., 85500 ft., 85600 ft., 85700 ft., 85800 ft., 85900 ft., 86000 ft., 86100 ft., 86200 ft., 86300 ft., 86400 ft., 86500 ft., 86600 ft., 86700 ft., 86800 ft., 86900 ft., 87000 ft., 87100 ft., 87200 ft., 87300 ft., 87400 ft., 87500 ft., 87600 ft., 87700 ft., 87800 ft., 87900 ft., 88000 ft., 88100 ft., 88200 ft., 88300 ft., 88400 ft., 88500 ft., 88600 ft., 88700 ft., 88800 ft., 88900 ft., 89000 ft., 89100 ft., 89200 ft., 89300 ft., 89400 ft., 89500 ft., 89600 ft., 89700 ft., 89800 ft., 89900 ft., 90000 ft., 90100 ft., 90200 ft., 90300 ft., 90400 ft., 90500 ft., 90600 ft., 90700 ft., 90800 ft., 90900 ft., 91000 ft., 91100 ft., 91200 ft., 91300 ft., 91400 ft., 91500 ft., 91600 ft., 91700 ft., 91800 ft., 91900 ft., 92000 ft., 92100 ft., 92200 ft., 92300 ft., 92400 ft., 92500 ft., 92600 ft., 92700 ft., 92800 ft., 92900 ft., 93000 ft., 93100 ft., 93200 ft., 93300 ft., 93400 ft., 93500 ft., 93600 ft., 93700 ft., 93800 ft., 93900 ft., 94000 ft., 94100 ft., 94200 ft., 94300 ft., 94400 ft., 94500 ft., 94600 ft., 94700 ft., 94800 ft., 94900 ft., 95000 ft., 95100 ft., 95200 ft., 95300 ft., 95400 ft., 95500 ft., 95600 ft., 95700 ft., 95800 ft., 95900 ft., 96000 ft., 96100 ft., 96200 ft., 96300 ft., 96400 ft., 96500 ft., 96600 ft., 96700 ft., 96800 ft., 96900 ft., 97000 ft., 97100 ft., 97200 ft., 97300 ft., 97400 ft., 97500 ft., 97600 ft., 97700 ft., 97800 ft., 97900 ft., 98000 ft., 98100 ft., 98200 ft., 98300 ft., 98400 ft., 98500 ft., 98600 ft., 98700 ft., 98800 ft., 98900 ft., 99000 ft., 99100 ft., 99200 ft., 99300 ft., 99400 ft., 99500 ft., 99600 ft., 99700 ft., 99800 ft., 99900 ft., 100000 ft.

Manner in which said well was plugged

Description: concrete monument 1 ft. in height, 6 in. in diameter and 2 ft. in diameter, also a ground, surface, and a well, erected.

and that the work of plugging and filling said well was completed on the 11th day of November, 1937.

1937