

No. 1000 E.L.A. 111
 HARRIS CONSTRUCTION REFINING Co. of the
 John A. Jeffries Parkersburg, W. Va. on the
 Troy _____ Parkersburg, W. Va. Pure consisting of 60 Acres
 _____ County, W. Va.

Kil-83-A

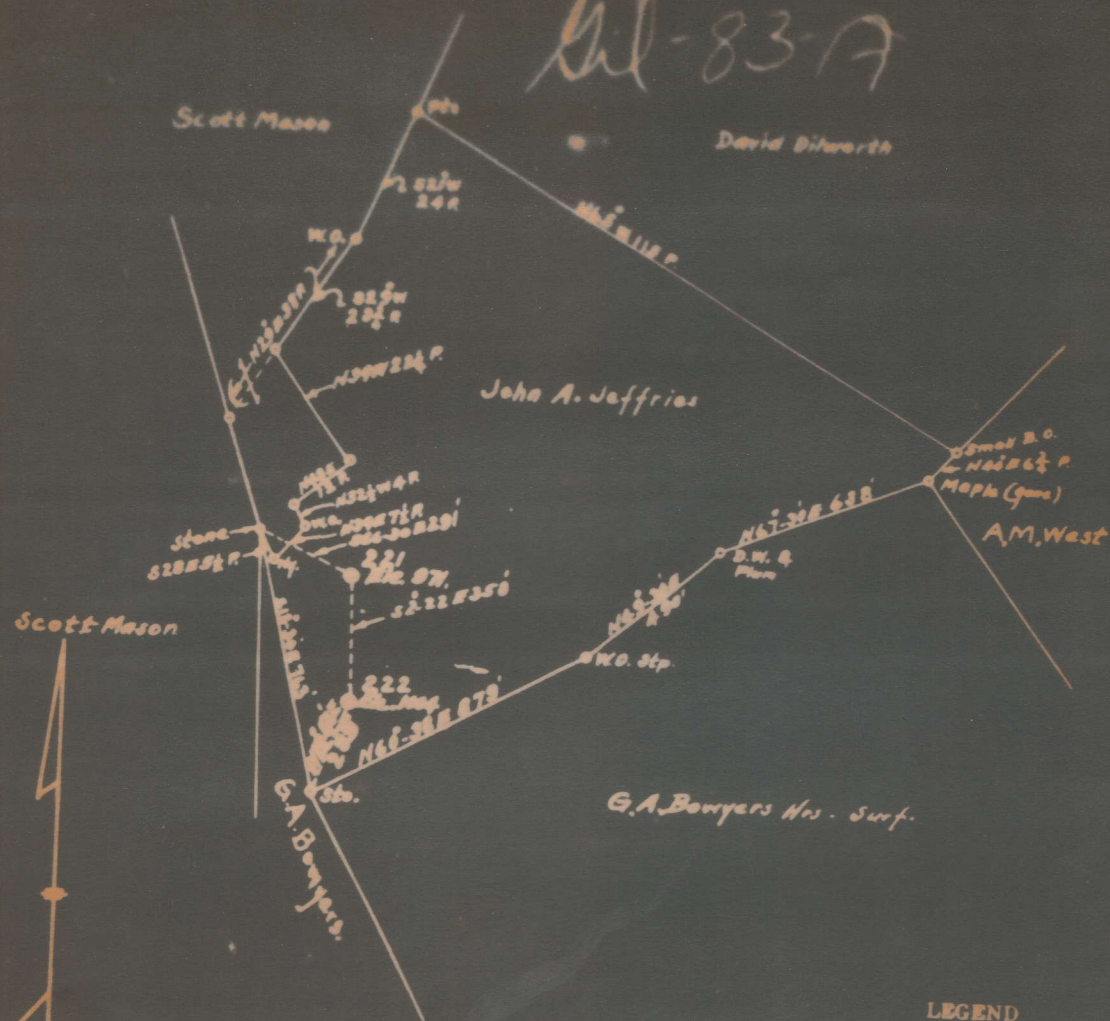

- LEGEND**
 ○ Location
 ● Oil Well
 ⊙ " " Aband.
 ⊛ Gas Well
 ⊙ " " Aband.
 ⊕ Dry Hole
 Field Book No. 111
 Book "M 111"

221-305-36

83-A

Troy District, Gilmer County, W. Va.

By Hope Construction & Refining Co., 445 W. Main St.,
Clarksburg, W. Va.

On 41 acres, surface and mineral rights owned by J. A. Jeffries,
Weston, W. Va. (Inmate, Weston Hospital for Insane).

Elevation, 971' L.

10" casing, 160' (pulled); 8 1/4", 887'; 6-5/8", 1935'; 2" tubing, 2273'.

No coal was encountered.

Abandonment reported to Dept. of Mines March 13, 1936.

Well was shot at 2251-2265'.

No water recorded.

	Top.	Bottom.	Thickness.
Sand	120 -	135	15
Sand	260 -	280	20
Sand	410 -	450	40
Little Dunkard Sand	708 -	750	42
Big Dunkard Sand	865 -	930	65
Gas Sand	1005 -	1090	85
Sand?	1195 -	1255	60
Sand	1290 -	1340	50
Salt Sand (show gas, 1445')	1430 -	1473	43
Sand	1630 -	1650	20
Red rock	1650 -	1748	98
Little Lime	1750 -	1782	32
Big Lime	1790 -	1853	63
Big Injun Sand	1853 -	1960	107
Squaw Sand	2050 -	2200	150
Gantz?(Berea) Sand (oil, 2251-2265'; gas, 2265')	2245 -	2271	26
Total depth		2273	

Boys Construction & Drilling Co., Company

COMPLETION DATA SHEET

Clarksburg, W. Va., Address

No. 2

Well No. 221

Owner J. A. Jettles

FORMATION RECORD

Name	Color	Character	Oil, Gas or Water	Top	Bottom	Thickness	Total Depth	Remarks
Sand				130	135	15'		
Sand				260	260	20'		
Sand				410	450	40'		
Little Dunkard Sand				708	750	42'		
Big Dunkard Sand				865	930	65'		
Gas Sand				1005	1090	85'		
Sand				1195	1255	60'		
				1290	1340	50'		
Salt Sand			SNOW gas 1445	1430	1473	43'		
Sand				1630	1650	20'		
Red Rock				1650	1748	98'		
Little Lime				1750	1782	32'		
Big Lime				1790	1853	63'		
Big Injun Sand				1853	1960	107'		
Squaw Sand				2050	2200	150'		
Gantz Sand				2245	2271	26'	2273	
			Oil-2251-2265 Gas-2265					

Well was shot at _____ feet; well was shot at 2251-2265 feet. Sect.

Salt water at _____ feet; fresh water at _____ feet. Sect.

None recorded None recorded

AFFIDAVIT IN TRIPLICATE TO TIME AND MANNER OF PLUGGING AND FILLING WELL

(REQUIRED BY SECTION 9, ARTICLE 4, CHAPTER 22 OF THE CODE)

WEST VIRGINIA DEPARTMENT OF MINES OIL AND GAS DIVISION

Well not in coal area.

Hope Construction & Refining Company

COAL OPERATOR OR OWNER

NAME OF WELL OPERATOR

ADDRESS

COMPLETE ADDRESS

COAL OPERATOR OR OWNER

WELL AND LOCATION

ADDRESS

Troy

Gilmer

LEASE OR PROPERTY OWNER

Well No. 221

ADDRESS

J. A. Jeffries

AFFIDAVIT TO BE MADE IN TRIPLICATE, ONE COPY TO BE MAILED BY REGISTERED MAIL TO THE DEPARTMENT, ONE COPY TO BE DELIVERED TO THE COAL OPERATOR AND THE THIRD COPY (AND EXTRA COPIES IF REQUIRED) TO BE MAILED TO EACH COAL OPERATOR ABOVE NAMED BY THEIR COMPANY.

AFFIDAVIT

STATE OF WEST VIRGINIA,

COUNTY OF LEWIS

vs:

JOHN L. ASH and MINKI B. WHITE

being first duly sworn according to law depose and say that they are experienced in the work of plugging and filling oil and gas wells and were employed by HOPE CONSTRUCTION & REFINING COMPANY

and participated in the work of plugging and filling the above well, that said work was commenced on the

22nd day of APRIL, 1935, and that the well was plugged and filled in the following manner:

Manner in which said well was plugged: Filled with clay from 2273' to 2255' and set cement plug at 2255'. Installed permanent bridge at 1945' and drove sand plug filled up solid with clay to 1875' and drove lead coal plug, installed cement bridge at 1705' and filled with clay to 1485'. Installed bridge at 1405' and drove sand plug Clay to 875' and drove 8" lead plug, filled up solid to 875' and set cement plug at 875'. Filled up solid to the surface with clay and stone.

Description of monument: concrete monument erected over the hole 3' in diameter 24' underground and 24' above ground.

and that the work of plugging and filling said well was completed on the 12th day of