

Latitude 39 00

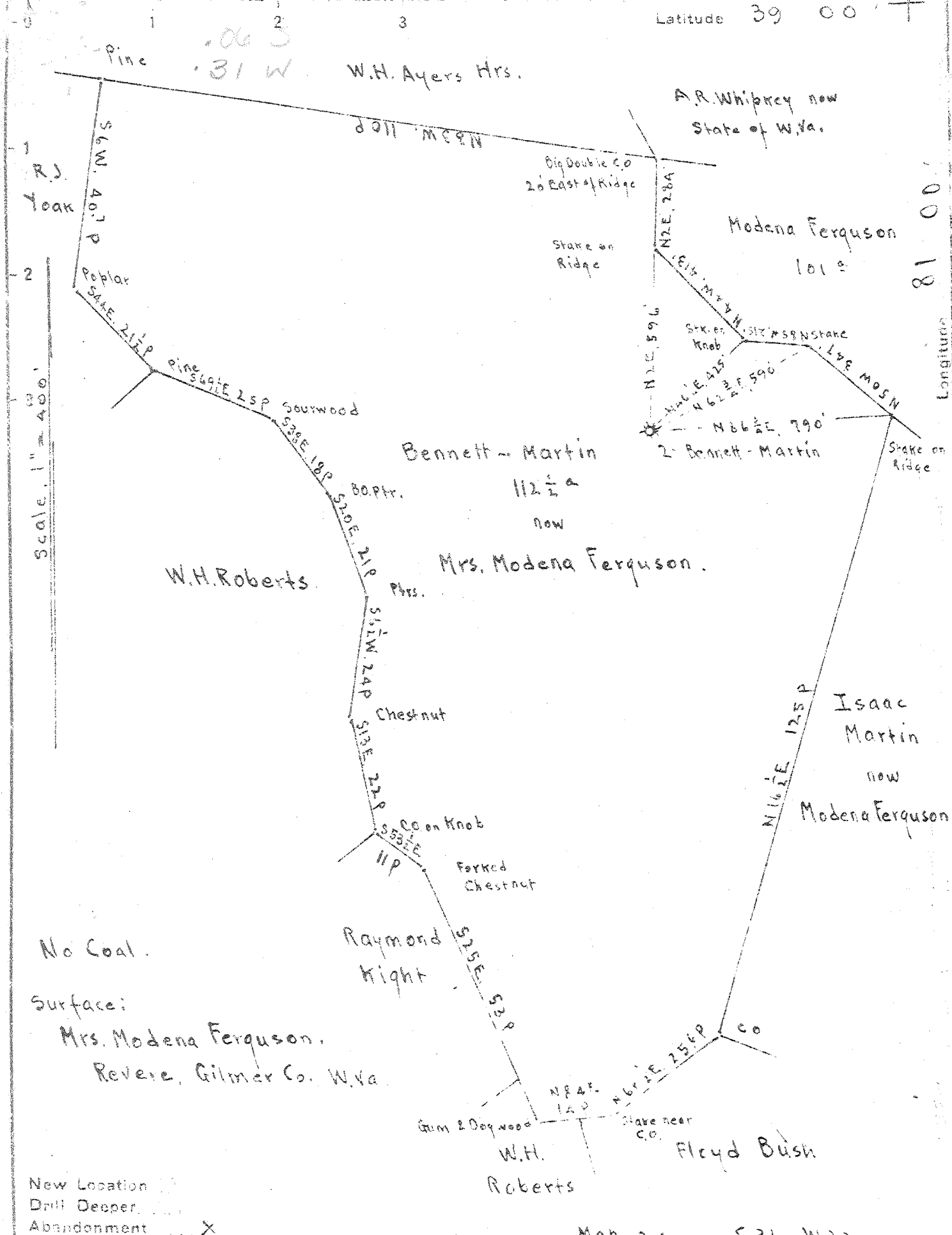

No Coal.

Surface:
Mrs. Modena Ferguson.
Revere, Gilmer Co. W.Va.

New Location
Drill Deeper
Abandonment

Company	Z. D. Conley Road Supply Co.	
Address	Salem, W. Va. GRANISVILLE, W. Va.	
Farm	Bennett - Martin	
Tract	Acres 112 1/2	Lease No.
Well (Farm) No.	2	Serial No.
Elevation (Spirit Level)	Floor 1113.51	Ground 1114.01
Quadrangle	Arnoldsburg	
County	Gilmer	District De Kalb
Engineer	E. C. Tabler	
Engineer's Registration No.		
File No.	Drawing No.	
Date	July 15 th 1946 Scale 1" = 400'	

STATE OF WEST VIRGINIA
DEPARTMENT OF MINES
OIL AND GAS DIVISION
CHARLESTON

WELL LOCATION MAP

FILE NO. GIL-230-A

+ Denotes location of well on United States Topographic Maps, scale 1 to 62,500, latitude and longitude lines being represented by border lines as shown.
- Denotes one inch spaces on border line of original tracing.

BENNETT-MARTIN NO. 2 WELL.

Dekalb District, Gilmer County, W. Va.

By Z. N. Connolly, Grantsville, W. Va.

Abandoned under permit Gil-230-A.

On 112 $\frac{1}{2}$ acres.

Elevation, 1114.01' L.

Surface owned by Mrs. Modena Ferguson, Revere, W. Va.

10" casing, 245'; 8 $\frac{1}{4}$ " tubing, 1125'; 2" tubing, 1225'; all left in.

No coal was encountered.

Gas well. Abandonment reported to Dept. of Mines Oct. 30, 1946.

Record to RCT from Mrs. Griffith Nov. 26, 1947. Old File No. 394.

	Top.	Bottom.
Conductor	0	15
Big Dunkard Sand (gas, 1160-1167 and 1211-1225')	1122	1239
Total depth		1245



STATE OF WEST VIRGINIA
DEPARTMENT OF MINES
OIL AND GAS DIVISION

394

WELL RECORD

Permit No. 230-A

Oil or Gas Well (KIND)

Company Mr. Z. N. Conley
Address Grantsville, W. Va.
Farm Bennett-Martin Acres 112 1/2
Location (waters).....
Well No. 2 Elev. 1114.01
District DeKalb County Gilmer
The surface of tract is owned in fee by Mrs. Modena Ferguson Address Revere, W. Va.
Mineral rights are owned by NO COAL
Address.....

Drilling commenced.....
Drilling completed.....
Date Shot From To
With.....

Open Flow /10ths Water in..... Inch
/10ths Merc. in..... Inch
Volume..... Cu. Ft.
Rock Pressure..... lbs..... hrs.
Oil..... bbls., 1st 24 hrs.
Fresh water..... feet..... feet
Salt water..... feet..... feet

Casing and Tubing	Used in Drilling	Left in Well	Packers
Size			
16.....			Kind of Packer.....
13.....			
10.....	245'	245'	Size of.....
8 1/4.....	1125'	1125'	
6%.....			Depth set.....
5 3/16.....			
3.....			Perf. top.....
2.....	1225'	1225'	Perf. bottom.....
Liners Used.....			Perf. top.....
			Perf. bottom.....

CASING CEMENTED..... SIZE..... No. Ft..... Date.....

COAL WAS ENCOUNTERED AT None FEET..... INCHES
..... FEET..... INCHES..... FEET..... INCHES
..... FEET..... INCHES..... FEET..... INCHES

Formation	Color	Hard or Soft	Top	Bottom	Oil, Gas or Water	Depth Found	Remarks
Conductor				15			
Big Dunkard Sand			1122	1239			
Gas			1160	1167	Gas		
Gas			1211	1225	Gas		
Total Depth				1245			

