

Latitude 38° 55' 00"



0.390  
0.94W

Longitude 80° 57' 30"

Topo Location

7.5' Loc. \_\_\_\_\_ 15' Loc. \_\_\_\_\_  
\_\_\_\_\_ (calc.) \_\_\_\_\_

Company Carnegie Nat. Gas Co.

Farm W. D. Jones (E-1082)

15' Quad \_\_\_\_\_  
(sec.)

7.5' Quad Tanner

District DeKalb

WELL LOCATION PLAT

County 021 Permit 30398

Longitude 80° 35'

2  
3

MARY FITZPATRICK

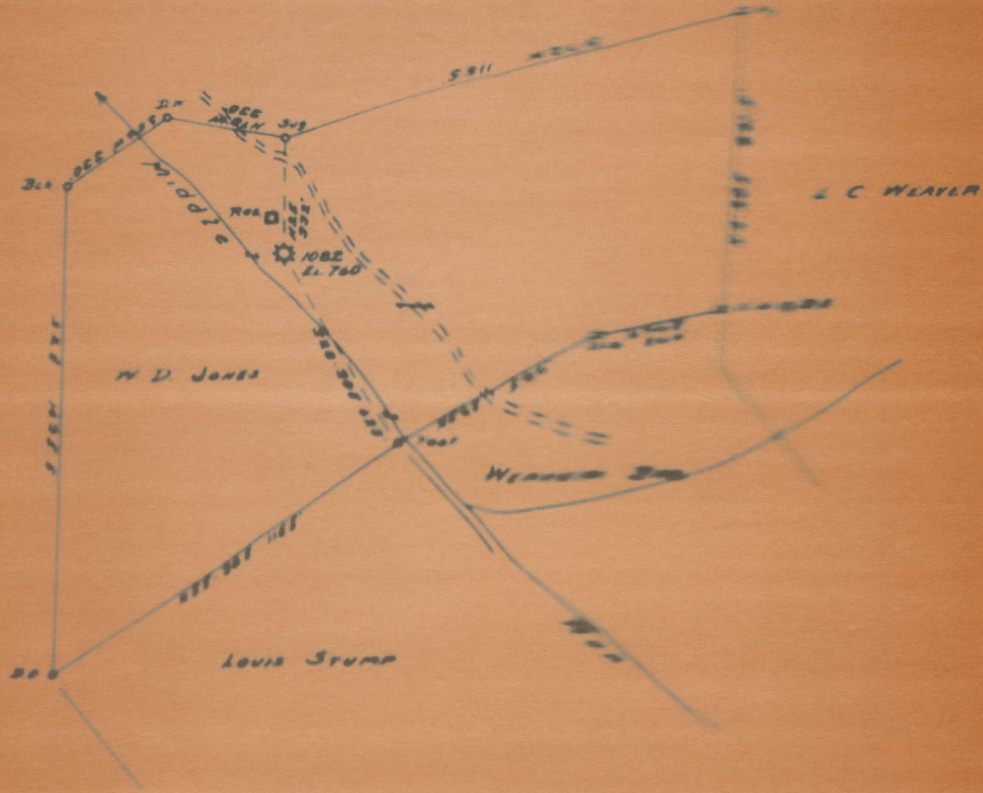

New Location   
 Drill Deeper   
 Abandonment

Company CARNegie NATURAL GAS  
 Address PITTSBURGH, Pa.  
 Farm W. D. JONES  
 Tract \_\_\_\_\_ Acres 66.75 Lease No. E-5184-20  
 Well (Farm) No. 1 Serial No. E-1082  
 Elevation (Spirit Level) 760'  
 Quadrangle GLENVILLE N.W.

STATE OF WEST VIRGINIA  
 DEPARTMENT OF MINES  
 OIL AND GAS DIVISION  
 CHARLESTON

WELL LOCATION MAP  
 FILE NO. Oil-398-A

\* Denotes location of well on United States

# WELL RECORD

Permit No. \_\_\_\_\_

WELL TO BE ABANDONED

Oil or Gas Well \_\_\_\_\_  
Date \_\_\_\_\_

Company Carnegie Natural Gas Company,  
 Address 1015 Friok Building, Pittsburgh 13, Pa.  
 Farm W. D. Jones Acres 14.75  
 Location (waters) Middle Run  
 Well No. 1-1082 Elev. 2160  
 District DeKalb County DeKalb  
 The surface of tract is owned in fee by W. D. Jones  
Glenville Address N. Va.  
 Mineral rights are owned by W. D. Jones,  
Glenville Address N. Va.  
 Drilling commenced 3-10-22  
 Drilling completed 3-30-22  
 Date Shot \_\_\_\_\_ From \_\_\_\_\_ To \_\_\_\_\_  
 With \_\_\_\_\_

Casing and Tubing	Used in Drilling	Left in Well	Packers
Size			Kind of Packer
18			
18			
18	139	139	Size of
8 3/4			
8 3/4	1156	1156	Depth set
8 3/16			
2			Perf top
2			Perf bottom
Liners Used			Perf top
			Perf bottom

Open Flow \_\_\_\_\_ /10ths Water in \_\_\_\_\_ Inch  
 \_\_\_\_\_ /10ths Merc. in \_\_\_\_\_ Inch  
 Volume 248,000 Cu. Ft.  
 Rock Pressure 500 lbs. hrs  
 Oil \_\_\_\_\_ bbls., 1st 24 hrs  
 Fresh water \_\_\_\_\_ feet  
 Salt water 1175 feet

CASING/CEMENTED	SIZE	No. Ft.	Date
COAL WAS ENCOUNTERED AT			
FEET	INCHES	FEET	INCHES
FEET	INCHES	FEET	INCHES

Formation	Color	Hard or Soft	Top	Bottom	Hl. Gas or Water	Depth Found	Remarks
Big Dunkard			530	550			
Gas Sand			590	700			
1st Salt Sand			760	880			
2nd Salt Sand			975	1025			
Mammon Sand			1145	1170			
					Water	1175	
					Gas	1175	
Little Line			1478	1513			
Pencil Cave			1513	1523			
Big Line			1523	1606			
Big Injun			1606		Gas	1660	
TOTAL DEPTH				1698			



ATTENTION SHOULD BE MADE IN TRIPPLICATE AND TO BE MAILED TO THE DEPARTMENT AND ONE TO BE KEPT BY THE OPERATOR AND THE OTHER COPY (AND EXTRA COPIES IF REQUIRED) SHOULD BE KEPT BY EACH COAL OPERATOR AT THEIR RESIDENCE

No Commercial Coal

COAL OPERATOR OR OWNER

ADDRESS

COAL OPERATOR OR OWNER

ADDRESS

W. D. Jones,

LEASE OR PROPERTY OWNER

Glenville, W. Va.

ADDRESS

CARNEGIE NATURAL GAS COMPANY,

1015 PETER BUILDING,  
Pittsburgh, Pa.

COMPLETE ADDRESS

November 10, 19 52

WELL AND LOCATION

DeKalb District

Gilmer County

Well No. 1 - 1082

W. D. Jones Farm

STATE INSPECTOR SUPERVISING PLUGGING O. C. Howard

AFFIDAVIT

STATE OF WEST VIRGINIA.

County of Ritchie

Harold Simmons

and

Clarence S. Collins

being first duly sworn according to law depose and say that they are experienced in the work of plugging and filling oil and gas wells and were employed by Carnegie Natural Gas Company well operator, and participated in the work of plugging and filling the above well, that said work was commenced on the 27, day of October, 19 52, and that the well was plugged and filled in the following manner:

BAND OR ZONE RECORD FORMATION	FILLING MATERIAL		PLUGS USED	CASING	
	CONTENT	FROM TO		SIZE & KIND	NO. FEET
Big Injun etc	Clay	1698 1981	5' crushed stone on cement	(7" OD.)	1272'
	Cement	1581 1572			
	Clay	1566 1458			
	Cement	1458 1448			
	Clay	1448 1125			
Set bridge at 200' 1 week next cement on bridge.	Cement	1125 1115	5' crushed stone on cement	(10-1/4")	139'
	Clay	200 164			
	Cement	164 154			
	Clay	149 Surface			
COAL BEAMS			DESCRIPTION OF MONUMENT		
			Concrete - 12" x 12"		None
			10" x 10"		Two
			10"		None

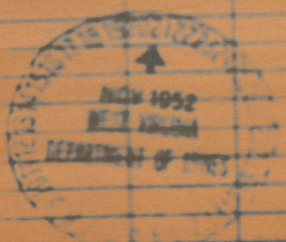

and that the work of plugging and filling said well was completed on the 6, day of November, 19 52.

And further deponents saith not.

Sworn to and subscribed before me this 13 day of Nov 1952

*Harold Simmons*  
*Clarence S. Collins*  
S E May  
Notary Public

My commission expires