

USGS LOCATION MAP
 PREPARED FOR
TIMOTHY GARDNER ETAL 1
 GRANT COUNTY, WEST VIRGINIA
 BLACKBIRD KNOB USGS QUAD

PROJECT -	Timothy Gardner ETAL
DATE -	1/23/2024
SCALE -	1" = 2,000'
DRAWN -	JKANE
FILE -	TIMOTHY_GARDNER_USGS_LOCATION_MAP.mxd



(844) 542-4757
04/19/2024



STATE PLANE
GRID NORTH
NAD 83

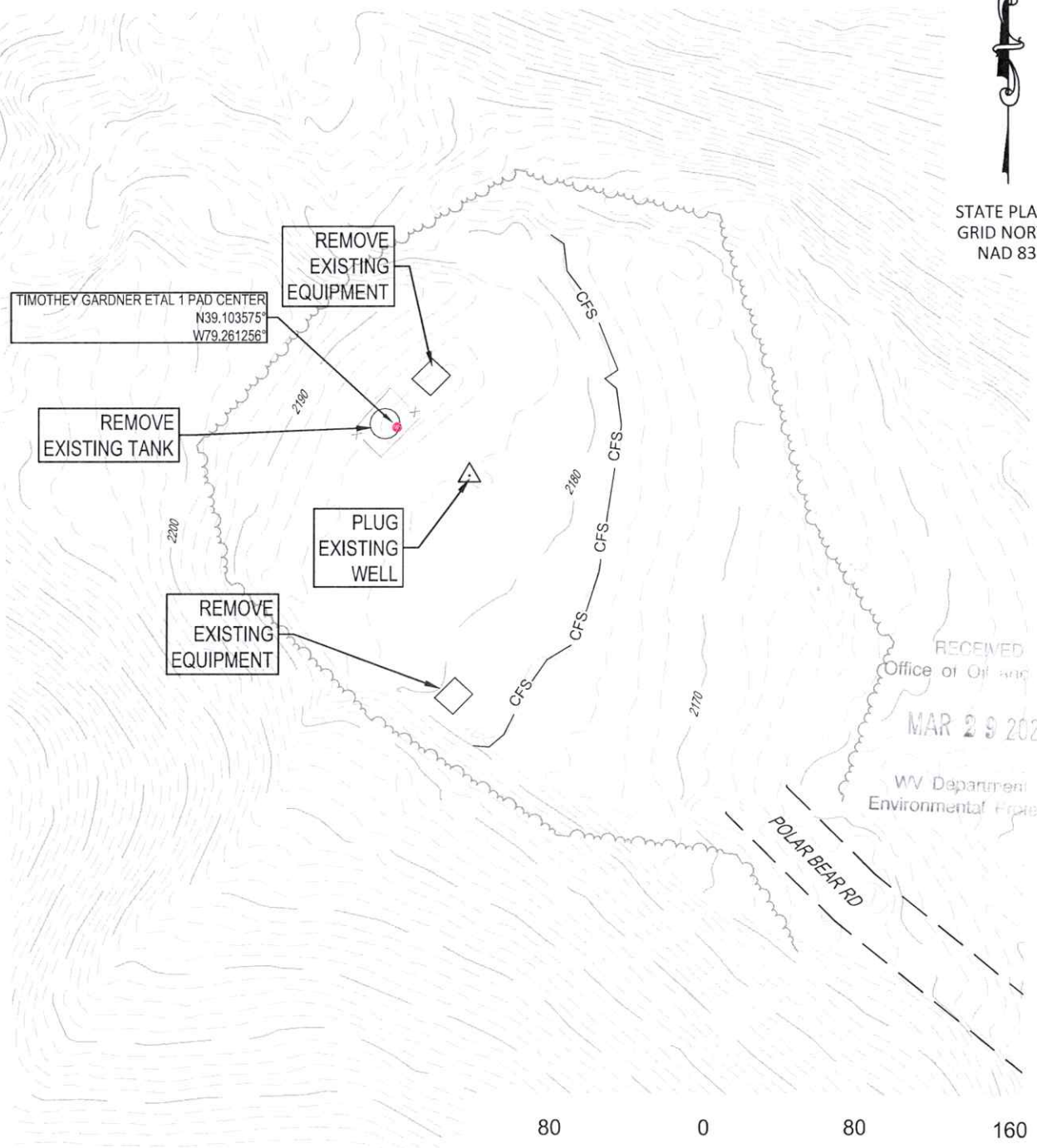

TIMOTHEY GARDNER ETAL 1 PAD CENTER
N39.103575°
W79.261256°

REMOVE
EXISTING
EQUIPMENT

REMOVE
EXISTING
TANK

PLUG
EXISTING
WELL

REMOVE
EXISTING
EQUIPMENT

RECEIVED
Office of Oil and Gas
MAR 29 2024
WV Department of
Environmental Protection

POLAR BEAR RD



SCALE IN FEET

NOTE: ALL PRODUCTION FACILITIES
WILL BE REMOVED UPON COMPLETION
OF THE PLUGGING OPERATIONS.

TIMOTHEY GARDNER ETAL 1
SITE RECLAMATION API#47-023-00033
FOR
CHESAPEAKE ENERGY
LOCATED IN
GRANT COUNTY, WEST VIRGINIA
UNION DISTRICT
SOUTH BRANCH POTOMAC (2070001) WATERSHED

SITE PLAN

LEGEND

- EXISTING CONTOUR
- EXISTING TREE LINE
- EXISTING PRIVATE ROAD EDGE
- WELLHEAD
- COMPOSITE FILTER SOCK



WWW.JHACOMPANIES.COM
844-542-4757
466 SOUTH MAIN STREET
MONTROSE, PA 18801
PA • OH • NY • WV • VA • MD

PLN NO	FINAL	DATE	01/23/2024	REV	1
--------	-------	------	------------	-----	---

04/19/2024



West Virginia Department of Environmental Protection
Office of Oil and Gas
WELL LOCATION FORM: GPS

API: 47-023-00033 WELL NO.: 623925

FARM NAME: TIMOTHY GARDNER

RESPONSIBLE PARTY NAME: CHESAPEAKE APPALACHIA LLC

COUNTY: GRANT DISTRICT: UNION

QUADRANGLE: BLACKBIRD KNOB

SURFACE OWNER: CARROLL B COOK AND DONNA T COOK

ROYALTY OWNER: CARROLL B COOK AND DONNA T COOK

UTM GPS NORTHING: 4329711.924

UTM GPS EASTING: 650358.876 GPS ELEVATION: 2181'

The Responsible Party named above has chosen to submit GPS coordinates in lieu of preparing a new well location plat for a plugging permit or assigned API number on the above well. The Office of Oil and Gas will not accept GPS coordinates that do not meet the following requirements:

1. Datum: NAD 1983, Zone: 17 North, Coordinate Units: meters, Altitude: height above mean sea level (MSL) – meters.
2. Accuracy to Datum – 3.05 meters
3. Data Collection Method:

Survey grade GPS : Post Processed Differential

Real-Time Differential

Mapping Grade GPS : Post Processed Differential

Real-Time Differential

4. Letter size copy of the topography map showing the well location.

I the undersigned, hereby certify this data is correct to the best of my knowledge and belief and shows all the information required by law and the regulations issued and prescribed by the Office of Oil and Gas.

Keri Luino
Signature

REGULATORY SPECIALIST
Title

3/21/24
Date

RECEIVED
Office of Oil and Gas

MAR 29 2024

Environmental Services