

30°27'30

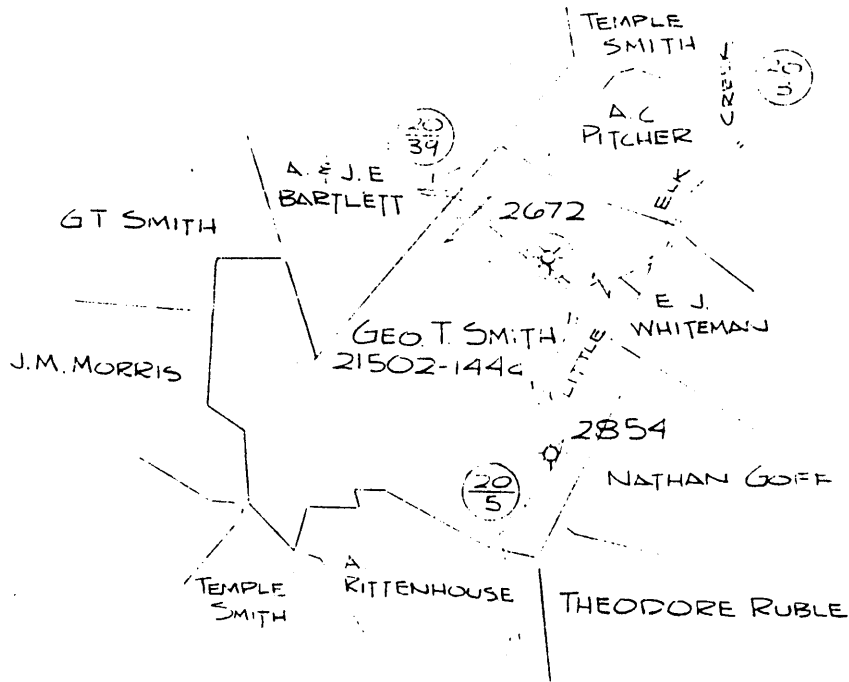

GEO. T. SMITH  
 21502-144a  
 SARDIS DIST., HARRISON CO., WV.  
 MAP SHEET 40 S-4 E-8  
 TOPO-WALLACE 7.5'  
 SCALE - 1" = 320'

033-1353

201

9

LATITUDE

39° 25' 00"

0.735  
0.55W

80° 27' 30"

LONGITUDE

7.5 OGIS topo location

7.5' loc

15' loc 0.735  
(calc.) 2.78W

Company \_\_\_\_\_

Farm Geo T. Smith 2854

Elev. 1019' ground -

Quad Wallace / Clarkburg WC

County Harrison

District Sardis

WELL LOCATION MAP

File No. 033-1353

DISTRICT *W. E. S.*  
 LEASE NO. *21502* ACRES *144* N. S. *4 E. 8*  
 NAME *Geo. J. Smith*  
 ADDRESS *1019 1/2*  
 CITY *Harrison* 47-033-1353  
 COMMENCED *Nov. 20, 1912*  
 CEASED *Nov. 22, 1912*  
 FACTOR *Apr. 12, 1913*  
 RASSED FROM *J. E. Neough*  
 PURCHASED *\$ 1.15 Per Foot*  
 HUT IN  
 CONNECTED  
 TURNED ON  
 TURNED OFF  
 DISCONNECTED  
 TO  
 SOLD  
 RE-PURCHASED  
 DATE PLUGGED  
 DATE ABANDONED  
 Elevator *1019 1/2*

RECORD

FORMATION	TOP	BOTTOM	OIL AT	GAS AT	WATER AT	FRESH OR SALT	SIZE	PUT IN WELL	PULLED	CEMENT
Pittsburgh Coal	573	580					13 In. Casing	644'3"		Date
Dunkard Sand	930	1090					10 In. Casing	1078'11"		Size Casing
Salt Sand	1600						8 1/2 In. Casing	1890'7"	15'9"	Top
Mazon Sand	1871	2000					6 1/2 In. Casing	2616'6"	1934	Bottom
Injun Sand	2330	2355					4 In. Tubing	2486'3"		
Berea Sand	2460	2495		2464			3/4 In. Tubing	2336'1"		
Gantz Sand	2545	2590					2 In. Tubing	2745'	2745	
Fifty Foot Sand	2614	2670					4 1/2 In. Line	1842		
Thirty Foot Sand	2682	2690								
Stray Sand	2694	2724		2706						
Gordon Sand				2711-17						
Fourth Sand										
Fifth Sand										
Bayard Sand										
TOTAL DEPTH		2464								

SHOOTING

DATE	QTS.	SAND	VOLUME BEFORE	VOLUME
2-2-37	30	used	274000	244

VOLUME AND PRESSURE TESTS

DATE TAKEN	READING	LIQUID	OPENING	POUNDS PRESSURE	1 MIN.	5 MIN.	10 MIN.	30 MIN.	60 MIN.	ROCK	VOLUME	SAND	PACKERS
Apr. 12 1913	7/10	M.	6"		95	240	280	285	290		4,152,330	50 ft.	8x6
" 28 "	26/10	"	4"		135	235	240	250	250	255	3,146,880	"	8x6
Aug. 18 1914	4/10	O.	2"								94,560	"	10
" 20 "	26/10	"	2"								2,42,592	"	8
Sept. 10 "	5/10	"	6"								1,117,428	"	6
" 23 "	30/10	"	5"		25	85	100	105	110	110	1,629,000	"	6x4
" 25 "	38/10	M.	2"		260	300	300	300	310	310	1,986,715	"	6x5
" 25 "			2"								277,376	"	5x2
May 12 1928	34/10	W	2"		5	17	30	50	55	50	26,730	50'	
" 12 "	16/10	"	2"								330,720	50'	
" 27 1931	50/10	"	2"								20315	50'	
" 27 "	73/10	"	3/4" F.M.		2	12	25	55	65	70	354,192	50'	
" 31 1937	55/10	"	3 1/2"								20752	50'	
" 31 "	57/10	"	1 1/2"		4	12	22	74	84	70	451,440	50'	
" 23 1937	52/10	M	1" F.M.		10	42	55	61	63	70	121,000	"	
Sept. 16 1944	19/10	Mare.			4	11	19	33	35				